

INSTALLATION INSTRUCTIONS

DESCRIPTION: Sport Screen Kit
PART NUMBER B90-F83J0-V0
MODEL: 2016~ XSR900



⚠ WARNING

Please read and understand these instructions completely before installation to avoid possible injury, or damage to the accessory or vehicle.

NOTICE:

This installation requires a torque wrench and should be performed by an authorized Yamaha dealer or other qualified technician.

WARRANTY INFORMATION:

Genuine Yamaha accessories are covered by a one-year limited warranty against defects in material or workmanship. Labor for replacement of defective components is not covered. See your Yamaha dealer for a copy of the warranty statement.

DEALER OR INSTALLER:

Please give a copy of these instructions to your customer as they contain important information for future reference.

PARTS LIST:

No.	Part Number	Description	Qty
--	B90-F83J0-V0	Sport Screen Kit	--
①	*	Sport Screen	1
②	*	Stay- Left	1
③	*	Stay- Right	1
④	*	M6 x 35mm hex socket bolt (7 Nm)	4
⑤	*	M5 x 18 button head hex bolt (.5 Nm)	4
⑥	*	M5 Nylon Washer	4
⑦	*	M5 Well Nut	4
⑧	*	20mm Collar	4
⑨	*	M6x20mm hex socket bolt (Not Used)	4
⑩	*	Nylon Spacer	4
⑪	*	Rubber Grommet	4
⑫	*	Top Hat Spacer	4

* Part supplied with kit only and not available separately.

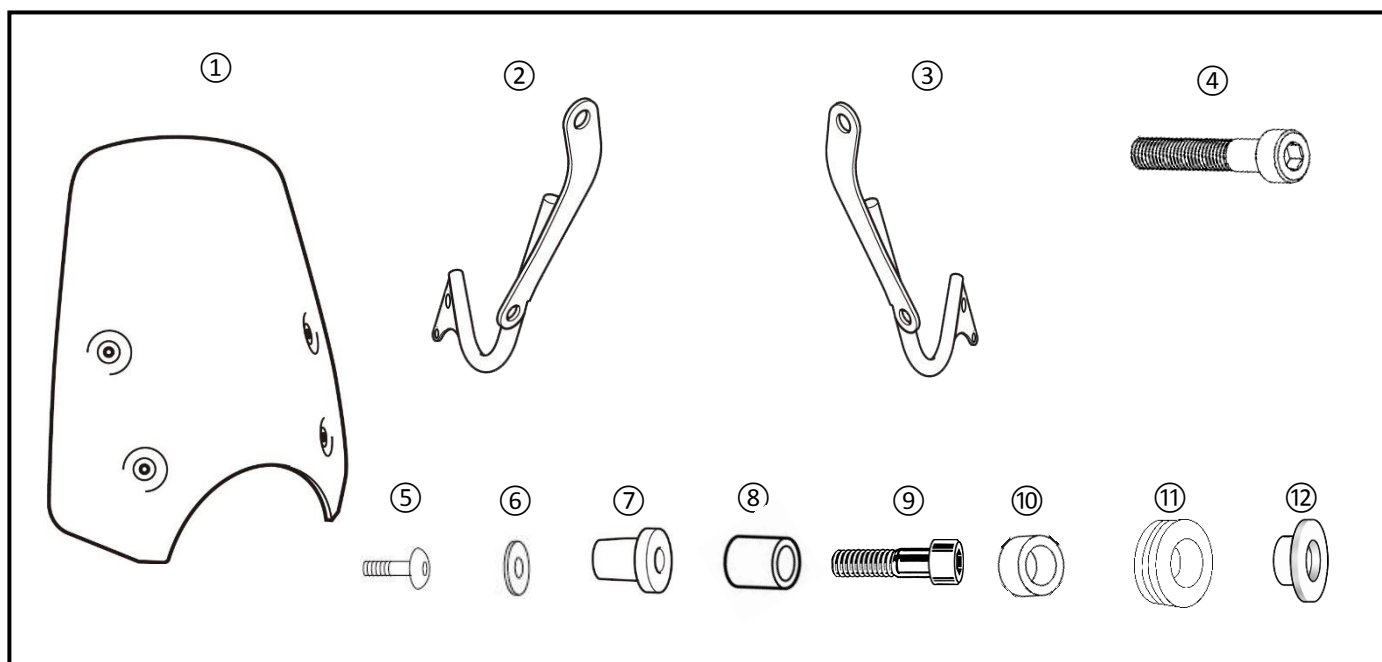

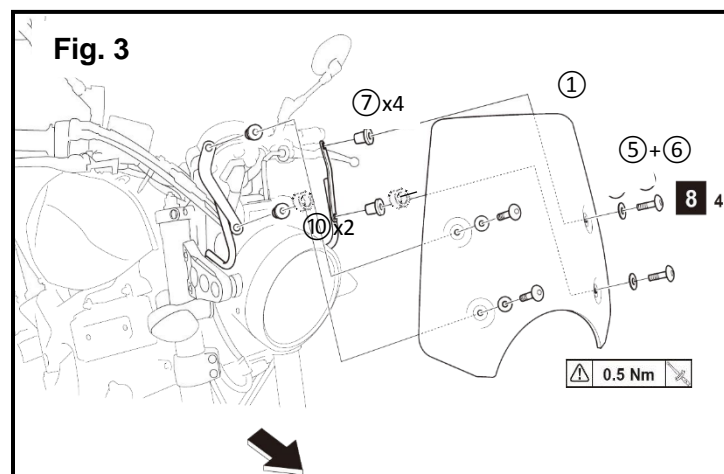
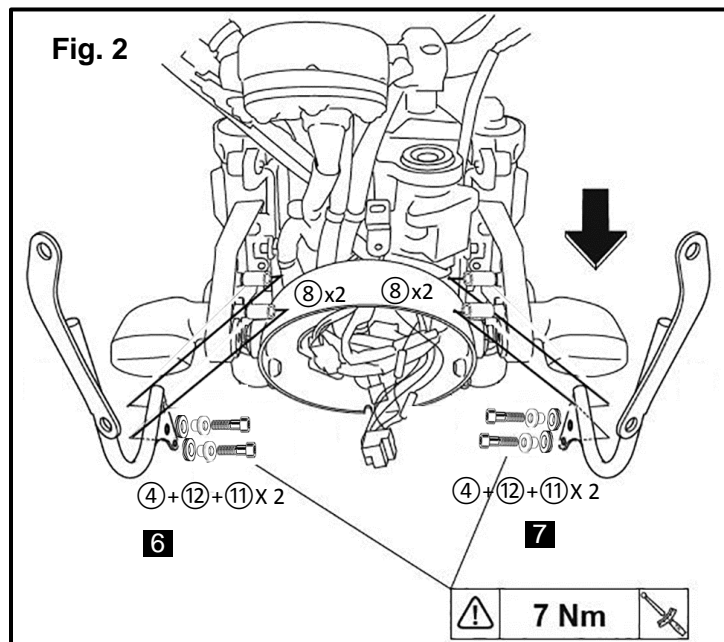
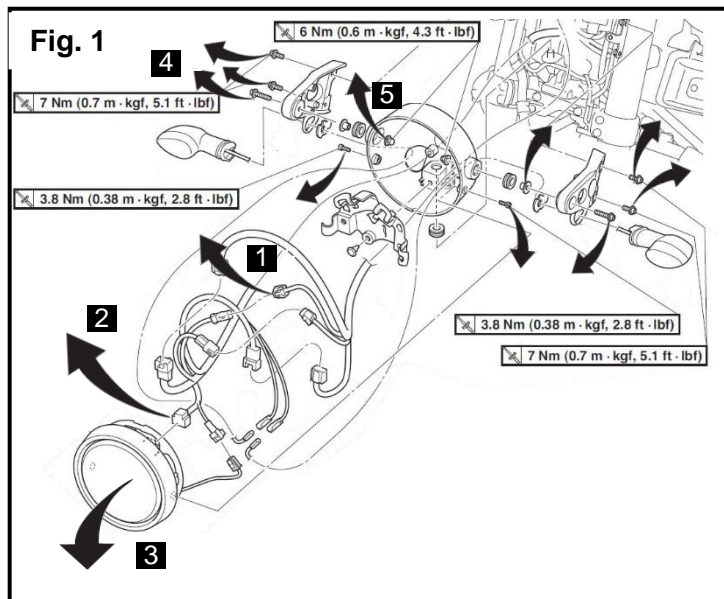

PREPARATION:

- Stand motorcycle on a secure and level surface.
- Clean all mount surfaces before installation.
- Disconnect battery to avoid short circuits.

REMOVE HEADLIGHT & TURN SIGNALS (Fig. 1)

- 1 Disconnect power connector from headlight bucket.
- 2 Disconnect headlight plug.
- 3 Rotate headlight bucket forward and down to remove.
- 4 Remove 2 bolts holding the headlight to the headlight mounts.
- 5 Remove the capture nuts from the back of the turn signal mounts.

INSTALL WINDSCREEN STAYS (Fig. 2)

- 6 Press 2 Rubber Grommets (11) into the mount holes in the Stay-Right (3). Press 2 Top Hat Spacer's (12) into the Rubber Grommets (11) as shown in Fig. 2. Thread 2 M6x35 hex socket bolts (4) through the Top Hat Spacers (12), through the Collars (8), and thread into the turn signal mount hole.
- 7 Repeat on the left side. Torque M6x35 hex socket bolts (4) to 7Nm (ft·lbf).

INSTALL WINDSCREEN TO STAYS (Fig. 3)

- 8 Insert 4 M5 Well Nuts (7) into mount holes on Left and Right side Stays (2 & 3). Install 4 Nylon Washers (6) to the 4 M5 x18 button head hex bolts (5). Install two Nylon Spacers (10) to 2 lower bolts between Sport Screen (1) and Well Nuts. Install the other 2 M5 bolts to the upper screen mounts. Torque all 4 M5 bolts (5) to 0.5 Nm (12 ft·lbf).
- 9 Use stock bolts and nuts to install headlight bucket. Install the headlight and reconnect power and headlight connectors. Torque headlight mount bolts to 7 Nm (0.7 m·kgf, 5.1 ft·lbf) and capture nuts to 6 Nm (0.6 m·kgf, 4.3 ft·lbf). Refer to Owner's Manual to adjust headlight. Reconnect the battery.

MAINTENANCE:

Periodically check all hardware for tightness and re-torque as necessary.

CARE AND CLEANING:

Clean windscreen with cloth or sponge using a neutral detergent, and after cleaning, thoroughly wash with water. For additional cleaning, use Yamalube® Windshield & Visor Plastic Cleaner & Conditioner (ACC-PLASP-OL-11).

NOTICE:

Avoid alkaline or strong acid cleaners, gasoline, brake fluid, or any other solvent. Some cleaning compounds may scratch the windshield. Test a new cleaner on a small unused portion before use.

CUSTOMER SERVICE:

For further information see your Yamaha dealer.

ESTIMATED TIME TO INSTALL: 0.5 HR