

## VT No. 50-1611

### Additional Parts Required

Turn Signal Relocation Kit (31-1567) or (31-1559) must be installed prior to installing this kit on FLSTF, FXSTS, FXST, and FXSTB models when saddlebags are not being installed.

Loctite 243 Threadlocker and Sealant - Blue

### Kit Contents

See Table 1.

### INSTALLATION

1. 2003-up Softail models without saddlebags: Install Turn Signal Relocation Kit, if not done already.
2. Remove and discard stock screws from fender support.
3. Install front and rear docking points (1, 2). For each docking point, place countersunk side of docking point towards fender support cover.
4. Apply Loctite 243 (blue) to first four threads of docking point screws.
5. Thread screws (3) through front and rear docking points and into fender and bracket (underneath fender). Tighten screws to 21-27 ft-lbs.
6. Repeat steps for opposite side.

### MAINTENANCE

#### NOTICE

Failure to tighten hardware to the specified torque could result in damage to the installed accessory.

#### NOTE

In time docking points may wear, causing the mating luggage rack or sideplates to become loose and rattle. The fit may be tightened using the following procedure.

1. Loosen docking hardware. If fasteners with Loctite are disturbed, the fasteners need to be cleaned and new Loctite applied.
2. Rotate docking points clockwise approximately 45 degrees.
3. Tighten docking hardware to the appropriate torque values. Repeat as often as required, up to 3 times. After 3 times new docking points must be installed.

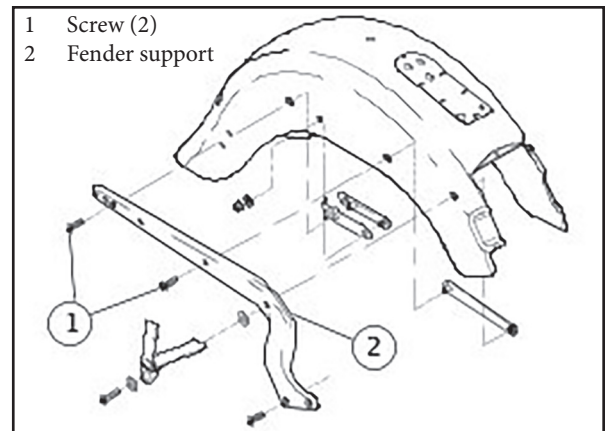

Figure 1. Remove Screws

Table 1. Service Parts: Softail Docking Hardware Without Saddlebag Supports (FXST Shown)

1	Docking point, front (2)
2	Docking point, rear (2)
3	Screw 3/8 -16 x1 3/4