

WOODCRAFT CFMOTORSPORTS

105 Baldwinville Rd
Winchendon, MA 01475
(978)297-2977

www.woodcraft-cfm.com

05-0738 KTM RC390 2022-23 Rearset Instruction Sheet – Racing Use Only

Thank you for selecting CFMOTORSPORTS rearsets. Please note that these components are intended and approved for **racing use only**. As such, the footpegs are solid-mount, the side stand is eliminated and brake light switches are optional (the Woodcraft 03-0100 switch works with this kit).

- 1) Remove stock rearsets, footpegs and associated hardware. All components that are re-used in this kit should be cleaned and inspected for damage before re-installation.

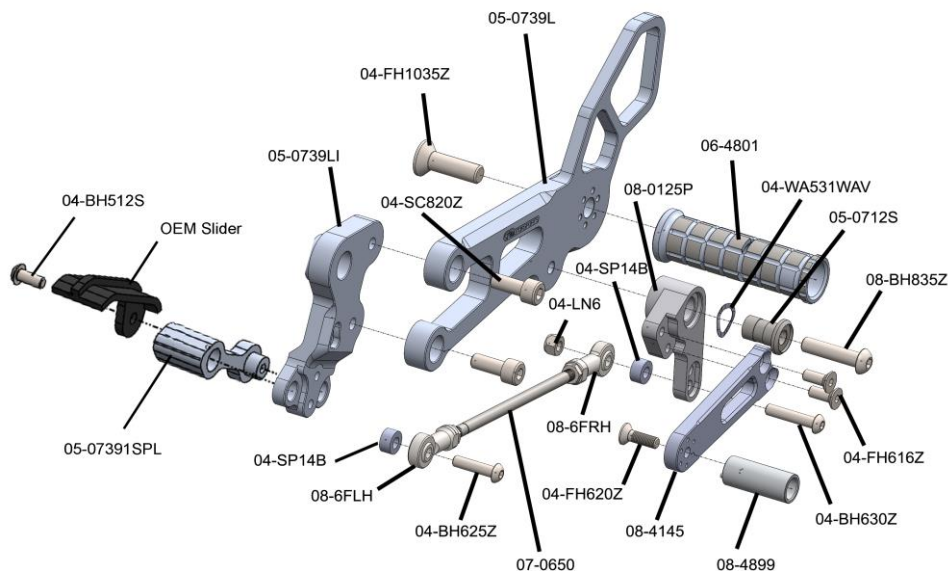

IMPORTANT

Tighten all fasteners to factory specification or industry standard. FAILURE TO PROPERLY TIGHTEN ALL FASTENERS MAY CAUSE DAMAGE TO THE MOTORCYCLE, LOSS OF CONTROL AND SERIOUS INJURY OR DEATH

Preparation - IMPORTANT - Secure all bolts with BLUE LOCTITE

- 1) Bolt the 05-0739LI and 05-0739RI inner brackets to the motorcycle using the OEM swingarm pivot bolt that was removed with the OEM rearsets through the top hole of each side.
- 2) Mount the OEM Chain slider to the 05-07391SPL using the 5mm bolt and Blue Loctite as shown above.
- 3) Before tightening the swingarm pivot bolt, secure the bottom OEM bolts on each side using the supplied spacers (05-07391SPL and 05-07391SPR) between the brackets and the frame. **Note:** This kit eliminates the side stand. Only the front mounting bolts are used on each side (these brackets also fit the older 390, which has two bolts).

Shift Side Assembly Installation - IMPORTANT - Secure all bolts with BLUE LOCTITE.

- 1) Assemble the CFM shift pedal. First assemble the 08-4145 shift shaft to the 08-0125P pivot. Next, bolt the 08-6FRH heim to the pivot through the LOWER hole using the 6x30 bolt, 04-SP14B spacer and 04-LN6 lock nut. Bolt the entire assembly to the bracket using the 05-0712S steel pin, 8x35BH bolt and the wave washer (be sure to coat the outside of the pin with waterproof grease).
- 2) Bolt the CFM footpeg to the main bracket 05-0739L using the included 10mm hardware. Once you have chosen your final position, bolt this assembly to the 05-0739LI inner bracket with the 04-SC820Z hardware supplied.
- 3) Connect the shift rod to both the shift pedal assembly + the shift spline on the engine with 08-6FLH heim joint with supplied hardware. Note the orientation of the spacers in the drawing at the right.
- 4) Bring the shift pedal to the desired height using a combination of the OEM shift rod and the eccentric toe piece.

