



INSTALLATION

UNIVERSAL TRAILER WIRING AND RELAY WIRING HARNESS

PART# 7671

PARTS INCLUDED

- 1 Trailer wiring isolation harness
- 1 Inline fuse Y harness with Heat shrink covered butt connectors
- 1 Universal trailer sub harness
- 1 Hardware kit containing
 - 6 8" black nylon wire ties
 - 1 1/4" ring terminal
 - 1 Dielectric grease pack
 - 5 Male Scotch lock wire ends (spade type)
 - 5 T-Tap female quick slide Scotch Locks
- 1 Installation Instructions

Please read and understand entire instructions before starting installation.

THANK YOU FOR CHOOSING KÜRYAKYN!

IN ORDER TO PROTECT YOU AND OTHERS FROM POSSIBLE INJURY AND/OR PROPERTY DAMAGE OR LOSS, PLEASE PAY CLOSE ATTENTION TO ALL INSTRUCTIONS, WARNINGS, CAUTIONS AND ATTENTION NOTES REGARDING THE USE AND CARE OF THIS PRODUCT.

WARNING! THIS INDICATION ALERTS YOU TO THE FACT THAT IGNORING THE CONTENTS DESCRIBED HEREIN CAN RESULT IN POTENTIAL DEATH OR SERIOUS INJURY

ATTENTION! This indication alerts you to the fact that ignoring the contents described herein may negatively affect product performance and functionality.

TOOLS SUGGESTED

- Set of hex wrenches, combination wrenches, wire stripper, crimping pliers, side cutters, test light or multi meter

STRICTLY OBSERVE THE FOLLOWING GUIDELINES IN ORDER TO USE THE PRODUCT PROPERLY AND AVOID POTENTIALLY DANGEROUS ACCIDENTS.

Procedure

ATTENTION! A factory service manual may be helpful in performing this installation. Do not attempt to perform this installation if you are not confident in your ability to complete all of the steps in the procedure; consult a trained technician.

STEP 1 Read and understand all steps in the instructions before starting the installation. Park the motorcycle on a hard, level surface and turn off the ignition.

-cont.-

7671-21HD-1110

CUSTOMER SERVICE
877.370.3604 (toll free)

INSTALLATION QUESTIONS
techsupport@kuryakyn.com
or call 715.247.2983

LIMITED WARRANTY

Küryakyn warrants that any Küryakyn products sold hereunder, shall be free of defects in materials and workmanship for a period of one (1) year from the date of purchase by the consumer excepting the following provisions:

- Küryakyn shall have no obligation in the event the customer is unable to provide a receipt showing the date the customer purchased the product(s).

- The product must be properly installed, maintained and operated under normal conditions.

- Küryakyn makes no warranty, expressed or implied, with respect to any gold plated products.

- Küryakyn shall not be liable for any consequential and incidental damages, including labor and paint, resulting from failure of a Küryakyn product, failure to deliver, delay in delivery, delivery in nonconforming condition, or for any breach of contract or duty between Küryakyn and a customer.

- Küryakyn products are often intended for use in specific applications. Küryakyn makes no warranty if a Küryakyn product is used in applications other than intended.

- Küryakyn electrical products are warranted for one (1) year from the date of purchase by the consumer. L.E.D.'S contained in components of Küryakyn products will be warranted for defects in materials and workmanship for 3 years from the date of purchase where as all other components shall be warranted for one(1) year. This includes, but is not limited to; control modules, wiring, chrome & other components.

- Küryakyn makes no warranty of any kind in regard to other manufacturer's products distributed by Küryakyn. Küryakyn will pass on all warranties made by the manufacturer and where possible, will expedite the claim on behalf of the customer, but ultimately, responsibility for disposition of the warranty claim lies with the manufacturer.

ABOUT OUR CATALOG

For purchasing Küryakyn® products, you can receive a complete catalog free of charge. Send the Proof-of-Purchase below with your address to: Küryakyn, P.O. Box 339, Somerset, WI 54025.

Please indicate either Accessories Catalog for Harley-Davidson® or GL & Metric Cruisers.

Be sure to ask your local dealer about other Küryakyn® products, the motorcycle parts and accessories designed for riders by riders.

©2005 Küryakyn USA® All Rights reserved.



kuryakyn.com

STEP 2 Locate wires for the taillights, and turn signals on the back of the bike. Usually underneath the seat or behind one of the side covers.

ATTENTION! **Plug the new Sub Harness in before any other components on the bike.(i.e. run-turn-brake module).**

STEP 3 With a test light, locate the run light, each turn signal light and brake light wires. It would be helpful to write each wire and purpose down on a piece of paper for later use.

STEP 4 Use the supplied female scotch locks and crimp one on each of the four wires so you can easily splice into them.

ATTENTION! **Küryakyn recommends the use of the included dielectric grease on electrical connections**

STEP 5 On the Universal-Sub Harness (this is the four wires attached to the four pin plug) PIC 1, these wires will attach to the bike's harness. Yellow is the Left Turn, Brown is Tail Light, Green is Right Turn, Blue is Brake Light.

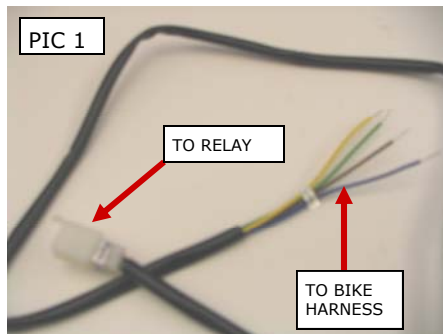

STEP 6 Find the location where you will like to secure the wires from the Universal-Sub Harness. If the wires are too long for your application, use a side cutter and cut them to the correct length.

STEP 7 Once you have your desired length, use the provided male spade connectors and crimp them onto all four wires.

STEP 8 Hook each wire up to its desired location. Revert to step 5 for explanation of each wire. If needed use a test light to determine proper location.

STEP 9 Take the Trailer Isolation Relay Kit and route the red, red with black stripe and black wires that are in black sheathing, from the harness to the battery.

STEP 10 Crimp a 1/4" ring terminal on the black wire that goes to the negative side of the battery. Connect the red wire to one end of the Y wire on the fuse holder and the red wire with the black stripe to the other side of the Y wire with the provided heat shrink covered butt connectors. Connect the single red wire on the opposite end of the fuse holder to the positive terminal on the battery.

WARNING: **When this wire is connected to the battery, the Red wire with the Black stripe will have power at the other end of it. Make sure it is capped off as in Step 12 before attaching this wire to the battery!**

Connect the black wire to the negative terminal on the battery. PIC 2 and PIC 3

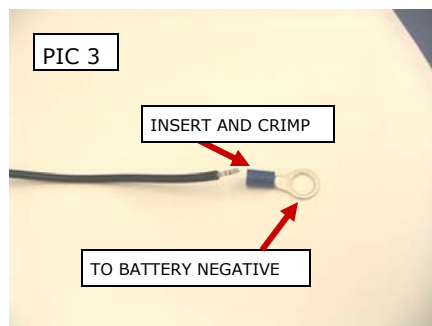
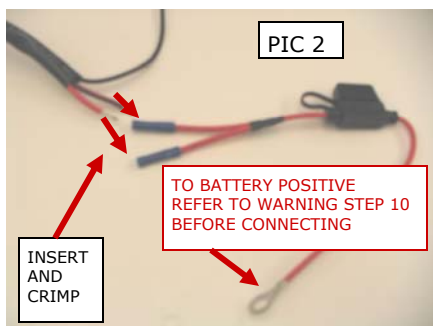

STEP 11 On the bike, you can plug the 4 pin plugs to each other. PIC 4

ATTENTION! Küryakyn recommends the use of the included dielectric grease on electrical connections

STEP 12 With the two (four pin) plugs connected, use a test light to check for proper function. Turn the key on and test both signals. (Yellow is left and Green is right turn) Brake lights (Blue) and Run light. (Brown). The red wire with a black stripe is a power wire that can be used for keyless entry power or interior lighting on the trailer.

WARNING: If this wire is not going to be used, cap it off using electrical tape or a piece of heat shrink over the installed butt connector, as it will have power to it all the time, even when the key is off, as it is hooked directly to the battery!

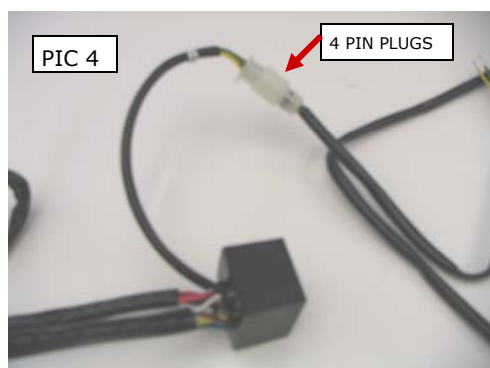

The white wire is ground. PIC 4 and PIC 5

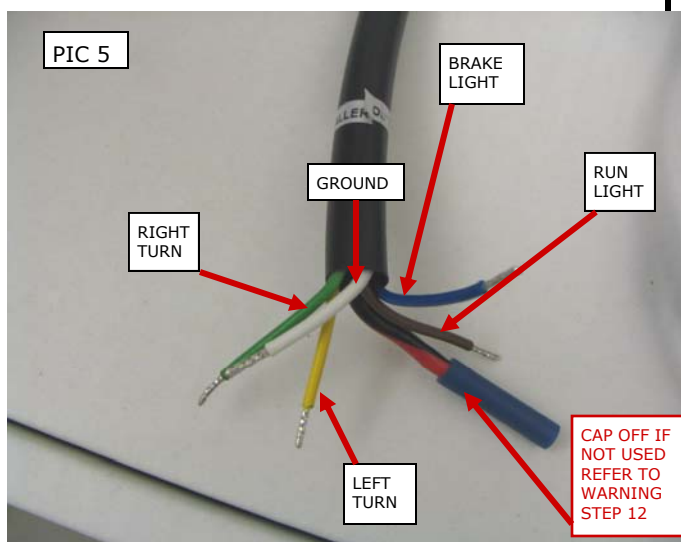

Ride On!