

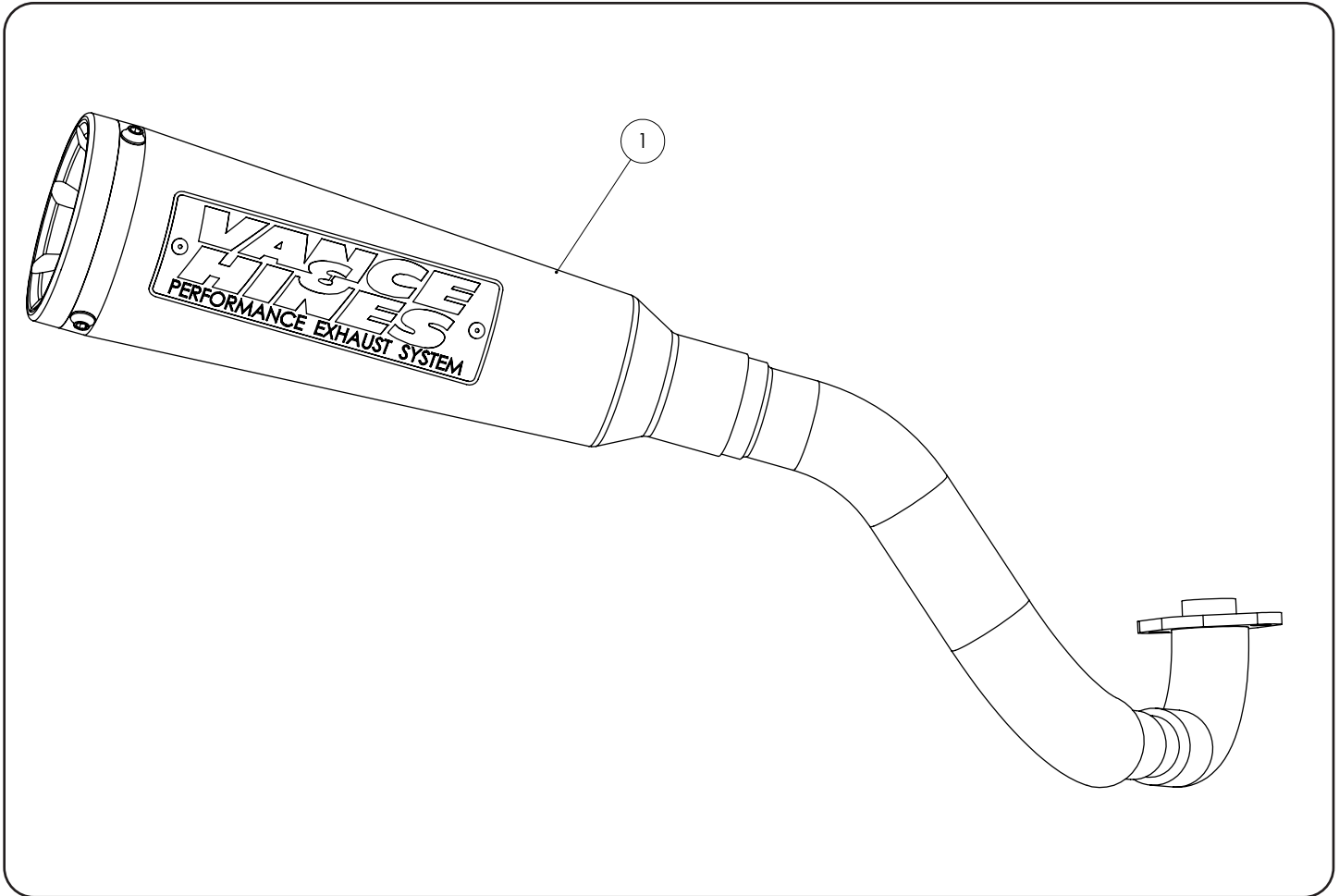

**INSTALLATION INSTRUCTIONS:
2022 HONDA NAVI
UPSWEEP FULL EXHAUST SYSTEM BLACK
PART# 48241**

Congratulations, you have purchased the finest exhaust system available for your motorcycle. Your Vance & Hines exhaust is designed and crafted for performance, quality, and style. Please follow the instructions below, check exhaust system for missing or damaged parts and if you need any assistance please contact our technical support line (562) 921-7461.

Fits 2022 Honda Navi models



PARTS LIST

	PART NO.	Description	Qty.
1	H182FP	Exhaust System	1
2	1275-P	Mounting Bracket	1
3	A949HW	M10X1.25X25mm	2
4	A304HW	1/4-20 x 1/2 Button Head Screw	2

HARDWARE

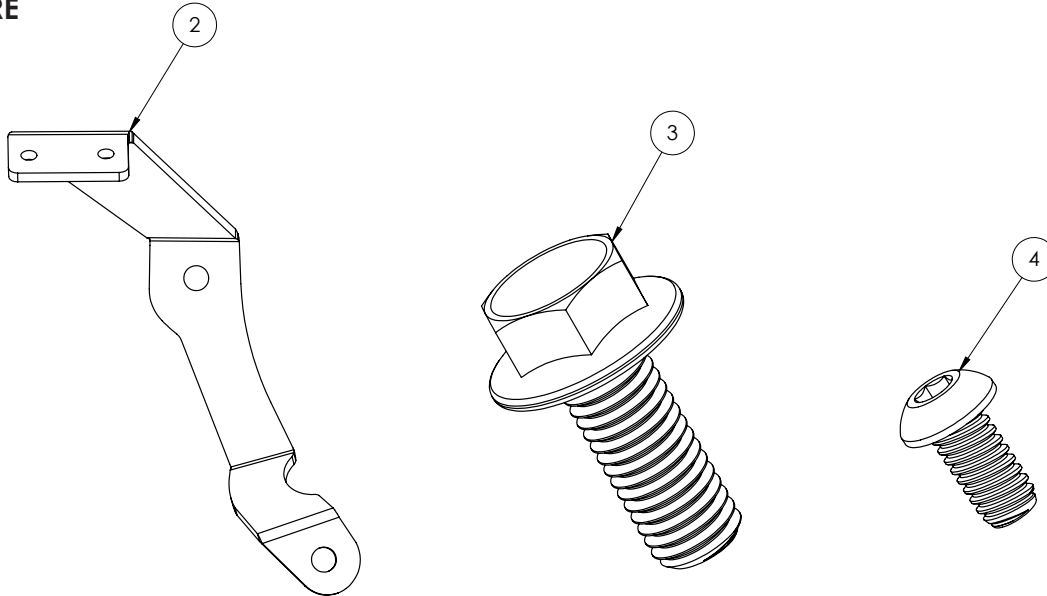

TOOLS REQUIRED



Allen Wrench: 4mm

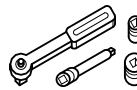

Sockets: 10mm, 14mm, 15mm

Ratchets: 1/4", 3/8"

Extentions: 1/4"DR EXT Bar 6"
3/8 "DR EXT Bar 6"

STOCK SYSTEM REMOVAL

1. Remove the two cylinder exhaust port nuts from head pipe, located at the cylinder head. (Save for reuse)
2. Remove the splashguard bolt, located on the rear fender.
3. Remove the two exhaust chassis mount bolts.
4. Remove the complete exhaust system and set aside.
5. Check the condition of exhaust gasket and replace if worn or damaged.

VANCE & HINES SYSTEM INSTALLATION

1. Install mounting bracket (1275-P) using supplied M10 bolts (A949HW). (Do not fully tighten at this time).
2. Install exhaust using stock exhaust port nuts. (Do not fully tighten at this time).
3. Fasten exhaust to mounting bracket using the two supplied 1/4-20 screws (A304HW).
4. Tighten cylinder exhaust port nuts evenly.
5. Tighten muffler mounting screws.
6. Tighten mounting bracket bolts.

EXHAUST CARE (BLACK)

1. When installing a new set of black pipes, make sure your hands are clean and free from oil. After installation, thoroughly clean pipes with warm soapy water and a soft cloth. Dry with a clean towel to remove any residue before starting the motorcycle. Do NOT use anything abrasive to clean pipes.
2. Avoid long periods of idling as this can cause discoloration.
3. Intake leaks can cause the engine to run lean and overheat, this could lead to discoloration.
4. Make sure there are no exhaust leaks at the junction of the exhaust pipes and the cylinder head. We recommend replacing gaskets if they are worn.

Emissions Notice:

In California, in order to meet Air Resources Board emissions requirements, certain aftermarket part applications have been identified as replacements, and others have received ARB Executive Orders. All other emissions related aftermarket parts are for competition use only. A list of replacement parts and EO parts, and corresponding fitment is provided at vanceandhines.com/California.

Warranty:

All Vance & Hines products are warranted against defects in material and workmanship for a period of 90 days. This warranty does not cover discoloration or rust. This warranty shall be limited to the repair or replacement of the product, which may be proven defective under normal use. Vance & Hines will not warranty any system that has been abused, misused, improperly installed or modified.

Dealers or distributors are not authorized to make dispositions binding upon Vance & Hines. Vance & Hines will not be responsible for any labor charges incurred in removing or replacing any system under warranty. A return authorization number and a copy of the original purchase invoice must accompany all returns. Parts returned without a return authorization may be refused.

13861 ROSECRANS AVENUE / SANTA FE SPRINGS, CA 90670
SALES: (562) 921-5388
TECHNICAL: (562) 926-5291
FAX: (562) 802-0110

vanceandhines
.com