

POWER COMMANDER 6

Installation Guide for: PC6-14023

Model Coverage: 2012-2013 Ducati Streetfighter 848

PARTS LIST

×

- | | | | |
|---|------------------------|---|---------------|
| 1 | POWER COMMANDER 6 | 2 | VELCRO STRIPS |
| 1 | INSTALLATION GUIDE | 1 | ALCOHOL SWAB |
| 1 | USB CABLE | 4 | ZIP TIES |
| 2 | DYNOJET DECALS | 1 | POSI-TAP |
| 2 | POWER COMMANDER DECALS | | |

**PLEASE READ ALL DIRECTIONS BEFORE STARTING INSTALLATION.
THE IGNITION MUST BE TURNED OFF BEFORE INSTALLATION.**

×

IPC6-14023.01

DUKATI

INPUT ACCESSORY GUIDE

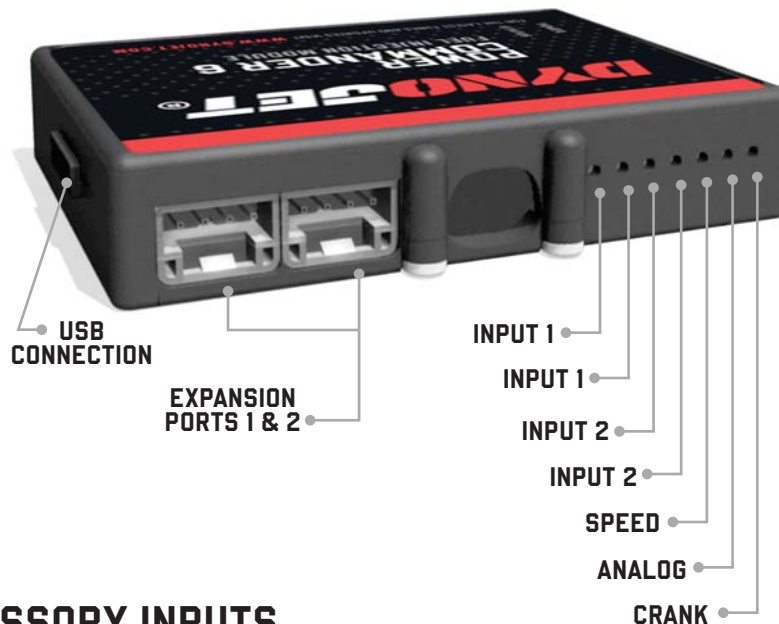

OPTIONAL ACCESSORY INPUTS

- Map** (Input 1 or 2) The PC6 has the ability to hold 2 different base maps. You can switch on the fly between these two base maps when you hook up a switch to the MAP inputs. You can use any open/close type switch. The polarity of the wires is not important.
- Shifter** (Input 1 or 2) Used for clutch-less full throttle upshifts. Insert the wires from the Dynojet quick shifter into either Input 1 or Input 2. The polarity of the wires is not important. Set to Input 2 by default.
- Speed** If your application has a speed sensor then you can tap into the signal side of the sensor and run a wire into this input. This will allow you to calculate gear position in the Control Center Software. Once gear position is setup you can alter your map based on gear position and setup gear dependent kill times when using a quick shifter.
- Analog** This input is for a 0-5v signal such as engine temp, boost, etc. Once this input is established you can alter your fuel curve based on this input in the Power Core software.
- Launch** You can connect a wire to either Input 1 or Input 2 and then the other end to a switch. This switch when engaged (continuity) will only allow the RPM to be raised to a certain limit (set in the software). When released, you will have full RPM.

WIRE CONNECTIONS

To input wires into the PC6 first remove the rubber plug on the backside of the unit and loosen the screw for the corresponding input. Using a 22-24 gauge wire, strip about 10mm from its end. Push the wire into the hole of the PC6 until it stops and then tighten the screw. Make sure to reinstall the rubber plug.

NOTE: If you tin the wires with solder it will make inserting them easier.



INSTALLING THE POWER COMMANDER 6



- 1 Remove the seat and fuel tank.
- 2 Using the supplied Velcro, secure the PC6 to the inner right hand side of the tail section.

Make sure to use the supplied alcohol swab to clean both surfaces before attaching the Velcro.

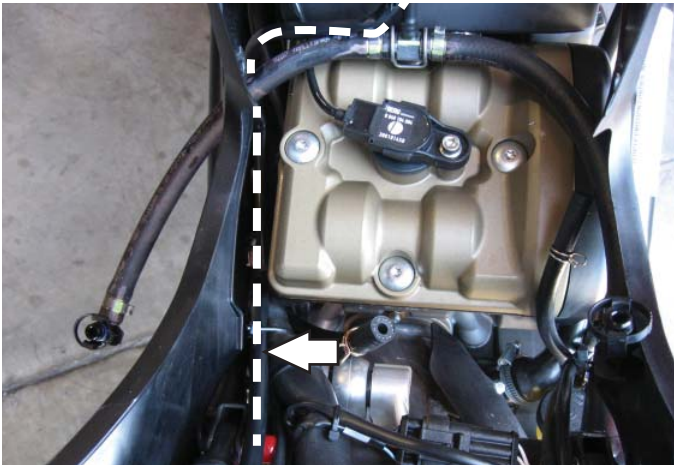

- 3 Route the PC6 harness under the subframe and go down the left side of the rear cylinder and follow the stock wiring harness to the rear fuel injector on top of the air box.



- 4 Continue routing the PC6 harness along the stock wiring harness to the front of the air box . Use the supplied zip ties to secure the PC6 harness to the stock harness.

- 5 Unplug the stock wiring harness from the rear fuel injector.



- 6 Plug the pair of PC6 leads with YELLOW colored wires in-line of the rear fuel injector and the stock wiring harness .

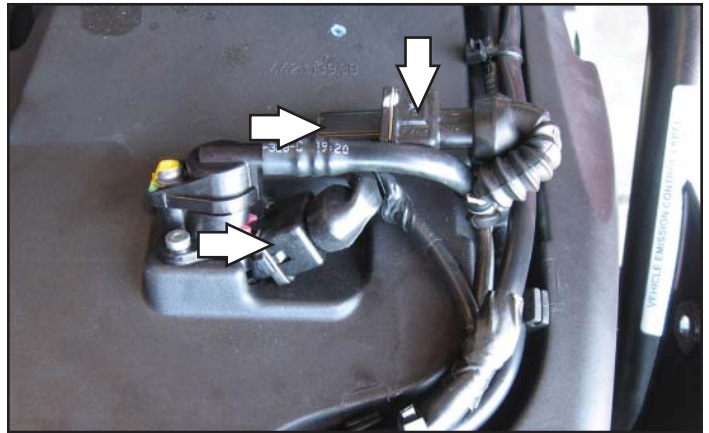

- 7 Remove the right hand side frame cover.

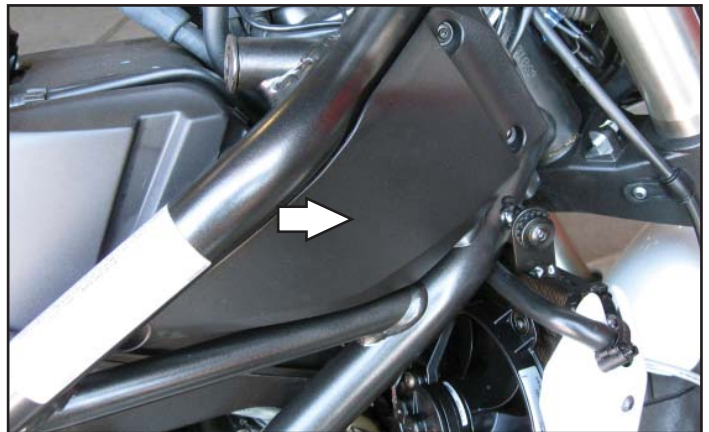

- 8 Remove the inner cover.



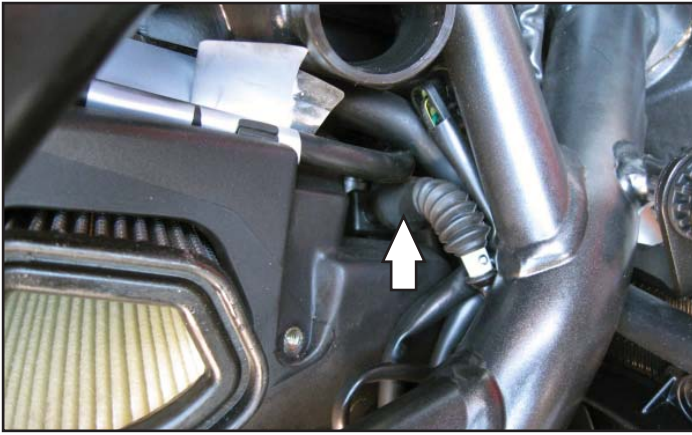

- Unplug the stock wiring harness from the front fuel injector.



- Plug the pair of PC6 leads with ORANGE colored wires in-line of the front fuel injector and the stock wiring harness.



- Locate the Throttle Position Sensor (TPS) on the right hand side of the throttle bodies.
- Using the supplied posi-tap, attach the single unterminated GREY wire from PC6 wiring harness to the stock ORANGE wire of the bike's TPS wiring harness (pin position C).

The wire tap shown is not a posi-tap. This is an older crimp-on style wire tap.

- Attach the ground wire of the PC6 wiring harness with the small ring lug to the engine bolt on the right hand side near the clutch cover.
- Reinstall the covers, the fuel tank, and the seat.

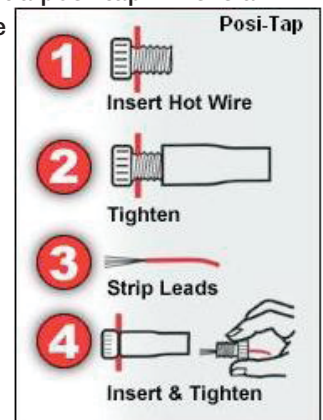

Optional Inputs:

Speed - grey/white wire from speed sensor located above clutch cover

12v Source for Autotune - red wire of 4-pin connector under rear cowling

Download the latest map files from our web site at dynojet.com/tunes.



PUSH THE LIMIT

2191 MENDENHALL DRIVE, NORTH LAS VEGAS, NV 89081 - 800-992-4993 - DYNOJET.COM

© 2012-2022 DYNOJET RESEARCH ALL RIGHTS RESERVED