



# INSTALLATION INSTRUCTIONS

Accessory

QUICK SHIFTER  
P/N 08U70-MKK-D01

Application

After '17 CRF1000L/L2

Publication No.

MII 17436

Issue Date

January 2020

Honda Dealer: Please give a copy of these instructions to your customer.

## PARTS LIST

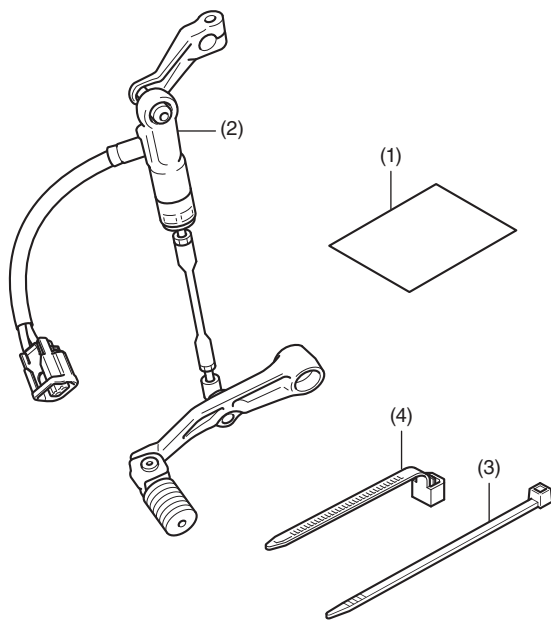

No.	Description	Qty
(1)	Installation Instruction URL	1
(2)	Gear change pedal	1
(3)	Wire tie (long)	4
(4)	Wire tie (short)	1

## TOOL AND SUPPLIES REQUIRED

Snips

Grease

Electrical tape

Ruler

Torque wrench

## TORQUE CHART

Refer to the Service Manual for the torque values of the removed parts.

## INSTALLATION

### ▲ CAUTION

- To prevent burns, allow the engine, exhaust system, radiator, etc., to cool before installing the accessory.

### NOTE:

- Do not disassemble the gear change pedal.
- Disconnect the negative (-) cable from the battery before installing this accessory.
- The memory of the clock will be erased when you disconnect the battery. Reset the clock after reconnecting the battery.
- Cut the wire tie at 5 mm from the lock part after attaching them to the wire harnesses. Do not allow the cut part of the wire tie to interfere with another harness or brake hose.
- Reinstall the removed parts on the motorcycle and make sure that the wires and harnesses are not pinched.
- PCM initialization is necessary after installing this accessory.

1. Remove the tool box and disconnect the negative (-) cable from the battery.

<Left side>

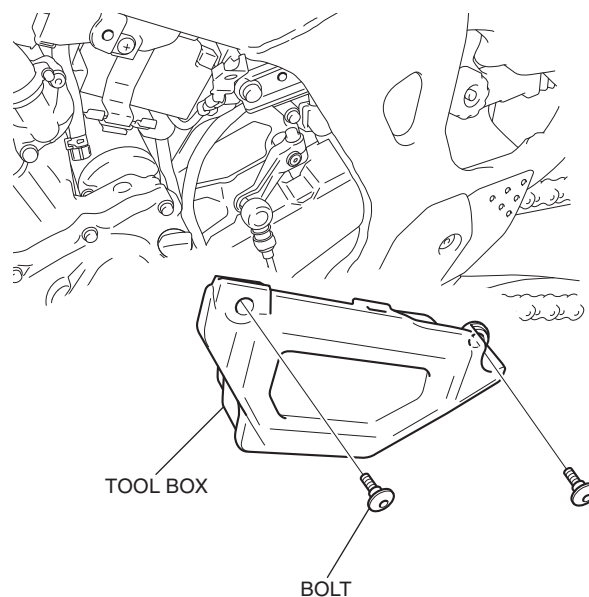

2. Remove the bolts as shown.

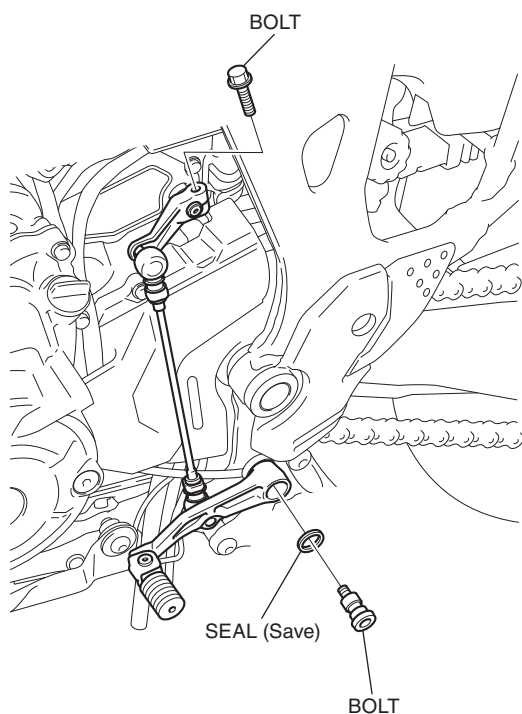

3. Remove the change pedal as shown.

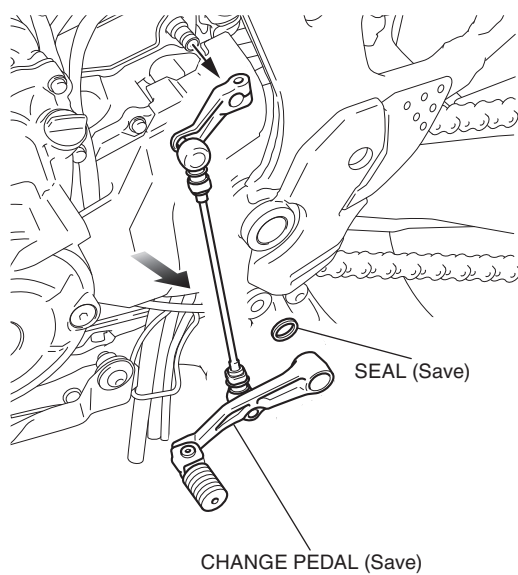

4. Remove the dummy connector as shown.

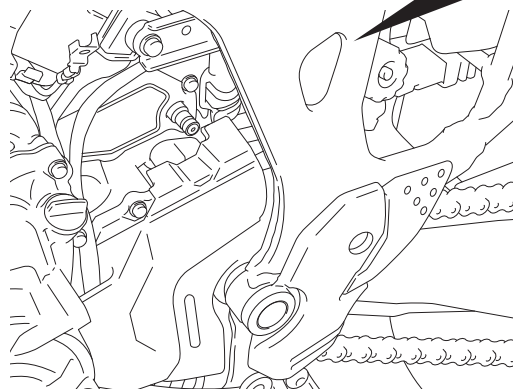
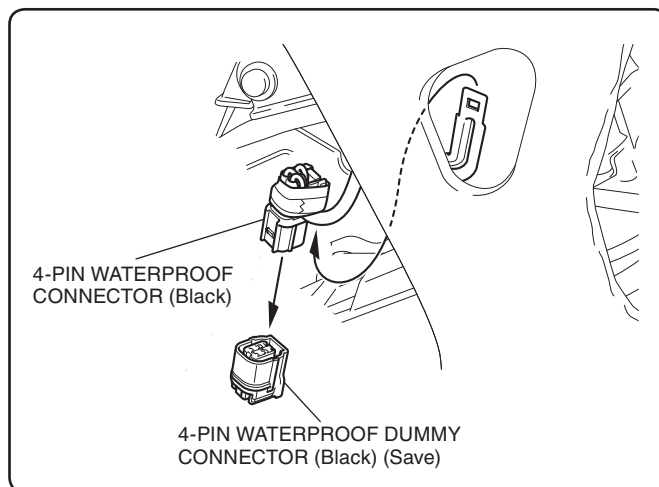

5. Secure the gear change pedal harness in the position of the dimension shown.

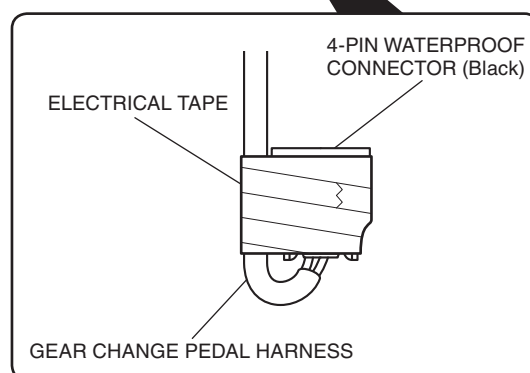
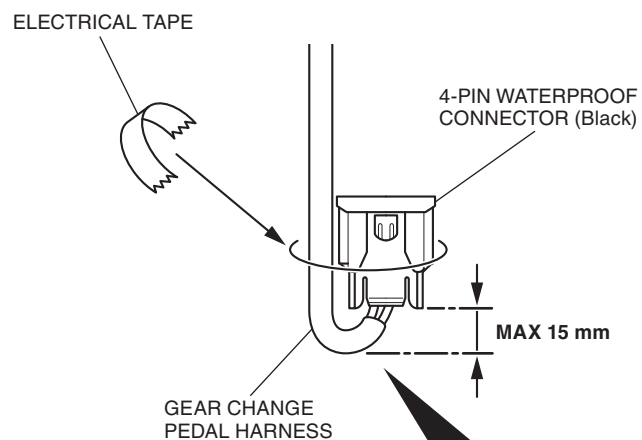

6. Install the gear change pedal as shown.

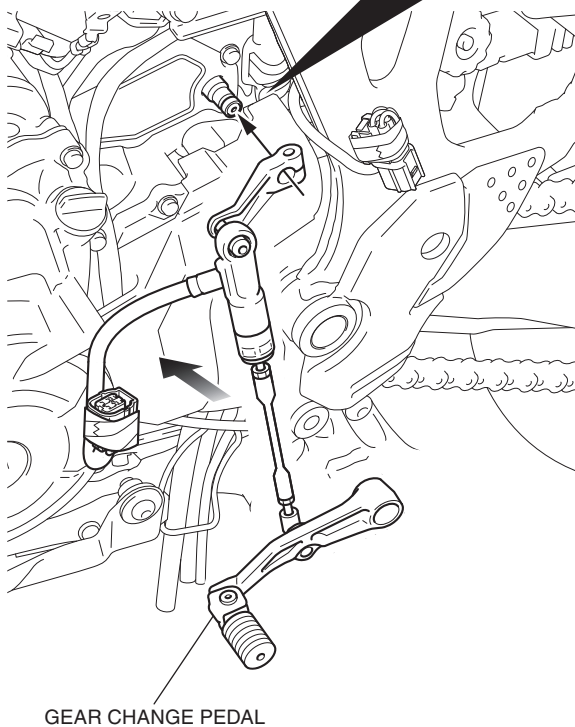
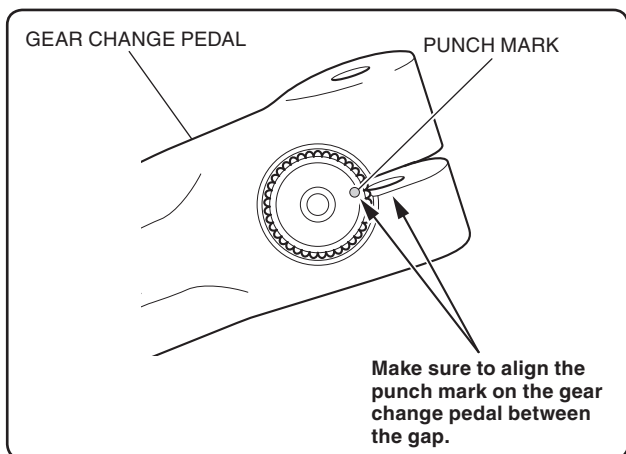

7. Apply grease to the bolt as shown.

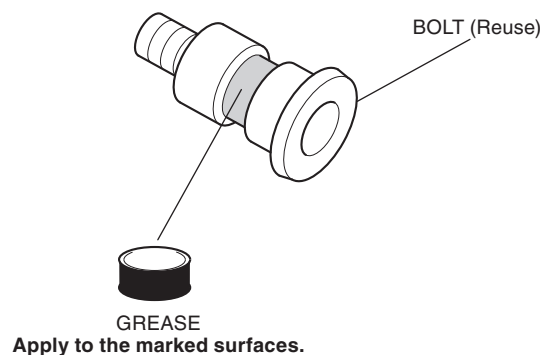

8. Install the bolts as shown.

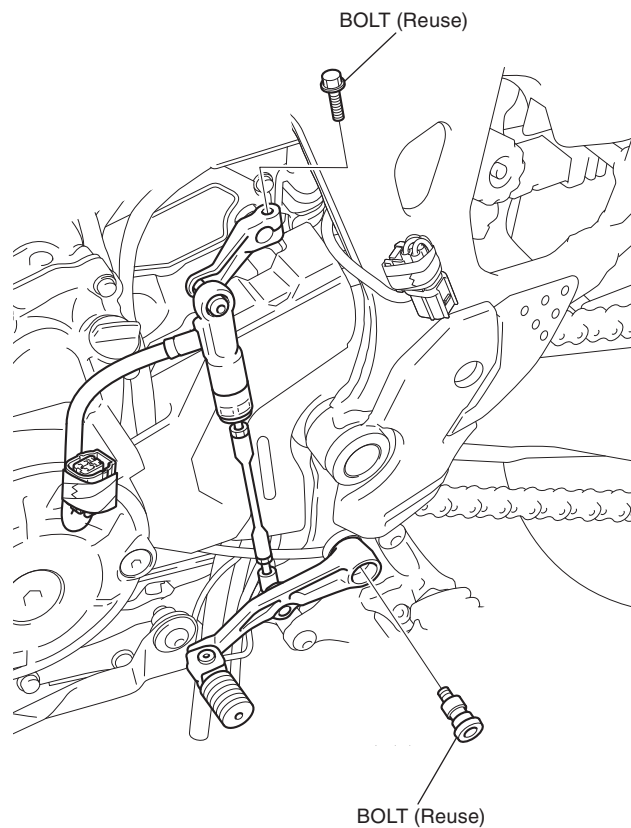

9. Connect the gear change pedal harness as shown.

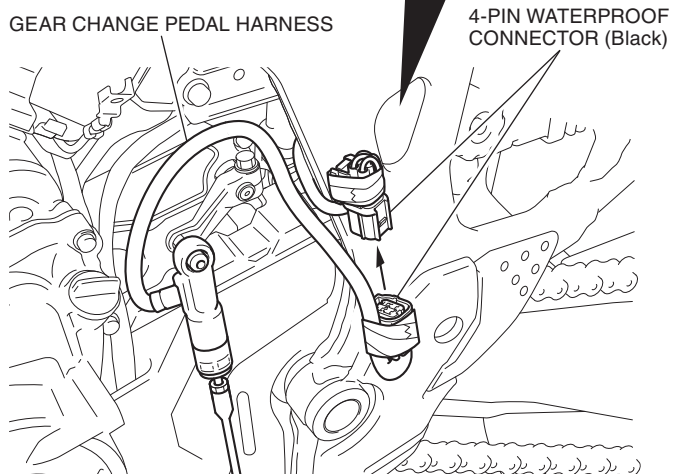
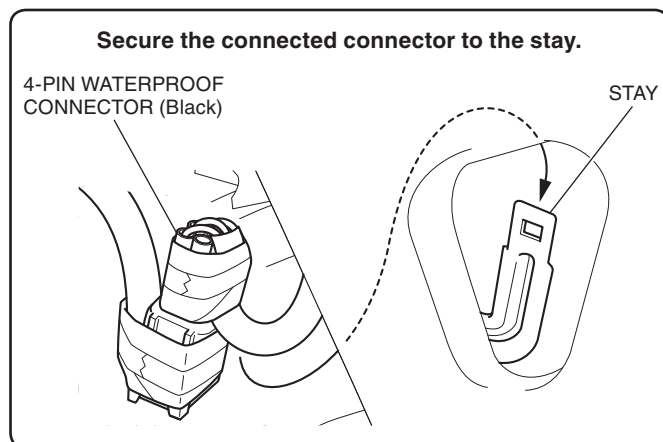

10. Secure the gear change switch harness with the wire ties as shown.

- **Confirm that any wire harness is not caught or too tight.**
- **After installation, check the gear change pedal harness not to interfere with the engine.**

WIRE TIE (long)  
Secure the gear change pedal harness to the motorcycle's harness.

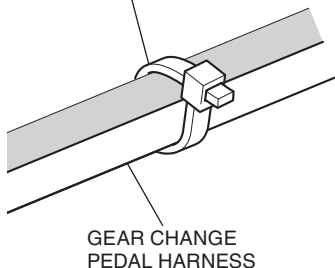

GEAR CHANGE PEDAL HARNESS

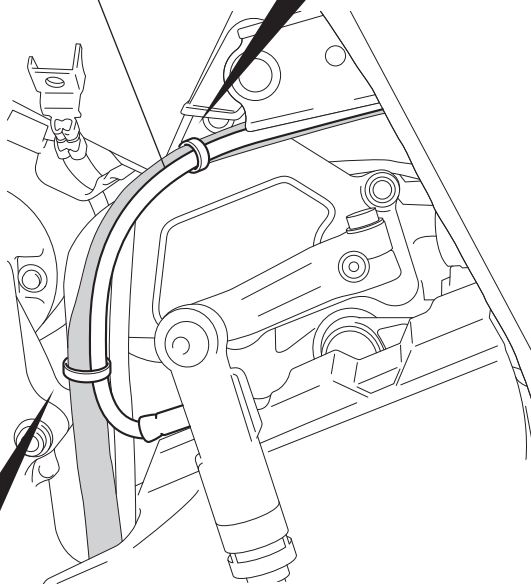

GEAR CHANGE PEDAL HARNESS

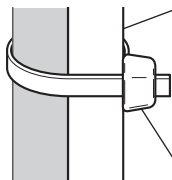

WIRE TIE (long)  
Secure the gear change pedal harness to the motorcycle's harness.

11. Secure the gear change switch harness with the wire tie as shown.

- **Do not cut the excess wire tie end.**

Store the end of wire tie in the gap as shown.

WIRE TIE (short)  
Secure the gear change pedal harness to the motorcycle's harness.

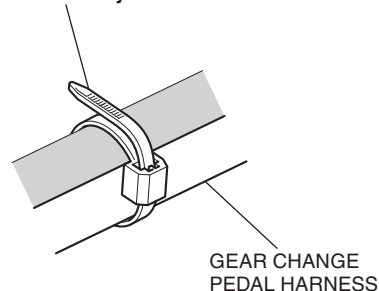

GEAR CHANGE PEDAL HARNESS

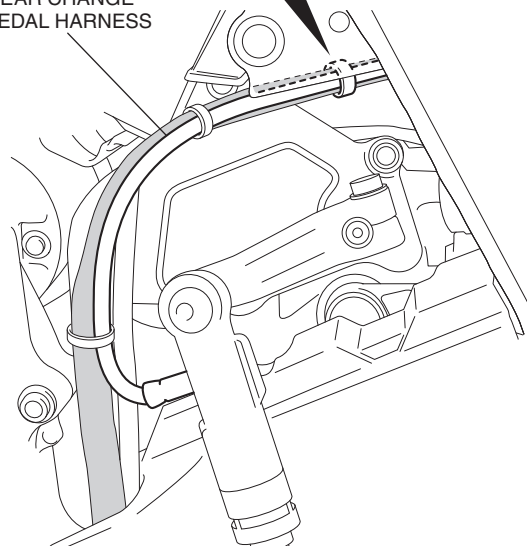

12. Install the motorcycle's parts in the reverse order of removal.

- **Confirm that any wire harness is not caught or too tight.**
- **After installing the quick shifter, perform the initialization.**

13. Check the quick shifter, headlight and the other lights for proper operation.

## INITIALIZATION INSTRUCTIONS

1. Connect the SCS short connector (070PZ-ZY30100) to the DLC.
2. Turn the ignition switch ON and engine stop switch “”.
  - **Do not start the engine.**
3. Push and hold the MODE and SEL▲ or SEL▼ switch.

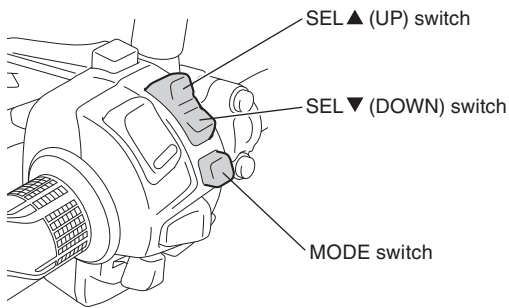

4. Select the “ON”. (After removing the quick shifter, select the “OFF”).
  - **Select the item with SEL▲/SEL▼ switches then decide the item with MODE switch.**



5. Select “YES”.

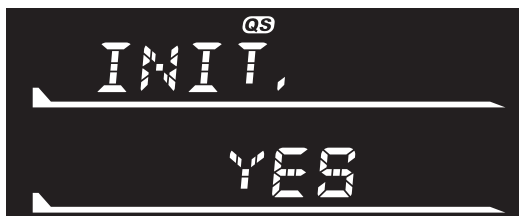

6. The display shows the message the “ENGINE START” then start the engine and let it idle.
  - **Shift the transmission to the neutral position then do not touch the pedal.**
  - **Do not operate the throttle grip.**

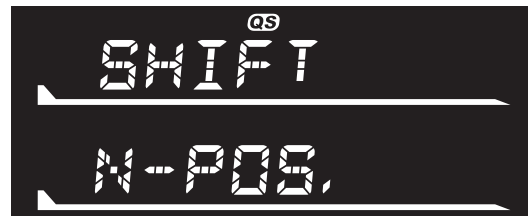
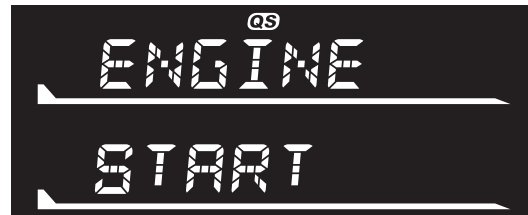

7. Wait for the display to show the message that “OK”.
  - **If the display shows the message “NO”, check the mounting conditions of the shift stroke and shift drum angle sensors, then restart the initialization again.**

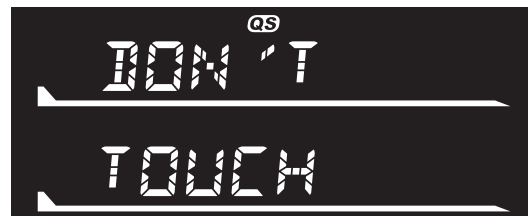

Initialization completion



Initialization failure



8. Turn the ignition switch OFF and remove the SCS short connector.

## **OPERATING INSTRUCTIONS**

This accessory enables up and down gear shifting without using the clutch. (Engine speed is more than 1,600 rpm on upshifting or more than the idle speed on downshifting).

- If there is a problem with the gear position display, the shift feeling may change.
- If the quick shifter does not operate normally, the gear shift can be made by normal clutch operation.

### **NOTE:**

- **To adjust the Quick Shifter UP LVL or DOWN LVL sensitivity, refer to the Genuine Accessory User's Guide.**