

Kawasaki

Assembly Instructions

Part Number	Description	Model	Approx. Assembly Time
99994-0526 99994-0526B	KQR™ Windshield Bracket Kit	Vulcan S EN650A/B/C/D	0.5 hr

Improper installation of this accessory could result in an accident causing serious bodily injury or death. To prevent an accident, be sure that this accessory is properly and securely installed on your vehicle. If you cannot properly install this accessory yourself, have a professional installer, such as an authorized Kawasaki dealer, install it for you.

Prior to each use, check to be sure the accessory is securely attached to the motorcycle and periodically inspect the accessory for any required adjustment, wear, and damage.

Parts List:

Ref. #	Description	Qty
A01	Windshield Bracket, Left	1
A02	Windshield Bracket, Right	1
A03	M6 x 20 mm Cap Screw	4
A04	Windshield Plate	2
A05	Collar, 17.5 mm Dia.	4
A06	Collar, 10 mm Length	4
A07	M6 Lock Washer	4
A08	M6 Cap Nut	4
B01	Windshield (Sold Separately) Large Windshield (99994-0632/K99994-0632) / Medium Windshield (99994-0633/K99994-0633)	-

Parts Diagram:

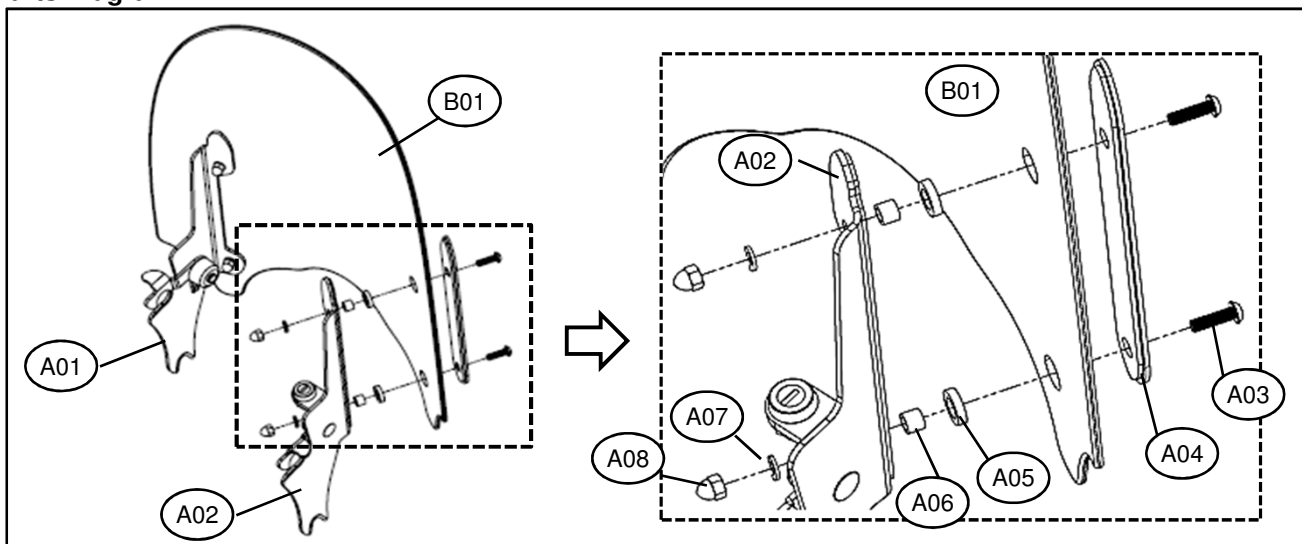

Note: Fitment of KQR™ Windshield Bracket requires prior installation of KQR™ Windshield Bracket Front Fork

(99994-0546).

Installation Instructions:

1. Park the vehicle on level ground and turn off the ignition switch.

2. Lay the windshield (B01) front side down on a soft clean cloth to assist in parts installation. Install the Windshield Bracket, Right (A02) with Windshield Plate (A04), M6 x 20 Cap Screw (A03 x 2) with Collar, 17.5 mm Dia. (A05 x 2) and Collar, 10mm Length (A06 x 2) nested inside the windshield holes, making sure the Collar (A06) is registered in the rubber gaskets on Bracket (A02) and Plate (A04). Now install the M6 Cap Nut (A08 x 2) with M6 Lock Washer (A07 x 2) and tighten the M6 x 20 Cap Screw (A03 x 2) to 7.9 Nm (70 in lb. NOT ft lb).

3. Repeat Step 2 with Windshield Bracket, Left (A01) and remaining parts onto left side of windshield.

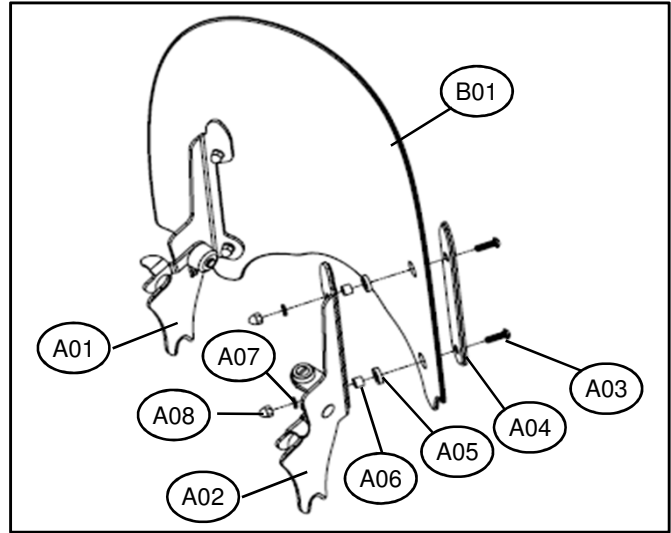

4. Unlock the latch on the Right Windshield Bracket (A02) and remove the key.

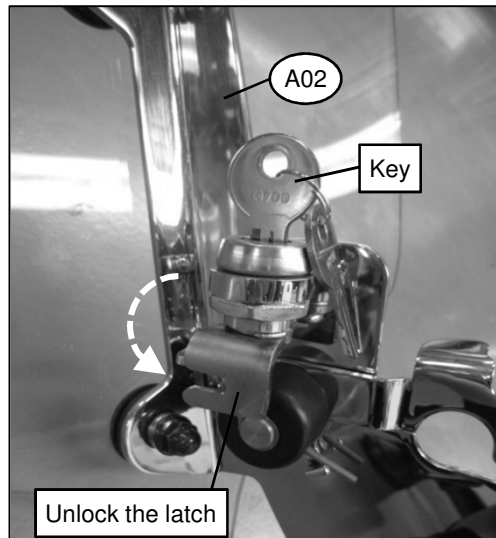

5. Remove the clip from the throttle cables and re-install it at a higher position just above the front fork tube as shown.

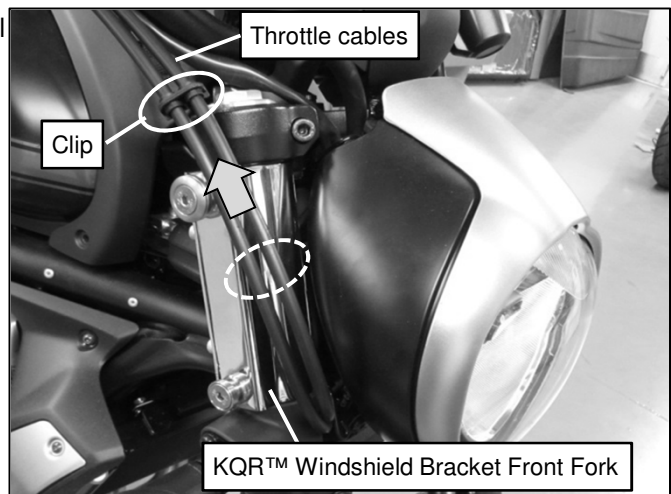

6. Hold the Windshield assembly in both hands with front side toward you and position the lower fork of each Windshield Bracket onto the lower spools of the Windshield Bracket Front Fork (99994-0546) previously installed, then move the upper part of the windshield back until the upper latches contact the upper spools.

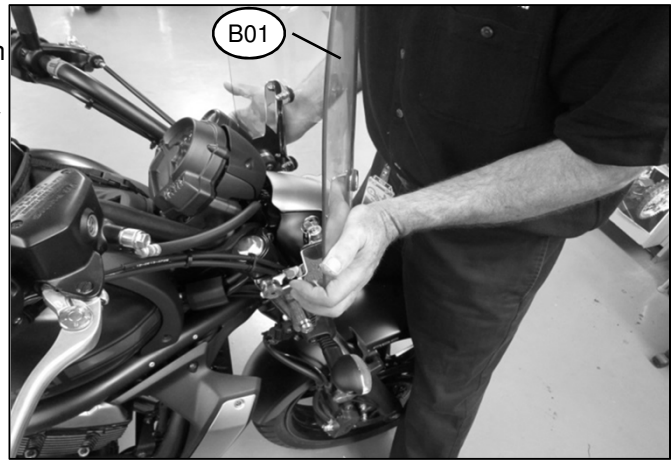

7. Lift up on the spring-loaded Left Latch Lever and Right Latch Lever simultaneously until they clear the upper spools, then press firmly rearward until the latches fully engage the spools on both sides.

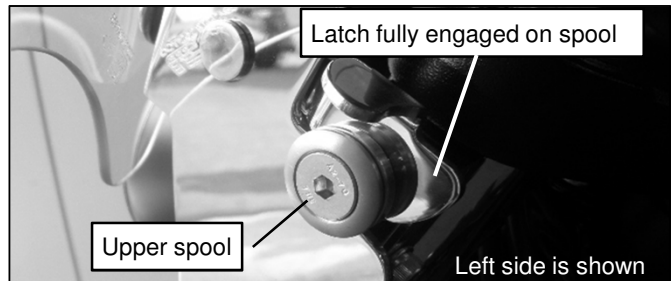
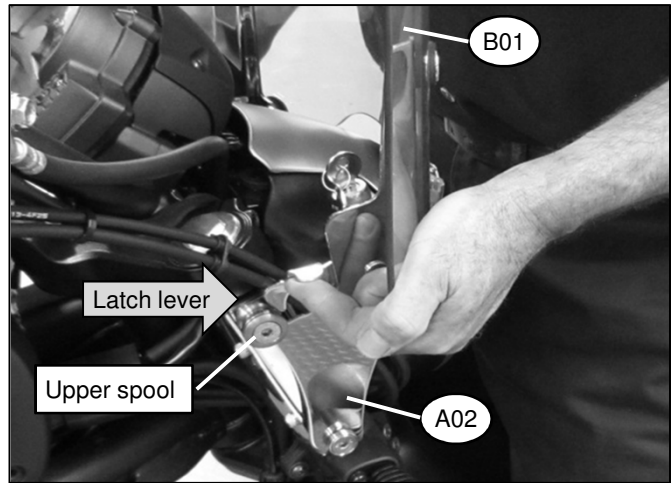

Note: Ensure that the throttle cables are positioned to the inside of the Windshield Bracket, Right (A02) as shown.

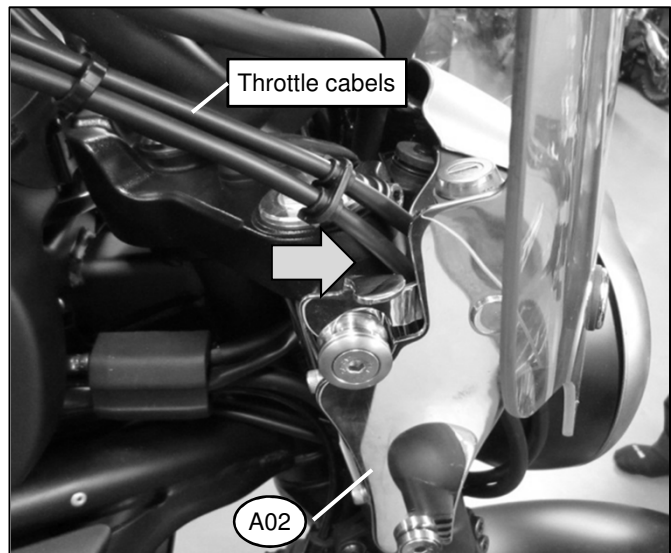

8. To remove windshield, lift up on the spring-loaded Left Latch Lever and Right Latch Lever simultaneously until they clear the upper spools, then pull firmly forward until the latches fully clear the spools and lift the windshield clear of the lower spools.



9. If desired, use the key to lock the Right Latch on the Right Windshield Bracket (A02).

Note: Locking is only required if theft deterrence is needed.

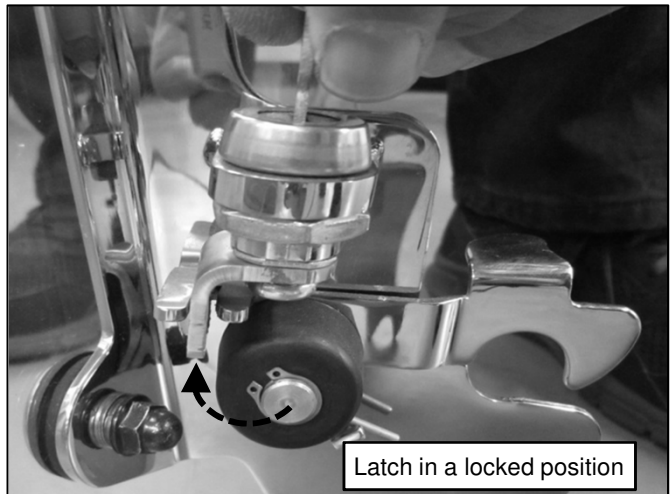

Please check / adjust all screws in regular intervals.