

Barkbusters

www.barkbusters.net

FITTING INSTRUCTIONS for STM-007 with Aluminium Backbone for Handlebar with an Internal Thread

LEFT SIDE

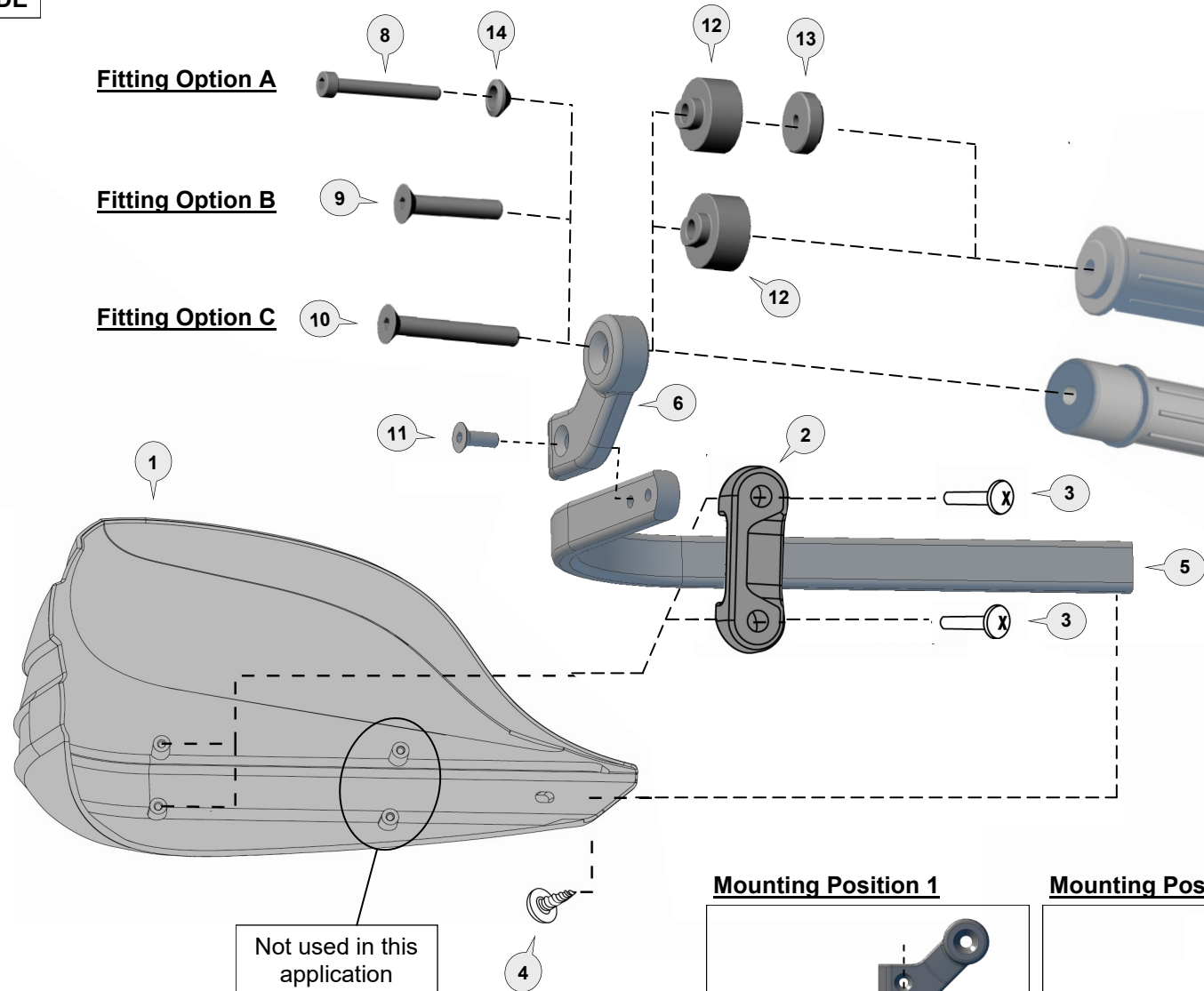

Option A
Handlebars with fixed 6mm internal thread. Triumph models with 5mm thread we recommend to drill and tap to 6mm.

Option B
Handlebars with fixed 8mm internal threads (must remove handlebar end weights). Fits many Kawasaki models with handlebar protruding past the end of the grips when bar end weight is removed.

Option C
Handlebars with fixed 8mm internal thread (must leave handlebar end weight in place). Fits to the end of the handlebar weight on many BMW models.

NOTE:
Some bikes may require a combination of parts from option A,B and C. For additional fitting assistance:
email: info@barkbusters.net

Mounting Position 1

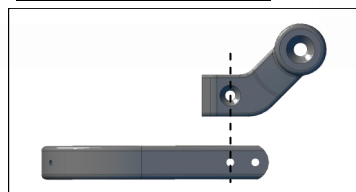

Mounting Position 2

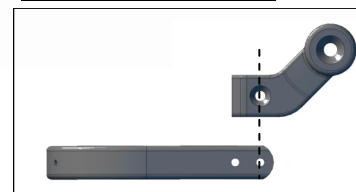

Not used in this application



1 Storm Plastic  PN: SP1 Pcs. 1 Left & 1 Right	2 Saddle  PN: Storm-Saddle Pcs. 2	3 Mush Head Screw  PN: SCREWPT3.5x14 Pcs. 4	4 Black Screw  PN: STSZ811MX11 Pcs. 2	5 Aluminium Bar (Black)  PN: BAR-S-011 Pcs. 2	6 Bar End LEFT  PN: BE-ST-L Pcs. 1	7 Bar End RIGHT  PN: BE-ST-R Pcs. 1	8 Socket Head Bolt 50mm DRI-LOC  PN:M6x50SHCSZP-DL Pcs. 2
9 Flat Head Bolt 40mm DRI-LOC  PN:M8x40FHCSZP-DL Pcs. 2	10 Flat Head Bolt 50mm DRI-LOC  PN:M8x50FHCSZP-DL Pcs. 2	11 Flat Head Bolt 16mm DRI-LOC  PN:M6x16FHCSZP-DL Pcs. 2	12 Locking Adaptor  PN: S7-LA2 Pcs. 2	13 Spacer 12mm  PN: S7-SP12 Pcs. 2	14 Bolt Adaptor  PN: S7-BA Pcs. 2	<p>NOTE: Model STM-007-01-NP does not include Items 1, 2, 3 & 4 Order Code: STM-003</p>	

Personalise Your Protection
 Guard options sold separately

JET	JET-003
VPS	VPS-003
Storm	STM-003
CARBON	BCF-003

Recommended Torque Settings	
M6	10 Nm (7.4 lbf ft)
M8	20 Nm (14.8 lbf ft)

NOTE:
 Thread lock on bolts is for single use ONLY.
 If reinstalling, apply new thread lock.

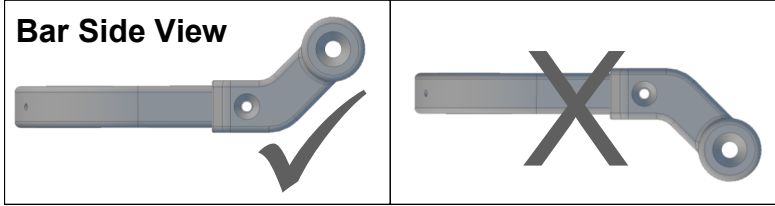

CAUTION:

Installation of the handguard is safety-relevant work and can be complicated. We recommend the installation be performed by a motorcycle service technician. Rideworx accepts no liability for damages caused by improper mounting. All screws, bolts and nuts, including all replacement hardware provided by Rideworx, should be tightened to the torque specified in the table. After the first 50km of riding check all screws, bolts and nuts are tightened to the correct torque. We recommend a medium strength liquid thread lock product on all fasteners.

WARNING:

Check operation of all handlebar controls, specifically the throttle, front brake, kill switch and clutch to ensure they are operating correctly and are in accordance with the OEM specifications. Do not ride the motorcycle if any controls are not operating correctly. Check periodically that all bolts are tight.

Disclaimer:

A failure to follow these fitting instructions could cause serious injury, death or property damage. These handguards are intended solely for use with motorcycles/ATV/snowmobiles/scooters that have not been modified. They are not designed to prevent injury or death while riding or in an accident or crash. The user must ensure that all controls are free of the handguards every time that they ride. By installing and/or using this product you acknowledge that you accept these terms and have followed the fitting instructions.



Phone: +61 (0)2 4271 8244
 Email: info@barkbusters.net
 Web: www.barkbusters.net

