

Kawasaki

Assembly Instructions

Model:	ZX1000W
Description:	Single Seat Cover
Part Number:	99994-0897-□□□ (□□□ is in the color codes.)
Flat Rate Time(Hr):	0.2

Before you begin, read through these instructions and check that all parts are present. Please note that Kawasaki cannot assume any responsibility for damage resulting from incorrect installation. Kawasaki recommends that all genuine accessories should be fitted by an authorized Kawasaki dealer.

Installation of this product will affect the passenger capacity.
Confirm your local regulations before installation.

The following symbol indicates the information for proper installation and operation in this instruction.

NOTE : *NOTE indicates information that may help or guide you in the operation or service of the vehicle.*

- Indicates a procedural step or work to be done.
- Indicates a procedural sub-step or how to do the work of the procedural step it follows. It also precedes the text of a NOTE.

Refer to the Service Manual (P/No.: 99924-1519-01) for detailed procedures.

Parts List				
No.	Component Name	Part No.	Qty	Remarks
1	Single Seat Cover	53065-0041-□□□	1	□□□ is in the color codes.
2	Nut	92210-0277	3	
3	Bracket	11056-2436	1	
4	Damper	92075-1927	4	
5	Bolt	92154-0899	5	M6 × 16
6	Damper	92075-1446	1	
7	Bracket-Lock	32074-0017	1	
8	Cover	14092-0248	1	
9	Collar	92152-0250	2	
10	Damper	92161-1922	2	

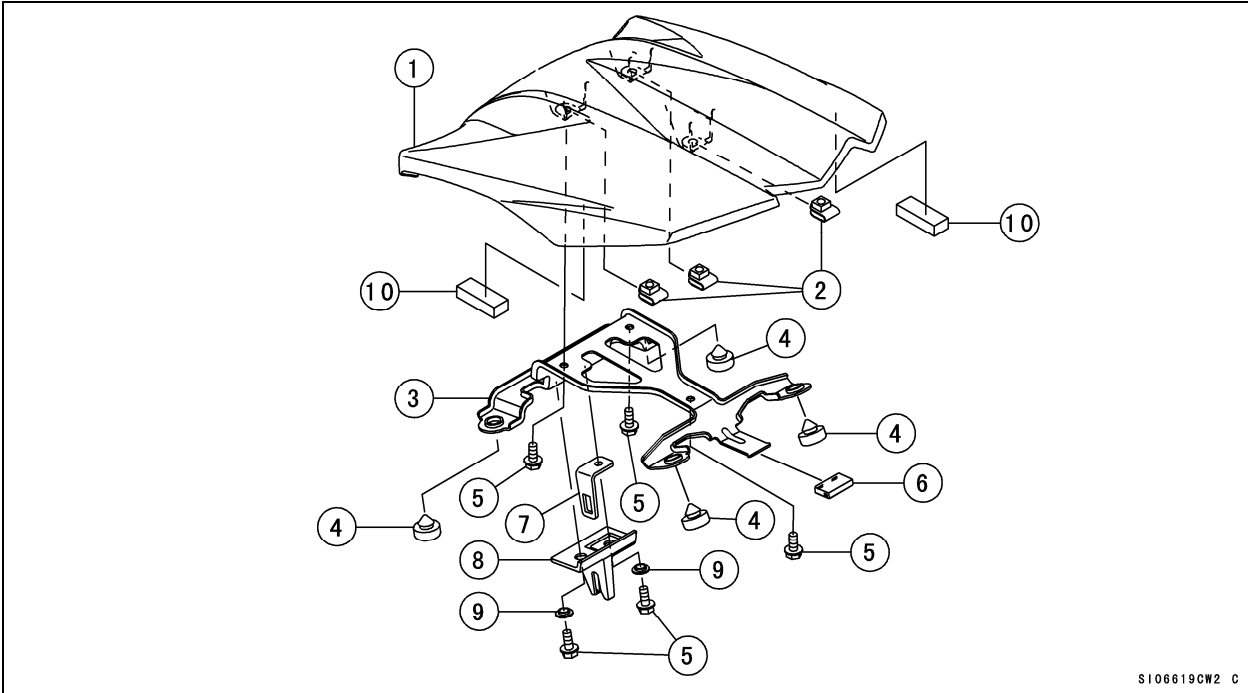

S106619CW2 C

Installation Instructions

Assembly Procedure

NOTE

○ *In order to protect the single seat cover from being damaged, do the work on a soft material such as cloth.*

- Put the single seat cover [1] upside down.
- Using a high flash-point oilless solvent, clean off any oil or dirt that may be on the single seat cover. Dry them with a clean cloth.
- Peel the release papers off the dampers [10] and apply them along the lines [A] on the single seat cover.

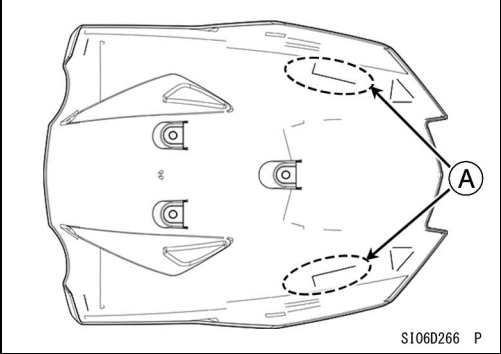
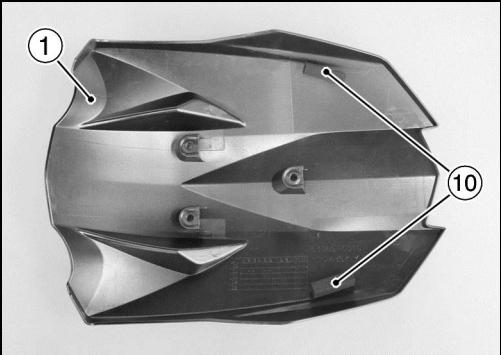

S106D266 P

- Insert the nuts [2] on the single seat cover [1] as shown in the figure.
- The thread side of the nut faces single seat cover.

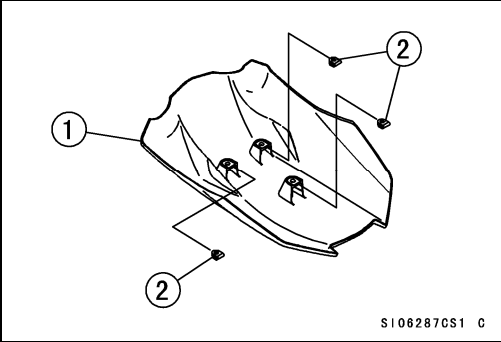

S106287CS1 C

- Install the dampers [4] [6] on the bracket [3] correctly.
- Install the bracket-lock [7], cover [8] and collars [9] on the bracket with the bolts [5]

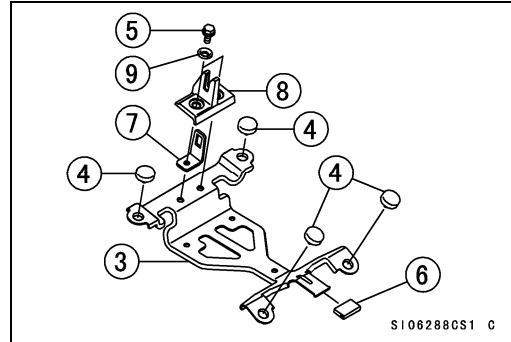

- Install the bracket assy [A] in the single seat cover [1] with the bolts [5].

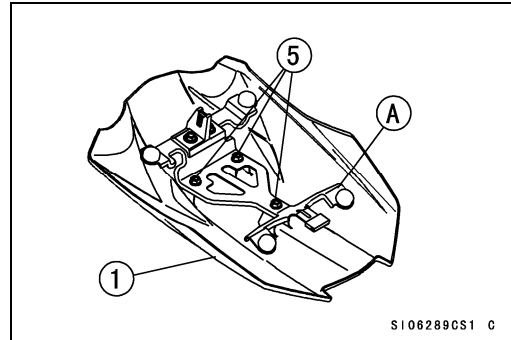

- Insert the ignition switch key [A] into the seat lock.
- Pull up the front part of the rear seat [B] while turning the key clockwise, and remove it forward.

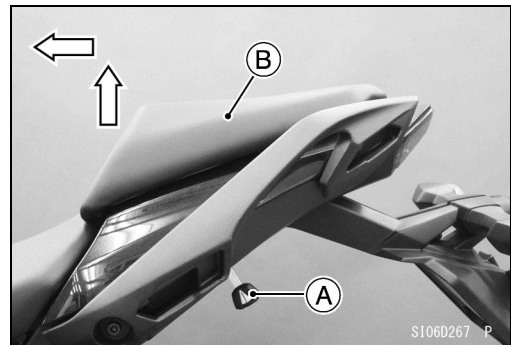

- Insert the hook portion [A] of the bracket assy under the rear frame [B].
- Insert the bracket-lock [7] into the latch hole [C].
- Push down the front part of the single seat cover until the lock clicks.

NOTE

- Pull up the front end of the single seat cover to make sure it is securely locked.
- To remove the single seat cover, pull it forward horizontally.

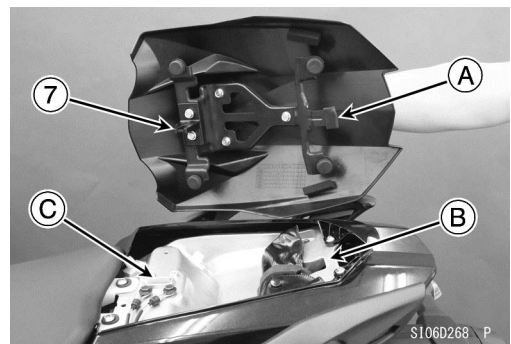

Basic Torque for General Fasteners

The tables below, relating tightening torque to thread diameter, lists the basic torque for the bolts, nuts and screws. Use these tables for the bolts, nuts and screws which are not specified the tightening torque particularly on the previous pages. All of the values are for use with dry solvent-cleaned threads.

For Bolts and Nuts

Threads dia. (mm)	Torque		
	N·m	kgf·m	ft·lb
5	4.5	0.46	40 in·lb
6	8.0	0.82	71 in·lb
8	20	2.0	15
10	35	3.6	26
12	60	6.1	44

For Screws, Plastic Part Tightening Portions and Plastic Washer Tightening Portions

Threads dia. (mm)	Torque		
	N·m	kgf·m	ft·lb
4	1.2	0.12	11 in·lb
5	3.0	0.31	27 in·lb
6	4.0	0.41	35 in·lb

Check tightness of all fasteners in regular interval. Retighten loose fasteners.