

Kawasaki

Assembly Instructions

Model:	KLE650EH/FH
Description:	Grip Heater Kit
Part Number:	99994-0887

Before you begin, read through these instructions and check that all parts are present. Please note that Kawasaki cannot assume any responsibility for damage resulting from incorrect installation.

Kawasaki recommends that all genuine accessories should be fitted by an authorized Kawasaki dealer.

The following symbols indicate the information for proper installation and operation in this instruction.

NOTE : NOTE indicates information that may help or guide you in the operation or service of the vehicle.

- Indicates a procedural step or work to be done.
- Indicates a procedural sub-step or how to do the work of the procedural step it follows. It also precedes the text of a NOTE.

Refer to the Service Manual (P/No.: 99924-1490-03) for detailed procedures.

NOTE

- This kit does not operate if the relay kit is not installed, therefore install the relay kit (see Relay Kit (P/No.:99994-0556) for Assembly Instructions Manual).

Parts List				
No.	Component Name	Part No.	Qty	Remark
1	Heater Switch	27010-0126	1	
2	Plate	11057-0654	1	
3	Screw	92172-0489	2	
4	Collar	92152-0901	1	
5	Collar	92152-0902	1	
6	Bolt	120CB0640	2	
7	Left Grip Heater	46075-0101	1	
8	Right Grip Heater	46075-0102	1	
9	Band	92072-1195	1	
10	Sub-harness	26031-0971	1	
11	Band	92072-1197	1	Unused
12	Clamp	92072-1414	2	Unused

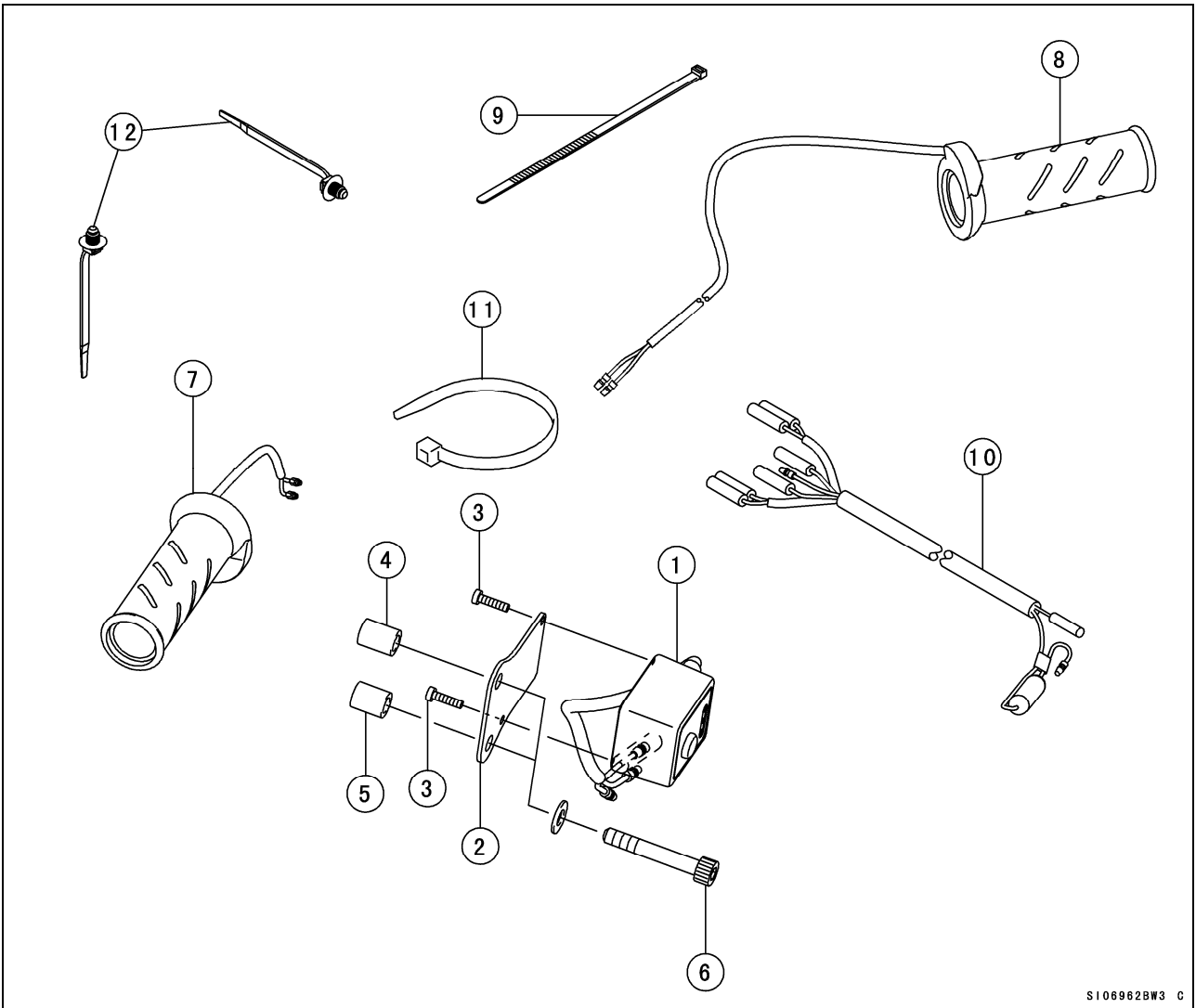

S106962BW3 C

Installation Instructions

Assembly Procedure

- Remove the following parts (Refer to the Service Manual).
 - Middle Fairing
 - Fuel Tank
 - Handlebar Grip
 - Left Rear View Mirror

- Assemble:
 - Heater Switch [1]
 - Plate [2]
- Tighten the screws [3] securely.

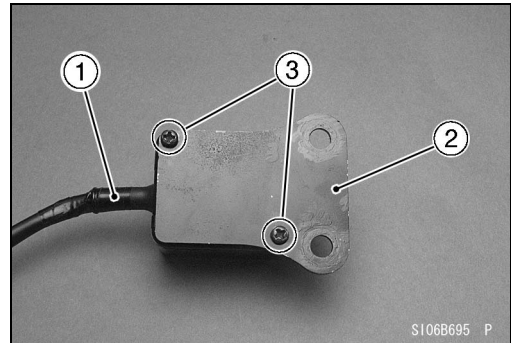

- Remove:
 - Clutch Lever Clamp Bolts [A]
 - Washers

NOTE

- This washers are necessary for this accessory.

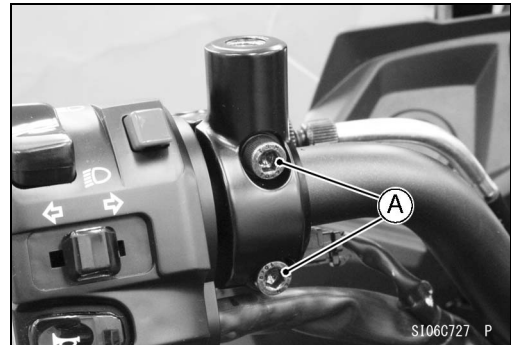

- Install:
 - Collar [4] (L = 14 mm)
 - Collar [5] (L = 13 mm)
 - Heater Switch Assembly [A]
 - Washers [B]
 - Bolts [6]

- The washers are original installed parts.

Torque – Clutch Lever Clamp Bolts: 7.8 N·m (0.80 kgf·m, 69 in·lb)

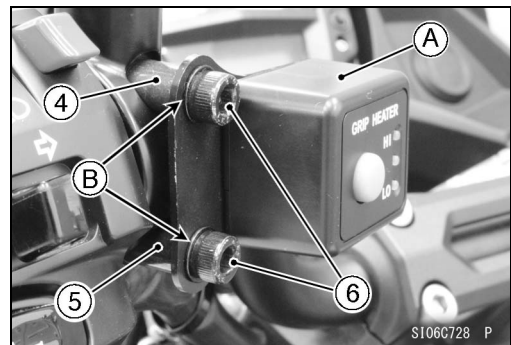

- Install the clutch lever so that the mating surface [A] of the clutch lever clamp is aligned with the punch mark [B].
- Tighten the upper clamp bolt first, and then the lower clamp bolt. There will be a gap at the lower part of the clamp after tightening.

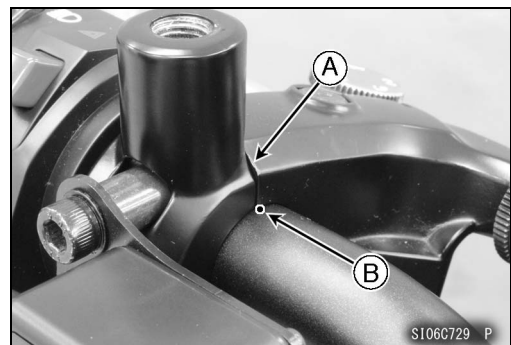

- Using a cleaning fluid, clean off any oil or dirt on the handlebar [A] and inside of the left grip heater [7].
- Apply thin coat of heat resistant adhesive to the handlebar end [B] and the inside rib [C] of the left grip heater.

Sealant – Adhesive, TB1530C: 56042-0001

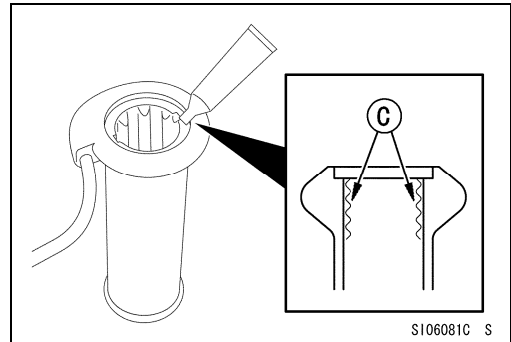
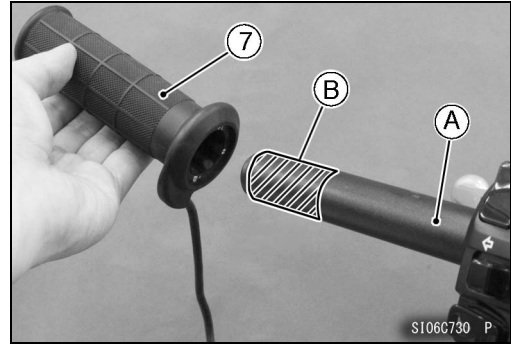

- Insert the left grip heater [7] onto the handlebar so that the harness come to the bottom side [A] of handlebar.

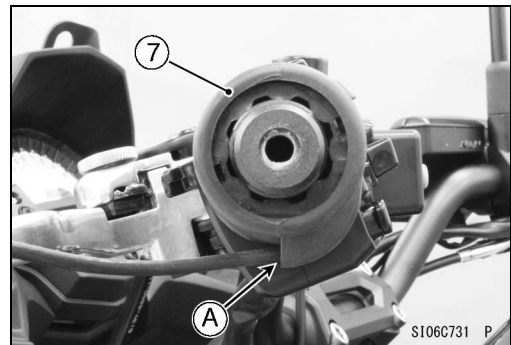

- Using a cleaning fluid, clean off any oil or dirt on the inner grip [A] and inside of the right grip heater [8].
- Apply thin coat of heat resistant adhesive to the inner grip surface.

Sealant – Adhesive, TB1530C: 56042-0001

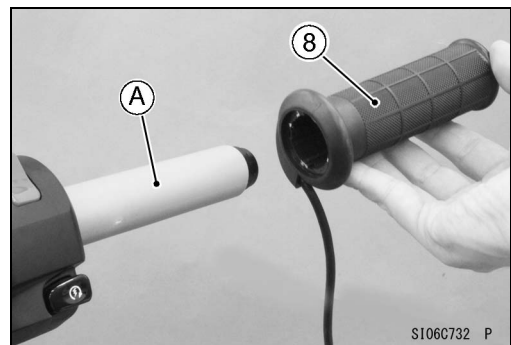

- Insert the right grip heater [8] onto the handlebar so that the harness come to the top side [A] of handlebar.

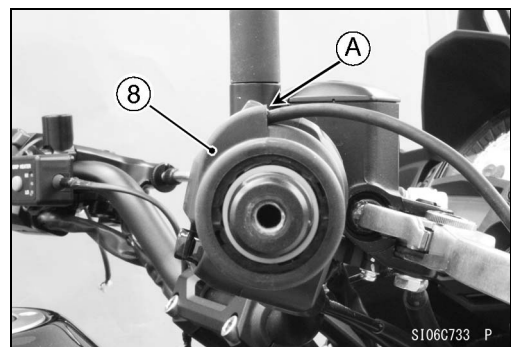

- Run the sub-harness [10] into the guide [A].
- Run the sub-harness [10] to the inside of the clutch cable [B].
- Run the sub-harness [10] in back of the ignition switch lead [C].

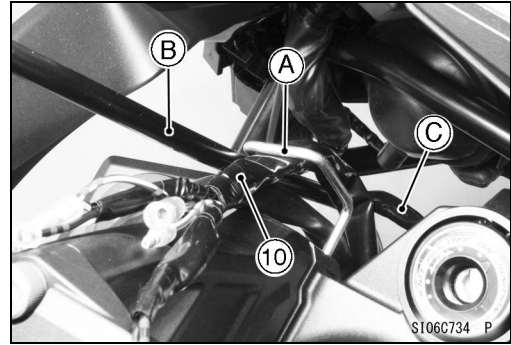

- Run the sub-harness [10] into the guide [A].
- Run the sub-harness [10] above the clutch cable [B].
- Run the sub-harness [10] under the frame [C].

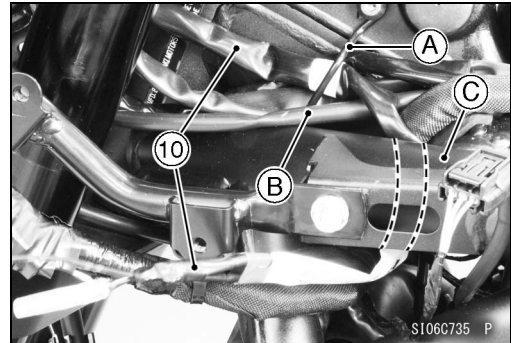

- Hold the right grip heater lead [A] with the band [9].
Lead Length [B]: 140 mm (5.51 in.)

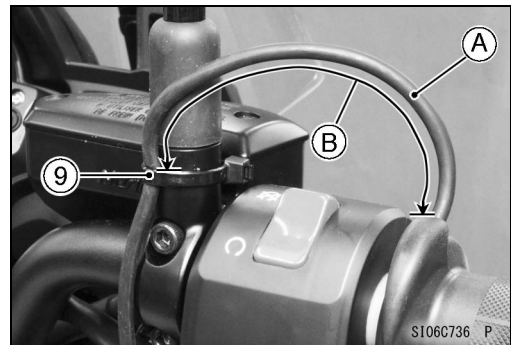

- Hold the right grip heater lead [A] and right switch housing lead [B] with the clamp [C].
- Connect the sub-harness connectors [D] to the right grip heater connectors as follows.
Right Grip Heater [8]
Sub-harness [10]
- Wrap the connectors with the available tape.

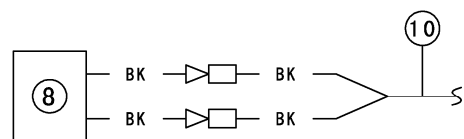
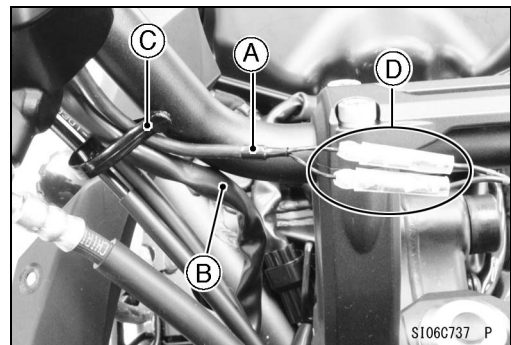

S106383CS1 C

- Hold the left grip heater lead [A], left switch housing lead [B] and heater switch lead [C] with the clamp [D].
- Connect the sub-harness connectors [E] to the left grip heater connectors and heater switch connectors as follows.
 - Heater Switch [1]
 - Left Grip Heater [7]
 - Sub-harness [10]
- Wrap the connectors with the available tape.

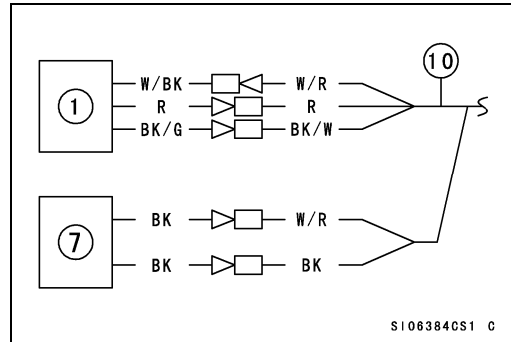
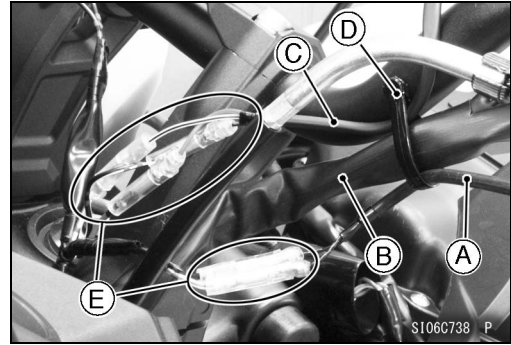

- Connect the sub-harness connectors [A] to the main harness connectors.
- Place the fuse [B] above the sub-harness [10].
- Wrap the fuse and connectors with the available tape.

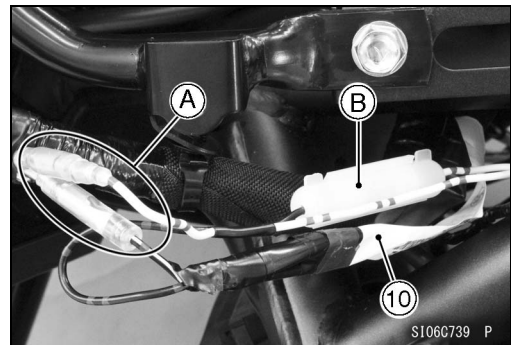

- Turn the ignition switch to "ON".
- ★ If the heater switch indicator light does not go on, inspect the installation condition of parts.
- Install the removed parts (Refer to the Service Manual).

Wiring Diagram

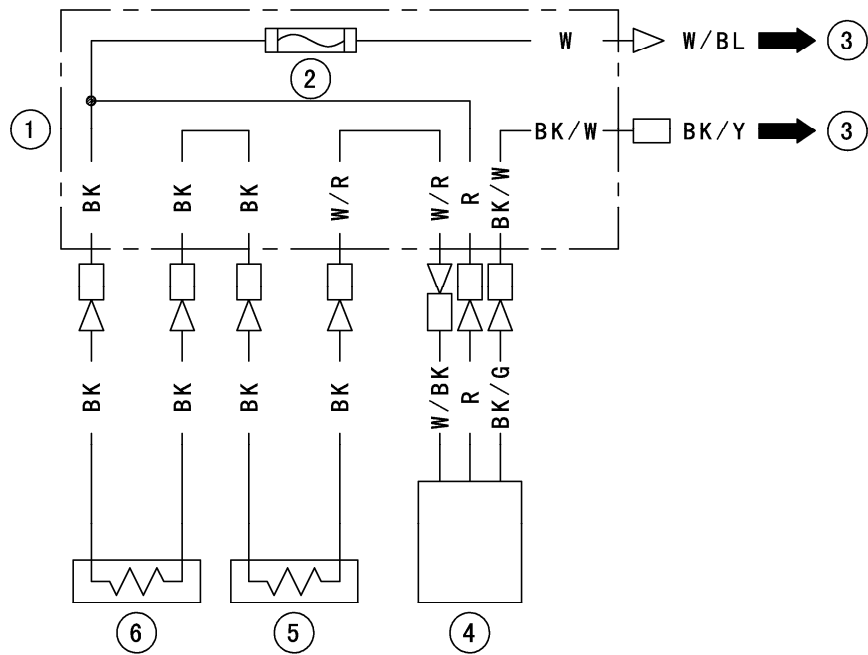

S106988BW2 C

1. Sub-harness
2. Fuse 2 A
3. To Main Harness
4. Heater Switch
5. Left Grip Heater
6. Right Grip Heater

Please check / adjust all screws in regular intervals.

This grip heater is rated at 18 W.

When the grip heater is used at an ambient temperature of 15°C (59°F) or below , use of other accessories with electrical load capacity specified in the owner's manual of the vehicle will be allowed.

NOTICE

Please refer to the Operating Manual (Part No. 99958-0015) for operating procedures.

Basic Torque for General Fasteners

The table below, relating tightening torque to thread diameter, lists the basic torque for the bolts and nuts. Use this table for only the bolts and nuts which do not require a specific torque value. All of the values are for use with dry solvent-cleaned threads.

Threads dia. (mm)	Torque		
	N·m	kgf·m	ft·lb
5	3.4 ~ 4.9	0.35 ~ 0.50	30 ~ 43 in·lb
6	5.9 ~ 7.8	0.60 ~ 0.80	52 ~ 69 in·lb
8	14 ~ 19	1.4 ~ 1.9	10 ~ 13.5
10	25 ~ 34	2.6 ~ 3.5	19 ~ 25
12	44 ~ 61	4.5 ~ 6.2	33 ~ 45
14	73 ~ 98	7.4 ~ 10.0	54 ~ 72
16	115 ~ 155	11.5 ~ 16.0	83 ~ 115
18	165 ~ 225	17.0 ~ 23.0	125 ~ 165
20	225 ~ 325	23.0 ~ 33.0	165 ~ 240