

## Assembly Instructions

Model:	EN650C/D/E
Description:	Windshield Bracket
Part Number:	99994-0825
Flat Rate Time(Hr):	0.1

**Before you begin, read through these instructions and check that all parts are present. Please note that Kawasaki cannot assume any responsibility for damage resulting from incorrect installation. Kawasaki recommends that all genuine accessories should be fitted by an authorized Kawasaki dealer.**

The following symbols indicate the information for proper installation and operation in this instruction.

**NOTE** : *NOTE indicates information that may help or guide you in the operation or service of the vehicle.*

- Indicates a procedural step or work to be done.
- Indicates a procedural sub-step or how to do the work of the procedural step it follows. It also precedes the text of a NOTE.

Refer to the Service Manual (P/No.: 99924-1515-01) for detailed procedures.

### NOTE

- *This kit can not install if the windshield bracket (Front Fork) kit is not installed, therefore install the windshield bracket (Front Fork) kit (see Windshield Bracket (Front Fork) Kit (P/No.:99994-0824) for Assembly Instructions Manual).*

Parts List				
No.	Component Name	Part No.	Qty	Remark
1	Bracket	11057-0212	1	Left
2	Bracket	11057-0213	1	Right
3	Damper	92161-1862	2	
4	Plate	13272-2181	2	
5	Collar	92152-2261	4	
6	Bolt	92154-0787	4	M6 × 22 mm (0.9 in.)
7	Bolt	92154-1032	4	M8 × 14 mm (0.6 in.)
8	Damper	92161-1863	1	Left
9	Damper	92161-1864	1	Right
10	Nut	92210-0322	4	

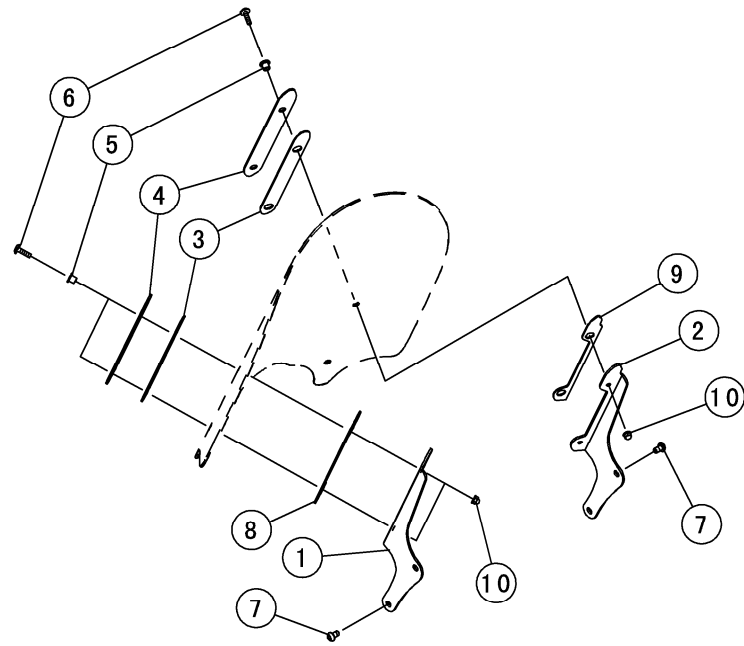

S106628CW2 C

## Installation Instructions

- Paste the dampers [3] on the plates [4] as shown.

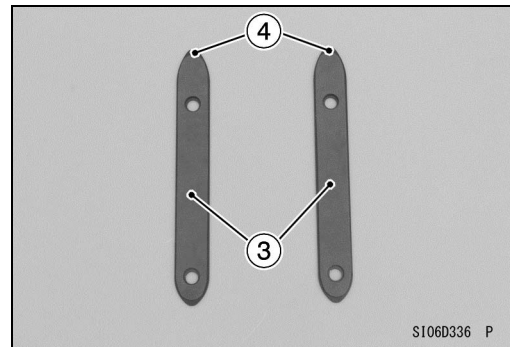

- Paste the dampers [8] [9] on the brackets [1] [2] as shown.

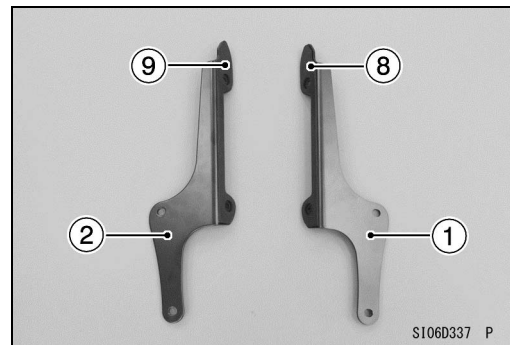

- Install the brackets [1] [2], and temporary tighten the bolts [7].

### NOTE

- Take care not to pinch the cables.

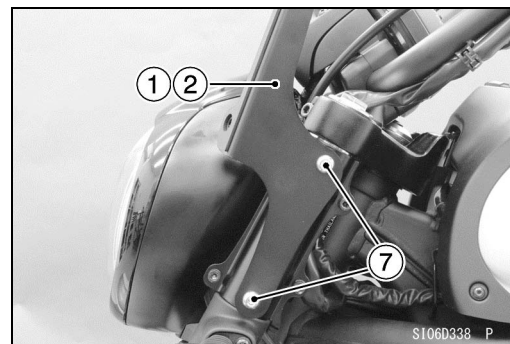

- Install:  
Windshield [A]  
plates [4]  
Collars [5]  
Bolts [6]  
Nuts [10]

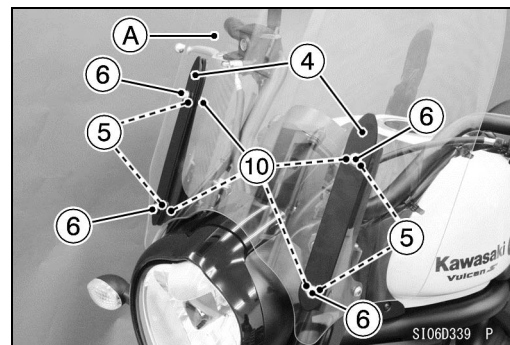

- Tighten the bolts [7] at both sides while pushing the top [A] of the windshield forward.
- Tighten the upper bolts first.

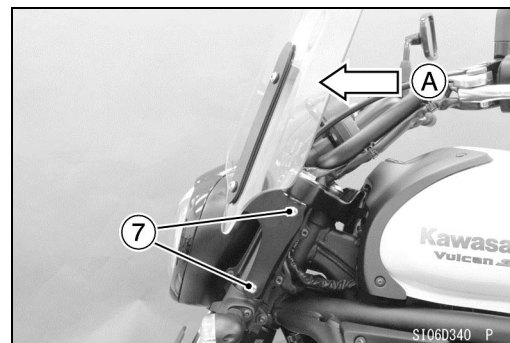

### Basic Torque for General Fasteners

The tables below, relating tightening torque to thread diameter, lists the basic torque for the bolts, nuts and screws. Use these tables for the bolts, nuts and screws which are not specified the tightening torque particularly on the previous pages. All of the values are for use with dry solvent-cleaned threads.

#### For Bolts and Nuts

Threads dia. (mm)	Torque		
	N·m	kgf·m	ft·lb
5	4.5	0.46	40 in·lb
6	8.0	0.82	71 in·lb
8	20	2.0	15
10	35	3.6	26
12	60	6.1	44

**Check tightness of all fasteners in regular interval. Retighten loose fasteners.**