

Assembly Instructions

Model:	ER650G/H, EX650J/K
Description:	Topcase Bracket
Part Number:	99994-0799
Flat Rate Time(Hr):	0.2

Before you begin, read through these instructions and check that all parts are present. Please note that Kawasaki cannot assume any responsibility for damage resulting from incorrect installation.

Kawasaki recommends that all genuine accessories should be fitted by an authorized Kawasaki dealer.

The following symbols indicate the information for proper installation and operation in this instruction.

NOTE : NOTE indicates information that may help or guide you in the operation or service of the vehicle.

● Indicates a procedural step or work to be done.

○ Indicates a procedural sub-step or how to do the work of the procedural step it follows. It also precedes the text of a NOTE.

Refer to the following Service Manual for detailed procedures.

ER650G/H: P/No.: 99924-1516-01

EX650J/K: P/No.: 99924-1517-01

Parts List				
No.	Component Name	Part No.	Qty	Remark
1	Stay	35063-1353	1	Left
2	Stay	35063-1354	1	Right
3	Carrier	53029-0353	1	
4	Bolt	92150-1747	4	M10 × 25 mm (1.0 in.)
5	Bolt	130CA0835	4	M8 × 35 mm (1.4 in.)
6	Collar	92152-2285	2	L = 13.3 mm (0.5 in.)
7	Collar	92152-2234	2	L = 19 mm (0.8 in.)
8	Collar	92152-2235	2	L = 16.7 mm (0.7 in.)
9	Bolt	130CB0625	4	M6 × 25 mm (1.0 in.)

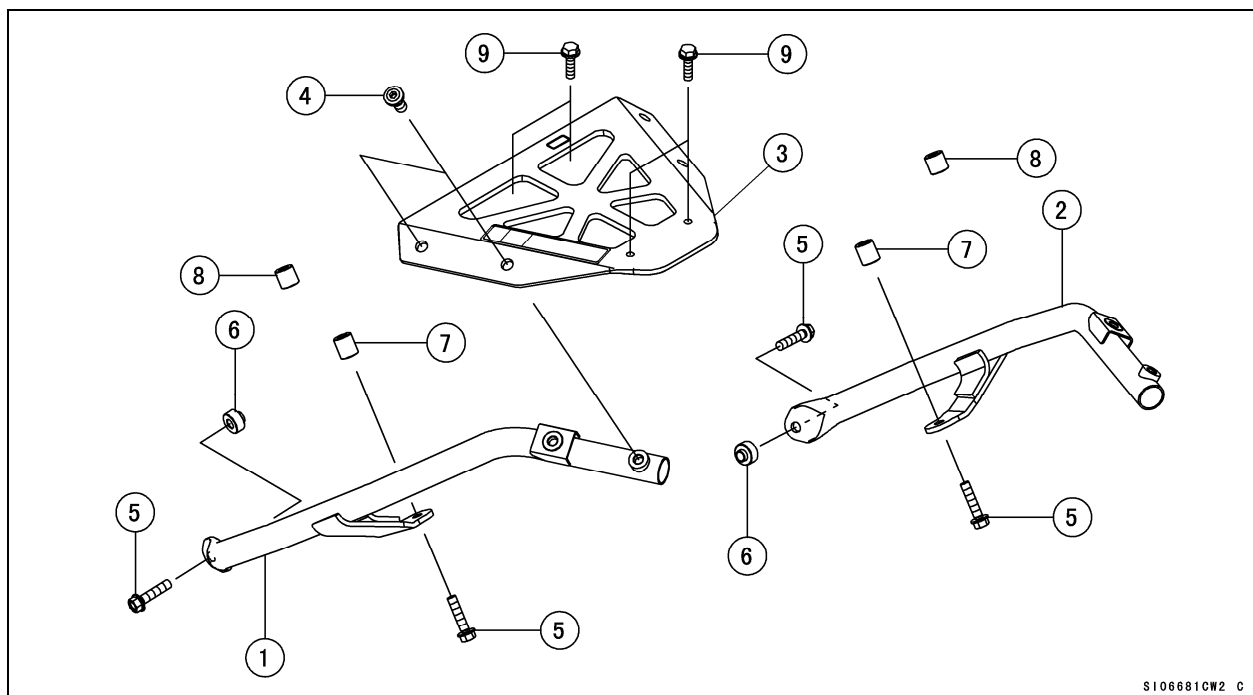

S106681CW2 C

Installation Instructions

- Remove (both sides):
Plugs [A]
Bolts [B]

NOTE

- *The removed parts are not necessary for this accessory.*

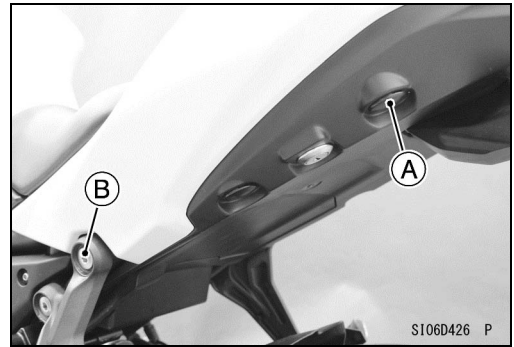

- Install the collars [6] so that the flat face outward (both sides).

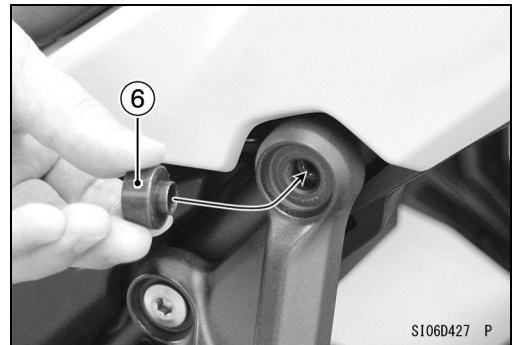

- Install (both sides):
Bracket [1] [2]
Collars [7]

NOTE

- *When installed the U-Lock Bracket kit use the collars [8] without using the collars [7] (both sides).*

- Temporary tighten the bolts [5] (both sides).
- Install the carrier [3], and tighten the bolts [4].

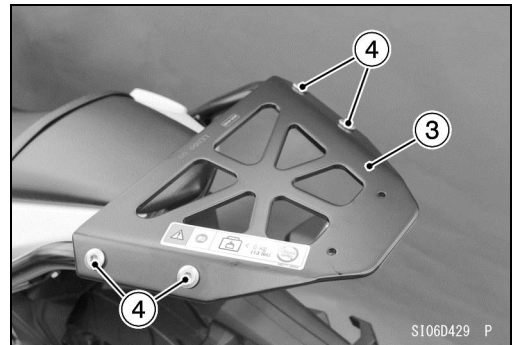
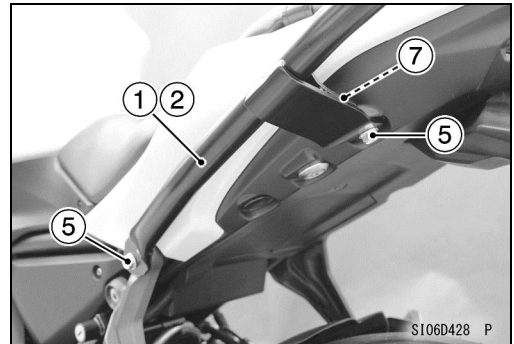

- Tighten the bolts [5] securely (both sides).

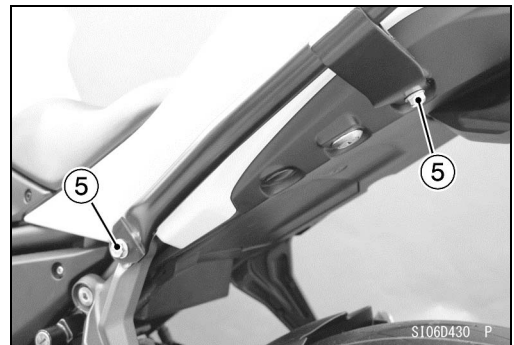

- Install the base plate [A].
- Align the long holes of plates [B] so that it becomes the center of the holes as shown.

NOTE

- The base plate [A] and plates [B] are sold separately.

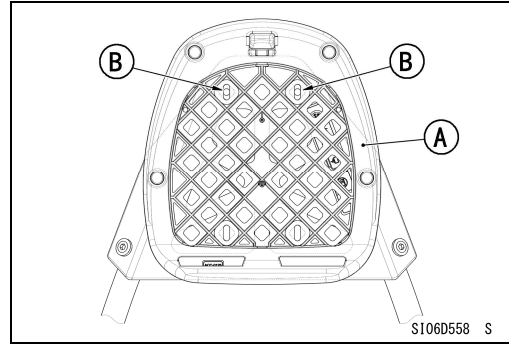

- Position of the bolts [9] when mounting the base plate for the top case is as shown.

Viewed from Top [A]
Viewed from Bottom [B]

NOTE

- Do not use the bolts supplied with the top case kit.

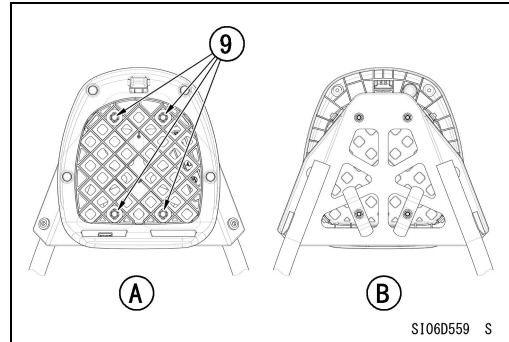

Basic Torque for General Fasteners

The table below, relating tightening torque to thread diameter, lists the basic torque for the bolts and nuts. Use this table for only the bolts and nuts which do not require a specific torque value. All of the values are for use with dry solvent-cleaned threads.

Threads dia. (mm)	Torque		
	N·m	kgf·m	ft·lb
5	3.4 ~ 4.9	0.35 ~ 0.50	30 ~ 43 in·lb
6	5.9 ~ 7.8	0.60 ~ 0.80	52 ~ 69 in·lb
8	14 ~ 19	1.4 ~ 1.9	10 ~ 13.5
10	25 ~ 34	2.6 ~ 3.5	19 ~ 25
12	44 ~ 61	4.5 ~ 6.2	33 ~ 45
14	73 ~ 98	7.4 ~ 10.0	54 ~ 72
16	115 ~ 155	11.5 ~ 16.0	83 ~ 115
18	165 ~ 225	17.0 ~ 23.0	125 ~ 165
20	225 ~ 325	23.0 ~ 33.0	165 ~ 240

Check tightness of all fasteners in regular interval. Retighten loose fasteners.