

## Assembly Instructions

Model:	KLE650E/F
Description:	Top Case Bracket
Part Number:	99994-0842

Before you begin, read through these instructions and check that all parts are present. Please note that Kawasaki cannot assume any responsibility for damage resulting from incorrect installation.

Kawasaki recommends that all genuine accessories should be fitted by an authorized Kawasaki dealer.

The following symbols indicate the information for proper installation and operation in this instruction.

NOTE : NOTE indicates information that may help or guide you in the operation or service of the vehicle.

● Indicates a procedural step or work to be done.

○ Indicates a procedural sub-step or how to do the work of the procedural step it follows. It also precedes the text of a NOTE.

Refer to the Service Manual (P/No.: 99924-1490-01) for detailed procedures.

Parts List				
No.	Component Name	Part No.	Qty	Remark
1	Stay	35063-0972	1	Right
2	Stay	35063-0971	1	Left
3	Collar	92152-2134	2	
4	Washer	410AA1000	2	OD = 18, t = 1.6
5	Bolt	92172-0269	2	M8 × 26
6	Bolt	92154-0077	2	M8 × 23
7	Bracket	11056-7240	1	
8	Bracket	11056-7239	1	
9	Damper	92161-0766	2	
10	Washer	92200-0414	4	OD = 20, t = 1
11	Damper	92161-1750	4	OD = 20, t = 2
12	Washer	92022-1346	4	OD = 20, t = 1.6
13	Bolt	92154-0856	4	M6 × 14
14	Bolt	92153-1792	4	M6 × 22
15	Damper	92161-1751	4	OD = 26, t = 2
16	Washer	92200-1697	4	OD = 26, t = 1.5
17	Collar	92152-1983	4	

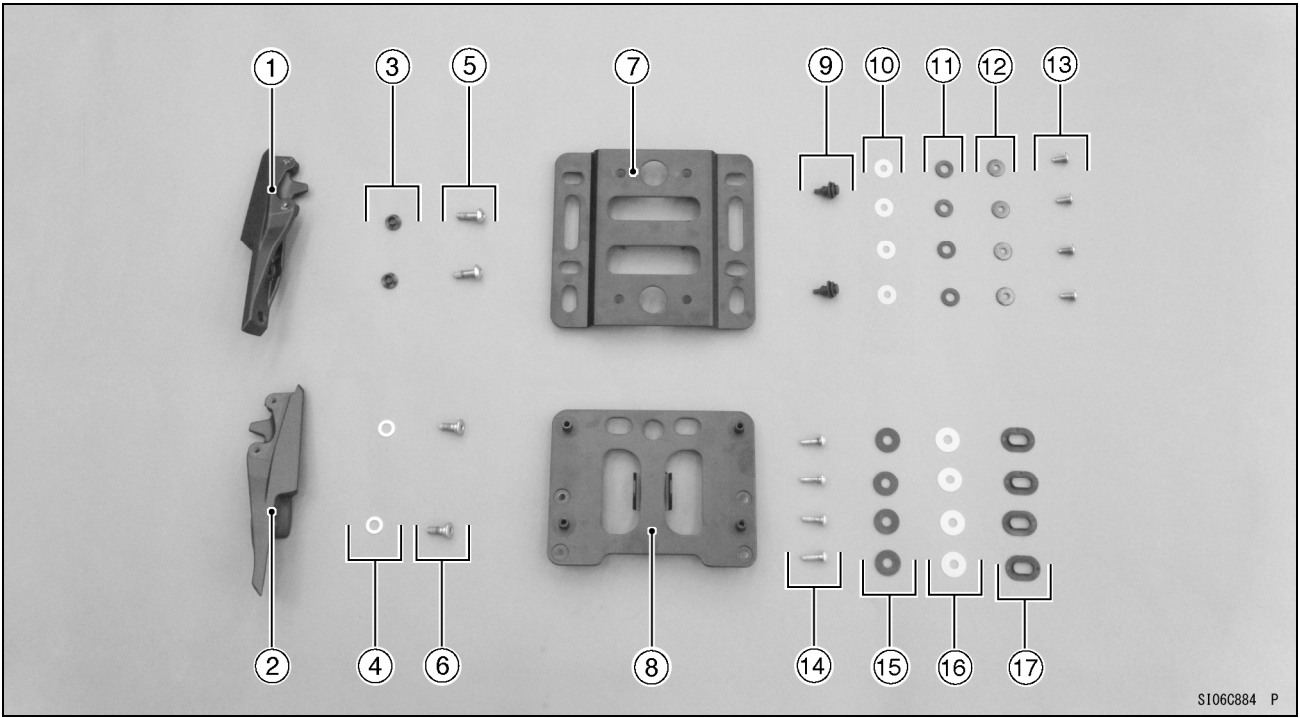

S106C884 P

## Installation Instructions

### Assembly Procedure

- Remove:  
Seat (Refer to the Service Manual)
- Remove the plugs [A] from the grab rail (both sides).

### NOTE

○ *This plugs are not necessary for this accessory.*

- Install: (Both Sides)  
Stay [2]  
Bolt [5] and Collar [3]  
Bolt [6] and Washer [4]
- Tighten the bolts securely.

- Install the bracket [8].
- Tighten the bolts [14] securely.

- Install:  
Dampers [15]  
Washers [16]

- Install the dampers [9] to the bracket [7] as shown.

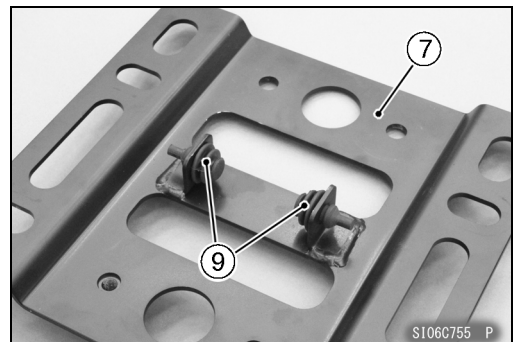
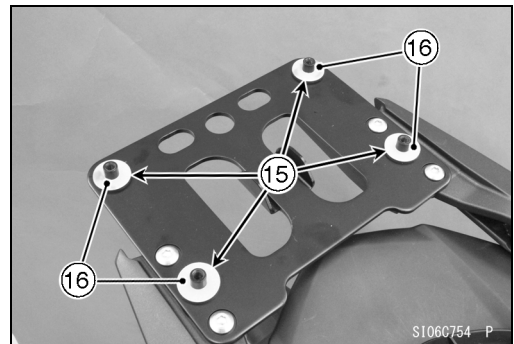
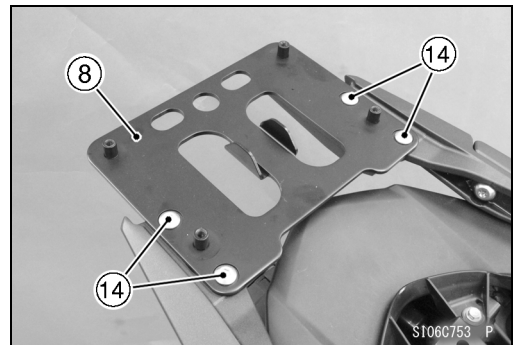
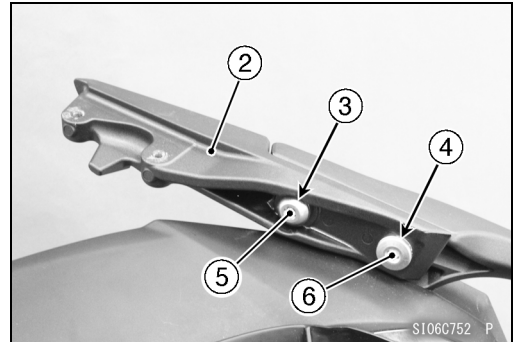
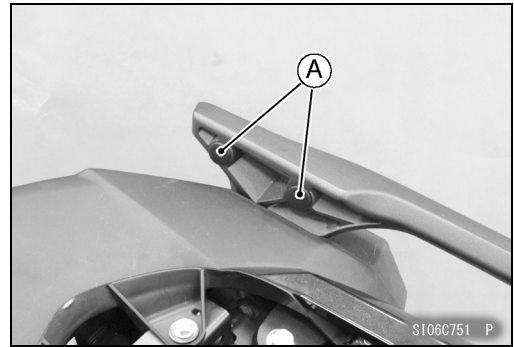

- Install:
  - Collars [17]
  - Bracket [7]
- Fit [A] the projection of collar [17] to hole of bracket [7].

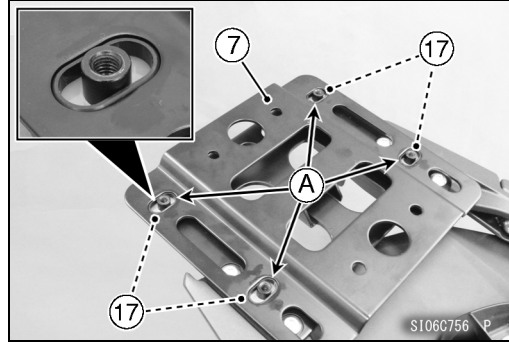

- Install:
  - Washers [10]
  - Dampers [11]

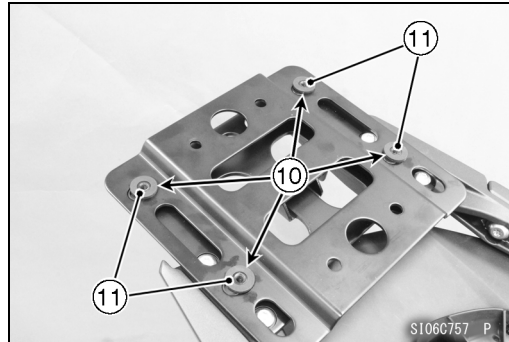

- Install the washers [12].
- Tighten the bolts [13] securely.
- Check the bracket [7] to slide the left and right.

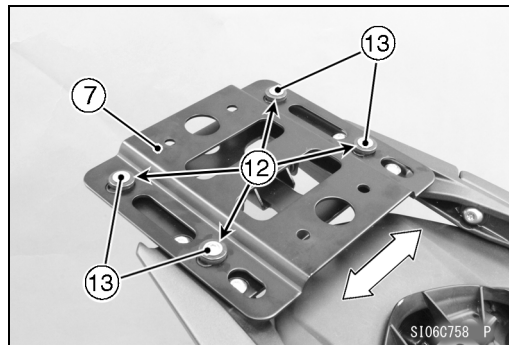

- Install:
  - Seat (Refer to the Service Manual)

### Basic Torque for General Fasteners

The table below, relating tightening torque to thread diameter, lists the basic torque for the bolts and nuts. Use this table for only the bolts and nuts which do not require a specific torque value. All of the values are for use with dry solvent-cleaned threads.

Threads dia. (mm)	Torque		
	N·m	kgf·m	ft·lb
5	3.4 ~ 4.9	0.35 ~ 0.50	30 ~ 43 in·lb
6	5.9 ~ 7.8	0.60 ~ 0.80	52 ~ 69 in·lb
8	14 ~ 19	1.4 ~ 1.9	10 ~ 13.5
10	25 ~ 34	2.6 ~ 3.5	19 ~ 25
12	44 ~ 61	4.5 ~ 6.2	33 ~ 45
14	73 ~ 98	7.4 ~ 10.0	54 ~ 72
16	115 ~ 155	11.5 ~ 16.0	83 ~ 115
18	165 ~ 225	17.0 ~ 23.0	125 ~ 165
20	225 ~ 325	23.0 ~ 33.0	165 ~ 240

**Check tightness of all fasteners in regular interval. Retighten loose fasteners.**