

# Kawasaki

## Assembly Instructions

Model:	KLE250C, KLE300B/C
Description:	Hand Guard
Part Number:	99994-0992
Flat Rate Time(Hr):	0.3

**Before you begin, read through these instructions and check that all parts are present. Please note that Kawasaki cannot assume any responsibility for damage resulting from incorrect installation.**

**Kawasaki recommends that all genuine accessories should be fitted by an authorized Kawasaki dealer.**

The following symbols indicate the information for proper installation and operation in this instruction.

**NOTE** : *NOTE indicates information that may help or guide you in the operation or service of the vehicle.*

● Indicates a procedural step or work to be done.

○ Indicates a procedural sub-step or how to do the work of the procedural step it follows. It also precedes the text of a NOTE.

(KLE250C) Refer to the Service Manual (P/No.: 99924-1528-01) for detailed procedures.

(KLE300B/C) Refer to the Service Manual (P/No.: 99924-1526-01) for detailed procedures.

Parts List				
No.	Component Name	Part No.	Qty	Remark
1	Bolt	92154-0951	2	M6 × 12
2	Hand Guard	59441-0043	1	Left
3	Collar	92152-2314	4	
4	Washer	92200-1762	2	
5	Nut	92015-1603	2	
6	Bolt	92154-2359	1	
7	Collar	92152-2302	1	
8	Bolt	92153-0790	1	
9	Hand Guard	59441-0044	1	Right
10	Damper	92161-1985	1	

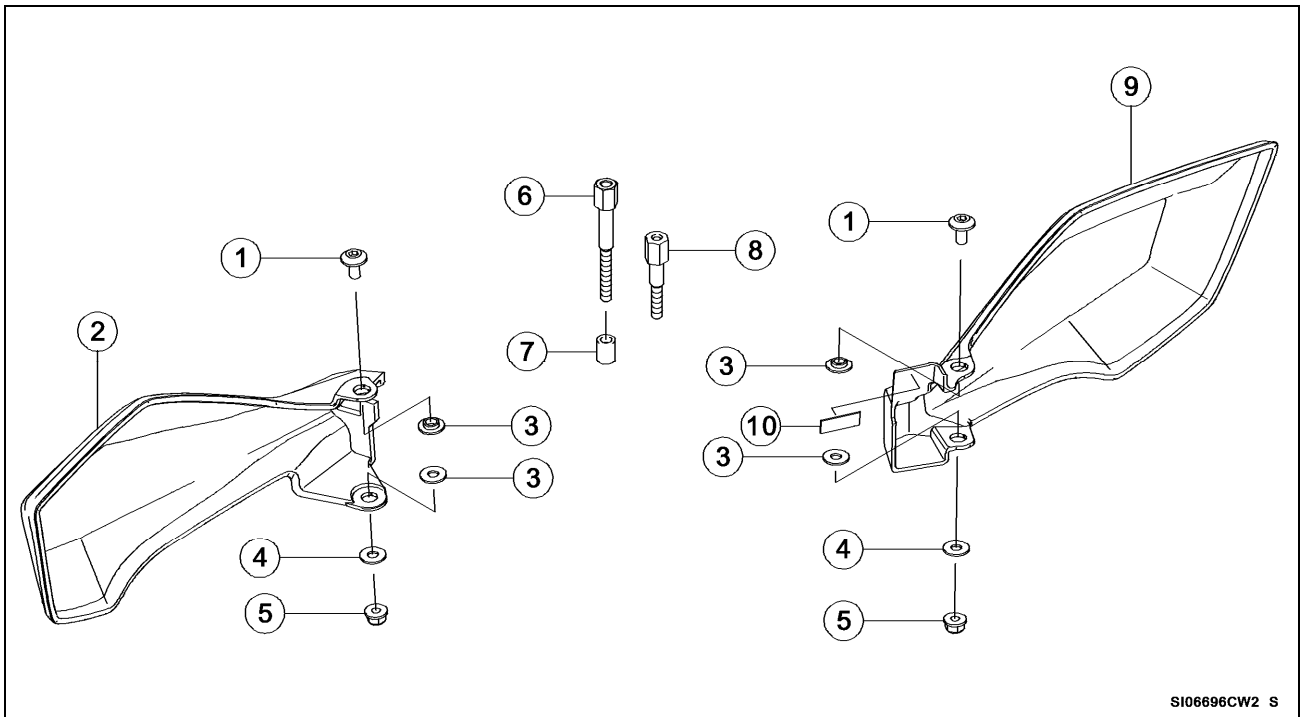

SI06696CW2 S

### Installation Instructions

#### Assembly Procedure For Right Side

- Remove:
  - Brake Lever Pivot Bolt [A]
  - Brake Lever Pivot Bolt Locknut [B]
  - Brake Lever [C]

#### NOTE

○ Brake lever pivot bolt is not necessary for this accessory.

- Apply silicone grease to the sliding surface of the bolt [8].
- Install:
  - Brake Lever [A]
- Tighten:
  - Torque – Bolts [8]: 5.9 N·m (0.60 kgf·m, 52 in·lb)**
  - Brake Lever Pivot Bolt Locknut [B]: 5.9 N·m (0.60 kgf·m, 52 in·lb)**

- Install the damper [10] on the hand guard [9].

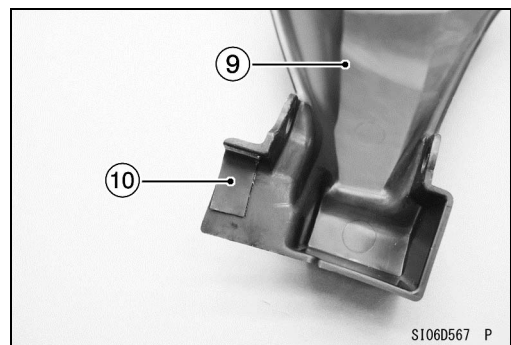
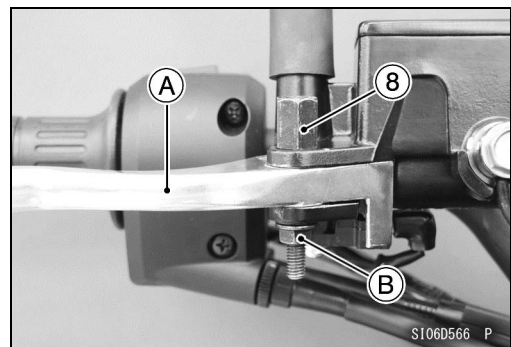
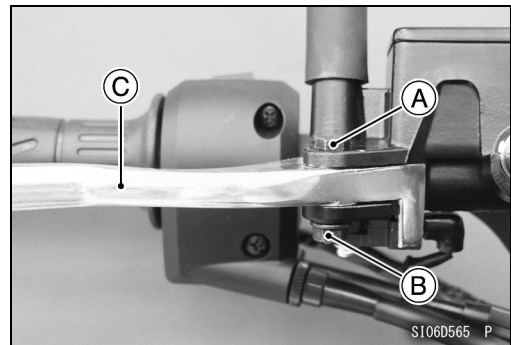

- Install:
  - Hand Guard [9]
  - Collars [3]
  - Washer [4]
  - Bolt [1]
  - Nut [5]

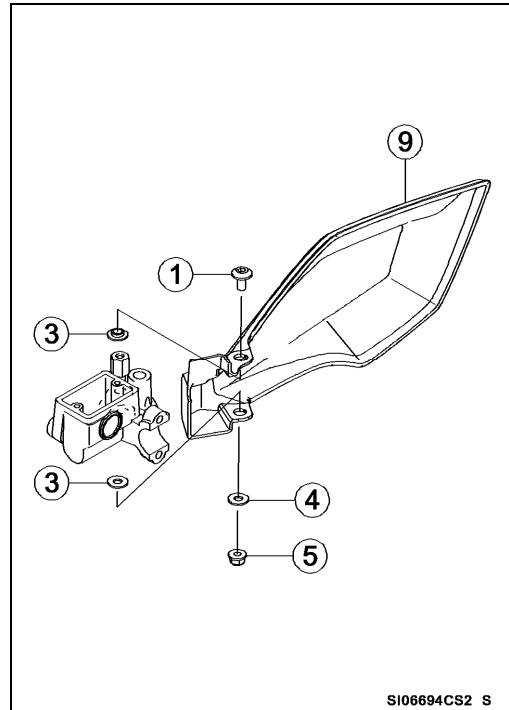

#### Assembly Procedure For Left Side

- Remove:
  - Clutch Lever (Refer to the Service Manual)

#### NOTE

○ Clutch lever pivot bolt is not necessary for this accessory.

- Replace the locknut [A].
- Apply silicone grease to the sliding surface of the bolt [6].
- Install:
  - Clutch Lever [B]
  - Bolt [6]
  - Collar [7]
  - Locknut
- Install:
  - Starter Lockout Switch (Refer to the Service Manual)
  - Clutch Cable (Refer to the Service Manual)
  - Left Switch Housing (Refer to the Service Manual)

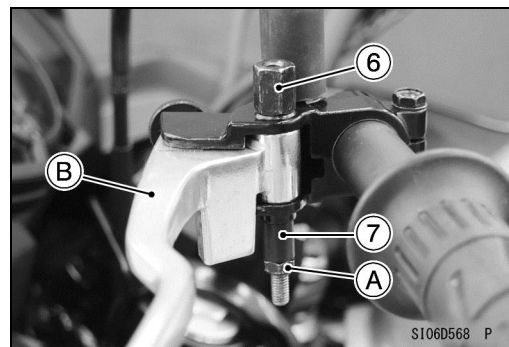

- Install:
- Hand Guard [2]
- Collars [3]
- Washer [4]
- Bolt [1]
- Nut [5]

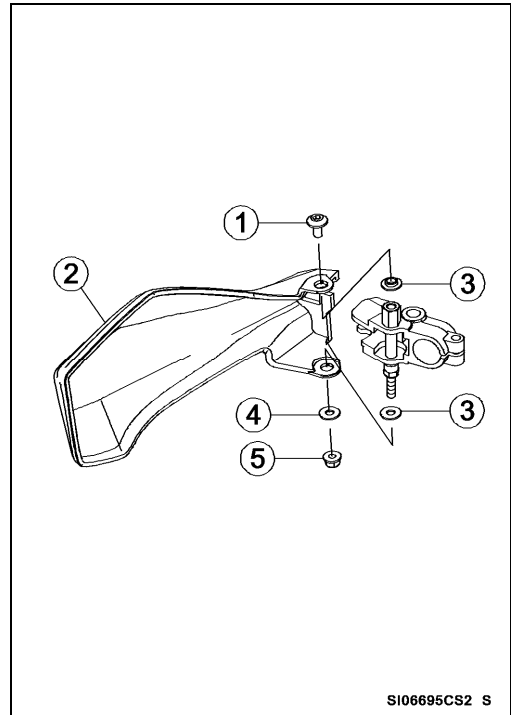

SI06695CS2 S

#### Basic Torque for General Fasteners

The table below, relating tightening torque to thread diameter, lists the basic torque for the bolts and nuts. Use this table for only the bolts and nuts which do not require a specific torque value. All of the values are for use with dry solvent-cleaned threads.

Threads dia. (mm)	Torque		
	N·m	kgf·m	ft·lb
5	3.4 ~ 4.9	0.35 ~ 0.50	30 ~ 43 in·lb
6	5.9 ~ 7.8	0.60 ~ 0.80	52 ~ 69 in·lb
8	14 ~ 19	1.4 ~ 1.9	10 ~ 13.5
10	25 ~ 34	2.6 ~ 3.5	19 ~ 25
12	44 ~ 61	4.5 ~ 6.2	33 ~ 45
14	73 ~ 98	7.4 ~ 10.0	54 ~ 72
16	115 ~ 155	11.5 ~ 16.0	83 ~ 115
18	165 ~ 225	17.0 ~ 23.0	125 ~ 165
20	225 ~ 325	23.0 ~ 33.0	165 ~ 240

**Check tightness of all fasteners in regular interval. Retighten loose fasteners.**