

Assembly Instructions

Model:	ZR900A/B
Description:	DC Output
Part Number:	99994-0838
Flat Rate Time(Hr):	0.1

Before you begin, read through these instructions and check that all parts are present. Please note that Kawasaki cannot assume any responsibility for damage resulting from incorrect installation.

Kawasaki recommends that all genuine accessories should be fitted by an authorized Kawasaki dealer.

The following symbols indicate the information for proper installation and operation in this instruction.

NOTE : NOTE indicates information that may help or guide you in the operation or service of the vehicle.

● Indicates a procedural step or work to be done.

○ Indicates a procedural sub-step or how to do the work of the procedural step it follows. It also precedes the text of a NOTE.

Refer to the Service Manual (P/No.: 99924-1525-01) for detailed procedures.

Parts List				
No.	Component Name	Part No.	Qty	Remark
1	DC Socket	13151-0566	1	
2	Cover	14093-0212	1	
3	Bracket	23062-0955	1	for Original Meter Cover: 14093-0512
4	Bracket	23062-0956	1	for Large Meter Cover: 14093-0514
5	Trim	53044-0031	1	
6	Collar	92152-2135	1	
7	Bolt	92154-0917	1	
8	Damper	92161-1789	1	
9	Clamp	92173-0736	1	

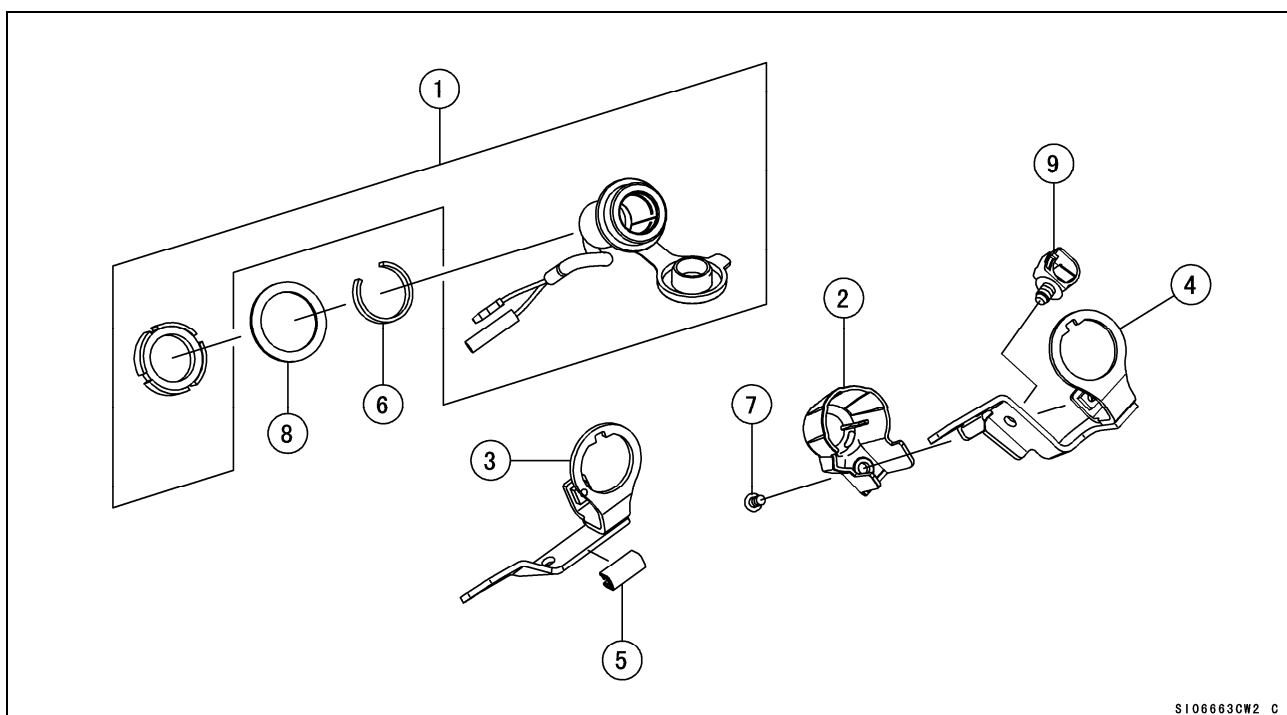

S106663CW2 C

Installation Instructions

- Remove the meter cover (Refer to the Service Manual).
- Install the collar [6] so that the opening [A] fits the projection [B] of the socket [1].

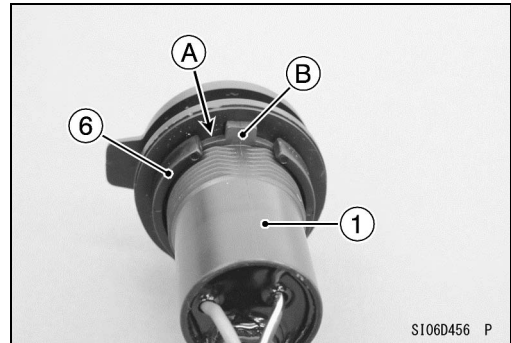

- Install the bracket [3] or [4] so that the groove [A] fits the projection [B] of the socket [1].
Bracket [3]: for Original Meter Cover
Bracket [4]: for Large Meter Cover

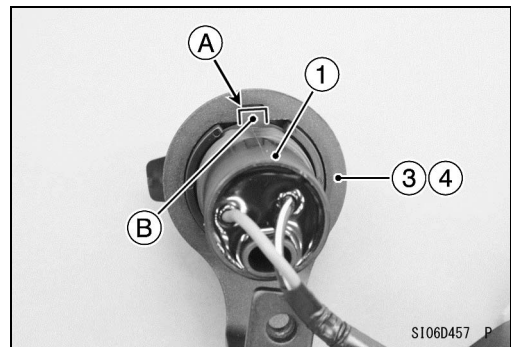

- Install the damper [8], and tighten the nut [A] securely.

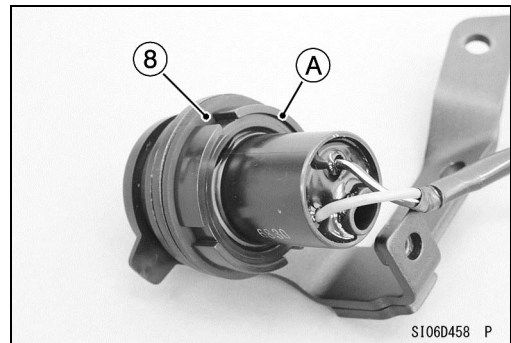

- Install the cover [2], and tighten the bolt [7] securely.

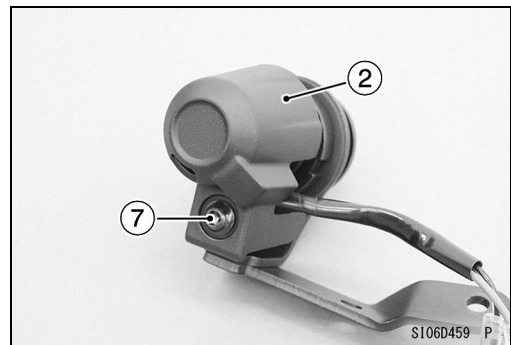

For Original Meter Cover

- Install the clamp [9] and trim [5].
- Run the socket lead [A] into the clamp [9] as shown.

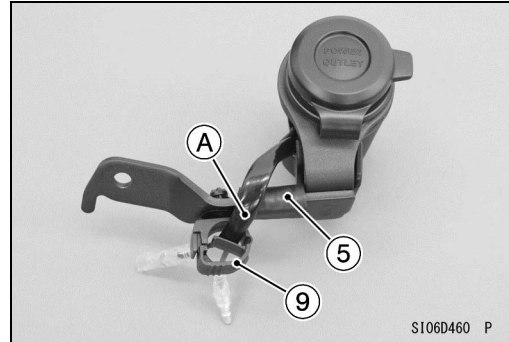

- Remove the harness tape [A] to free the connectors [B] from the main harness.

NOTE

- Do not remove the other harness tape.

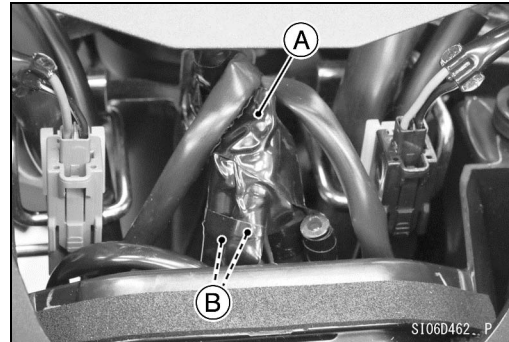

- Remove the bolt [C].

NOTE

- The removed bolt are necessary for this accessory.

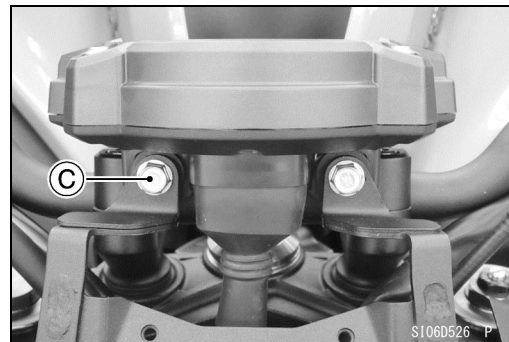

- Connect the socket lead connectors [A] to the main harness.
- Run the socket lead, under the turn signal lead.
- Install the socket assy [B] and bolt [C].
- Fit the projection [D] of the socket assy to the meter bracket as shown.
- Install the removed parts (Refer to the Service Manual).

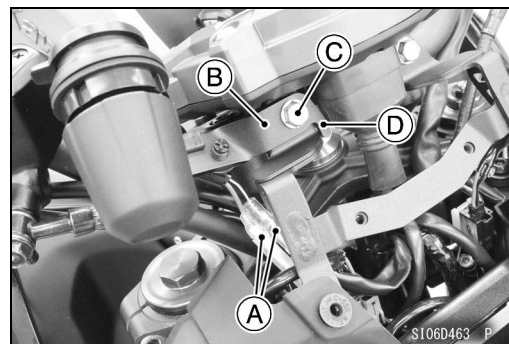

For Large Meter Cover

NOTE

- If installing the large meter cover from the state where the DC socket kit and original meter cover installed, wrap the harness tape [A] to hold the connectors.

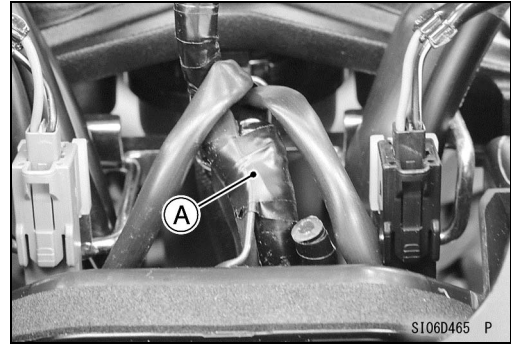

- Install the clamp [9].
- Run the socket lead [A] into the clamp [9] as shown.

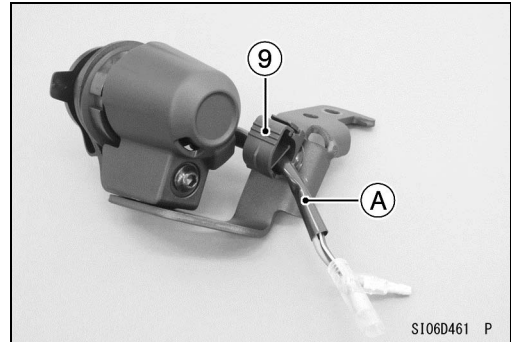

- Remove the bolt [C].

NOTE

- The removed bolt are necessary for this accessory.
- Connect the socket lead connectors [A] to the main harness.
- Run the socket lead, over the turn signal lead.
- Install the socket assy [B] and bolt [C].
- Fit the projection [D] of the socket assy to the meter bracket as shown.

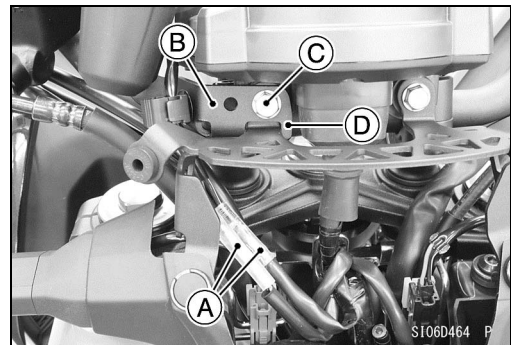

- Install the removed parts (Refer to the Service Manual).

Basic Torque for General Fasteners

The table below, relating tightening torque to thread diameter, lists the basic torque for the bolts and nuts. Use this table for only the bolts and nuts which do not require a specific torque value. All of the values are for use with dry solvent-cleaned threads.

Threads dia. (mm)	Torque		
	N·m	kgf·m	ft·lb
5	3.4 ~ 4.9	0.35 ~ 0.50	30 ~ 43 in·lb
6	5.9 ~ 7.8	0.60 ~ 0.80	52 ~ 69 in·lb
8	14 ~ 19	1.4 ~ 1.9	10 ~ 13.5
10	25 ~ 34	2.6 ~ 3.5	19 ~ 25
12	44 ~ 61	4.5 ~ 6.2	33 ~ 45
14	73 ~ 98	7.4 ~ 10.0	54 ~ 72
16	115 ~ 155	11.5 ~ 16.0	83 ~ 115
18	165 ~ 225	17.0 ~ 23.0	125 ~ 165
20	225 ~ 325	23.0 ~ 33.0	165 ~ 240

Check tightness of all fasteners in regular interval. Retighten loose fasteners.