

# BMW Motorrad

## Workshop installation instructions

### Case carrier for aluminium case

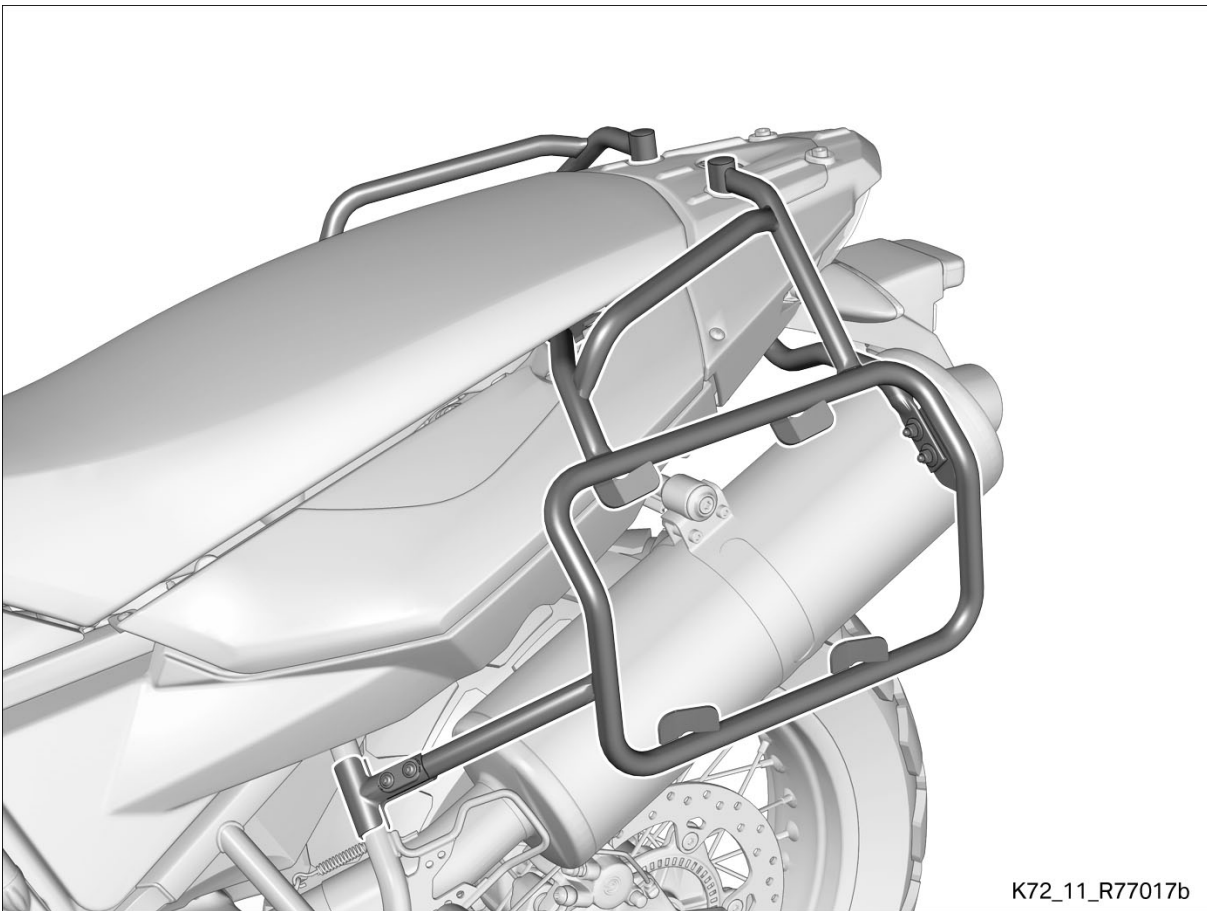

**Before commencing work, you must read these installation instructions through carefully and make sure you understand them fully.**

**BMW Motorrad recommends having this installation kit installed by a specialist workshop with the requisite special tools, preferably an authorised BMW Motorrad dealer.**

**Incorrect installation and incorrect handling give rise to considerable safety risks.**

**The symbols used to draw attention to safety instructions in this manual are as follows:**



**Warning**

This symbol stands for precautions and measures which are essential in order to protect the rider and other persons from possibly severe or fatal injury.



**Attention**

Specific instructions and safety precautions intended to prevent damage to the motorcycle and accessories. Non-compliance can void the warranty.



**Note**

Specific instructions on how to operate, control, adjust or look after items of equipment on the motorcycle.



**Tightening torque**

Screws, bolts and nuts are tightened in accordance with the applicable DIN/ISO standards. Tightening torques that deviate from the standards are stated. Non-compliance can result in damage to the motorcycle or accessories or can endanger the rider.

▶ Start of the main activity

▷ Start of the secondary activity

• Instruction

◀ End of the main activity

◁ End of the secondary activity

◇ End of validity designation CS (construction status), OE (optional extra) or OA (optional accessory)

©2013 Bayerische Motoren Werke Aktiengesellschaft  
80788 Munich, Germany

Reprinting, even only in extracts, is only permitted with written authorization by BMW Motorrad, Aftersales.

Printed in Germany.

Subject to change without notice. Errors and omissions excepted.

All rights reserved.

## Case carrier for aluminium case

### Requisite tools

- Set of Torx wrenches
- Set of open-ended spanners
- Torque wrench

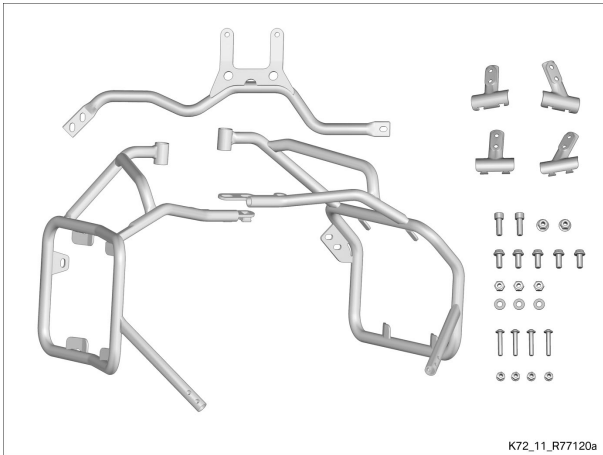

### Scope of supply

- Cross-member
- Case carrier, right
- Case carrier, left
- Clamp, right, inside and outside
- Clamp, left, inside and outside
- Socket-head screw, M8 X 25 2 of
- Hex nut, M8 2 of
- Socket-head screw, M8 x 20 5 of
- Hex nut, M8 3 of
- Washer 8 3 of
- Flanged oval-head screw, M6 X 35 4 of
- Hex nut, M6 4 of

### General instructions

#### Attention

A motorcycle that has not been stood up correctly may topple over when the following work is being carried out. Make sure that the motorcycle is standing up safely.

## 77 42 138 Installing case carrier for aluminium case

– with case carrier for aluminium cases<sup>OA</sup>

– without centre stand<sup>OE</sup> (0636)

Additional work: 46 52 511 Removing and installing the middle stand special tool (motorcycles without centre stand)◇

### 1

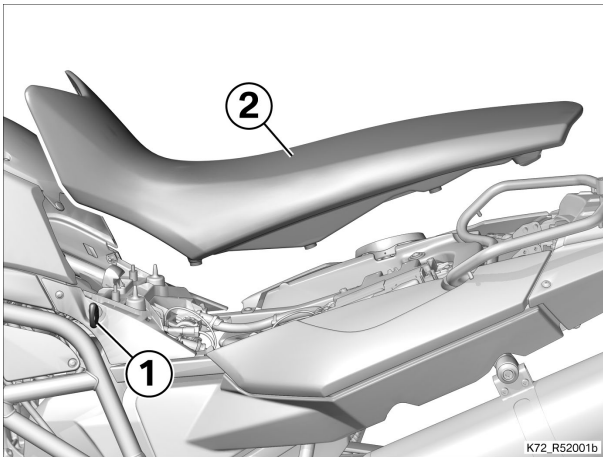

#### ► Removing seat

- Open the seat lock with ignition key **(1)**.
- Remove seat **(2)**.

### 2

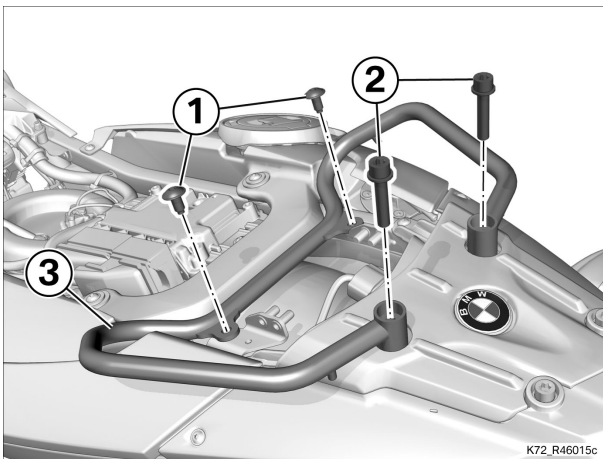

#### ► Remove the grab handle

- Remove screws **(1)** and lay them safely aside **(needed for subsequent reassembly)**.
- Remove screws **(2)** and lay them safely aside **(needed for subsequent reassembly)**.
- Remove grab handle **(3)**.

### 3

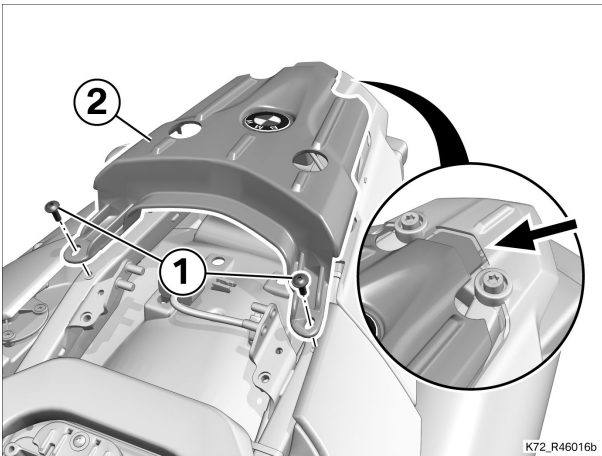

#### ► Removing luggage rack

- Remove screws **(1)** and lay them safely aside (**needed for subsequent reassembly**).
- Remove luggage carrier **(2)**, noting the guide (**arrow**).

### 4

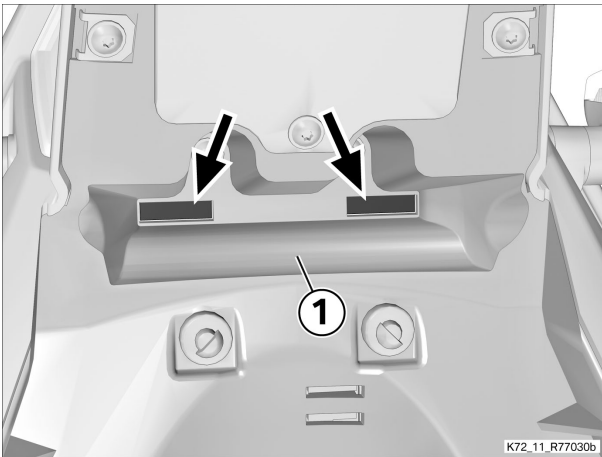

#### ► Piercing rear-wheel cover

- Pierce rear-wheel cover **(1)** at the appropriate point (**arrows**), using suitable tools.

### 5

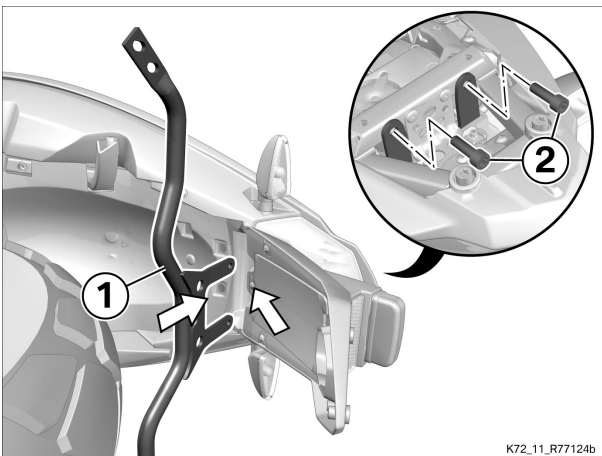

#### ► Installing cross-member

- without construction status February 2011<sup>CST</sup>
- Insert the section (**arrow**) of cross-member **(1)** right through the hole in the rear-wheel cover (**arrow**).
- Install screws **(2)** in the rear frame.

🔧 Tightening torques		
Cross-member, rear, to rear frame		
M8 x 25	19 Nm	– with case carrier for aluminium cases <sup>OA</sup>
M8 x 25, Replace nut Thread-locking compound (mechanical)	19 Nm	– with case carrier for aluminium cases <sup>OA</sup> – with construction status February 2011 <sup>CST</sup>

# 6

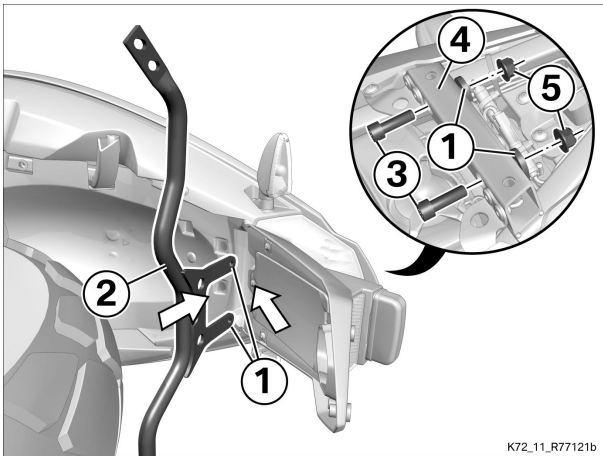

– with construction status February 2011<sup>CST</sup>

## ▶ Installing cross-member

- Insert retaining lugs **(1)** of cross-member **(2)** right through the holes in the rear-wheel cover **(arrow)**.
- Insert screws **(3)** through the drilled holes in rear frame cross-member **(4)** and drilled holes in retaining lugs **(1)**.
- Install nuts **(5)**.

🔧 Tightening torques		
Cross-member, rear, to rear frame		
M8 x 25	19 Nm	– with case carrier for aluminium cases <sup>OA</sup>
M8 x 25, Replace nut Thread-locking compound (mechanical)	19 Nm	– with case carrier for aluminium cases <sup>OA</sup> – with construction status February 2011 <sup>CST</sup>

# 7

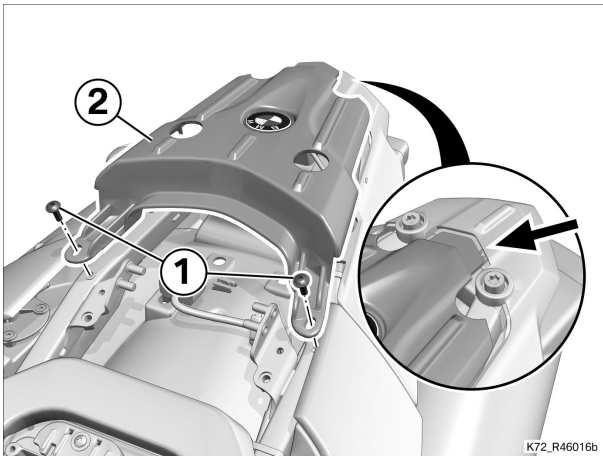

## ► Installing luggage rack

- Install luggage carrier **(2)**, noting the guide **(arrow)**.
- Install screws **(1)**.

# 8

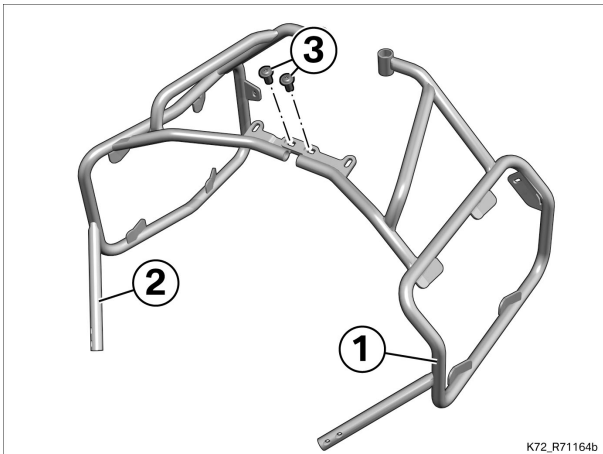

## ► Installing case carrier

- Join case carriers **(1)** and **(2)**.
- Install screws **(3)** and tighten until hand-tight.

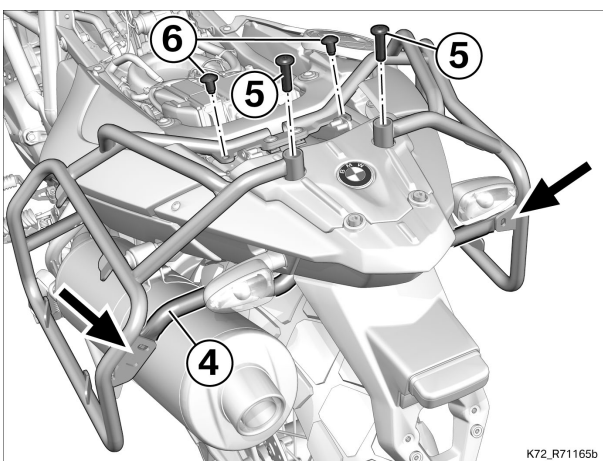

- Cover the rear silencer with a cloth to avoid scratches.
- Working from above, position the case carriers on the rear frame with the lugs **(arrows)** behind cross-member **(4)** and tighten screws **(5)** until hand-tight.
- Install screws **(6)** and tighten until hand-tight.



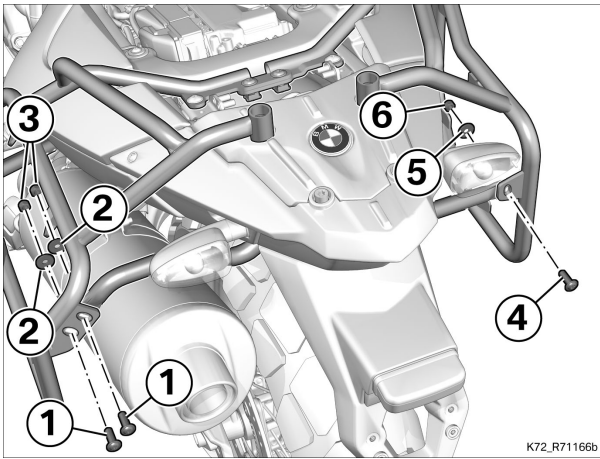

▷ **Case carriers, left and right, to cross-member**

- On the left side, install screws (1) with washers (2) and nuts (3).
- On the right side, install screw (4) with washer (5) and nut (6).

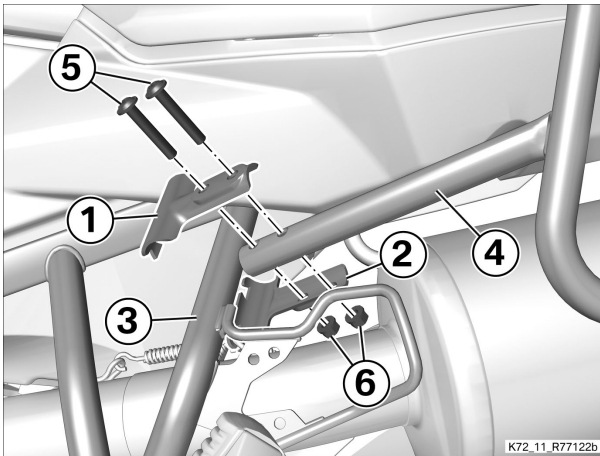

▷ **Installing clamps on link for rear footrests and case holders**

- Install a clamp on either side as appropriate.
- On the left side, position clamp outboard part (1) and inboard part (2) on link for rear footrest (3) and case carrier (4) and tighten screws (5) with nuts (6) until hand-tight.

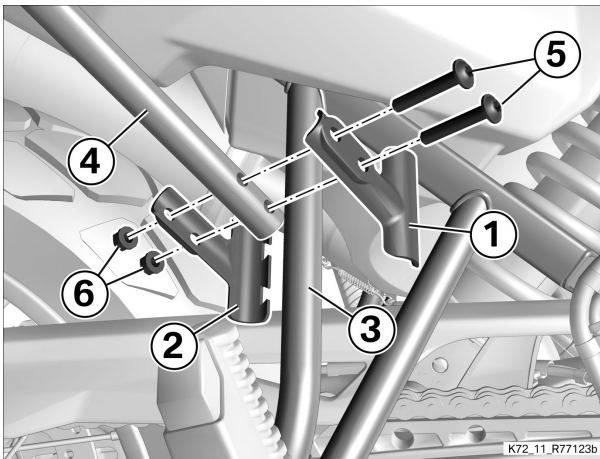

- On the right side, position clamp outboard part (1) and inboard part (2) on link for rear footrest (3) and case carrier (4) and tighten screws (5) with nuts (6) until hand-tight.

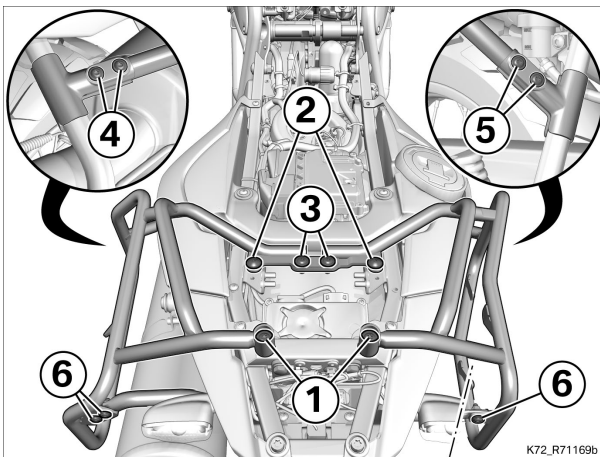

▷ **Tightening screws**

- Tighten screws (1).

Tightening torques		
<b>Case carrier to rear frame at top</b>		
M8 x 35	19 Nm	– with case carrier for aluminium cases <sup>OA</sup>

- Tighten screws (2).



🔧 <b>Tightening torques</b>		
<b>Case carriers, left and right, to rear frame</b>		
M8 x 20	19 Nm	– with case carrier for aluminium cases <sup>OA</sup>

- Tighten screws **(3)**.

🔧 <b>Tightening torques</b>		
<b>Case carrier, left to case carrier, right</b>		
M8 x 20	19 Nm	– with case carrier for aluminium cases <sup>OA</sup>

- Tighten screws **(4)** and **(5)**.

🔧 <b>Tightening torques</b>		
<b>Clamp to rear frame</b>		
M6 x 35 Thread-locking compound (Micro-encapsulated)	8 Nm	– with case carrier for aluminium cases <sup>OA</sup>

- Tighten screws **(6)**.

🔧 <b>Tightening torques</b>		
<b>Cross-member, rear, to case carriers</b>		
M8 x 20	19 Nm	– with case carrier for aluminium cases <sup>OA</sup>



## 9

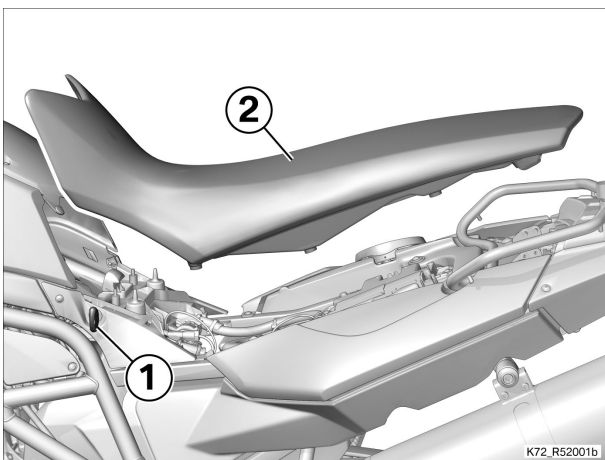

### ► **Installing seat**

- Engage seat **(2)** in the holders at the rear.
- Engage seat lock **(1)** by pressing down on the front seat.



► **Final check of work performed**

- Check that
  - the work as performed achieved the intended purpose.
  - all reservoirs and containers have been filled and that all fluids and lubricants are at their correct levels.
  - all threaded fasteners released beforehand have been correctly retightened.
  - the fuel system is free of leaks.
  - the lights and signalling equipment are fully operational and that the motorcycle is roadworthy.
  - the brake pads of the front and rear brakes are bedded against the brake discs.◊



**Always comply with the regulations regarding approval in the country of use.**



**Note**

**Applicable in the Federal Republic of Germany:**

An entry does not have to be recorded in the vehicle documents.

---