

BMW Motorrad

Workshop installation guide

Tail-hump cover

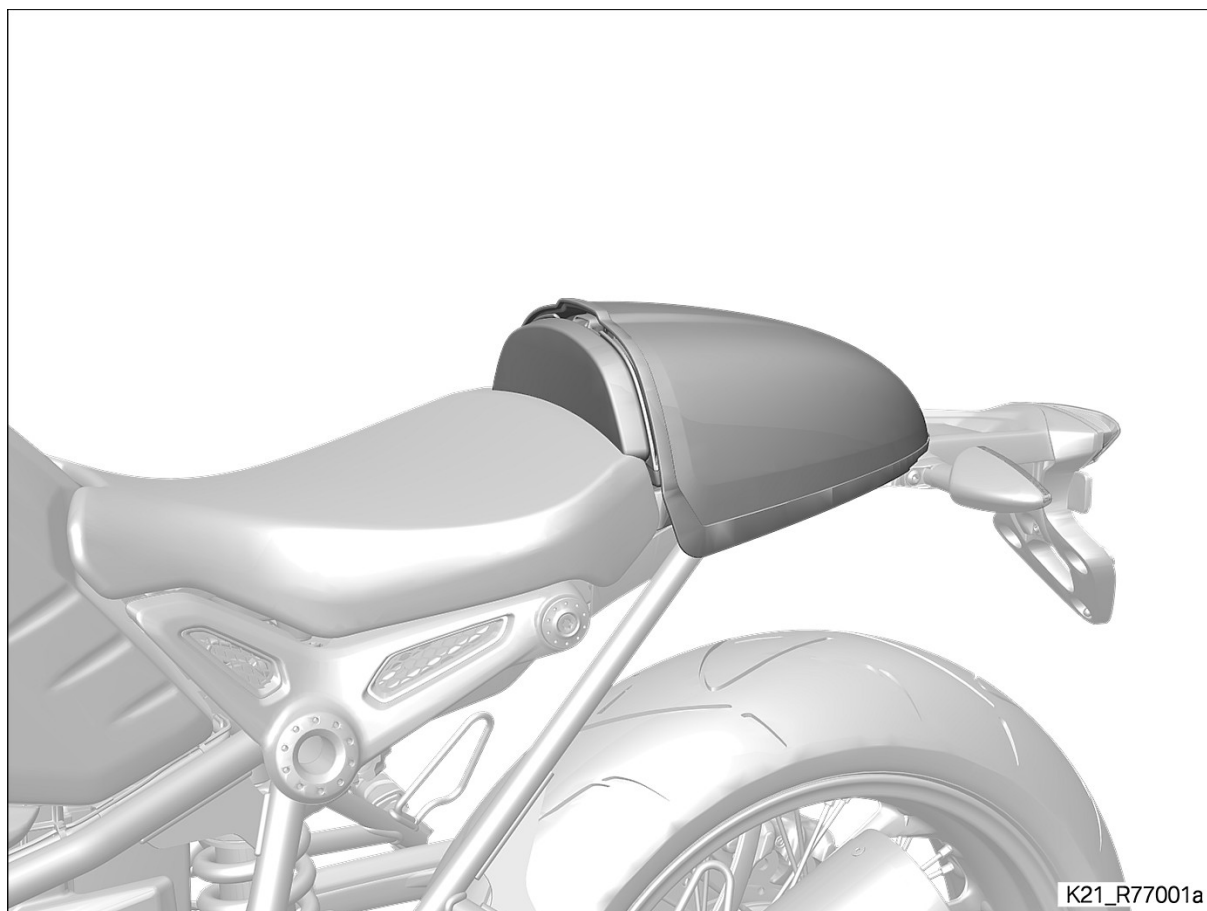

Before commencing work, you must read these installation instructions through carefully and make sure you understand them fully.

BMW Motorrad recommends having this installation kit installed by a specialist workshop with the requisite special tools, preferably an authorised BMW Motorrad dealer.

Incorrect installation and incorrect handling give rise to considerable safety risks.

The symbols used to draw attention to precautionary statements in this manual are as follows:



CAUTION

Low-risk hazard. Non-avoidance can lead to slight or moderate injury.



WARNING

Medium-risk hazard. Non-avoidance can lead to fatal or severe injury.



DANGER

High-risk hazard. Non-avoidance leads to fatal or severe injury.



ATTENTION

Special notes and precautionary measures. Non-compliance can lead to damage to the vehicle or accessory and, consequently, to voiding of the warranty.



NOTICE

Specific instructions on how to operate, control, adjust or look after items of equipment on the motorcycle.



Tightening torque

Screws, bolts and nuts are tightened in accordance with the applicable DIN/ISO standards. Tightening torques that deviate from the standards are stated. Non-compliance can result in damage to the vehicle or accessories or can endanger the driver.

- Start of the main activity
- ▷ Start of the secondary activity
- Instruction

- ◄ End of the main activity
- ◁ End of the secondary activity
- ◇ End of validity designation CS (construction status), OE (optional extra) or OA (optional accessory)

© 2018 Bayerische Motoren Werke Aktiengesellschaft
80788 Munich, Germany

Not to be reproduced by any means whatsoever, wholly or in part, without the written permission of BMW Motorrad, After Sales.

Printed in Germany.

Subject to change without notice. Errors and omissions excepted.

All rights reserved.

Tail-hump cover

Requisite tools

- Set of Torx bits
- Torque wrench

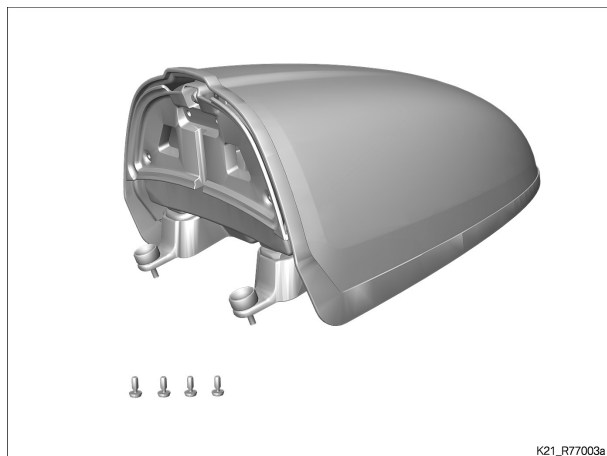

Delivery specification

- Tail-hump cover
- Screws for plastic

4 of



Also required:

- Backrest pad

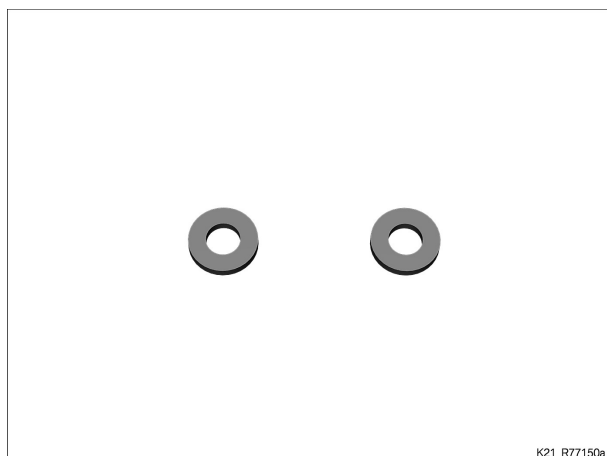

Also required:

- Washers

2 pieces

 Installation tool	
Silicone spray	83 19 2 208 609

General instructions

ATTENTION

Vehicle not securely propped

Risk of damage to parts if vehicle topples

- Prop the vehicle securely.
-

77 34 009 Installing tail-hump cover

NOTICE

Described installation is also valid for painted aluminium tail-hump cover as well as for HP Carbon tail-hump cover.

Additional work: 46 52 510 Removing and installing the rear-wheel stand special tool (motorcycles without centre stand)

1

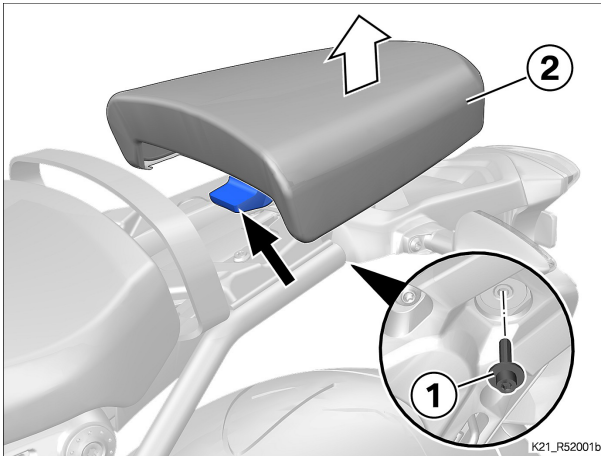

► Removing passenger seat

- Remove screw (1).
- Raise rear seat (2) slightly at the rear and remove, noting the lug (arrow).

2

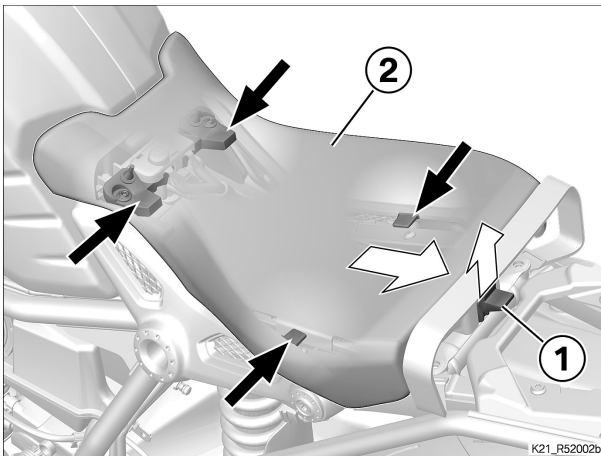

► Removing rider's seat

- Pull latch (1) up.
- Work rider's seat (2) to the rear and remove, noting the lugs (arrows).

3

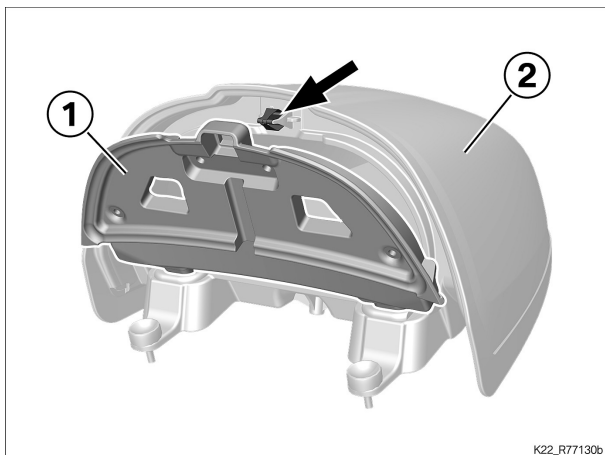

► Removing storage compartment lid

- Pull storage compartment lid (1) off the tail-hump cover in the upper area of the mounting clip (**Arrow**) on tail-hump cover (2) and remove (storage compartment lid (1) is secured with a retaining strap).

4

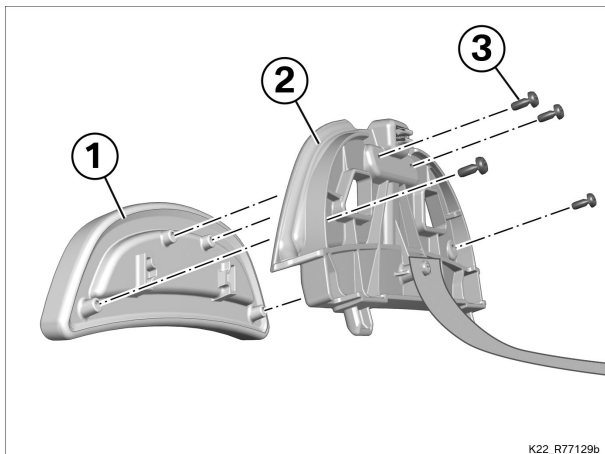

► Installing backrest pad

- Position backrest pad (1) on storage compartment lid (2) and install carefully with screws (3).

5

► Closing stowage-compartment lid with backrest pad

Requirement

Comply with the procedure for closing the stowage-compartment lid.

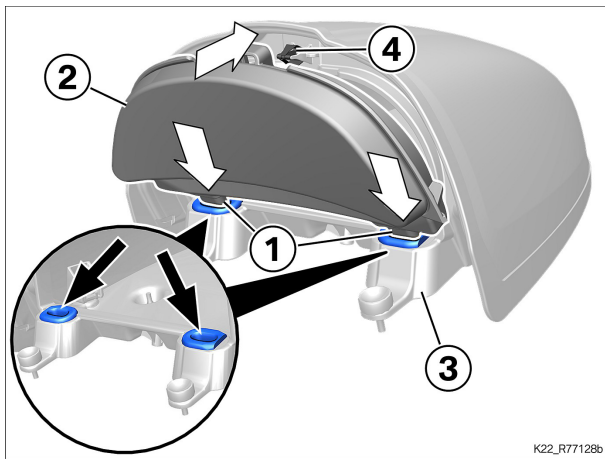

- Lightly spray the rubber mounts (**arrows**).



Installation tool

Silicone spray	83 19 2 208 609
----------------	-----------------

- Insert lugs **(1)** of luggage compartment lid **(2)** in rubber mountings **(Arrows)** on tail-hump cover **(3)** and press down fully.
 - Swivel luggage compartment lid **(2)** towards mounting clip **(4)** and insert.
- » The stowage compartment lid engages with an audible click.

6

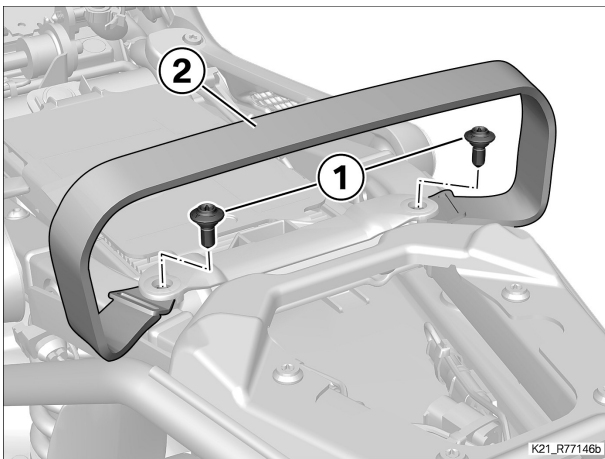

► Removing grab strap

- Remove screws **(1)** and put away (**will be used again**).
- Remove retaining belt **(2)**.

7

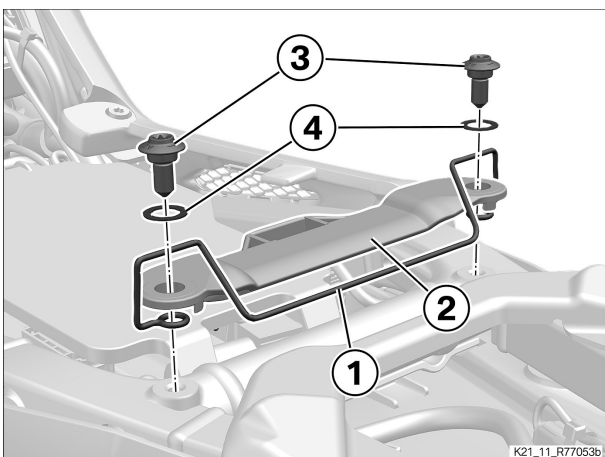

► Installing retainer

- Insert retaining bracket **(1)** under the retaining bridge of driver's seat **(2)**.
- Install screws **(3)** with washers **(4)**.



Tightening torques

Retaining bridge to rear frame

M6 x 14.5	8 Nm	
-----------	------	--

8

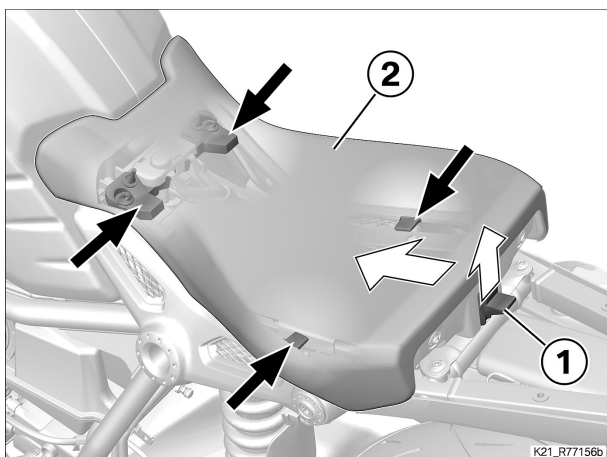

► Installing rider's seat

- Lift lock (1) and position driver's seat (2) while noting tabs (Arrows).
- Ensure that the lock (1) is in **bottom position**.

9

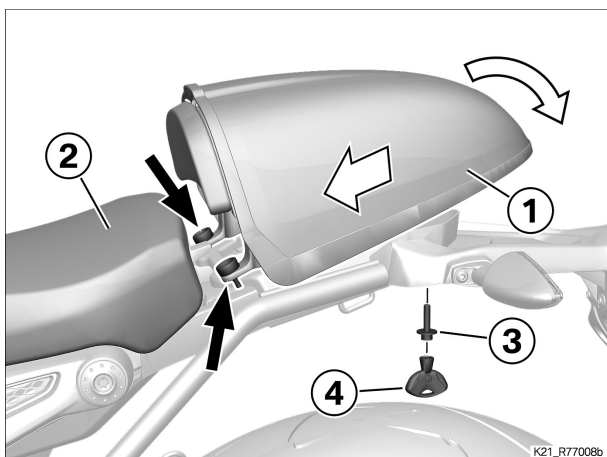

► Installing tail-hump cover

- Position tail-hump cover (1) while pushing the guides (Arrows) in the openings in rear seat bench (2) and swing tail-hump cover (1) to the bottom.
- Install bolt (3) (with special wrench (4)).

10

► Final check of work performed

- Check the following:
 - The work as performed achieved the intended purpose.
 - All reservoirs and containers have been filled and all fluids and lubricants are at their correct levels.
 - All threaded fasteners released beforehand have been correctly retightened.
 - The fuel system is free of leaks.
 - The lights and signalling equipment are fully operational and the vehicle is roadworthy.
 - The brake pads of the front and rear brakes are bedded against the brake discs.

▷ Function test, engine start suppression

Check

- Shift the transmission to idle position.

- Switch on the ignition.
- » Neutral indicator light "N" lights up.
- Select a gear.
- » Neutral indicator light "N" goes out.
- Operate the starter motor switch.
- » Starter does **not** operate.
- Extend the side stand.
- Pull the clutch lever.
- Operate the starter motor switch.
- » Starter does **not** operate.
- Retract the side stand.
- Operate the starter motor switch when the clutch is pulled.
- » Starter operates.

Result

Not all test steps completed successfully.

Measure

- Check the appropriate parts with the BMW Motorrad diagnostic system.



Always comply with the regulations regarding approval in the country of use.

NOTICE

For vehicles registered in the Federal Republic of Germany:

No entry in the vehicle registration papers is required.