



INSTALLATION & USER'S GUIDE

TorqDrive® Clutch Pack
for KTM 85

Doc ID: 191-2851A
Revision: 040819

TABLE OF CONTENTS

OVERVIEW2

INSTALLATION TIPS3

TOOLS NEEDED.....3

INCLUDED PARTS4

BIKE PREP & DISASSEMBLY5

INSTALL THE CLUTCH PACK6

PRESSURE PLATE INSTALLATION.....9

MAINTENANCE.....11

 Clutch wear11

 Clutch parts11

 Preventive Maintenance.....12

NEED ADDITIONAL HELP?.....14

OVERVIEW

This kit reuses the OE (Original Equipment) or “stock” core clutch components. All 7 OE friction disks will be replaced with Rekluse TorqDrive® Frictions, and all OE steel drive plates will be replaced with Rekluse steel drive plates.

- All 6 of the OE drive pins will be reinstalled.
- If you install this product for a customer or another person, instruct them to read the **Safety Information** document and the **Installation and User Guide** before operating the bike with the product.

INSTALLATION TIPS

- Read this entire document before performing any steps, so you will know what to expect.
- Be sure to use proper eye protection.
- Laying the bike on its left side allows for easy clutch access and eliminates the need to drain oil.
- For optimal clutch performance Rekluse recommends using fresh, clean oil that **meets JASO-MA** oil rating requirements. Rekluse offers Factory Formulated Oil™ developed specifically for Rekluse products. Rekluse Factory Formulated Oil is a perfect complement to any OEM or aftermarket wet clutch. Visit www.rekluse.com to learn more.

TOOLS NEEDED

- 8 mm socket
- Torque wrench (in-lb & ft-lb, or N-m)
- Spring puller
- 4 mm hex bit/socket

INCLUDED PARTS

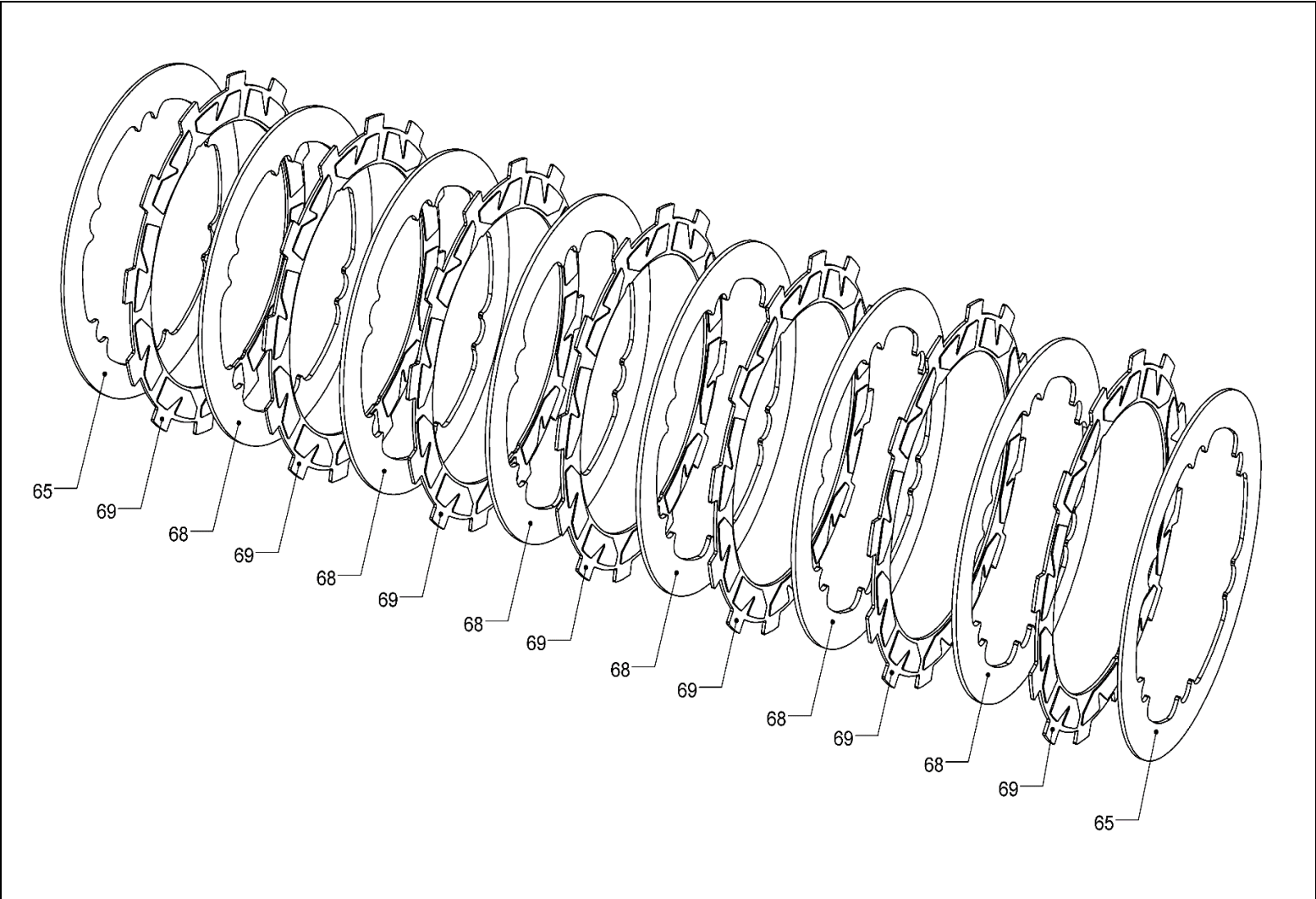

Item	Item Type	Qty
65	Steel Drive Plate - .048" (1.2 mm)	2
68	Steel Drive Plate - .060" (1.5 mm)	6
69	TorqDrive Friction Disks	7

Visit Rekluse.com/support for a full parts fiche illustration and part numbers.

BIKE PREP & DISASSEMBLY

1.Lay the bike on its left side. Catch any fuel that might drain in a suitable container.

2. Soak the TorqDrive® friction disks in new engine oil for 5 minutes. Make sure the friction disks are coated on both sides.

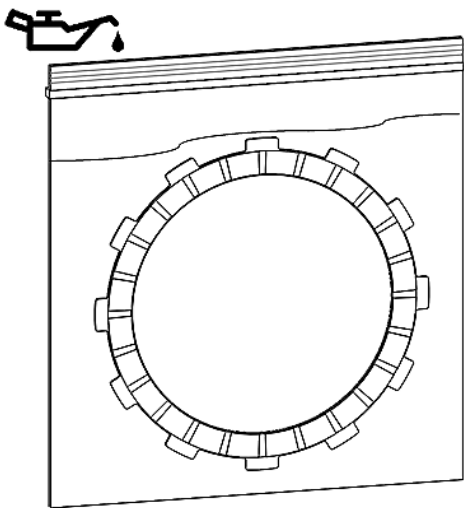

3. Using a socket, remove the clutch cover bolts, then remove the clutch cover.

4. Remove the OE parts named in the following diagram.

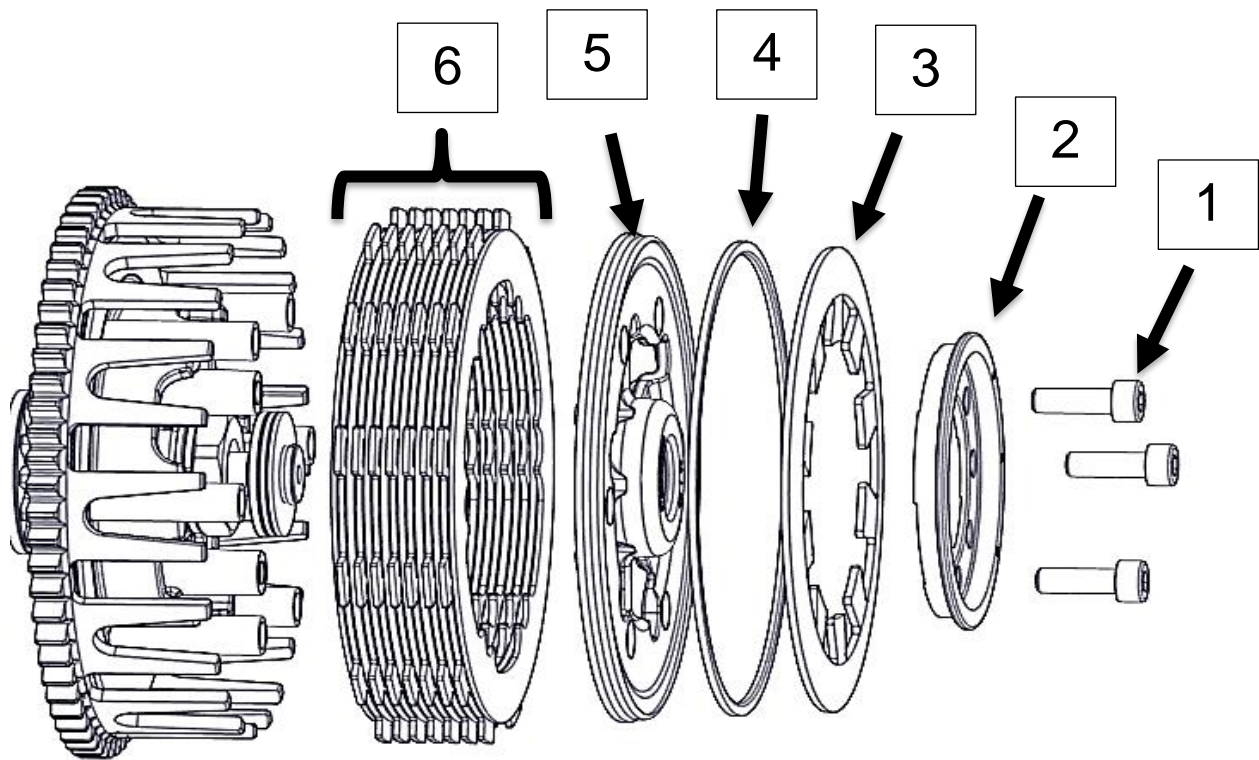

1	Pressure plate screws
2	Spring ring
3	Belleville spring
4	Slider ring
5	Pressure plate
6	Clutch pack

NOTE: Be careful that the drive pins do not fall into the engine while disassembling.

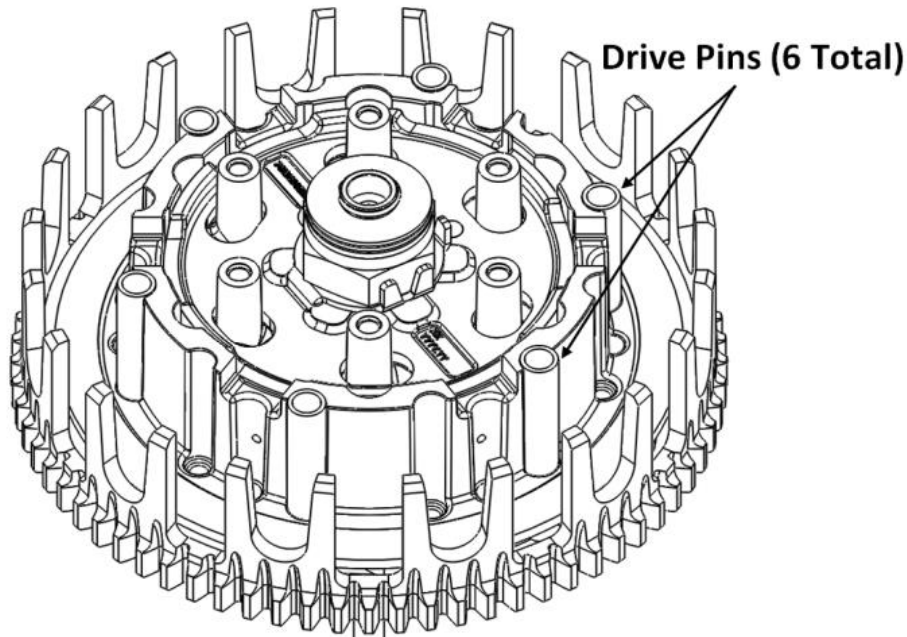

INSTALL THE CLUTCH PACK

1. Install a Rekluse .048" (1.2 mm) steel drive plate. Align the drive pin notches in the drive plate with the drive pins on the hub when you install it into the basket.

NOTE: Be sure that the drive pins are seated in the notches and not in the bigger sections. ALL the steel drive plates must be aligned in the drive pins notches or damage may occur. The plates will not move when installed correctly.

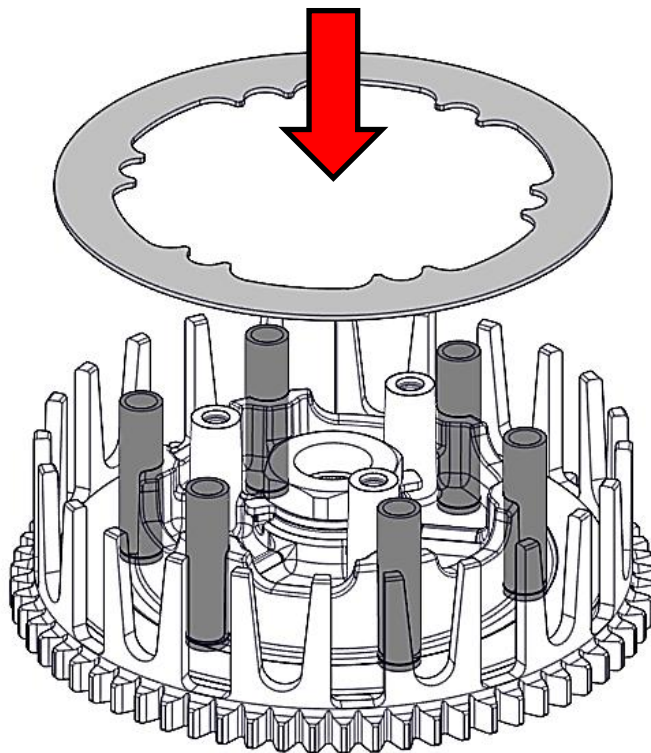

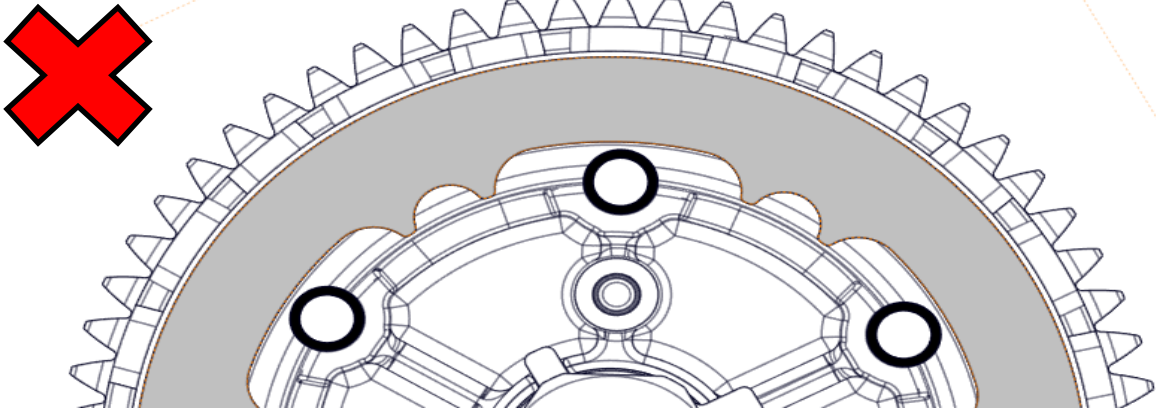
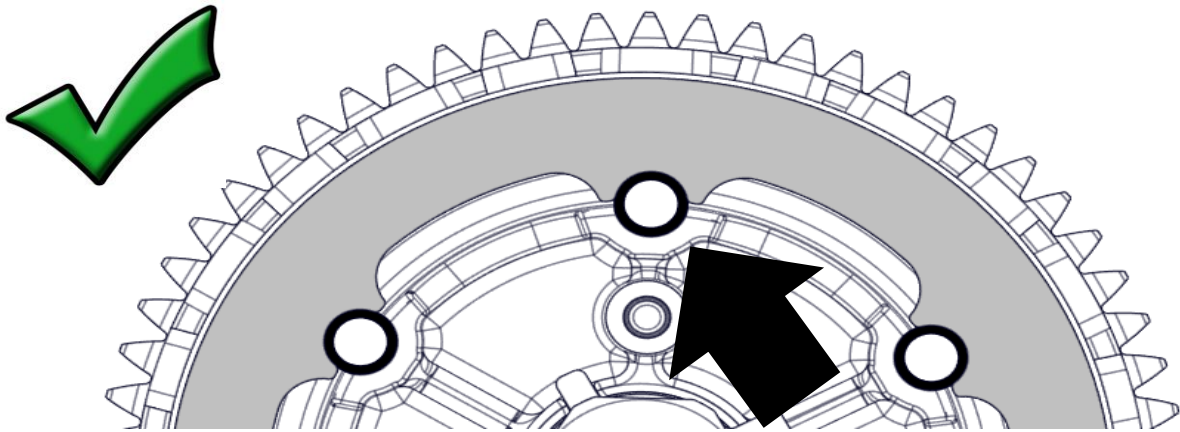

2. On top of the steel drive plate, install a Rekluse friction disk.

NOTE: The OE basket has tapered slots in alternating basket tangs. Rekluse products require the entire clutch pack be installed into the MAIN (deeper) basket slots. Installing the pack in the tapered slots will cause performance issues. See the following picture for reference.

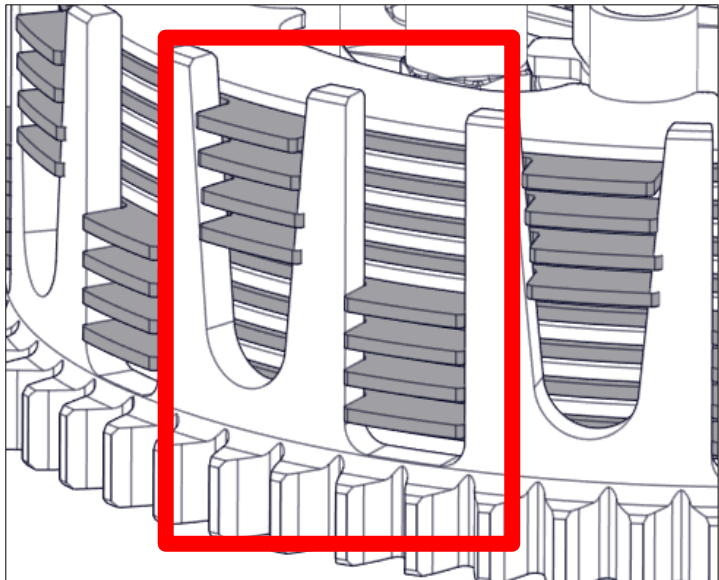
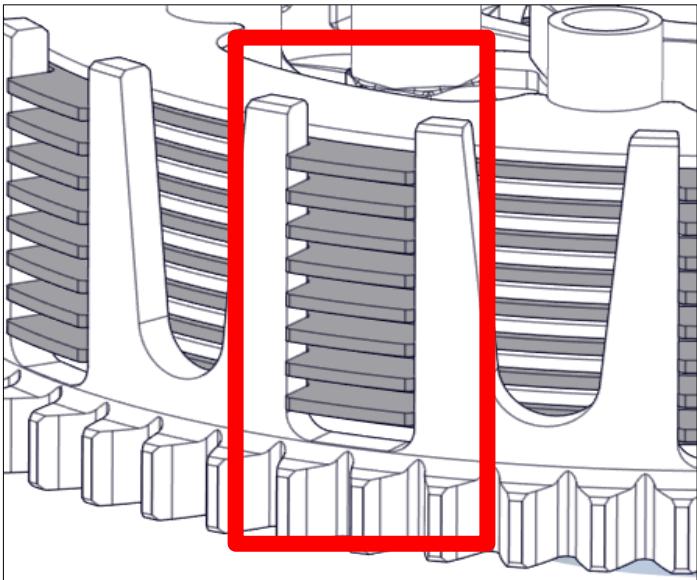

3. Alternate the Rekluse .060" (1.5 mm) steel drive plates and friction disks for the entire clutch pack, for a **total of 8 steel drive plates and 7 friction disks**. *You will have one .048" (1.2 mm) steel drive plate left over.*
4. On top of the last friction disk, install the last .048" (1.2 mm) steel drive plate.

NOTE: *Some friction disks are marked with a small colored dot. This mark is used for processing and can be ignored.*

Total clutch pack:
8 steel drive plates and 7 friction disks

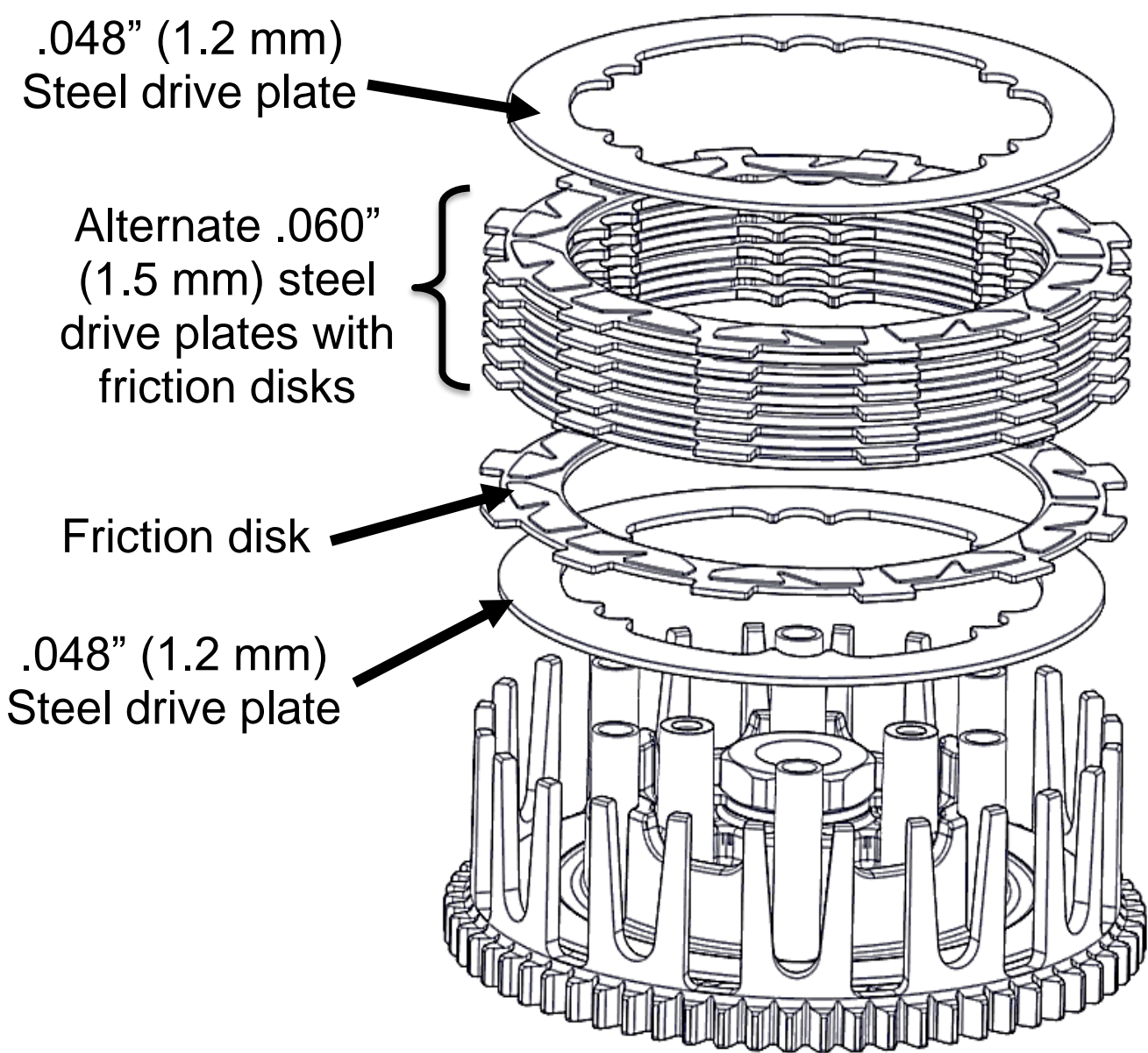

PRESSURE PLATE INSTALLATION

1. Install the OE pressure plate onto the clutch pack.
2. Place the OE slider ring on the pressure plate with the “top” marking facing up. (The top side is rounded and the bottom edge is sharp.)

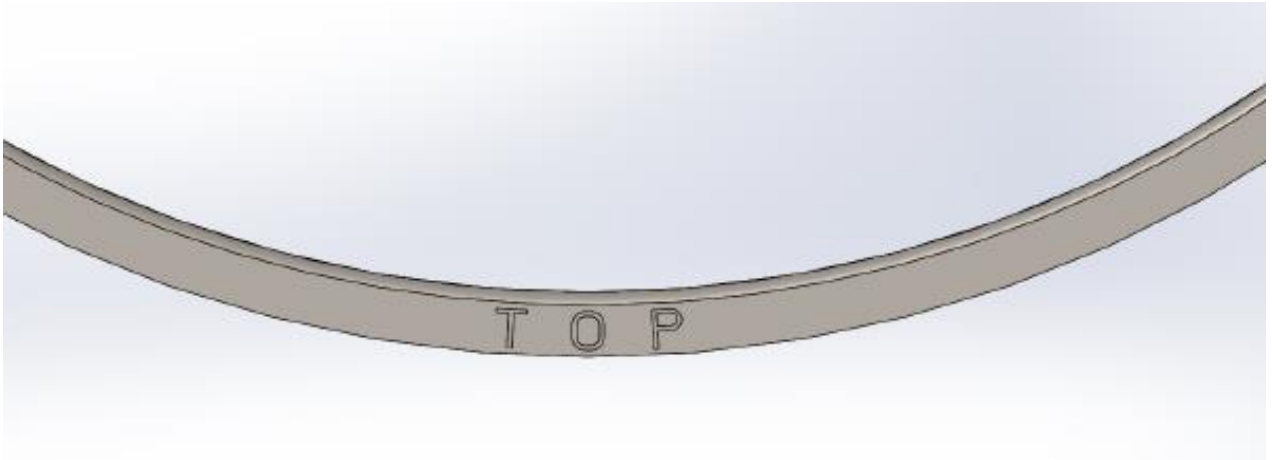

3. Install the OE Belleville spring onto the slider ring, with the rounded dome side facing up. See pictures for reference.

NOTE: *The outer edge of the Belleville spring will make contact with the slider ring. If it does not, the Belleville spring is upside down.*

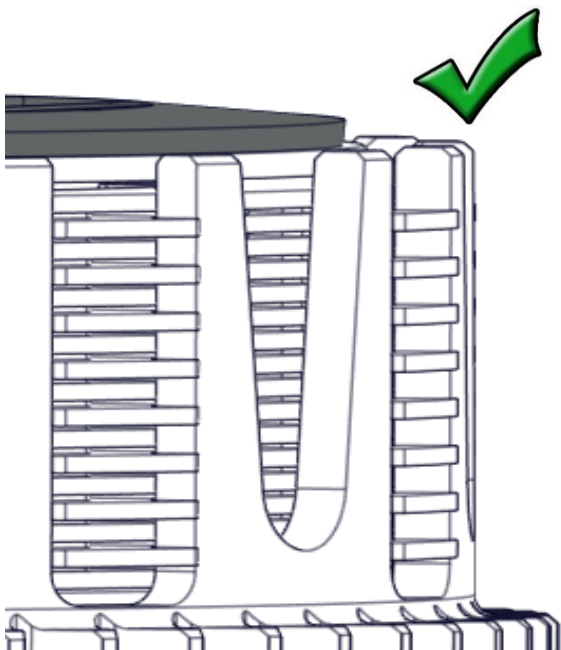

Correct – The Belleville spring sits flat against the slider ring.

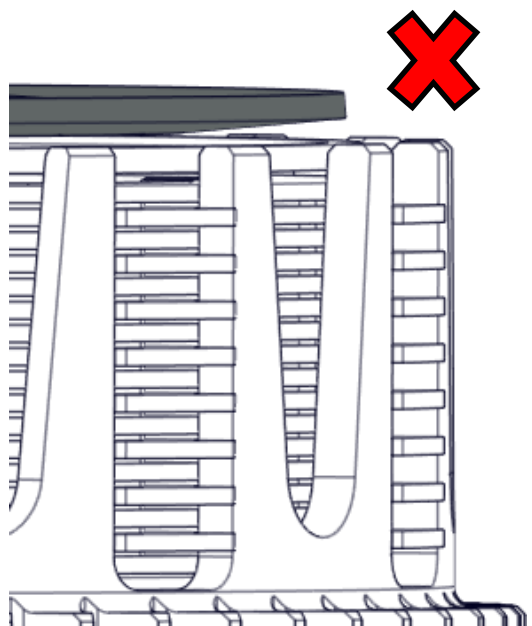

Incorrect – The Belleville spring is upside down.

4.Reinstall the OE spring ring.

NOTE: *There are 3 possible settings on the OE spring ring. Rekluse recommends setting “2” for optimum clamping force and performance. See the **Setup Sheet located at the back of the manual** for more information.*

5.Reinstall the OE pressure plate screws.

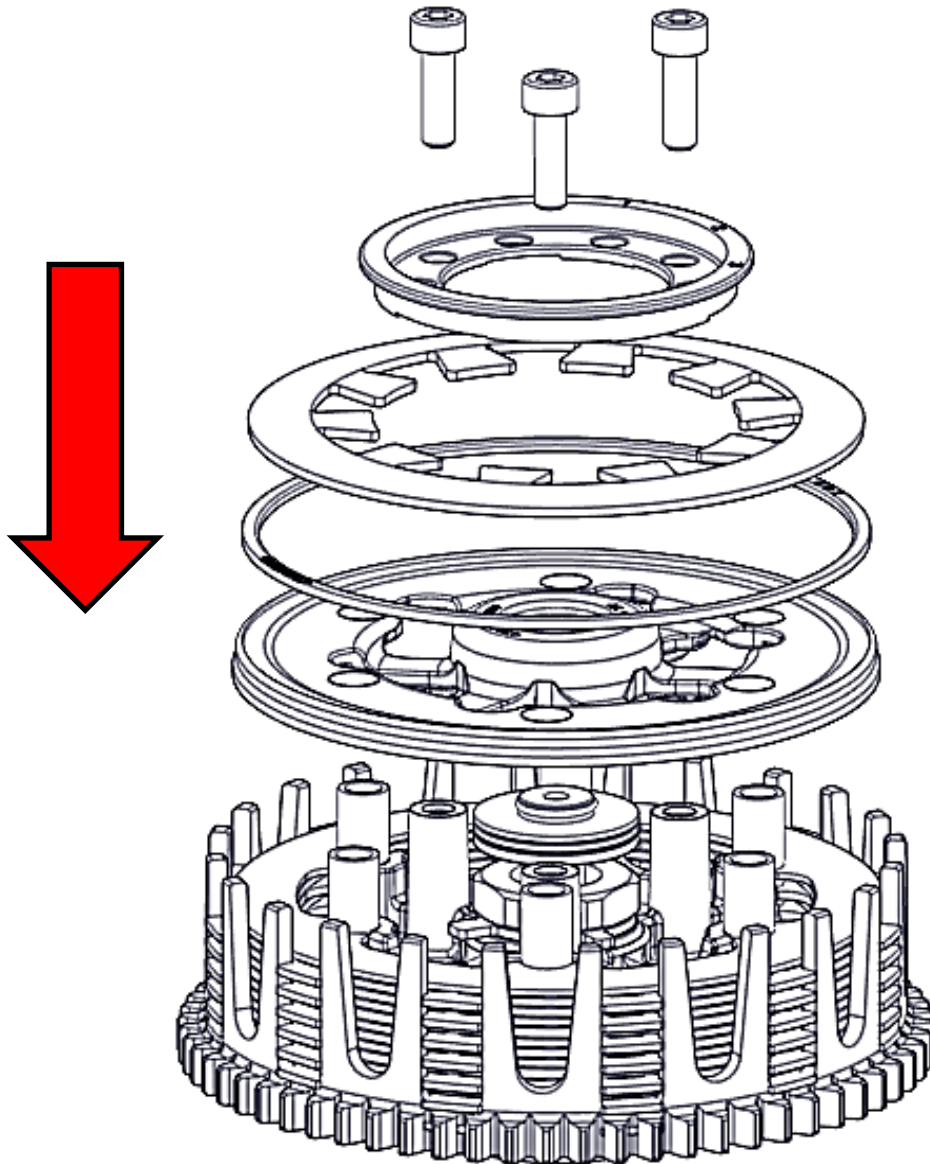

6.Torque the pressure ring screws to **55 in-lb (4.5 ft-lb) (6 N-m)**.

7.Reinstall the clutch cover, then reinstall the clutch cover bolts. Lightly tighten the cover bolts in small increments in a star pattern. Torque the cover bolts to OE specifications.

MAINTENANCE

Clutch wear

Rekluse clutches are built using high quality materials but do wear based on the rider's use, type of terrain, and natural wear and tear.

- Clutch longevity and performance is greatly increased with oil quality and other bike factors that reduce engine heat.
- Riding style, such as speed, engine RPM, and terrain can also effect the life of the clutch.
- To keep your clutch performing at its best, perform regular maintenance on your bike and clutch based on your riding style.

Clutch parts

Inspect all of your clutch parts at regular intervals for signs of wear or excessive heat, and replace components as necessary.

- The OE spring ring can be optimized based on the wear and height of the clutch pack. See the **Setup Sheet at the back of the manual** for the specific clutch pack measurements.
- Repeat the break-in procedure anytime you replace the frictions disks. Always soak new friction disks in fresh oil before installing.
- Measuring the clutch pack can help determine if the components need replacing. The clutch pack is measured with the entire clutch pack together. Include the friction pad in the measurement.
- Disk inspection examples are found in the following section.

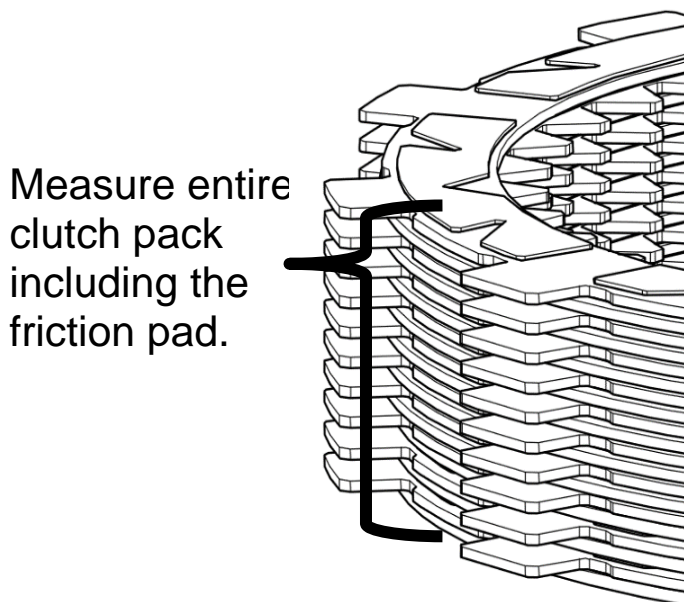

Preventive Maintenance

- For optimal clutch performance Rekluse recommends using fresh, clean oil that **meets JASO-MA** oil rating requirements.
- Keep up with regular oil changes as per the bike manufacturer's recommendations. Clutch performance and longevity depend on oil quality.
- Change the oil filter and/or clean the oil screen with every oil change.
- **Disk inspection examples:** When inspecting the clutch pack, the following pictures can be used as a reference. **These are best viewed in color by viewing this install document on our website at www.rekluse.com/support.**

Drive Plates – If the clutch pack is getting high amounts of heat, purple, blue, or black color can be seen on the drive plate teeth. See pictures below. Not all drive plates look the same and may look different than pictured.



Normal Heat

High Heat
(Blue)

Excessive Heat
(Black)

Friction Disks – Due to the dark color of the friction material, the friction disks will appear almost black as soon as they are put in oil. During inspection, look for glazing of the friction material. Glazing will appear shiny and feel like glass, even after oil is cleaned from the friction disk. Not all friction disks look the same and may look different than pictured.

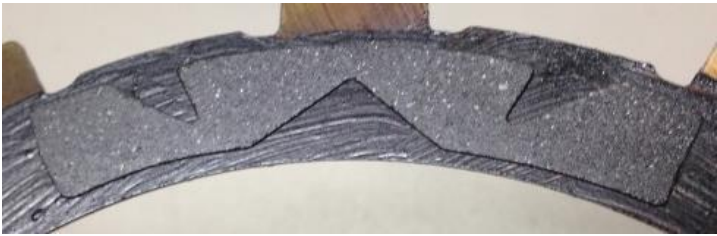

Normal Friction



Glazed Friction

NEED ADDITIONAL HELP?

Website

www.rekluse.com/support

Frequently Asked Questions

www.rekluse.com/faq

Support Videos

www.rekluse.com/support/videos

Phone

(208) 426-0659

Technical Support

Contact Technical Support for questions related to product installation, tuning, and performance.

Hours:

Monday thru Friday: 8:00 a.m. - 5:00 p.m.

Mountain Time zone

Email: tech@rekluse.com

Customer Service

Contact Customer Service for additional product information, orders, and returns.

Hours:

Monday thru Friday: 8:00 a.m. - 5:00 p.m.

Mountain Time zone

Email: customerservice@rekluse.com

