

INSTALLATION INSTRUCTIONS

ATTENTION INSTALLER (if other than owner): Please forward this Instruction Sheet to the purchaser of this product. These instructions contain valuable information necessary to the end user.

INTRODUCTION: These instructions describe the procedure for properly installing the Fender Edge Light on 14-16 XL883N, XL1200V, and 14-16 models with the chopped rear fender.

Review instructions carefully before beginning, as they contain important information. Please retain for future reference.

Particularly important information is distinguished in these instructions by the following notations:

NOTE: A **NOTE:** provides key information to make procedures easier or clearer.

CAUTION: (Shaded) A **CAUTION:** Indicates special procedures that must be followed to avoid damage to the motorcycle and/or accessories.

WARNING!: (boxed and shaded) A **WARNING!:** Indicates special procedures that must be followed to avoid injury to a motorcycle operator or person inspecting or repairing the motorcycle.

PROCEDURE: INSTALLATION

1. See the owner's manual and remove the seat and main fuse.
2. Remove the stock reflector from the rear of the fender if installed.

NOTE: The surface of the rear fender where the fender edge light will be mounted must be very clean for the adhesive pads of the light to properly adhere.

DRAG SPECIALTIES FENDER EDGE LIGHT 2010-1160/1161

3. Thoroughly clean the area inside the rear fender where the fender edge light will be mounted and along the inner left side of the fender where the wire clips may be mounted:

- a. Clean the mounting area of the fender thoroughly with soap and water.
- b. Clean the mounting area of the fender with an approximately 1:1 mixture of isopropyl alcohol and water.
- c. Allow the fender to dry completely

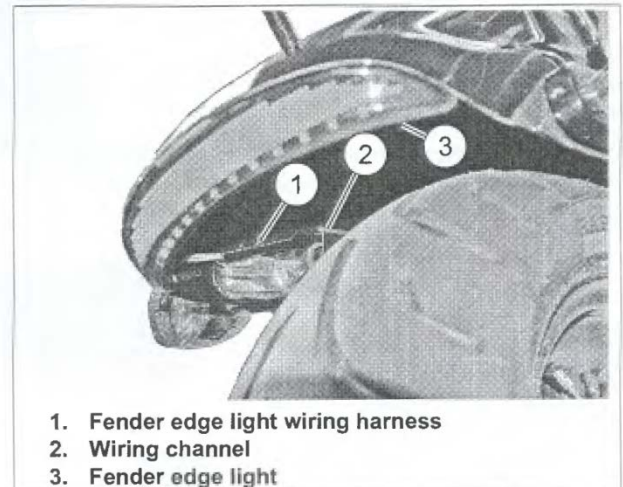

Figure 1. Fender Edge Light

4. See Figure 1. Test the fit of the fender edge light into the open end of the rear fender to verify that the fender edge light will fit properly without obstruction.
5. See Figure 3. Remove the protective liner (A) from the three adhesive pads on the fender edge light (1).

NOTE: The adhesive pads of the fender edge light are pressure sensitive. Press each adhesive pad firmly in place by hand for best adhesion.

6. Press the fender edge light firmly into place in the open end of the rear fender.

7. Remove the protective liner from the adhesive pad (B) of the reflector mount (6) and install the reflector to the center of the fender edge light. Press firmly in place for best adhesion.

WIRING

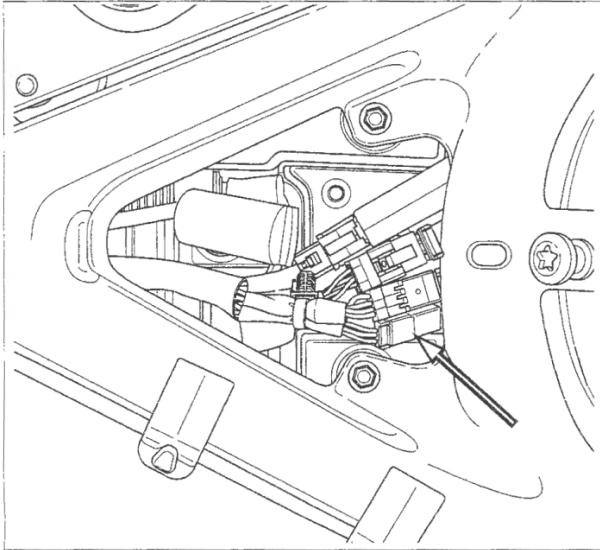

Figure 2. Rear Lighting Harness Connector

1. See Figure 2. Locate and disconnect rear lighting harness connector from the main wiring harness connector.
2. Connect interconnect harness (3) to rear lighting harness connector and main wiring harness.

NOTE: The surface of the rear fender where the wire clips will be mounted **must be very clean** for the adhesive pads to properly adhere.

3. Route the light assembly wiring harness along the inner left side of the fender to the fender pass through hole. Secure the wire harness to the inner fender wall with wire clips from the kit. Then route the harness to pass through of the rear fender to the seat pan area and the interconnect harness.

NOTE: See the service manual for additional information on assembling the Multi lock connector, if necessary.

4. See Figure 3. Insert the wires and terminals from the light assembly harness into the pin housing (2) from the kit:

- a. Insert the **blue** wire into cavity 1.
- b. Insert the **red/yellow** wire into cavity 2.
- c. Insert the **black** wire into cavity 3.

5. Connect the light assembly harness to the interconnect harness 3-place connector.

6. Secure the interconnect harness in the seat pan area as necessary with cable straps (5).

RETURN TO SERVICE

1. Refer to the owner's manual and follow instructions to install the main fuse.

2. Turn the ignition key switch to IGNITION, but do not start the motorcycle.

Test the fender edge light **and** the motorcycle lamps for proper operation:

- a. With the ignition switch on, the LEDs in the fender edge light should be illuminated, along with the vehicle tail lamps.
- b. When either the brake hand lever or foot pedal are activated, the LEDs in the fender edge light should noticeably brighten, along with the vehicle stop lamps.
- c. When either turn signal switch is activated, the LEDs in the fender edge light should remain lit steadily, and not flash.
- d. Turn the ignition key switch to OFF. The fender edge light should turn off immediately, along with the vehicle tail lamps.

3. Refer to the owner's manual and follow instructions to install the seat.

WARNING!: Before operating motorcycle, be sure all hardware is tight.

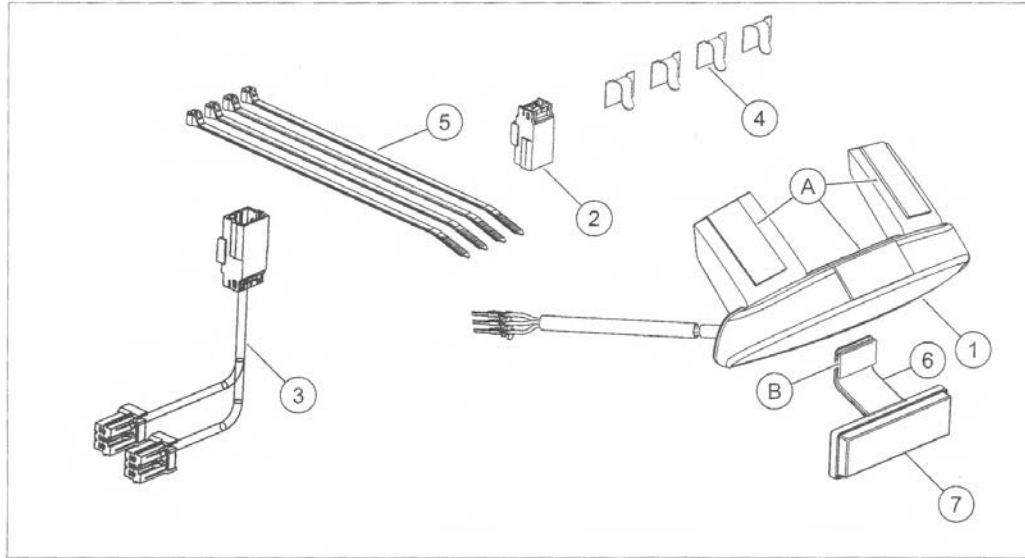

Figure 3. Service Parts: Fender Edge Light Kit

Table 1. Service Parts

Item	Description (Quantity)
1	Fender Edge Light Assembly
2	Pin housing, three-way
3	Harness, interconnect
4	Clip, adhesive-backed (4)
5	Cable strap (4)
6	Mount, reflector
7	Reflector
Items mentioned in text:	
A	Adhesive pads
B	Adhesive pad