

Thank you for purchasing this Dynojet kit. This kit has been developed for a motorcycle which is set to the parameters listed at the right in the "Stage" description. If your motorcycle does not meet any of these parameters please check with Dynojet before installation. For technical assistance contact your Dynojet distributor or call Dynojet U.S.A. (800)-992-4993

2191 Mendenhall Dr. Suite 105
 North Las Vegas, NV 89081
 TEL: 702-399-1423
 FAX: 702-399-1431
 8am-5pm Pacific Time
 Monday through Friday

Website Address
<http://www.dynojet.com>

The manufacturer and seller make no warranties express or implied which extend beyond the description of the goods contained herein. Any description of this product is for the purpose of identifying it and shall not be deemed to create an express warranty.



3138.002

U.S Models Only

1990-2016 Suzuki DR650S

Stage 1&2

STAGE 1 1990-1996 ONLY

For mildly tuned machines using the stock airbox, with stock or K&N filter #SU-6590

STAGE 2 1990-2016 ONLY

For mildly tuned machines using stock airbox with lid removed. K&N filters #SU-6590

Both stages may be used with a good aftermarket exhaust

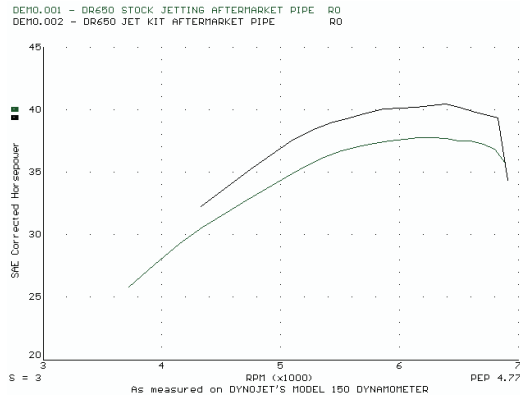

This graph shows a typical gain with a Dynojet jet kit.

WARNING

**NO SMOKING!
 NO OPEN FLAME!
 WHILE INSTALLING
 YOUR DYNOJET KIT**

PARTSLIST		
1	Main Jet	DJ150
1	Main Jet	DJ155
1	Main Jet	DJ160
1	Main Jet	DJ170
1	Fuel Needle	DNT604
1	E-Clip	DE0001
1	Adjusting Washer	DW0001
1	Screw	DS0001
1	Plug Drill	DD 5/32

STAGE ONE INSTRUCTIONS

**NOT APPLICABLE FOR 1996-2016 MODELS

1. Remove the vacuum slide from the carb. Remove the stock needle and spacers, noting order of assembly (Fig.A).
2. Install the Dynojet needle on groove #4 from the top. **OMIT the white nylon spacer** (Fig. A). Install the small Dynojet washer above the e-clip. After installing the slide in the carb be sure to check slide movement manually.
3. Remove the stock main jet and replace with the Dynojet main jet provided. If you are running the stock exhaust install the DJ150. If you are running an aftermarket exhaust or slip-on with high flowing baffle use the DJ155. Be sure that the jet you are changing is the main jet.
4. Locate the fuel mixture plug (Fig. B). If you see a screw head at Fig.B then proceed to the adjusting procedure. With the 5/32 drill bit provided carefully drill through the plug. **NOTE: The mixture screw is directly underneath this plug, be ready to pull back on the drill the instant you break through.** Use screw provided to secure and remove this plug. Carefully turn the mixture screw clockwise until lightly seated, then back out 2.5 turns.

Fig. A

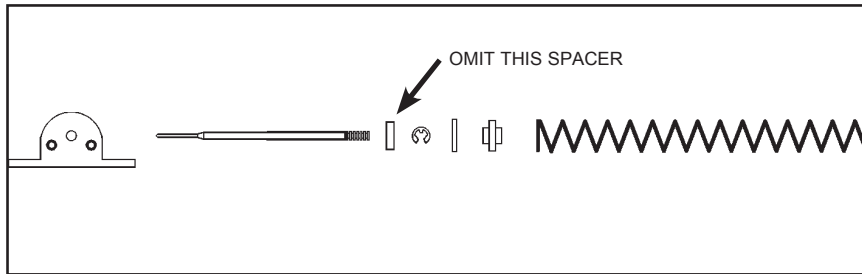

STAGE TWO INSTRUCTIONS

**REQUIRES AIRBOX LID REMOVAL

1. Remove the vacuum slide from the carb. Remove the stock needle and spacers, noting order of assembly (Fig.A).
2. Install the Dynojet needle on groove #4 from the top. **OMIT the white nylon spacer** (Fig. A). Install the small Dynojet washer above the e-clip. After installing the slide in the carb be sure to check slide movement manually.
3. Remove the stock main jet and replace with the Dynojet main jet provided. If you are running the stock exhaust install the DJ155. If you are running an aftermarket exhaust or slip-on with high flowing baffle use the DJ160. Be sure that the jet you are changing is the main jet. **NOTE: On 1996-2016 models use DJ160 with the stock exhaust and DJ170 with a high flow aftermarket exhaust.**
4. Locate the fuel mixture plug (Fig. B). If you see a screw head at Fig.B then proceed to the adjusting procedure. With the 5/32 drill bit provided carefully drill through the plug. **NOTE: The mixture screw is directly underneath this plug, be ready to pull back on the drill the instant you break through.** Use screw provided to secure and remove this plug. Carefully turn the mixture screw clockwise until lightly seated, then back out 2.5 turns.

Dynojet

3138.002

Fig. B

