

MOTOPLASTIC, S.A.

Molí de la sal, 1 - 08400 Granollers (Barcelona) SPAIN

Tel. 34 93 849 06 33 - Fax 34 93 849 09 88

info@puig.tv

www.puig.tv







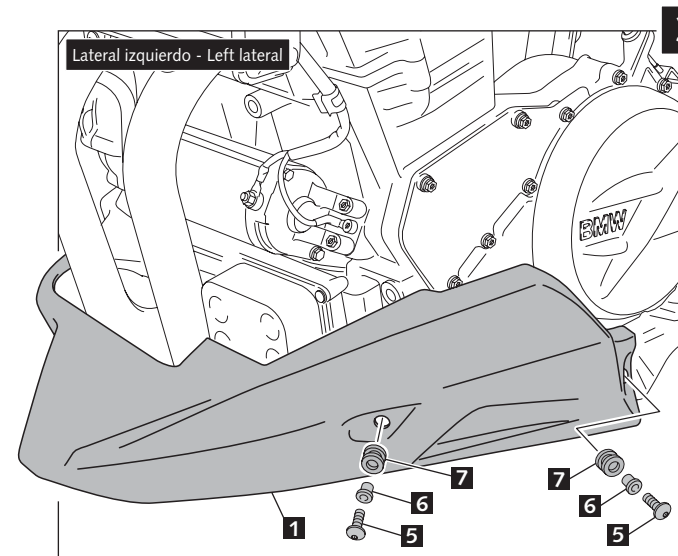
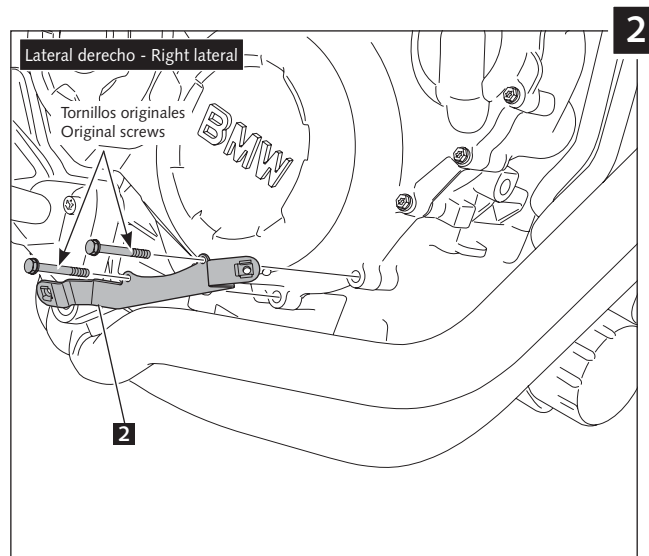
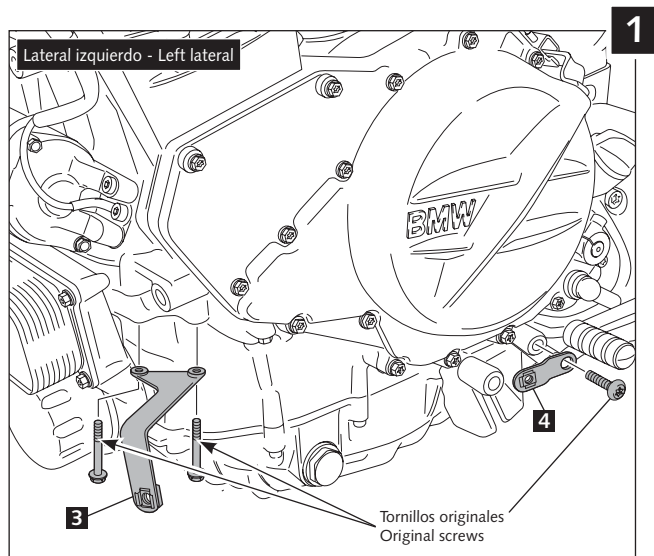

INSTRUCCIONES DE MONTAJE - MOUNTING INSTRUCTIONS

QUILLA ADAPTABLE A - ENGINE SPOILER ADAPTABLE TO BMW F800 S/R

Ref.: 5048N
(color negro/black colour)

Ref.: 5048C
(color carbono/carbón look)



ID.	DESCRIPCIÓN	DESCRIPTION	QTY.
1	 Quilla	Engine spoiler	1
2	 Soporte metálico derecho	Right metal support	1
3	 Soporte delantero metálico izquierdo	Left metal support front	1
4	 Soporte trasero metálico izquierdo	Left metal support rear	1
5	 Tornillo Allen M6x20 ISO 7380	M6x20 ISO 7380 Allen screw	4
6	 Casquillo con valona (se suministra montado en la pieza nº1)	Bush with flange (supplied fitted to Part No. 1)	4
7	 Silemblock (se suministra montado en la pieza nº1)	Wel nut (supplied fitted to Part No. 1)	4
8	 Conjunto adhesivos (ver anexo)	Sticker set (annexe)	1
-	 Separador de silicona diámetro 12,7x3,5 (se suministra montado en el lateral derecho de la pieza nº 1)	12,7x3,5 silicone spacer (supplied fitted to the right-hand side of nº 1)	1

