

#H3502,H3503,H3506,H3507 Bobber Style Rear Fender kit & Type II

! Before installation, thoroughly familiarize yourself with the instructions and illustrations. After installation, make sure all components fit and function correctly before use.

(1)	Bobber Style Rear Fender or Type II	1	(5)	Spacer for Grommet	1
(2)	Side Support	2	(6)	Button Head Bolts M8 × 50	2
(3)	Seat Nuts	1	(7)	Button Head Bolts M8 × 35	2
(4)	Grommet	1	(8)	Flanged nuts M8	4

*required drilling hole on proper portion when put any taillight or double seat

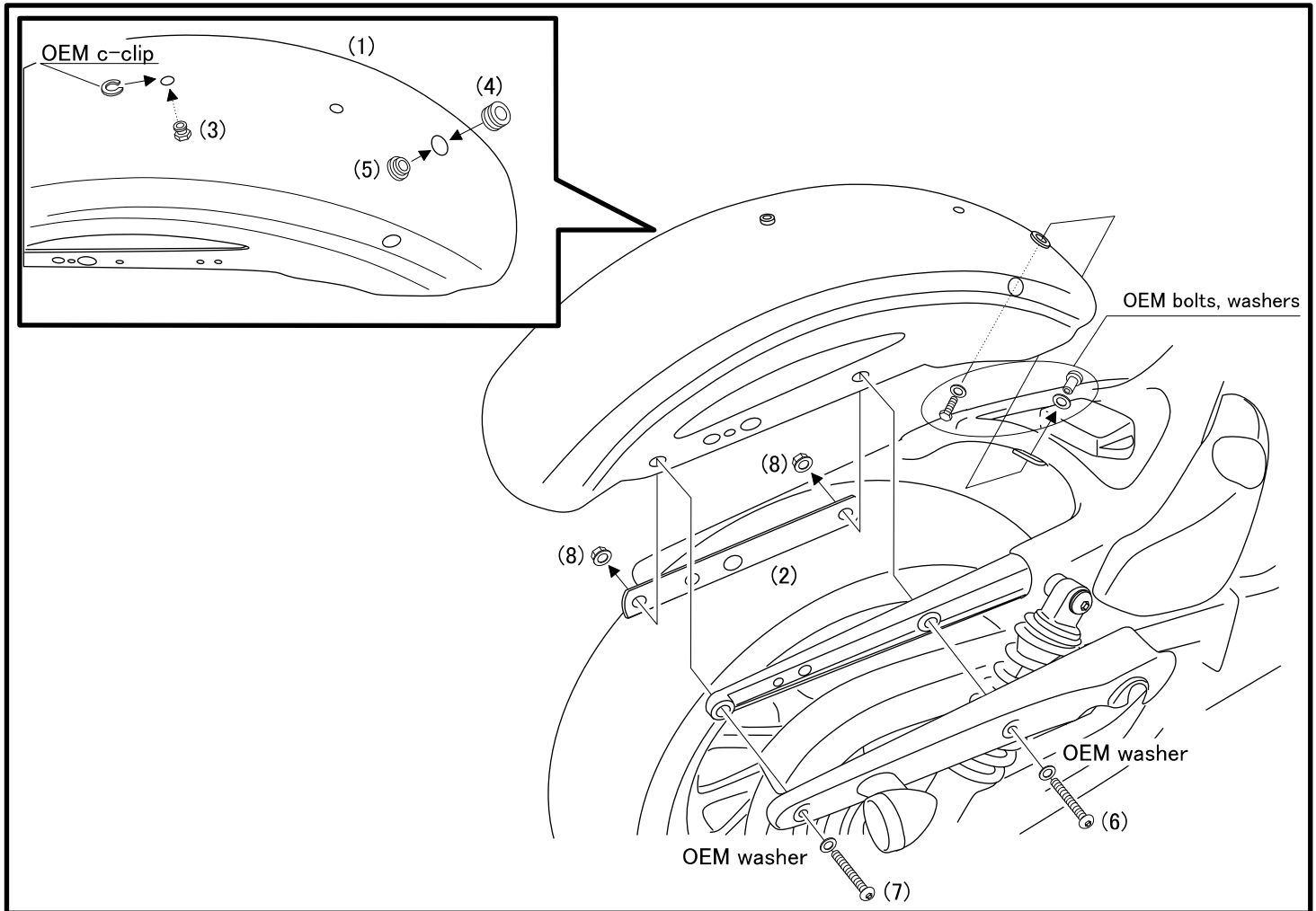

【取付手順】

Step1. Remove seat and turn signals and taillight wiring.

Step2. Remove right and left struts and rear fender.

Step3. Install (3)Seat Nuts, (4)Grommet and (5)Spacer on (1)Bobber rear fender.
Use OEM c-clip to install (3)Seat Nuts.

Step4. Refer to the drawing above, install (1)fender using (2)Side Supports, (6)(7)Button Head Bolts, (8)Flanged Nuts and OEM hardware.
*Be careful not to interfere fender and any wirings.

Step5. Install seat, check fastened bolts, nuts and every hardware, lighting turn signals and taillight.

*required to put ECM mounting plate on the fender for '07-'09 models. Installing ECM plate, some fenders are hard to put it on. In this case, shave edge portion of ECM plate, and put it on fender using double-stick tape.

EASYRIDERS, INC.

5-44-10 Kamikitazawa Setagaya-ku Tokyo Japan 156-0057

Ph. +81-3-3306-5647 / Fax +81-3-3306-5545

www.easyriders.jp