

# WOODCRAFT CFMOTORSPORTS

105 Baldwinville Rd  
Winchendon, MA 01475  
(978)297-2977

[www.woodcraft-cfm.com](http://www.woodcraft-cfm.com)

## Kawasaki Ninja 650R (12+) Rearset Instruction Sheet – Racing Use Only

Thank you for selecting CFMOTORSPORTS rearsets. The components you have just purchased for your motorcycle are designed to improve the ground clearance, crash worthiness and overall good looks of your motorcycle. Please note that these components are intended and approved for **racing use only**. As such, the footpegs are solid-mount and provisions for brake light switches and brake pedal return springs are not provided.

- 1) Remove stock rearsets, footpegs and associated hardware. All components that are re-used in this kit should be cleaned and inspected for damage before re-installation.

### **IMPORTANT**

Tighten all fasteners to factory specification or industry standard. FAILURE TO PROPERLY TIGHTEN ALL FASTENERS MAY CAUSE DAMAGE TO THE MOTORCYCLE, LOSS OF CONTROL AND SERIOUS INJURY OR DEATH

These rearsets come with an option for either low or high footpeg position. When installing the footpegs, brake pedal and master cylinder is it important that you place **all** components in the same position for the kit to function properly.

### **Brake Side Assembly Installation**

- 1) Assemble the CFM Brake Pedal (3) **IMPORTANT** - Secure the two main shaft bolts (FH 6x20) with **THREADLOCKING COMPOUND**.
- 2) Bolt the CFM brake pin (4) and brake pedal (3) (OEM or CFM) to the backside of the bracket. Be sure to generously apply quality waterproof grease to the sliding surface of the footpeg to ensure smooth lever operation. Capture the brake pedal assembly using the bolt (8) and washer (9). **IMPORTANT** – Secure all bolts with **THREADLOCKING COMPOUND**.
- 3) Bolt the footpeg to the bracket using the included 10mm hardware (11). Bolt the brake side bracket to the frame using the included bolts (6), placing the spacers (7) between the bracket and the frame. **IMPORTANT** - Secure the footpeg bolt with **THREADLOCKING COMPOUND** once you have found the position that you like.
- 4) Attach the master cylinder to the bracket using the OEM hardware (running the OEM bolts first through the heel guard (5) and then through the main bracket (1). Re-connect the brake pedal to the master cylinder clevice using the OEM pin.

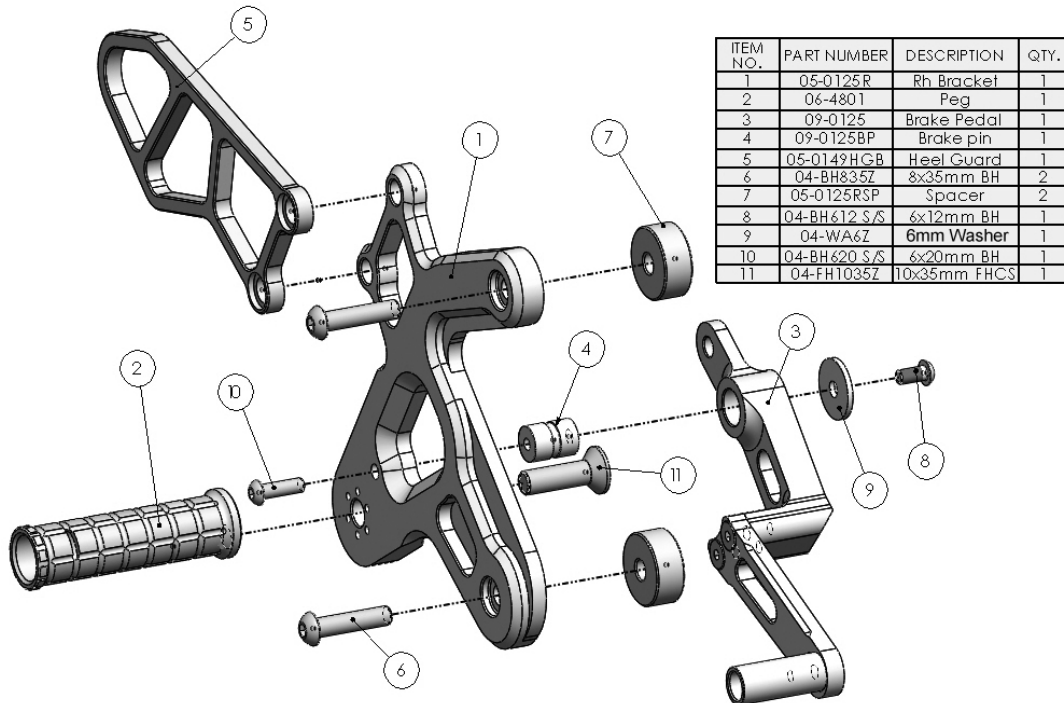

### Shift Side Assembly Installation

- 1) Remove the stock shift pedal. Install the supplied shift actuator assembly (11) in place of the shifter.  
**GP Shift:** Install the actuator so that it points approximately to the 6 o'clock position.  
**Standard Shift:** Install the actuator so that it points approximately to the 12 o'clock position.
- 2) Assemble the CFM shift pedal. **IMPORTANT** - Secure all shifter bolts with **THREADLOCKING COMPOUND**.
- 3) Secure the shift pedal (10) and footpeg (2) to the bracket (1) using the included 8 x 35mm bolt (5), sleeve (4), spacer (12) and wave washer (3). **IMPORTANT** – Secure the bolt with **THREADLOCKING COMPOUND**. Be sure to generously apply quality waterproof grease to the sliding surface of the footpeg to ensure smooth lever operation.
- 4) Secure the main bracket (1) to the frame using the supplied bolts 8 x 30mm (7), placing the spacers (6) between the bracket and the frame.
- 5) Install the shift rod by simultaneously threading it on the actuator and shift pedal. Rotate the rod turn by turn until the desired pedal height is achieved. It is important that the rod (8) and actuator (11) be oriented so that they are approximately 90 degrees to each other. It may be necessary to rotate the actuator on the spline to properly achieve this 90 degree orientation. Once the desired position is reached, lock the rod in place on both sides using the 6mm locknuts on the heim joints.

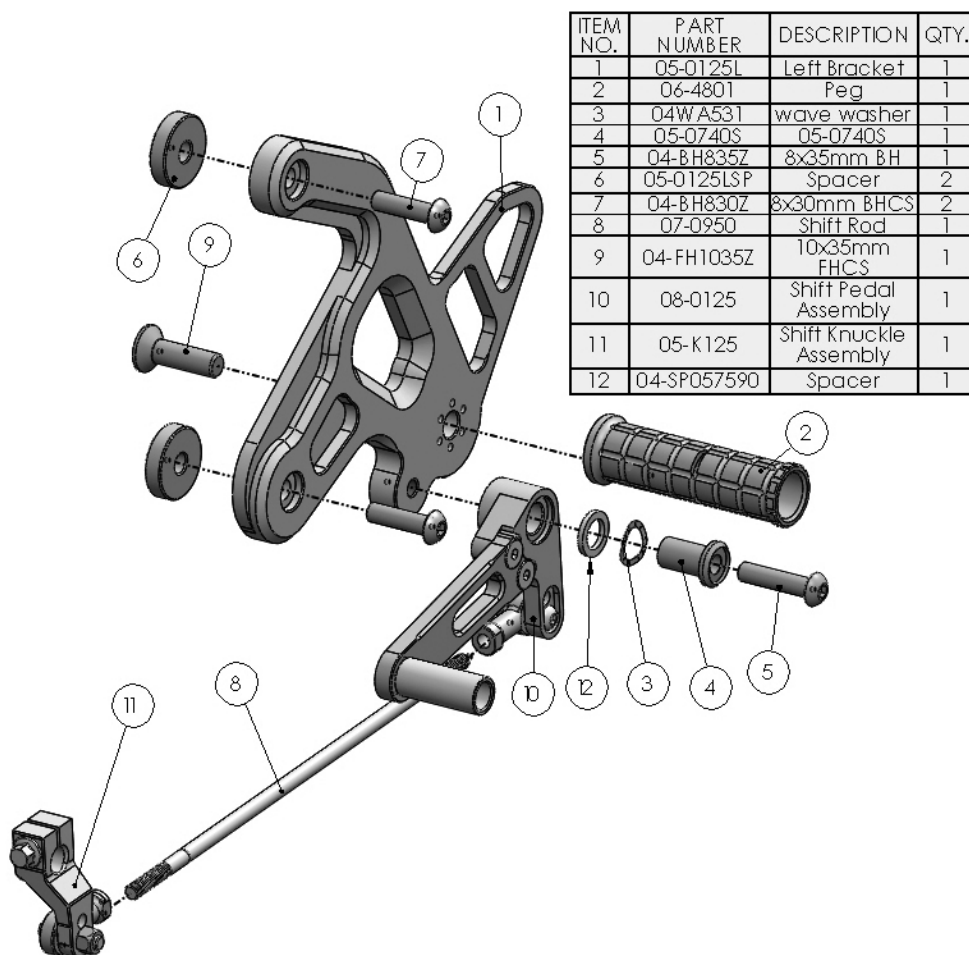

BE SURE THAT ALL COMPONENTS OPERATE AND RETURN FREELY BEFORE USE  
If you have any questions regarding installation, please feel free to contact us.

#### **IMPORTANT**

Installation and use of this product will change the response of the motorcycle to rider control inputs. Failure of the rider to adapt to these changes may result in a loss of control, and serious injury or death. Improper installation and/or failure to comply with all warnings and instructions may cause a loss of control and serious injury or death. **DO NOT INSTALL OR USE THIS PRODUCT IF YOU ARE UNABLE TO DO SO IN COMPLIANCE WITH ALL INSTRUCTIONS AND WARNINGS. SEEK THE ASSISTANCE OF A TRAINED PROFESSIONAL TECHNICIAN.** Installation of this product releases the Woodcraft Technologies, Inc. from all liabilities as to the use of this product. The user recognizes that any alteration or modification to any motorcycle may increase the risk of injury or accident and may also render the motorcycle illegal for public road use