



# YOSHIMURA

RESEARCH&DEVELOPMENT OF AMERICA, INC.

5420 DANIELS STREET STE A, CHINO CA, 91710 · (800)634-9166 · (909)628-4722 · FACSIMILE (909)591-2198

**[www.yoshimura-rd.com](http://www.yoshimura-rd.com)**

## **OFF-ROAD PERFORMANCE EXHAUST SYSTEM**

**HONDA  
2006-2008  
CRF450R**

**2255703**

STAINLESS STEEL SLIP-ON SYSTEM WITH ALUMINUM SLEEVE

NOTE: THIS SYSTEM IS DESIGNED FOR USE IN CLOSED COURSE COMPETITION AND IS NOT INTENDED FOR ANY OTHER USE.



**THIS PRODUCT IS DESIGNED FOR USE IN CLOSED COURSE  
RACING AND IS NOT INTENDED FOR ANY OTHER USE.**



CAUTION: The muffler packing on this system **MUST** be replaced every 6-8 hours of use, or after each moto. Failure to follow recommended muffler re-packing interval can cause muffler damage and may void the warranty.



NOTE: IN THE STATE OF CALIFORNIA, IT IS ILLEGAL TO MODIFY THE EMISSION CONTROL SYSTEM. WHICH INCLUDES THE CARBURETORS OF ANY VEHICLE.

**Caution:** Exhaust system may be extremely hot. Let motorcycle cool down before beginning installation.

**Note:** Read through all instructions before beginning installation.

## Tools Needed:

8mm, 10mm, and 12mm Sockets  
11mm (7/16") Deep Socket  
Ratchet Wrench and Extension  
Torque Wrench  
Spring Puller Tool

## Installation Steps:

- 1 Remove right rear number plate (see Fig. 1 for fastener locations).
  - 2 Remove stock muffler (see Fig. 2 for fastener locations).
  - 3 Remove stock header.
  - 4 Disconnect Yoshimura muffler from Yoshimura tailpipe using the supplied spring puller tool.
  - 5 Slide stainless steel collector clamp over Yoshimura tailpipe and connect the Yoshimura tailpipe to the stock header. Connect stock header to cylinder head using stock header nuts. Leave loose.
- NOTE:** Gasket is not used between the header and tailpipe.
- 6 Bolt tailpipe to chassis mount using supplied 20mm bolt . Leave loose.
  - 7 Install supplied rubber grommet into muffler mounting bracket. Install aluminum insert into rubber grommet. Make sure that the shoulder of the aluminum insert faces toward the frame (see Fig. 3).
  - 8 Slide Yoshimura muffler onto Yoshimura tailpipe. Mount muffler to stock muffler mount location using supplied 40mm bolt and washer.
  - 9 Connect Yoshimura muffler to Yoshimura tailpipe using the supplied springs and spring puller tool.
  - 10 Torque header nuts to 1.0 kg-m (7.3 lb-ft).
  - 11 Torque muffler mount and chassis mount bolt to 2.5 kg-m (18 lb-ft).
  - 12 Torque stainless steel collector clamp to 1.25 kg-m (9 lb-ft).
  - 13 It is recommended that the muffler and tailpipe be wiped down with rubbing alcohol to remove oil and fingerprints. This will help prevent tarnishing of the finish after the exhaust is heated up.



Fig. 1



Fig. 2

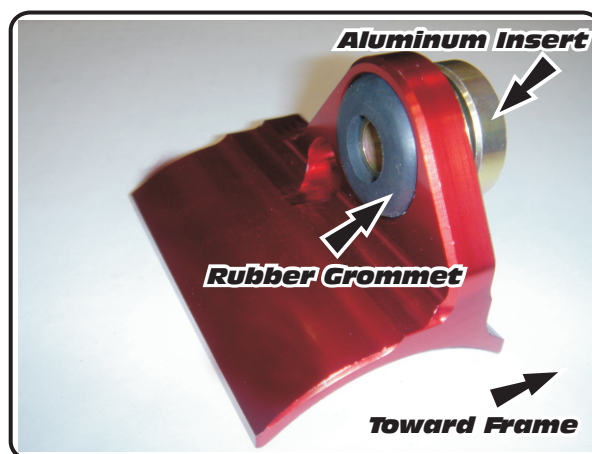
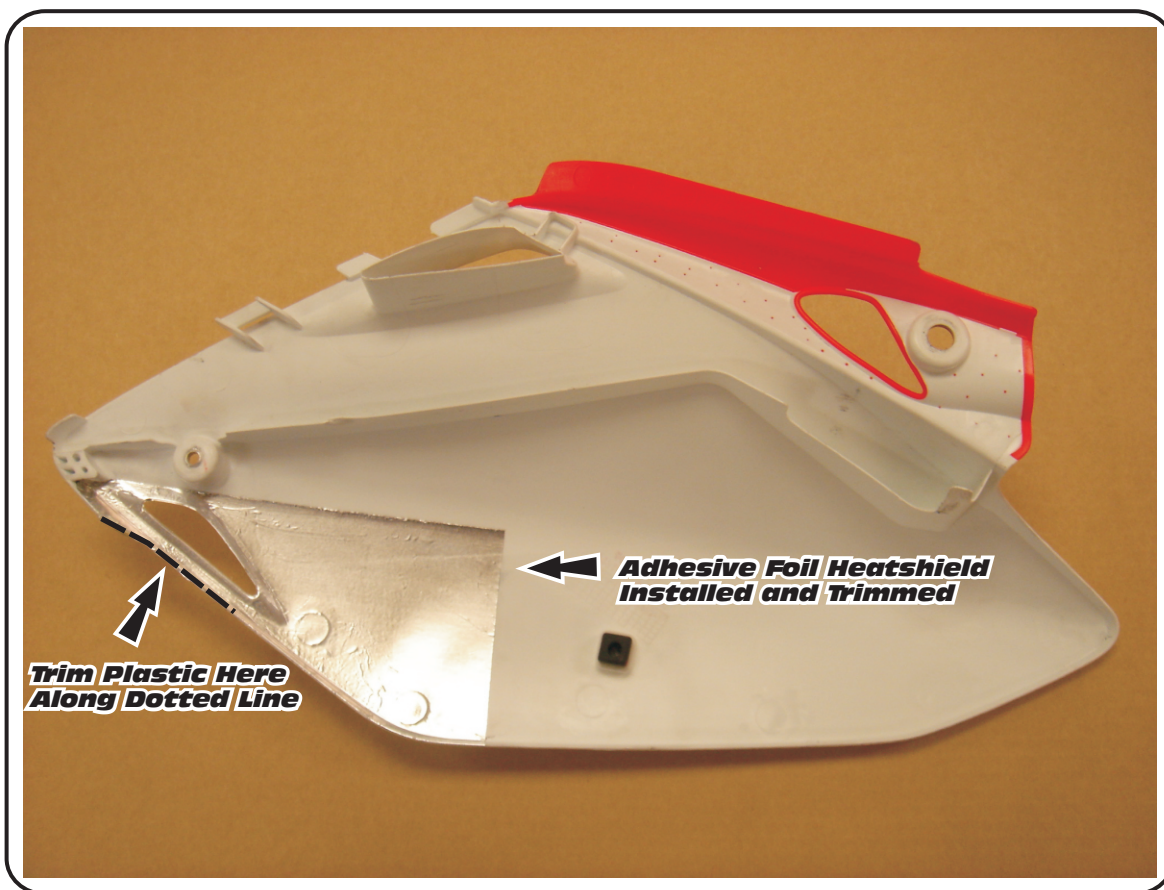

Fig. 3

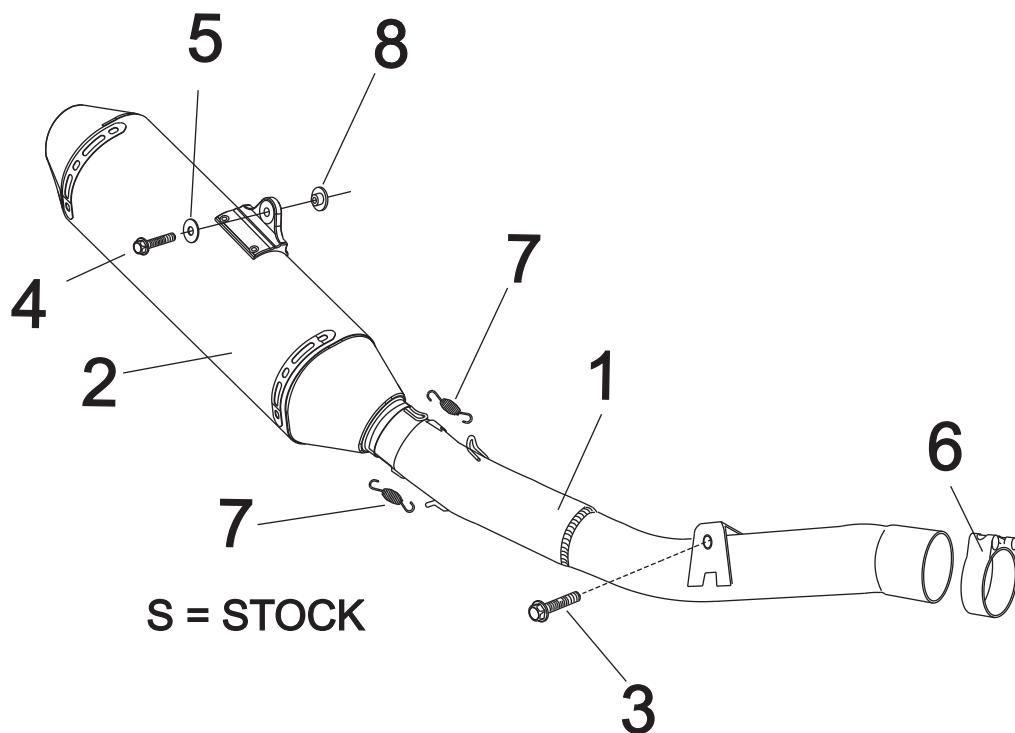

**Fig. 4**

- 14 Before starting motorcycle, check for proper clearance between new exhaust system and rear suspension (i.e. tire, swingarm, brake, rear shock, etc). If any problem is found, please carefully follow through the installation steps again. If problem still persists, please call Yoshimura tech department at (800) 634-9166 / in CA (909) 628-4722.
- 15 Trim the number plate as shown in figure 4. The dotted line in figure 4 shows where the plastic must be cut.  
  
**NOTE:** Your Yoshimura exhaust system has been designed with weight centralization in mind. Trimming of the number plate is required in order to move the muffler as far forward as possible.
- 16 Apply adhesive foil heatshield to the inside of the number plate and trim off excess material as shown in figure 4.
- 17 Reinstall number plate.

**NOTE:** After starting motorcycle, it is normal for new exhaust system and muffler to emit smoke until oil residue burns off.

**#2255703**



Parts Diagram

NO.	DESCRIPTION	QTY	PART #
1	Yoshimura Stainless Steel Tailpipe	1	2255-152
2	Yoshimura Race Muffler	1	2255503-RMA
3	8mm X 20mm Bolt	1	M8X20H
4	8mm X 40mm Bolt	1	M8X40H
5	Large 8mm Washer	1	8MMWASHERL
6	Stainless Steel Collector Clamp	1	22057
7	Small Exhaust Springs	2	RACE-SPX-1
8	Aluminum Insert	1	ALS-002
**	Adhesive Foil Heatshield	1	2255-00-01
**	Rubber gromment	1	Z1022
**	Yoshimura Spring Puller	1	ST-200
**	Yoshimura Vinyl Sticker	2	17028-BLK

**Nuts and Bolts Guide (Actual Size):**

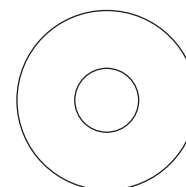

8mm Large Washer

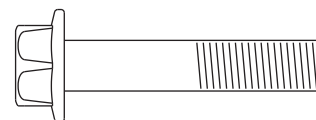

8mm x 40mm  
Flange Hex Bolt

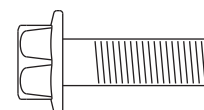

8mm x 20mm  
Flange Hex Bolt



# YOSHIMURA

RESEARCH & DEVELOPMENT OF AMERICA, INC.

5420 DANIELS STREET SUITE A, CHINO, CA 91710 · (800)634-9166 · (909)628-4722 · FACSIMILE (909)591-2198

[www.yoshimura-rd.com](http://www.yoshimura-rd.com)

## Spark Arrester Cleaning Information

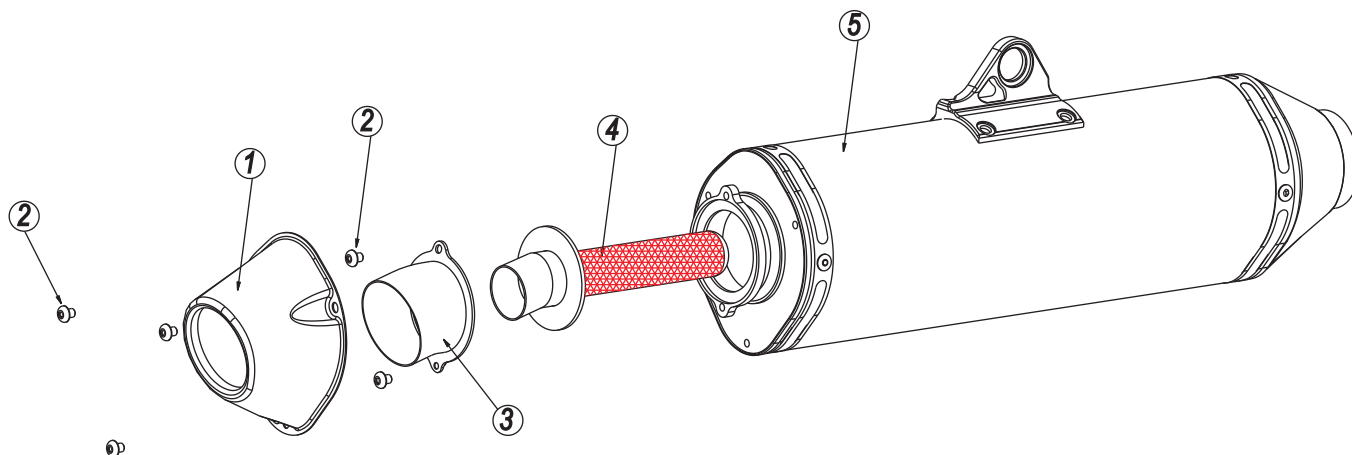

Parts Diagram

**Caution:** *Muffler can be extremely hot. Let muffler cool down before removing spark arrester.*

**Note:** *Read through all instructions before beginning disassembly.*

NO.	DESCRIPTION	QTY
1	Cone Cap	1
2	5mm x 10mm Button Head Bolt	5
3	Exhaust Tip	1
4	Spark Arrester	1
5	Muffler Assembly	1

### Tools Needed:

3mm Allen Key  
Wire Brush  
Pair of Gloves  
Safety Glasses

### Cleaning Steps:

- 1 Using a 3mm Allen key, remove the three 5mm x 10mm button head bolts that secure the cone cap to the muffler (see Parts Diagram for location).
- 2 Remove the two 5mm x 10mm button head bolts that secure the spark arrester to the muffler. Remove the spark arrester from the muffler.

- 3 Using a wire brush, remove carbon deposits from spark arrester screen. Inspect the screen for excessive wear or damage. If spark arrester is excessively worn or damaged, the spark arrester must be replaced. Cleaning and inspection should be performed after every 60 hours of use.

**CAUTION:** *Gloves and Safety Glasses should be worn while cleaning spark arrester.*

- 4 Re-install spark arrester and cone cap. Torque the 5mm x 10mm bolts to 1.0 kg-m (7.3 lb-ft).

**NOTE:** *It is recommended that a low strength "Loc-tite" is used on the 5mm x 10mm bolts.*