



## KICKER AMP and WIRE HARNESS

### 871

### PARTS INCLUDED

- 1 Kicker Audio 4.1 Amplifier
- 1 Amplifier Installation Kit Containing
  - 1 Amplifier Power Harness
  - 1 Amplifier Speaker Harness
  - 1 Rear Extension Harness
  - 4 Single Speaker Harnesses
  - 2 Positive Y Adapters—**WHITE**
  - 2 Negative Y Adapters—**BLACK**
- 3 3-1/4" X 5-3/4" Pieces Double Sided Tape
- 1 Hardware Kit Containing
  - 1 Dielectric Grease Pak
  - 4 Female Spade Connectors-Large
  - 4 Female Spade Connectors-Small
  - 2 Alcohol Pads
  - 10 6" Black Nylon Cable Ties
- 1 Installation Instructions

RETAIN FOR FUTURE USE

RETAIN FOR FUTURE USE

Please read and understand entire instructions before starting installation.

### THANK YOU FOR CHOOSING KÜRYAKYN!

**IN ORDER TO PROTECT YOU AND OTHERS FROM POSSIBLE INJURY AND/OR PROPERTY DAMAGE OR LOSS, PLEASE PAY CLOSE ATTENTION TO ALL INSTRUCTIONS, WARNINGS, CAUTIONS AND ATTENTION NOTES REGARDING THE USE AND CARE OF THIS PRODUCT.**

**ATTENTION!** This indication alerts you to the fact that ignoring the contents described herein may negatively affect product performance and functionality.

**CAUTION!** This indication alerts you to the fact that ignoring the contents described herein can result in potential injury or material damage.

### TOOLS SUGGESTED

Set of Torx Sockets, Ratchet and Extension, Set of Hex Wrenches, Set of Combination Wrenches

**STRICTLY OBSERVE THE FOLLOWING GUIDELINES IN ORDER TO USE THE PRODUCT PROPERLY AND AVOID POTENTIALLY DANGEROUS ACCIDENTS.**

### STEP 1

Read and understand all steps in the instructions before starting the installation. **Please familiarize yourself with the wire color key chart on Page 4 and description pictures on Page 5 before starting this installation.** Park the motorcycle on a hard, level surface and turn off the ignition.

**NOTE:** This kit contains an amplifier and wiring harnesses designed to be installed on 2006 and Later Harley Davidson Touring bikes with stock two or four speaker stereo systems. There is also some wiring hardware included for use with Kuryakyn Saddlebag Speaker Pods, Saddlebag Lids with Speakers and Lower Fairing Speakers. Keep any unused hardware for future use.

**CAUTION!** Avoid potential electrical shock! Disconnect the battery before starting this procedure.

**ATTENTION!** Kuryakyn recommends the use of dielectric grease on electrical connections.

### CUSTOMER SERVICE

877.370.3604 (toll free)

### INSTALLATION QUESTIONS

techsupport@kuryakyn.com  
or call 715.247.2983

### LIMITED WARRANTY

Kuryakyn warrants that any Kuryakyn products sold hereunder, shall be free of defects in materials and workmanship for a period of one (1) year from the date of purchase by the consumer excepting the following provisions:

- Kuryakyn shall have no obligation in the event the customer is unable to provide a receipt showing the date the customer purchased the product(s).
  - The product must be properly installed, maintained and operated under normal conditions.
  - Kuryakyn makes no warranty, expressed or implied, with respect to any gold plated products.
  - Kuryakyn shall not be liable for any consequential and incidental damages, including labor and paint, resulting from failure of a Kuryakyn product, failure to deliver, delay in delivery, delivery in nonconforming condition, or for any breach of contract or duty between Kuryakyn and a customer.

• Kuryakyn products are often intended for use in specific applications. Kuryakyn makes no warranty if a Kuryakyn product is used in applications other than intended.

• Kuryakyn electrical products are warranted for one (1) year from the date of purchase by the consumer. L.E.D.'S contained in components of Kuryakyn products will be warranted for defects in materials and workmanship for 3 years from the date of purchase where as all other components shall be warranted for one(1) year. This includes, but is not limited to; control modules, wiring, chrome & other components.

• Kuryakyn makes no warranty of any kind in regard to other manufacturer's products distributed by Kuryakyn. Kuryakyn will pass on all warranties made by the manufacturer and where possible, will expedite the claim on behalf of the customer, but ultimately, responsibility for disposition of the warranty claim lies with the manufacturer.

### ABOUT OUR CATALOG

For purchasing Kuryakyn® products, you can receive a complete catalog free of charge. Send the Proof-of-Purchase below with your address to: Kuryakyn, P.O. Box 339, Somerset, WI 54025. Please indicate either Accessories Catalog for Harley-Davidson® or GL & Metric Cruisers.

Be sure to ask your local dealer about other Kuryakyn® products, the motorcycle parts and accessories designed for riders by riders.

©2005 Kuryakyn USA® All Rights reserved.



**ATTENTION!** A factory service manual may be helpful in performing this installation. Do not attempt to perform this installation if you are not confident in your ability to complete all of the steps in the procedure; consult a trained technician.

### INSTALLING AMP IN ELECTRA GLIDE, STREET GLIDE OR ULTRA CLASSIC ELECTRA GLIDE

**STEP 2** Remove the windscreen and outer fairing as per the instructions in your service manual.

**STEP 3** Unplug the CB radio (if equipped) wire harness and antenna. Remove the screw from the bracket on the CB and remove the CB from the top of the stereo. Set these aside, they will be reinstalled. PIC 1

**STEP 4** Clean the top of the stereo with the included alcohol pad. Install the included two sided adhesive pads to the top of the stereo. PIC 2

**ATTENTION!** Ensure the area of installation is free of grease, oil, dirt or other debris to ensure proper adhesion. Küryakyn WILL NOT issue a warranty on any parts lost due to improper installation.

**ATTENTION!** The adhesive will not bond correctly if applied at temperatures less than 50°F. Do not attempt this installation in temperatures less than 50°F.

**STEP 5** Test fit the Amp to the top of the stereo. It **MUST** be positioned in towards the inner fairing as far as possible. The Amp should be pushed against the four rubber grommets in PIC 2. The fins of the Amp should be even or slightly behind the front of the stereo. If the Amp is not positioned in far enough, the fins will contact the inside of the outer fairing.

**STEP 6** Install the amp to the top of the stereo. The wires will exit the amp from the right (throttle) side and the fins on the amp will face forward. PIC 3

**STEP 7** Route the antenna wire from the CB behind the main wire harness, turn the CB upside down and plug the harness and antenna wire back into the CB. Attach the CB radio to the amp with the provided two sided adhesive pad. PIC 4 Proceed to Step 11 for bikes with four OEM/Kicker speakers, or Step 17 for bikes with two OEM/Kicker speakers.

### INSTALLING AMP IN ROAD GLIDE MODELS

**STEP 8** Remove the windscreen and outer fairing as per the instructions in your service manual.

**STEP 9** Clean the inner fairing on the right side (sitting on the bike), between the glove box and the inner fairing, with an ammonia based cleaner such as window cleaner. Let dry. Using one of the included alcohol pads, go over the area to remove any residue. Let dry. Clean the side of the amp that will go against the inner fairing, PIC 5, with one of the included alcohol pads.

**ATTENTION!** Ensure the area of installation is free of grease, oil, dirt or other debris to ensure proper adhesion. Küryakyn WILL NOT issue a warranty on any parts lost due to improper installation.

**ATTENTION!** The adhesive will not bond correctly if applied at temperatures less than 50°F. Do not attempt this installation in temperatures less than 50°F.

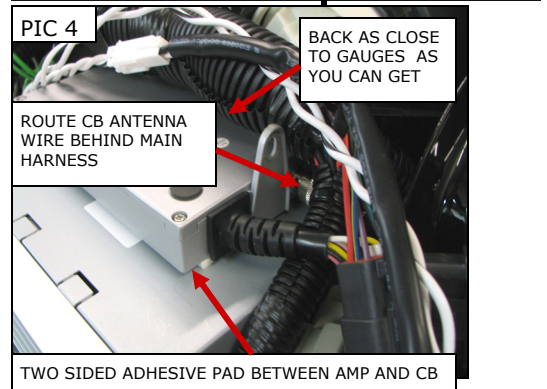
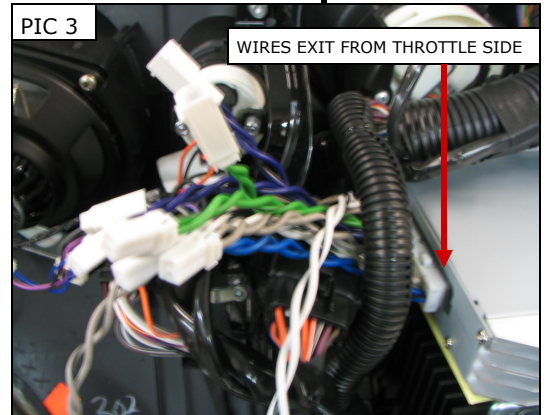
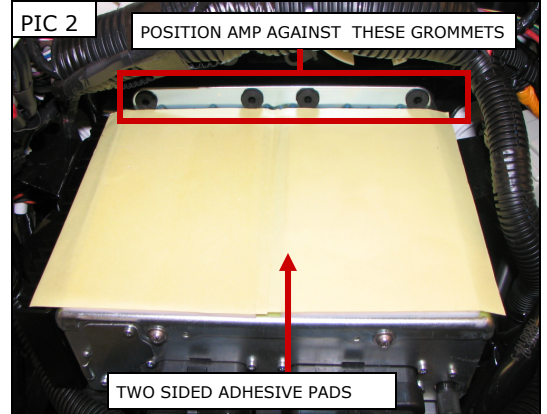
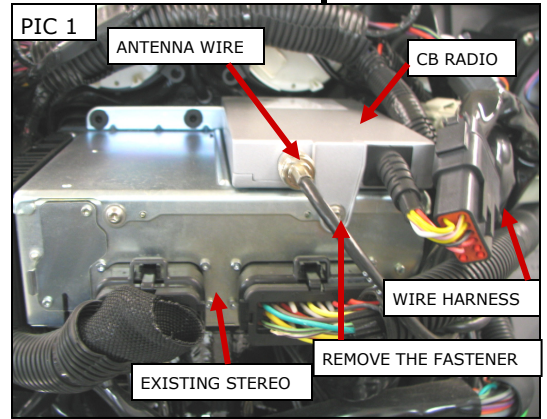

-cont.-

**STEP 10** Test fit the Amp to find the location that will give you the most contact area between the Amp and inner fairing. The Amp should be located as far back on the inner fairing as possible. Attach two pieces of the included double sided adhesive to the side of the amp that will face the inner fairing. The wires will exit towards the front of the bike and the fins on the amp will face down. Install it to the side of the inner fairing as shown in PIC 5. Press firmly on the Amp for 1 minute. Full bonding will occur in 24 hours. Proceed to Step 11 for bikes with four OEM/Kicker speakers, or Step 17 for bikes with two OEM/Kicker speakers.

**CONNECTING THE AMP TO THE STEREO with FOUR OEM/KICKER SPEAKERS**

**NOTE:** There are also some wiring extensions included for use with Kuryakyn Saddlebag Speaker Pods, Saddlebag Lids with Speakers and Lower Fairing Speakers. Keep any unused extensions for future use.

**STEP 11** Refer to FIG 1 on Page 5. Remove the seat. Connect the 18 pin and 12 pin harnesses to the amp. Connect the Rear Extension Harness to the same colored wires from the Amp. Route the Rear Extension harness and the Power Harness over the lower triple tree and under the tank to the seat area. Use cable ties to keep the wiring harness away from the motor and pinch points. You may want to raise the fuel tank or remove it to route these harnesses.

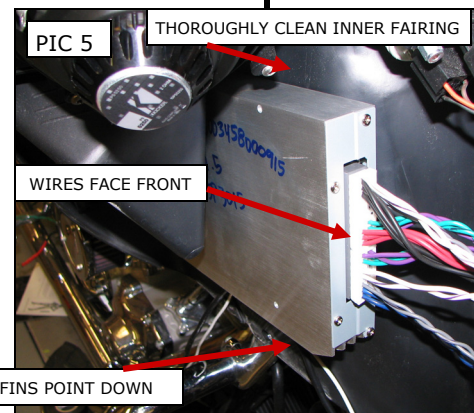

**ATTENTION!** Secure all wiring away from any moving parts, pinch points or extreme heat. Kuryakyn WILL NOT issue a warranty on any electrical component that fails due to pinched, crimped, broken, abraded, melted or frayed wires.

**STEP 12** Connect a Single Speaker harness to the left and right sections of the Rear Extension Harness. The wires are labeled and can only be connected one way.

**STEP 13** Remove the rear speakers from the housing for access to the speaker wiring. Route the Single Speaker harness to the inside of the housing, GREEN to the left side--PURPLE to the right side. Unplug the wires from the speakers. Connect the Female Spade connectors on the Single Speaker harness to each speaker.

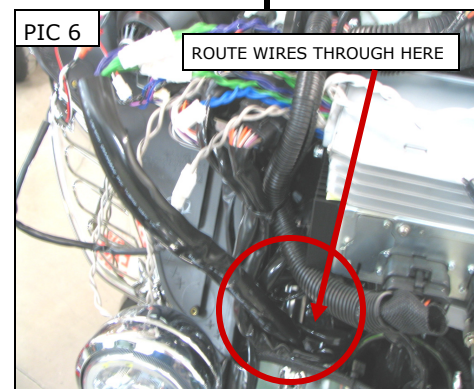

**STEP 14** Connect the wires labeled "TO REAR OEM SPEAKER WIRES" from the Rear Extension harness to the OEM speaker wires, spades on the GREEN to the left side, spades on the PURPLE to the right side. They will only connect to the correct spade. Reinstall the speakers.

**STEP 15** Connect the wires from the amp labeled "TO LEFT FRONT SPEAKER HARNESS" to a single speaker harness. Connect the wires from the amp labeled "TO RIGHT FRONT SPEAKER HARNESS" to a single speaker harness. Unplug the right front speaker wires. Connect the OEM wires from the speaker to the wires labeled "TO RIGHT FRONT OEM SPEAKER WIRES". Repeat for the left side. Connect the single speaker harness to each front speaker. WHITE for the left side—GRAY for the right side.

**ATTENTION!** Secure all wiring away from any moving parts, pinch points or extreme heat. Kuryakyn WILL NOT issue a warranty on any electrical component that fails due to pinched, crimped, broken, abraded, melted or frayed wires.

**STEP 16** Connect the red wire from the Power Harness to the positive side of the battery, connect the black wire to the negative side of the battery. Test the system for proper operation. Reinstall the seat and the outer fairing.

**CONNECTING THE AMP TO THE STEREO FOR TWO OEM/KICKER FRONT SPEAKERS**

**NOTE:** There are also some wiring extensions included for use with Kuryakyn Saddlebag Speaker Pods, Saddlebag Lids with Speakers and Lower Fairing Speakers. Keep any unused extensions for future use.

**STEP 17** Refer to FIG 2 on Page 5. Connect the 18 pin and 12 pin harnesses to the amp. The Rear Extension Harness will not be used for this application. This Rear Extension Harness should be set aside. It will be needed if you install Kuryakyn P/N 872, Speaker Pods or P/N 873, P/N 878, Saddlebag Lids with Speakers, at a later date.

-cont.-

**STEP 18** Remove the seat. Route the power harness over the top of the lower triple tree, under the tank, to the seat area. Use the included Cable Ties to secure the harness away from the motor and pinch points. You may want to raise or remove the tank to do this.

**STEP 19** Connect the wires from the Amp labeled "LEFT FRONT SPEAKER HARNESS" to a supplied Single Speaker Harness. Connect the wires from the Amp labeled "RIGHT FRONT SPEAKER HARNESS" to a supplied Single Speaker Harness. Unplug the right front OEM speaker wires from the speaker and connect them to the wires with the male spades from the Amp labeled "TO RIGHT FRONT SPEAKER WIRES". Repeat for the left side.

**STEP 20** Connect the Single Speaker Harness to each front speaker. The right speaker wires are labeled "TO RIGHT FRONT SPEAKER" and are WHITE. The left speaker wires are labeled "TO LEFT FRONT SPEAKER" and are GRAY.

**ATTENTION!** Secure all wiring away from any moving parts, pinch points or extreme heat. Kuryakyn **WILL NOT** issue a warranty on any electrical component that fails due to pinched, crimped, broken, abraded, melted or frayed wires.

**STEP 21** Connect the red wire from the Power Harness to the positive side of the battery, connect the black wire to the negative side of the battery. Test the system for proper operation. Reinstall the seat and outer fairing.

**WIRING HARNESS COLOR KEY CHART  
LEFT AND RIGHT ARE AS SITTING ON THE BIKE**

- WHITE**— LEFT FRONT POSITIVE      **WHITE/BLACK STRIPE**— LEFT FRONT NEGATIVE
- GRAY**— RIGHT FRONT POSITIVE      **GRAY/BLACK STRIPE**— RIGHT FRONT NEGATIVE
- GREEN**— LEFT REAR POSITIVE      **GREEN/BLACK STRIPE**—LEFT REAR NEGATIVE
- PURPLE**— RIGHT REAR POSITIVE      **PURPLE/BLACK STRIPE**— RIGHT REAR NEGATIVE

THE LONG HARNESSES WITH THE **GREEN** AND THE **GREEN/BLACK** WIRES NEED TO BE ROUTED TO THE LEFT REAR OF THE BIKE IF THE BIKE HAS EXISTING REAR SPEAKERS

THE LONG HARNESSES WITH THE **PURPLE** AND **PURPLE/BLACK** WIRES NEED TO BE ROUTED TO THE RIGHT REAR OF THE BIKE IF THE BIKE HAS EXISTING REAR SPEAKERS

THE MID LENGTH HARNESS WITH THE HEAVY **RED** WIRE WITH THE FUSE HOLDER IS THE POSITIVE TO THE BATTERY AND THE HEAVY **BLACK** WIRE IS NEGATIVE TO THE BATTERY

THE **BLUE** WIRES FROM THE AMP ARE AN EXTENSION FOR THE SUBWOOFER AND **WILL NOT BE USED AT THIS TIME.**

THE **POSITIVE** SIDE OF THE SPEAKER HAS THE **SMALL** SPADE CONNECTOR

THE **NEGATIVE** SIDE OF THE SPEAKER HAS THE **LARGE** SPADE CONNECTOR

**CAUTION!**

It is up to the installer to ensure that the total speaker Ohms on each channel is within the operating range of the Kicker Amp. This range is 2 Ohms minimum to 8 Ohms maximum. Check your speakers to find the Ohms listed. **KURYAKYN WILL NOT** warranty speakers or Amps that have failed due to incorrect wiring.

This diagram divides the bike into four zones or sections that are called Channels. Each channel includes all speakers in that zone or section. To determine the correct OHMS for each channel, use the Ohms of the speakers in each zone or section and the formulas given for Series wiring or Parallel wiring. Refer to the above caution.

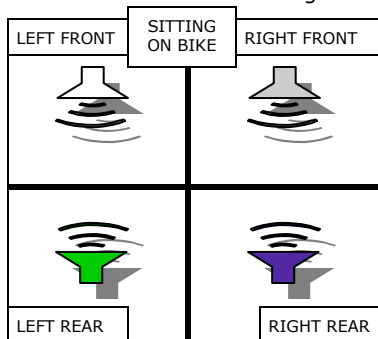

**SERIES**

When speakers are added and wired in series' add the Ohms from each speaker on that channel together to get the total Ohms.

**Example:** 4 Ohms + 2 Ohms = 6 Ohms which is in the range of acceptable Ohms.

**PARALLEL**

When speakers are wired in parallel to get the total Ohms, multiply the Ohms from each speaker on a channel together. Divide that by the amount from adding the Ohms of each speaker on that channel together.

**Example:** 4 Ohms X 2 Ohms / 4 Ohms + 2 Ohms = 1.3 Ohms which would be too low.

-cont.-

**FIG 1**

**USE THESE HARNESSES FOR FOUR  
OEM/KICKER SPEAKERS—ULTRA  
CLASSIC, ULTRA LIMITED,  
ROAD GLIDE ULTRA**

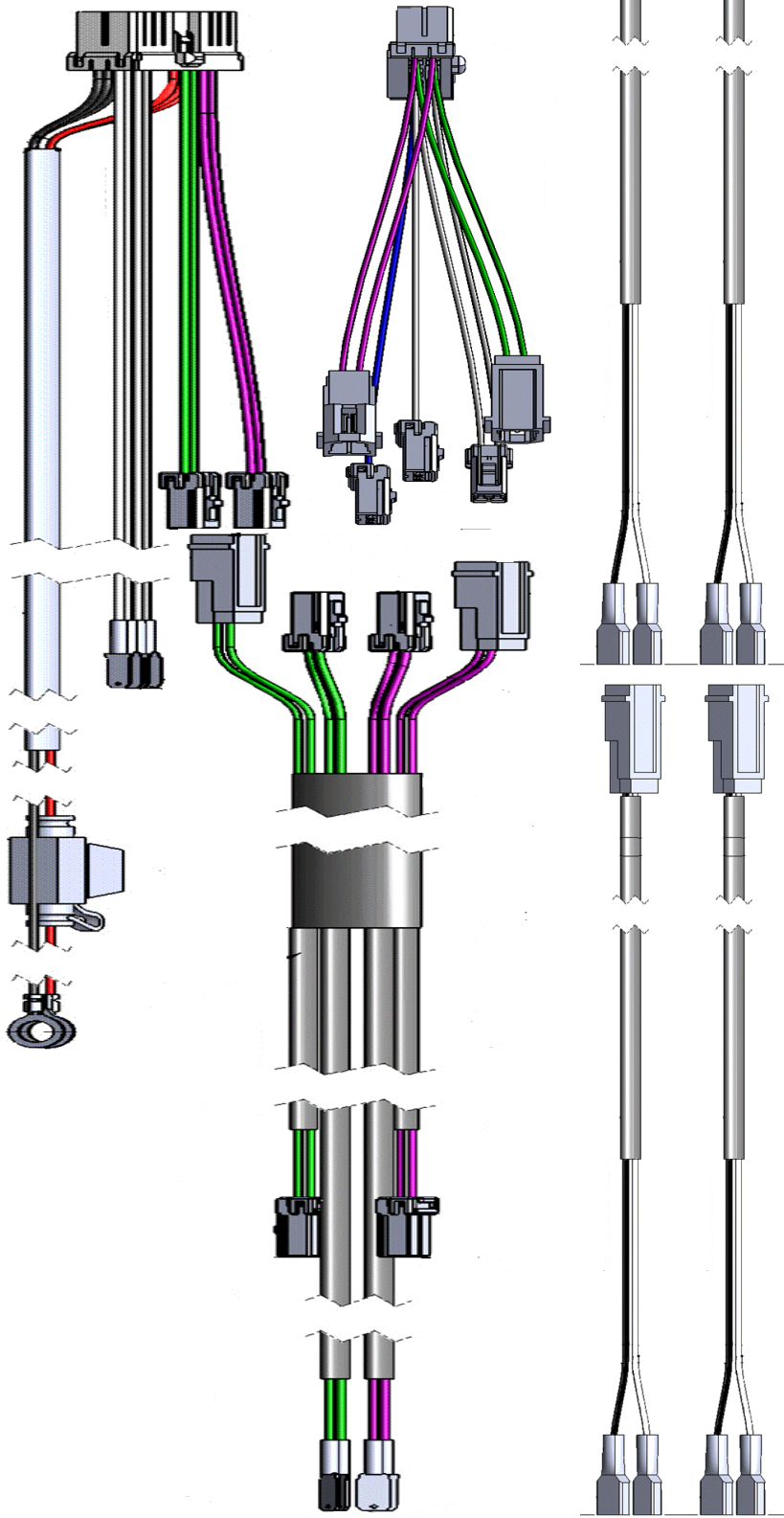

**FIG 2**

**USE THESE HARNESSES FOR TWO OEM/  
KICKER SPEAKERS—STREET GLIDE,  
ROAD GLIDE, ELECTRA GLIDE CLASSIC**

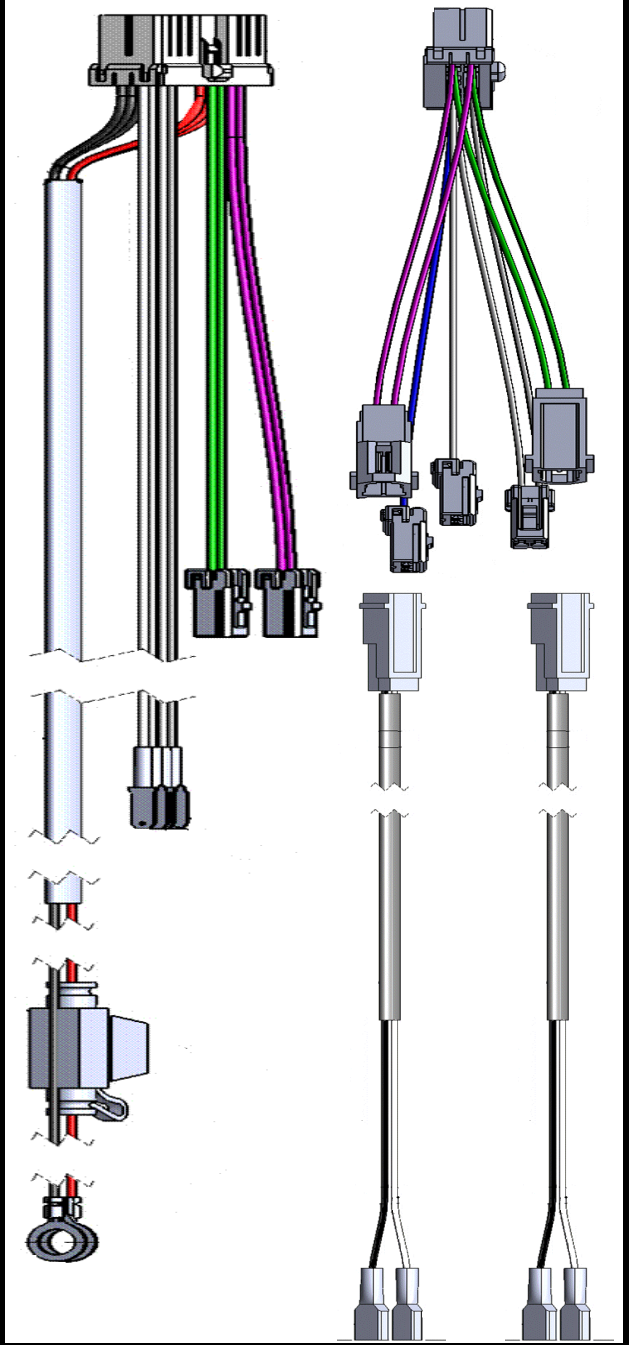

*Ride On!*