

Box: PLOCK 1

BIKE	HONDA CBR 1000 RR	PART NO.	EHA - 82
YEAR	2004 - 2005	FIT KITS	OVAL Z039.11052
NOTES	Where not supplied use original fittings	FEATURES	DB KILLER Z028.10107

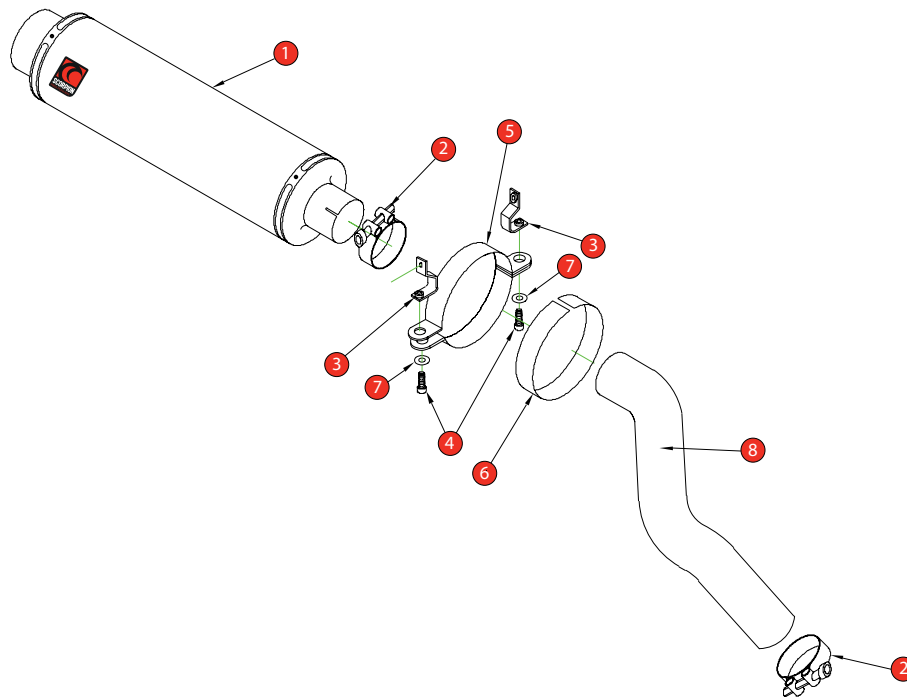

- 1 350mm Underseat Silencer ESC 53
- 2 2 x 51-55mm Band Clamps (Z016.10002)
- 3 2 x Mounting Brackets (Z015.10056)
- 4 2 x M8 x 20mm Cap Head Bolts (Z017.10072)
- 5 Fireblade Hanging Bracket (Z028.10080)
- 6 Protective Rubber Strip (Z029.10022)
- 7 2 x M8 x 17mm Washers (Z017.10831)

- 8 Connecting Pipe CP 251
- 9 Heat Shield Template (Z028.10102)

E-MARK ROUND	N/A
E-MARK OVAL	SC-53 e4 2132
ISSUE NO.	9
DATE	21/02/07
AUTHORISED	S.Northrop
CHECKED	

NOTE: ENSURE SCORPION SYSTEM IS CLEAR OF MOVING PARTS AND ALL ORIGINAL FUNCTIONS WORK CORRECTLY.



A) Remove cables from Exup valve secure safely or remove completely

B) Remove right hand exhaust cover

C) Remove rear foot peg

D) Remove front foot peg



Box: PLOCK 1

BIKE	HONDA CBR 1000 RR	PART NO.	EHA - 82
YEAR	2004 - 2005	FIT KITS	OVAL Z039.11052
NOTES	Where not supplied use original fittings	FEATURES	DB KILLER Z028.10107

CONTINUED FROM OVERLEAF:



E) Remove right hand heat shield

F) Remove top exhaust clamp, loosen bottom clamp

G) Remove front and rear seats

H) Remove seat cowl

I) Remove number plate / light bracket

J) Remove standard silencer

K) Remove exhaust heat shield (do not replace with scorpion silencer)

L) Remove olive and gasket.



Box: PLOCK 1

BIKE	HONDA CBR 1000 RR	PART NO.	EHA - 82
YEAR	2004 - 2005	FIT KITS	OVAL Z039.11052
NOTES	Where not supplied use original fittings	FEATURES	DB KILLER Z028.10107

CONTINUED FROM OVERLEAF:

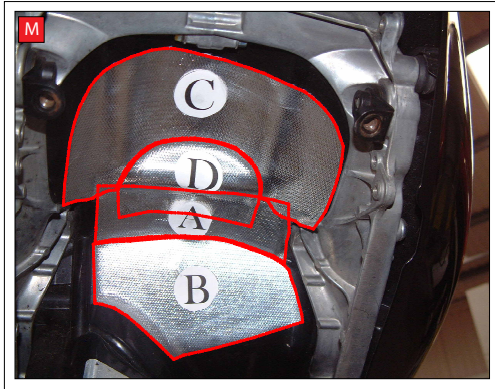

M) Cut out heat shields A to D
From supplied template and fix
to under seat area in alphabetical
order

N) Fit Scorpion link pipe, do not
tighten clamps

O) Fit Scorpion silencer, align
centrally with bodywork, then
tighten all brackets and clamps.
(Can and all pipe work)

P,Q) DO NOT RE-FIT THIS PLASTIC
COWLING



Secure Exup valve cables safely or
remove completely and replace
all original heat shields. (leaving
off black plastic cowling – see
photos above - for 2006 model)
Ensure all cables and any fittings
are secured safely and all original
functions work correctly prior to
use.

