



YOSHIMURA

RESEARCH&DEVELOPMENT OF AMERICA, INC.

5420 DANIELS STREET STE A, CHINO CA. 91710 · (800)634-9166 · (909)628-4722 · FACSIMILE (909)591-2198

www.yoshimura-rd.com

R77 TRI-OVAL PERFORMANCE EXHAUST SYSTEM

2009-2012

YAMAHA

YZF -R1

13140E0220	R77 STAINLESS STEEL SLIP-ON W/ CARBON FIBER SLEEVE; CARBON FIBER ENDCAP
13140E0520	R77 STAINLESS STEEL SLIP-ON W/ STAINLESS STEEL SLEEVE; CARBON FIBER ENDCAP
13140E0550	R77 STAINLESS STEEL SLIP-ON W/ STAINLESS STEEL SLEEVE; STAINLESS STEEL ENDCAP



This product is 50-state legal and complies with Federal and State regulations. Any attempts to modify this product will render it non-compliant with Federal law and void warranty. If modified, the vehicle can no longer be used on public roads and can only be used for off-highway closed course competition. In the state of California, it is illegal to modify the emission control system, which includes the fuel injection system of any vehicle.



NOTE: IN THE STATE OF CALIFORNIA, IT IS ILLEGAL TO MODIFY THE EMISSION CONTROL SYSTEM. WHICH INCLUDES THE FUEL INJECTION OF ANY VEHICLE.

Caution: Exhaust system can be extremely hot. Let motorcycle cool down before beginning installation. Always wear hand and eye protection and take precautionary measures to avoid injury.

Note: Read through all instructions before beginning installation.

Tools Needed:

10mm and 12mm Sockets	Torque Wrench
3/8" Ratchet and Extension	3/16" Drill Bit
3mm and 4mm Allen Wrench	Electric Drill
#2 Phillips Screwdriver	Safety Glasses

Installation Steps:

1. Remove passenger seat.
2. Remove driver seat.
3. Remove upper portion of rear tail. (See Fig. 1 & 2)
 - Remove 2 front plastic screw type rivets. (Fig. 1)
 - Remove bolt. (Fig. 1)
 - Remove push type rivet. (Fig. 2)
 - Remove passenger seat lock cable.
 - Remove tailpiece.
4. Loosen tailpipe clamps. (Fig. 3)
5. Remove left and right muffler heatshields. (Fig. 4)
6. Remove left muffler mount bolt then remove muffler. Repeat for right muffler. (Fig. 5)

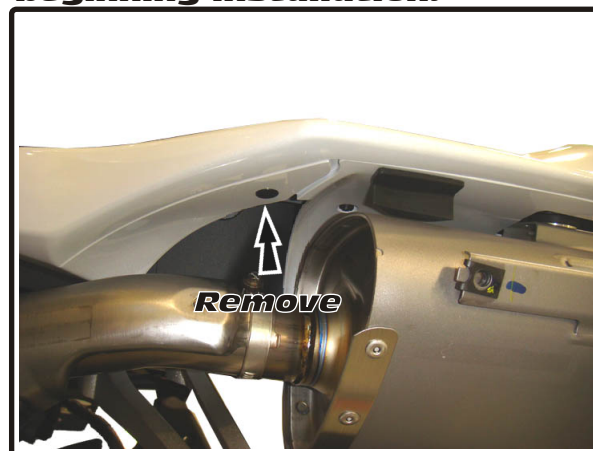

Fig. 2

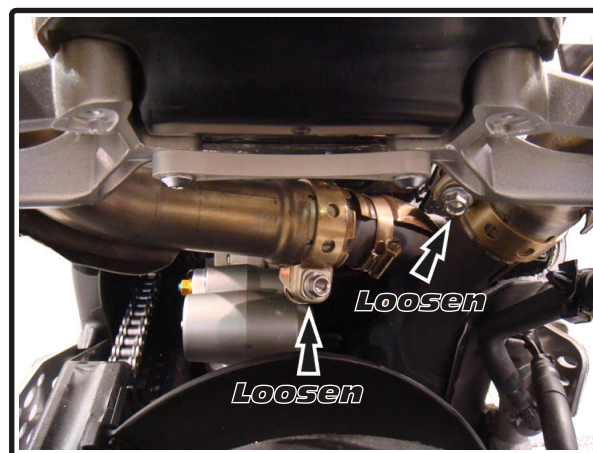

Fig. 3

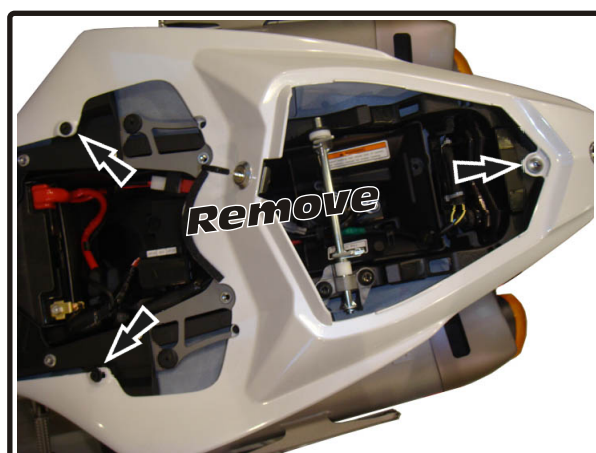

Fig. 1



Fig. 4

7. Install Yoshimura collector clamp onto left Yoshimura tailpipe/muffler assembly.
8. Install left Yoshimura muffler assembly. Using stock bolt, tighten hand-tight. (Fig. 6)
9. Repeat steps for right Yoshimura muffler assembly.
10. Stand to the rear of the motorcycle and adjust mufflers and/or tailpipes to achieve desired fit, while checking all clearances.

Note: If insufficient clearances are found between bodywork and heatshields or tailpipes, loosen the midpipe clamp between the header and midpipe and adjust the orientation of the stock midpipe. Be sure to tighten the midpipe once orientation is set correctly.

11. Torque muffler mounting bolts to 16.5 lb-ft (2.3 kg-m)
12. Torque collector clamps to 16.5 lb-ft (2.3 kg-m)
13. Install left and right Yoshimura heatshields using supplied bolts. (Fig. 7)
14. Install tail fairing and seats using the reverse steps of removal.
15. It is recommended that the entire exhaust system be wiped down with rubbing alcohol to remove oil and fingerprints. This will help prevent tarnishing of the finish after the exhaust is heated up.
16. Before starting motorcycle, check for proper clearance between new exhaust system and motorcycle (i.e. Bodywork, swing-arm, etc.). If any problem is found, please carefully follow through the installation steps again. If problem still persists, please call Yoshimura tech. dept. at (800)634-9166 / in CA (909)628-4722

NOTE: After starting motorcycle, it is normal for new exhaust system and mufflers to emit smoke until oil residue burns off.

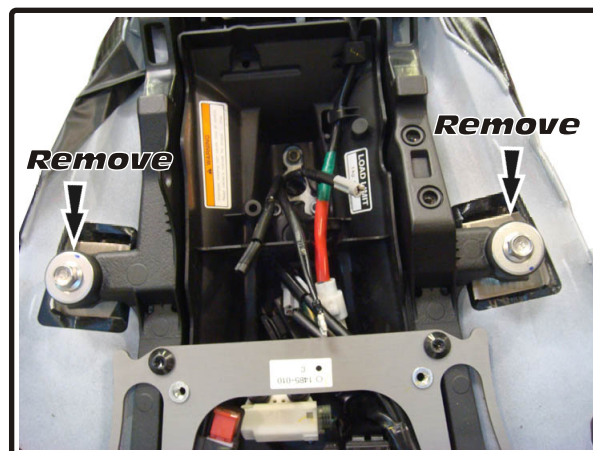
**Fig. 5****Fig. 6****Fig. 7**

#13140E0(220,520,550)

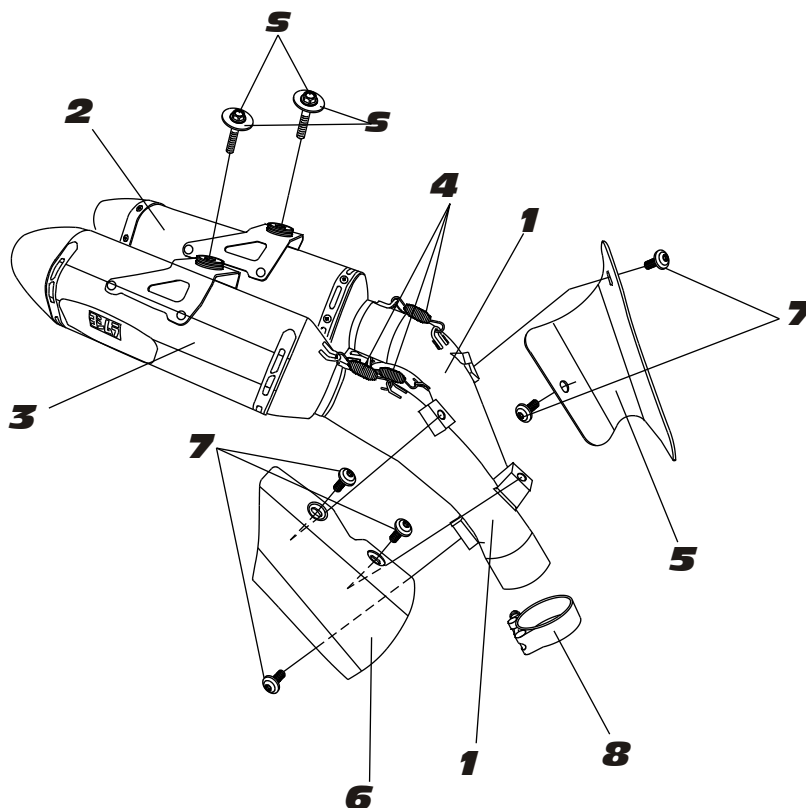
**S=STOCK**

Parts Diagram

NO.	DESCRIPTION	QTY	PART #
1	Yoshimura Tail Pipe		
	Stainless Steel (Left Side)	1	1314-426
	Stainless Steel (Right Side)	1	1314-427
2	Muffler (Left)	1	
	R77 Muffler with Carbon Fiber Sleeve		N/A
	R77 Muffler with Stainless Steel Sleeve		N/A
3	Muffler (Right)	1	
	R77 Muffler with Carbon Fiber Sleeve		N/A
	R77 Muffler with Stainless Steel Sleeve		N/A
4	Medium Exhaust Spring	4	RACE-SPS-1
5	Left Heatshield	1	1314-HSL
6	Right Heatshield	1	1314-HSR
7	Heatshield Bolts	5	RC116HSB-BK
8	Collector Clamp	2	22059
**	Exhaust Spring Puller	1	ST-200
**	Yoshimura Sticker Kit Sheet	1	17029