

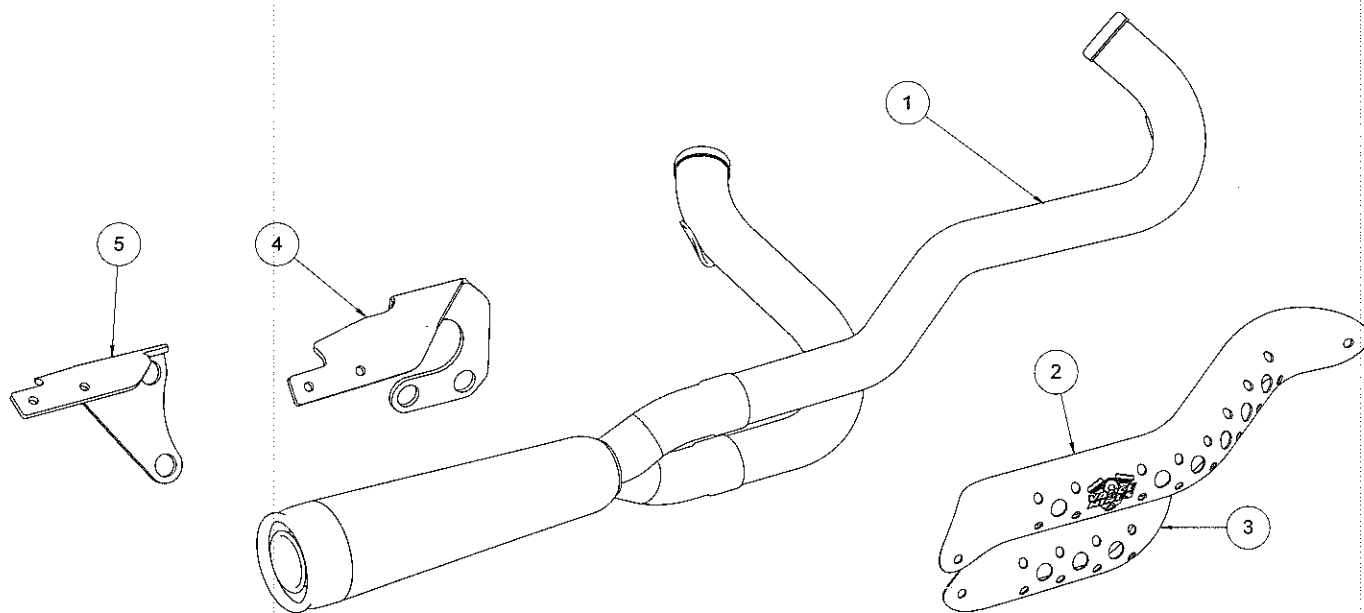

INSTALLATION INSTRUCTIONS HARLEY-DAVIDSON SPORTSTER RSD TRACKER 2-INTO-1 PART# 11823

Congratulations, you have purchased the finest exhaust system available for your motorcycle. Your Vance & Hines exhaust is designed and crafted for performance, quality and style. Please follow the instructions below, check exhaust system for missing or damaged parts and if you need any assistance please contact our technical support line (562) 921-7461.

PARTS LIST



PARTS LIST

NO.	PART NO.	Description	Qty.				
1	R125FP1-S	Header Assembly	1	12	C903	STRAIGHT TUBE SPACER	3
2	R125HP	Front Heat Shield	1	13	A121HW	18MM X 24MM OD COPPER	2
3	R126HP	Rear Heat Shield	1	14	A112HW	#10 FLAT WASHER	2
4	961-P	Bracket 2014-2016	1	15	A240HW	5/16-18 X 5/8 FLANGE BOLT	2
5	501-P	Bracket 2004-2013	1	16	A100HW	3/8-16 X 1 1/2 IN SHCS	2
6	A270HW	SS HOSE CLAMP #20	4	17	A470HW	3/8-16 X 1 3/4 IN SHCS	2
7	A195HW	DOGBONE NUT PLACE	1				
8	A213HW	18MM X 1.35 MM X 10MM PLUG	2				
9	A644ST	18-12MM O2 ADAPTER	2				
10	A155HW	3/8 FLAT WASHER	6				
11	A245HW	RUBBER GROMMET	3				

HARDWARE

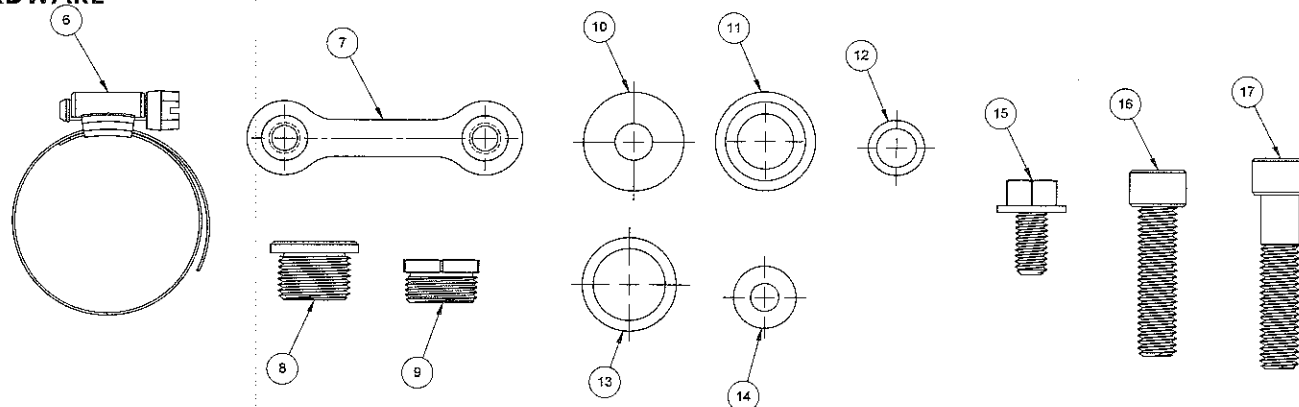

TOOLS REQUIRED

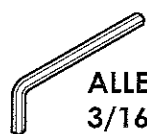

ALLEN WRENCHES:
3/16", 5/16"

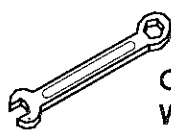

**COMBINATION
WRENCHES:** 9/16",
1/2", 7/8", 3/4" OR
22mm & 14mm

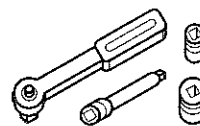

**RATCHET & EXTEN-
SIONS; SOCKETS:**
1/2", 3/4", 9/16"
DEEP, T30, T40



**FLAT BLADE SCREW-
DRIVER**

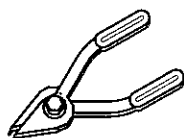

SNAP RING PLIERS

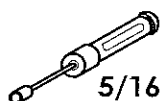

5/16" NUTDRIVER

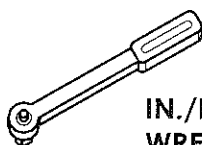

**IN./LBS. TORQUE
WRENCH**

STOCK EXHAUST SYSTEM REMOVAL

1. This exhaust system is not compatible with stock air cleaner backing plate, an aftermarket high flow air cleaner kit is required. Passenger foot pegs will not fit with the exhaust system.
2. On models equipped, find and unplug the O2 sensor wires from the wiring harness. Feed the end of the wires through the frame so they are free from the motorcycle. NOTE: Pay attention to the wire routing for re-installation.
3. Loosen the heat shield clamps on both the front and rear exhaust pipes. This allows easier access to the head pipe mounting nuts.
4. Loosen the clamps holding the mufflers to the head pipes.
5. Remove the two bolts that mount each muffler to the mounting bar. Carefully remove mufflers from the motorcycle and set aside.
6. Remove the two head pipe mounting nuts from each flange, located at the cylinder head.
7. Remove the clamp bolt which mounts the rear head pipe to the belt drive cover bracket.
8. Carefully remove exhaust from the motorcycle and set aside.
9. 2004 – 2013 Models remove the brake rod at the rear eyelet.
10. 2014 – Later Models remove e-clip from brake rod lynchpin and remove foot controls.
11. Remove the belt drive cover and take the bracket off the rear bolt, bracket will not be re-used.
12. Remove the three mount bolts and washers attaching the mounting bar. Hardware will not be re-used.
13. On models equipped carefully remove O2 sensors from the stock head pipes and save for re-use.
14. Carefully remove exhaust port flanges and circlips from the stock exhaust system. NOTE: Replace bent or damaged circlips. Check exhaust port gasket condition. Recommended replacement gaskets, Harley part number: 17048-98 or 65324-83B.

VANCE & HINES EXHAUST INSTALLATION

1. Remove plastic plugs and attach mounting bracket using two 3/8" x 2-1/2" bolts (supplied).
2. Remove master cylinder bracket and plastic plug and attach mounting bracket with two 3/8" x 1-3/4" bolts and one 3/8" x 1-1/2" bolt (upper hole).
3. Reinstall belt cover by using stock bolts. Place two 1/4 washers on the bottom bolt to give space between belt cover and transmission. Torque the 3/8" bolt to 30-33 Ft/Lbs. and the two 1/4" bolts to 80-120 In/Lbs. Important: Not using 1/4 washers to space cover will damage the belt and cover.
4. 2004 – 2013 Models re-install brake rod eyelet using removable thread locking compound (Loctite® 243 recommended). Torque to 120-180 In/Lbs.

VANCE & HINES EXHAUST INSTALLATION CONTINUED...

5. 2014 – Later Models reinstall foot controls, brake rod lynchpin and e-clip.
6. Remove head pipes and heat shields from protective packaging. Place each heat shield on a non-abrasive surface such as a blanket or carpet. Using a marker, lightly mark outside edge of each heat shield to show location of mounting clips that hose clamps will loop through.
7. Lay head pipes into their respective heat shields, being very careful not to harm black coating.
8. Install #20 hose clamps by feeding tail end of clamps into heat shield clips. Take note of screw head direction. Screw head must be accessible when system is installed on motorcycle for adjustment purposes.
9. Apply a small amount of anti-seize compound to the threads of the O2 sensors and install them into the new head pipe. NOTE: 2004 - 2013 models or models using 18mm wideband oxygen sensors install sensor directly into head pipe. 2014 - Later models install supplied 18mm to 12mm oxygen sensor adapter then install 12mm oxygen sensors. All models not using oxygen sensors install 18mm plug with copper crush washer.
10. Install exhaust port flanges and circlips (from stock system) onto head pipes.
11. Using stock flange nuts, carefully install head pipes into exhaust ports, starting with the rear cylinder. Assistance may be required. NOTE: Do not tighten at this time.
12. Slide the nut plate (supplied) into the bracket that is welded to the back side of the muffler. Loosely install two 5/16" x 5/8" flange head bolts (supplied)
13. Tighten the exhaust port flange nuts and 5/16" flange head bolts.
14. Tighten the bracket.
15. Tighten all hose clamps securing heat shields.
16. Plug O2 sensors back into wiring harness and route wires away from hot areas of motorcycle.
17. Install a new nylon cable tie (supplied) to hold front O2 sensor wire onto the frame.
18. Check for adequate clearance between all exhaust system components and motorcycle accessories prone to heat damage.
19. Be sure to tighten all hardware before starting your motorcycle.
20. After installation and before starting your motorcycle, completely clean pipes and mufflers with warm soapy water and a clean soft cloth. Dry with a clean towel. NOTE: any residue, oil, or fingerprints will stain the black coating. Do NOT use anything abrasive to clean the pipes as it may remove the finish.

EXHAUST CARE (BLACK)

1. When installing a new set up black pipes, make sure your hands are clean and free of oil. After installation, thoroughly clean pipes with warm soapy water and a soft cloth. Dry with a clean towel to remove any residue before starting the motorcycle. Do NOT use anything abrasive to clean pipes.
2. Avoid long periods of idling as this can cause discoloration.
3. Intake leaks can cause the engine to run lean and overheat, this could lead to discoloration.
4. Make sure there are no exhaust leaks at the junction of the exhaust pipes and cylinder head. We recommend replacing gaskets if they are worn.

Figure 1

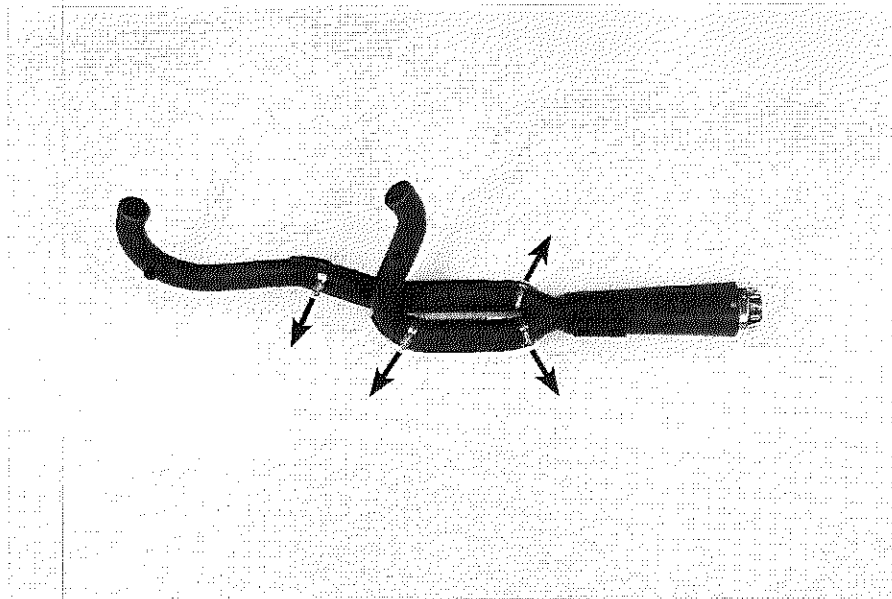

Emissions Notice:

In California, in order to meet Air Resources Board emissions requirements, certain aftermarket part applications have been identified as replacements, and others have received ARB Executive Orders. All other emissions related aftermarket parts are for competition use only. A list of replacement parts and EO parts, and corresponding fitment is provided at vanceandhines.com/California.

Warranty:

All Vance & Hines products are warranted against defects in material and workmanship for a period of 90 days. This warranty does not cover discoloration or rust. This warranty shall be limited to the repair or replacement of the product, which may be proven defective under normal use. Vance & Hines will not warranty any system that has been abused, misused, improperly installed or modified.

Dealers or distributors are not authorized to make dispositions binding upon Vance & Hines. Vance & Hines will not be responsible for any labor charges incurred in removing or replacing any system under warranty. A return authorization number and a copy of the original purchase invoice must accompany all returns. Parts returned without a return authorization may be refused.

13861 ROSECRANS AVENUE
SANTA FE SPRINGS, CA 90670
SALES: (562) 921-5388
TECHNICAL: (562) 926-5291
FAX: (562) 802-0110

vanceandhines
.com