

## 1. ADAPT YOUR DEVICE

Center the iOadapt and adhere. Wait 1 hour before first use. Use the included iOskin underneath iOadapt to avoid permanency.



## 2. INSTALL

The Kustom Semisphere Mount bolts to the clutch lever clamp. Hardware included. Tools needed: T27 torx



## 3. ATTACH

Once the iOcore is placed on the Semisphere, your device is ready to be firmly attached.

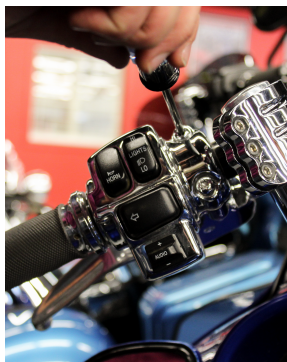

The Kustom Semisphere Mount attaches to your stock controls. Remove 2 bolts from the controls, line up the mount, and use the included hardware to tighten. Follow factory specs.

**Tools needed: T27 torx**

**WARNING:** When riding or driving, please follow your state laws regarding device use.

Each iOadapt™ utilizes permanent adhesive and is very difficult to remove once applied. Use of an iOskin™ sticker under the iOadapt or a case is recommended. Klock Werks and/or iOmounts™ are not responsible for any damages caused by the removal of the iOadapt™.

Clean the surface of your device. Center the iOadapt™ then apply with firm pressure to device or case while on a flat surface. Allow adhesive to set at least 1 hour before first use. For best results, let it set overnight.

iOadapts supplied with the nomad™ and motorcycle-specific mounts are intended for phones and smaller devices only, and will not support full size tablets, e-readers and larger devices.

**Center the iOadapt™  
on your device!**

**Apply with pressure!**

**Allow 1 hr for adhesive  
to set!**

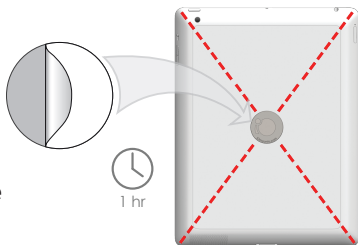

## iOmounts™ components



**iOadapt™:** A stainless steel disk that attaches to your smartphone, tablet, e-reader or other approved device. The iOadapt™ is **NOT A MAGNET!**

**iOcore™:** A **magnetic** cylinder that connects your devices to the motorcycle mounts, stands, wall mounts, car mounts and other iOmounts™ products once the iOadapt is adhered to your device. (Available in many colors.)



**iOskin™:** A non-essential but recommended addition. Apply the sticker on your device then attach the iOadapt™ on top of your sticker for easier removal.

