



INSTALLATION

ADJUSTABLE CRUISE PEG MOUNTS

7535

PARTS INCLUDED

- 1 Right Side Offset Arm/Clevis Assembly—2" Offset
- 1 Left Side Offset Arm/Clevis Assembly—2" Offset
- 1 Right Mount
- 1 Left Mount
- 2 Stiffening Plates—Traditional Boards
- 1 Hardware Kit Containing:
 - 6 1/4"-20 x 5/8" Button Socket Cap Screws
 - 6 1/4"-20 x 1-1/2" Button Socket Cap Screws
 - 12 1/4"-20 Nylon Locking Nuts
 - 12 1/4" Flat Washers
 - 2 5/16"-18 x 3/4" Socket Head Cap Screws
 - 2 Anti-Seize Packets
 - 2 3/8" Chrome Hot Spots
 - 2 5/16" Chrome Hot Spots
- 1 Installation Instructions

Please read and understand entire instructions before starting installation.

THANK YOU FOR CHOOSING KÜRYAKYN!

IN ORDER TO PROTECT YOU AND OTHERS FROM POSSIBLE INJURY AND/OR PROPERTY DAMAGE OR LOSS, PLEASE PAY CLOSE ATTENTION TO ALL INSTRUCTIONS, WARNINGS, CAUTIONS AND NOTICES REGARDING THE USE AND CARE OF THIS PRODUCT.

WARNING

THIS INDICATION ALERTS YOU TO THE FACT THAT IGNORING THE CONTENTS DESCRIBED HEREIN CAN RESULT IN POTENTIAL DEATH OR SERIOUS INJURY.

NOTICE

This indication alerts you to the fact that ignoring the contents described herein may negatively affect product performance and functionality.

CAUTION

This indication alerts you to the fact that ignoring the contents described herein can result in potential injury.

NOTICE

IF INSTALLING THIS PRODUCT FOR ANOTHER PARTY, PLEASE MAKE SURE THEY RECEIVE THIS COPY OF THE INSTALLATION INSTRUCTIONS SO THEY ARE AWARE OF THE IMPORTANT INFORMATION CONTAINED IN THEM.

TOOLS SUGGESTED

Set of Hex Wrenches, Combination Wrenches or Socket Set and Ratchet, Screwdrivers, Drill Bits, Drill, Center Punch

STRICTLY OBSERVE THE FOLLOWING GUIDELINES IN ORDER TO USE THE PRODUCT PROPERLY AND AVOID POTENTIALLY DANGEROUS ACCIDENTS.

STEP 1

Read and understand all steps in the instructions before starting the installation. Park the motorcycle on a hard, level surface and turn off the ignition. Let cool.

-cont.-

7535-21HD-0613

CUSTOMER SERVICE

877.370.3604 (toll free)

INSTALLATION QUESTIONS

techsupport@kuryakyn.com
or call 715.247.2983

LIMITED WARRANTY

Küryakyn warrants that any Küryakyn products sold hereunder, shall be free of defects in materials and workmanship for a period of one (1) year from the date of purchase by the consumer excepting the following provisions:

- Küryakyn shall have no obligation in the event the customer is unable to provide a receipt showing the date the customer purchased the product(s).
- The product must be properly installed, maintained and operated under normal conditions.
- Küryakyn makes no warranty, expressed or implied, with respect to any gold plated products.
- Küryakyn shall not be liable for any consequential and incidental damages, including labor and paint, resulting from failure of a Küryakyn product, failure to deliver, delay in delivery, delivery in nonconforming condition, or for any breach of contract or duty between Küryakyn and a customer.
- Küryakyn products are often intended for use in specific applications. Küryakyn makes no warranty if a Küryakyn product is used in applications other than intended.
- Küryakyn electrical products are warranted for one (1) year from the date of purchase by the consumer. L.E.D.'S contained in components of Küryakyn products will be warranted for defects in materials and workmanship for 3 years from the date of purchase where as all other components shall be warranted for one(1) year. This includes, but is not limited to; control modules, wiring, chrome & other components.

- Küryakyn makes no warranty of any kind in regard to other manufacturer's products distributed by Küryakyn. Küryakyn will pass on all warranties made by the manufacturer and where possible, will expedite the claim on behalf of the customer, but ultimately, responsibility for disposition of the warranty claim lies with the manufacturer.

ABOUT OUR CATALOG

For purchasing Küryakyn® products, you can receive a complete catalog free of charge.

Send the Proof-of-Purchase below with your address to: Küryakyn, P.O. Box 339, Somerset, WI 54025.

Please indicate either Accessories Catalog for Harley-Davidson® or GL & Metric Cruisers.

Be sure to ask your local dealer about other Küryakyn® products, the motorcycle parts and accessories designed for riders by riders.

©2005 Küryakyn USA® All Rights reserved.

kuryakyn.com





YOU WILL BE WORKING AROUND THE ENGINE AND EXHAUST SYSTEM DURING INSTALLATION. ENSURE THAT THE ENGINE AND EXHAUST SYSTEM HAVE FULLY COOLED TO PREVENT INJURY.



THIS ASSEMBLY IS ONLY AS STRONG AS THE OEM COMPONENTS IT IS ATTACHED TO. ADDING THIS FOOTREST POSITION CAN INCREASE LEVERAGE ON THE OEM EQUIPMENT. THIS ACCESSORY IS INTENDED AS A FOOT REST ONLY. DO NOT STAND ON, OR APPLY EXCESSIVE FORCE TO THESE PEGS.

STEP 2

Starting with the right side, remove the footboard pad from the base by gently pulling up on the rubber pad while simultaneously pushing on the rubber darts (PIC 1) protruding from the underside of the footboard assembly.

STEP 3

Lay one of the stiffener plates on the foot board base as shown in PIC 2. Use this plate as a template to mark the position of the six mounting holes. PIC 2 Use a center punch or felt tip pen to mark the hole positions.

NOTICE

MEASURE TWICE – DRILL ONCE. Double check all reference marks made on the floorboard base BEFORE drilling. Kuryakyn will not be responsible for incidental or consequential damages resulting from this installation.

STEP 4

Using a center punch, mark the center of each hole. Using a 1/4" drill bit, drill out the six holes.

STEP 5

Loosely install the stiffener plate using the three rear mounting holes. Insert the 1/4"-20 x 5/8" button socket cap screws through the stiffener plate and base. Secure with the 1/4" flat washers, and nylon locking nuts from the bottom. PIC 3

STEP 6

Place the mounting bracket under the foot board so its mounting holes line up with the forward three mounting holes. Insert the 1/4"-20 x 1-1/2" button socket cap screws through the stiffener plate, the base then the mount. PIC 4 Secure with the 1/4" flat washers, and nylon locking nuts from the bottom.

STEP 7

Tighten all six mounting bolts securely.

STEP 8

Wet the Isolators with soapy solution and reinstall the rubber pad to the steel foot board body. You may have to carefully pull the rubbers through the holes in the board with pliers.

STEP 9

Using one of the supplied 5/16"-18 X 3/4" socket head cap screws, attach the right side offset arm/clevis assembly to the mount. Leave finger tight for now. PIC 4

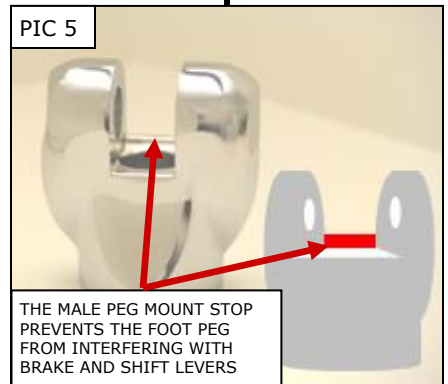
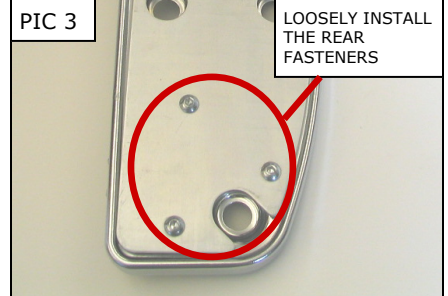
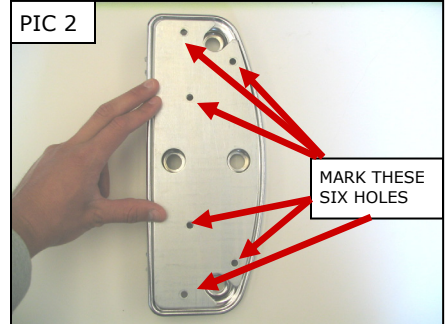
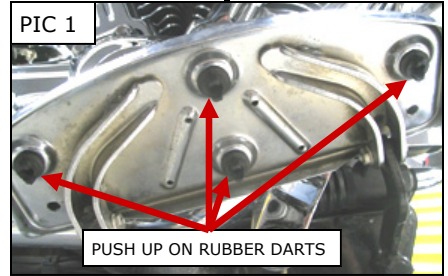



WARNING FOOTPEGS MUST BE INSTALLED SO THEY WILL FOLD UPWARD AND REARWARD IF HIT BY ANY OBJECT. FAILURE TO ADJUST THE FOOTPEGS TO OPERATE IN THIS MANNER COULD RESULT IN SERIOUS INJURY OR DEATH.

STEP 10

Install the H-D style male mount peg (purchased separately) of your choice to the clevis on the adjustable mount using the 3/8" fastener and wave washer from the clevis.

NOTE: Position the Spitfire Clevis (PIC 5) so the peg mount stop is on the topside, regardless of which side the clevis is installed on the bike.

STEP 11

Repeat all steps for opposite side

STEP 12

Loosen the offset arm pivot cap screw (PIC 4) and adjust the arm to a position comfortable to you. Check for interference with the front fender as the front end is turned through its full range of movement. Grasp the front brake and cycle the suspension while the front end is at full lock; do this for both right and left directions. If any contact occurs, adjust the bar closer to the rider and test again. Be certain that the placement of these pegs does not interfere with accessibility to the motorcycle controls (brake pedal, shifter, etc). Once the optimum position is found, tighten the offset arm pivot cap screw securely into place.



WARNING TURN THE FORK LOCK TO LOCK TO CHECK FOR CLEARANCE BETWEEN THE ADJUSTABLE CRUISE PEG MOUNTS AND ANY OTHER COMPONENT ON THE MOTORCYCLE. INSUFFICIENT CLEARANCE MAY CAUSE LOSS OF CONTROL RESULTING IN SERIOUS INJURY OR DEATH.



WARNING POSITION THE OFFSET ARMS AND PEGS SO THEY DO NOT INTERFERE WITH THE OPERATION OF THE FOOT CONTROLS. INTERFERENCE WITH THE FOOT CONTROLS MAY CAUSE LOSS OF CONTROL RESULTING IN SERIOUS INJURY OR DEATH.



WARNING CHECK TO MAKE SURE THAT THERE IS PROPER GROUND CLEARANCE FOR CORNERING. LOSS OF CONTROL OF THE MOTORCYCLE AND SERIOUS INJURY MAY OCCUR IF THE PEG/ARM IS NOT POSITIONED PROPERLY. REPOSITION THE PEG/ARM IF NECESSARY SO THAT THERE IS ADEQUATE CORNERING CLEARANCE.



CAUTION Ensure that the installation of this product does not interfere with the proper operation of the motorcycle before riding.

STEP 13

Check the tightness of all fasteners.



NOTICE It is the installer's responsibility to ensure that all of the fasteners (including pre-assembled) are tightened before operation of the motorcycle. Küryakyn will not provide warranty coverage on products or components lost due to improper installation or lack of maintenance. Periodic inspection and maintenance are required on all fasteners.