



YOSHIMURA

RESEARCH & DEVELOPMENT OF AMERICA, INC.

5420 DANIELS STREET STE A, CHINO CA., 91786 · (800)634-9166 · (909)628-4722 · FACSIMILE (909)591-2198

www.yoshimura-rd.com

RS-3 OVAL PERFORMANCE EXHAUST SYSTEM

00-08 SUZUKI DR400Z
03-04 KAWASAKI KLX400

D460AS-SA

STAINLESS STEEL SLIP-ON SYSTEM



THIS PRODUCT IS DESIGNED FOR USE IN CLOSED COURSE RACING AND IS NOT INTENDED FOR ANY OTHER USE.



CAUTION: The muffler packing on this system **MUST** be replaced every 6-8 hours of use, or after each moto. Failure to follow recommended muffler re-packing interval can cause muffler damage and may void the warranty.



NOTE: IN THE STATE OF CALIFORNIA, IT IS ILLEGAL TO MODIFY THE EMISSION CONTROL SYSTEM. WHICH INCLUDES THE CARBURETORS OF ANY VEHICLE.

Caution: Exhaust system can be extremely hot. Let motorcycle cool down before beginning installation.

Note: Read through all instructions before beginning installation.

Tools Needed:

8mm, 11mm and 12mm sockets
3/8" ratchet and extension
4mm and 6mm Allen bit for torque wrench
12mm Wrench
Torque wrench

Installation Steps:

- 1 Remove right rear number plate and header heat shield. (See Fig. 1 for fastener locations.)
- 2 Remove stock muffler assembly. (See Fig. 2 for fastener locations.)
- 3 Slide exhaust clamp over inlet of slip-on tailpipe. (See page 4).
- 4 Install Yoshimura tailpipe with muffler onto stock header.
- 5 Bolt tailpipe to chassis mount using stock bolt. See (Fig. 3) Do not tighten bolt at this point.
- 6 Apply heat insulator to inside of muffler clamp and slide clamp onto muffler. (Note direction of clamp in Fig. 4)
- 7 Mount muffler clamp to chassis using supplied bolt and aluminum spacer. (See Fig. 3)
Torque bolt to 2.5 kg-m (18 lb-ft).

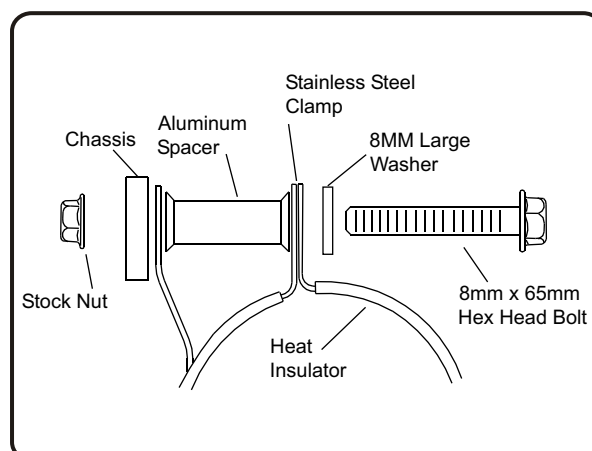

Fig. 1



Fig. 2

- 8 Mount muffler clamp to chassis using supplied bolt, washer, aluminum spacer and stock nut.
(See Fig. 4) Torque bolt to 2.5 kg-m (18 lb-ft).
- 9 Torque chassis mount bolt to 2.5 kg-m (18 lb-ft)
- 10 It is recommended that the muffler and tailpipe be wiped down with rubbing alcohol to remove oil and fingerprints. This will help prevent tarnishing of the finish after the exhaust is heated up.
- 11 Torque exhaust clamp nut to 1.25kg-m (9lb-ft).
- 12 Before starting motorcycle check for proper clearance between new exhaust system and rear suspension (i.e. rear brake, frame, shock spring, etc). If any problem is found, please carefully follow through the installation steps again. If a problem still persists, please call Yoshimura tech. Dept. at (800)634-9166 / in CA (909) 628-4722
- 13 Reinstall number plate and stock header heat shield.
- 14 Check for proper clearance between new exhaust system and number plate.

**Fig. 3****Fig. 4**

Note: After starting motorcycle, it is normal for new exhaust system to smoke until oil residue burns off.

#D460AS-SA

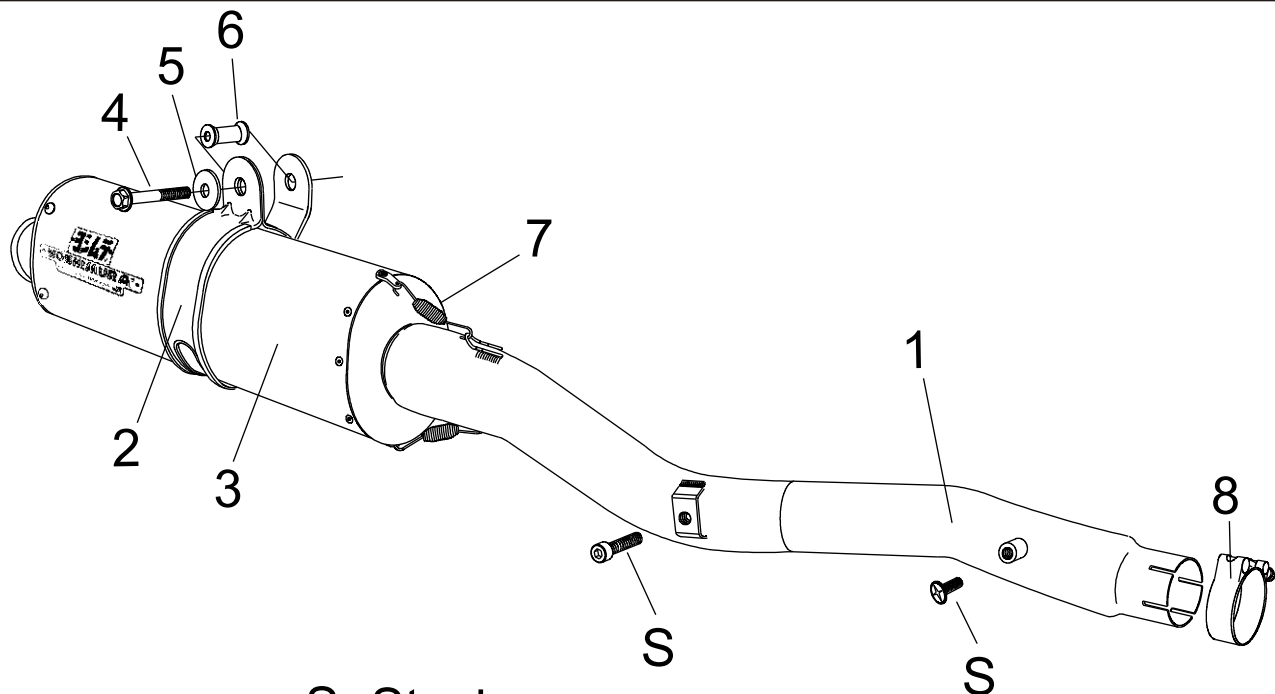

S=Stock

Parts Diagram

NO.	DESCRIPTION	QTY	PART #
1	Yoshimura Tailpipe Stainless Steel	1	D460ASRT
2	Stainless Steel Muffer Clamp	1	COS400S8ASD
**	Muffer Clamp Heat Insulator	1	HT SHLD-14A
3	RS-3 Muffer Assembly	1	**
4	Hex Head Bolt	1	M8X65H
5	Large 8mm Washer	1	8MMWASHERL
6	43mm Aluminum Spacer	1	8MMFS
7	2.5" Exhaust Spring	2	RACE-SPS
8	2" Stainless Steel Exhaust Clamp	1	220-59
**	Yoshimura Vinyl Sticker	1	17029

OPTIONAL ACCESSORIES	PART #
Tunable Endcap Option - includes Low & Medium sound spark arrested inserts	TEC-KIT

Nuts and Bolts Guide (Actual Size):

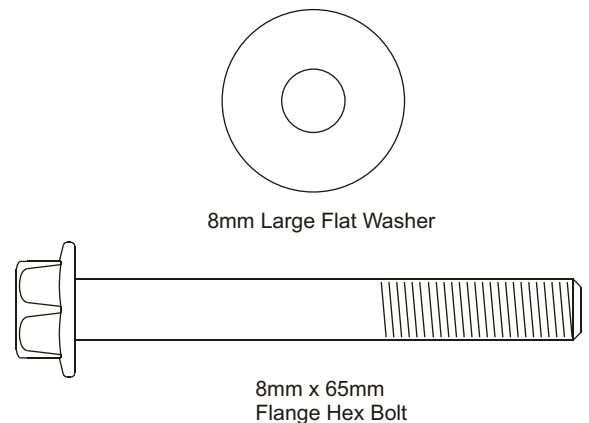

JETTING RECOMMENDATION

When using the stock carburetor, change the main jet to a 168 and move the needle clip down one position.



YOSHIMURA

RESEARCH & DEVELOPMENT OF AMERICA, INC.

4555 CARTER COURT, CHINO CALIF. 91710 · (800)634-9166 · (909)628-4722 · FACSIMILE (909)591-2198

www.yoshimura-rd.com

TEC-SA Spark Arrester Cleaning Information

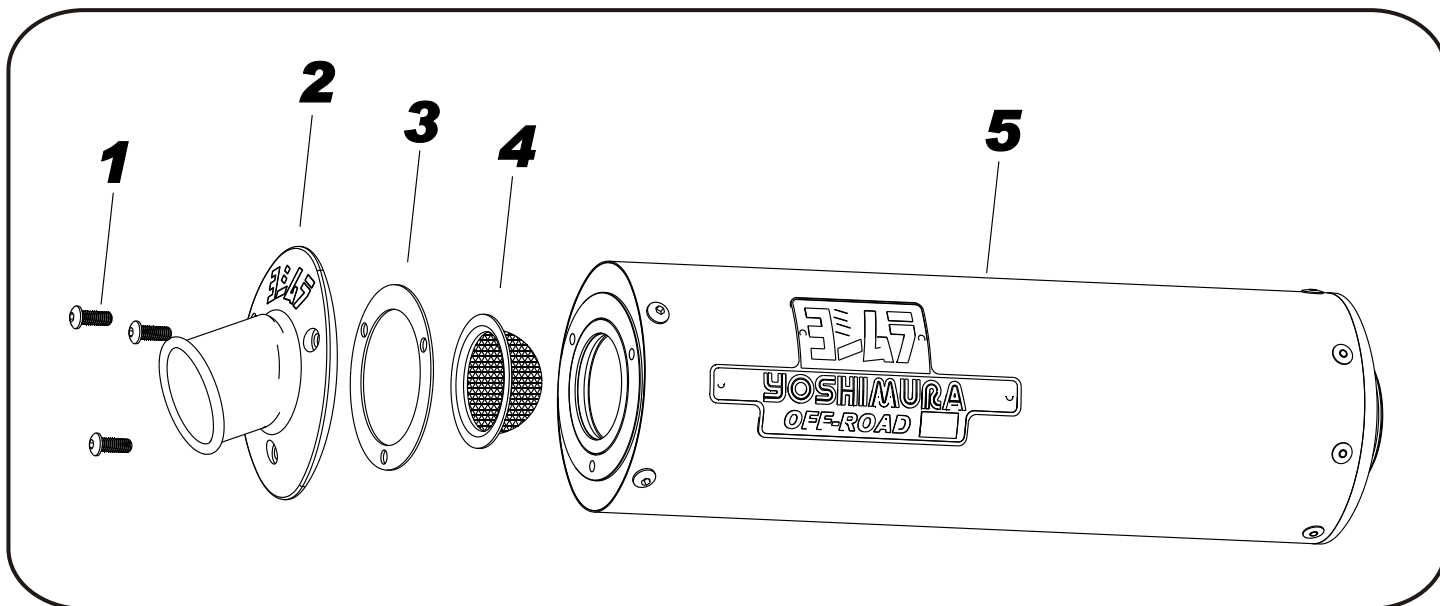

Parts Diagram

Caution: Muffler can be extremely hot. Let muffler cool down before removing spark arrester.

Note: Read through all instructions before beginning disassembly.

NO.	DESCRIPTION	QTY
1	6 x 1.0mm x 16mm Button Head Screw	3
2	4.0" YRD End Cap, Cover	1
3	T.E.C. End Cap, Gasket	1
4	T.E.C. End Cap, Spark Arrester	1
5	Muffler Assembly	1

Tools Needed:

4mm Allen Key
Wire Brush
Pair of Gloves
Safety Glasses

Cleaning Steps:

1 Using a 4mm Allen key remove the three 6mm x 16mm Button Head Screws located in the muffler end cap. (See Parts Diagram for location)

2 Remove the end cap, gasket and spark arrester from the muffler.

3 Using a wire brush remove carbon deposits from spark arrester screen. Once clean inspect the screen for excessive wear or damage, if any is found the spark arrester must be replaced. Cleaning and inspection should be performed after every 60 hours of use.

(Caution: Gloves and Safety Glasses should be worn while cleaning spark arrester.)

4 Re-install spark arrester, gasket, end cap and 6mm x 16mm screws into muffler assembly. Torque screws to 1.0 kg-m (7.3 lb-ft)

(Note: It is recommended that a low strength "Loctite" is used on the screws.)