



INSTALLATION

LED SPEAKER GRILLS FOR VICTORY — BLACK

7699

THANK YOU FOR CHOOSING KÜRYAKYN!

PROTECT YOURSELF AND OTHERS FROM POSSIBLE INJURY AND/OR PROPERTY DAMAGE OR LOSS. PAY CLOSE ATTENTION TO ALL INSTRUCTIONS, WARNINGS, CAUTIONS, AND NOTICES REGARDING THE INSTALLATION, USE, AND CARE OF THIS PRODUCT.

WARNING

THIS INDICATION ALERTS YOU TO THE FACT THAT IGNORING THE CONTENTS DESCRIBED HEREIN CAN RESULT IN POTENTIAL DEATH OR SERIOUS INJURY.

CAUTION

This indication alerts you to the fact that ignoring the contents described herein can result in minor or moderate potential injury.

NOTICE

This indication alerts you to the fact that ignoring the contents described herein may negatively affect product performance and functionality or damage the product itself or the product to which it is being attached.

MAKE SURE THE FOLLOWING PARTS HAVE BEEN INCLUDED IN THE KIT:

- 1 Right Speaker Grill Assembly — Black
- 1 Left Speaker Grill Assembly — Black
- 1 Hardware Kit containing:
 - 1 Fairing "Run" Adapter
 - 1 Dielectric Grease Pack
 - 6 Cable Ties
- 1 Installation Instructions

SOME PICTURES DEPICT CHROME PARTS, HOWEVER INSTALLATION IS THE SAME FOR BLACK PARTS

TOOLS SUGGESTED

Set of metric hex wrenches, plastic trim tool, set of metric hex sockets, in/lbs torque wrench

NOTICE

This copy of installation instructions contains important information. Ensure that the end user receives this copy and is aware of its importance for future reference.

STEP 1

Read and understand all steps in the instructions before starting the installation. Park the motorcycle on a hard, level surface and turn off the ignition.

NOTICE

A factory service manual may be helpful in performing this installation. Do not attempt to perform this installation and consult a trained technician if you are not confident in your ability to complete all of the steps in these instructions.

Avoid damage to the motorcycle. Protect painted surfaces with a soft cloth or blanket.

CUSTOMER SERVICE

877.370.3604 (toll free)

INSTALLATION QUESTIONS

techsupport@kuryakyn.com
or call 715.247.2983

LIMITED WARRANTY

Kuryakyn warrants that any Kuryakyn products sold hereunder, shall be free of defects in materials and workmanship for a period of one (1) year from the date of purchase by the consumer excepting the following provisions:

- Kuryakyn shall have no obligation in the event the customer is unable to provide a receipt showing the date the customer purchased the product(s).
- The product must be properly installed, maintained and operated under normal conditions.
- Kuryakyn makes no warranty, expressed or implied, with respect to any gold plated products.
- Kuryakyn shall not be liable for any consequential and incidental damages, including labor and paint, resulting from failure of a Kuryakyn product, failure to deliver, delay in delivery, delivery in nonconforming condition, or for any breach of contract or duty between Kuryakyn and a customer.
- Kuryakyn products are often intended for use in specific applications. Kuryakyn makes no warranty if a Kuryakyn product is used in applications other than intended.
- Kuryakyn electrical products are warranted for one (1) year from the date of purchase by the consumer. L.E.D.'S contained in components of Kuryakyn products will be warranted for defects in materials and workmanship for 3 years from the date of purchase where as all other components shall be warranted for one(1) year. This includes, but is not limited to; control modules, wiring, chrome & other components.

• Kuryakyn makes no warranty of any kind in regard to other manufacturer's products distributed by Kuryakyn. Kuryakyn will pass on all warranties made by the manufacturer and where possible, will expedite the claim on behalf of the customer, but ultimately, responsibility for disposition of the warranty claim lies with the manufacturer.

ABOUT OUR CATALOG

For purchasing Kuryakyn® products, you can receive a complete catalog free of charge.

Send the Proof-of-Purchase below with your address to: Kuryakyn
454 County Road V V
Somerset, WI 54025-9031
Please indicate either Accessories Catalog for Harley-Davidson® or GL & Metric Cruisers.

Be sure to ask your local dealer about other Kuryakyn® products, the motorcycle parts and accessories designed for riders by riders.

©2005 Kuryakyn USA® All Rights reserved.



kuryakyn.com

STEP 2

Use a plastic trim tool to gently pry both OEM speaker grills out of the fairing as shown in **PIC 1**; start on the outside and work your way inward. Remove the screw shown in **PIC 2** from both sides; set it aside for now, it will be reused later.

Kuryakyn

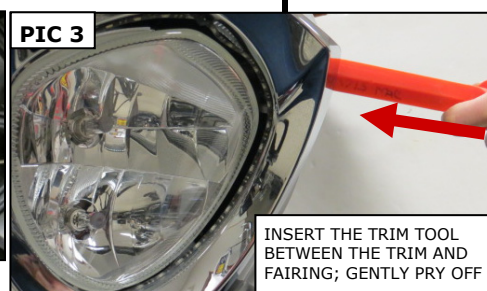

STEP 3

Refer to **PIC 3**. Use the plastic trim tool to gently pry the headlight trim away from the fairing; set it aside for now, it will be reused later. Remove the four screws securing the headlight assembly to the fairing; set the screws aside; they will be reused later.

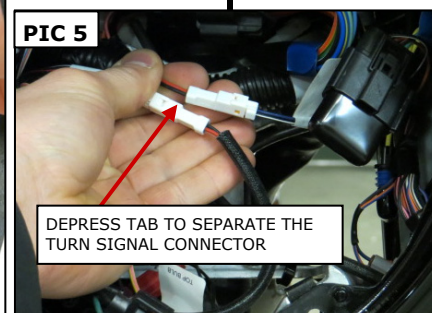
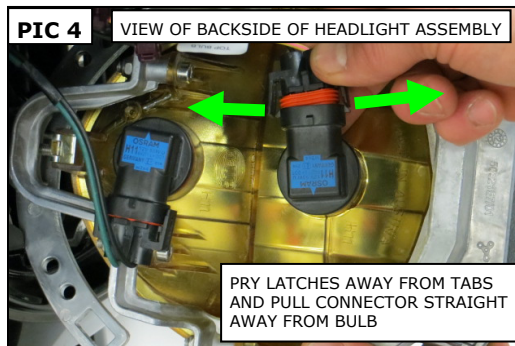

STEP 4

Refer to **PIC 4**. Gently pry the latches away from the tabs on the bulb connectors; pull the connectors straight away from the bulbs. Set the headlight assembly aside for now.

STEP 5

Refer to **PIC 5**. Locate the left and right turn signal connectors inside the headlight area of the fairing. Depress the small tabs to separate the turn signal connectors.

STEP 6

Remove the screws shown in **PIC 6** from each side of the fairing. Grasp the fairing by the upper edge (just below the windshield) and bottom of the headlight opening. Pull forward on the bottom edge and then the top to remove the outer fairing. Set the fairing on a soft sturdy surface.

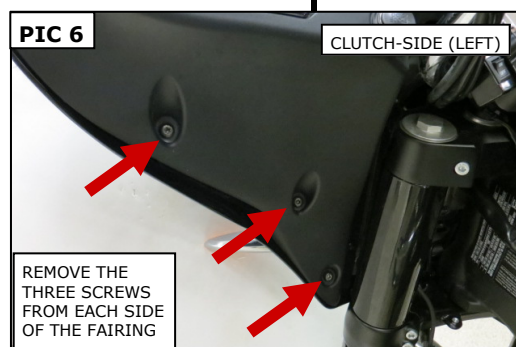

NOTICE

Kuryakyn recommends the use of the included dielectric grease on ALL electrical connections.

STEP 7

Refer to **PIC 7**. Locate the included 14-pin Fairing "Run" Adapter in the kit. On the inside of the inner fairing, locate and separate the black 14-pin connector on the bike. Apply some of the included Dielectric Grease to the open connector ends and link the Fairing "Run" Adapter in between the black 14-pin connectors.

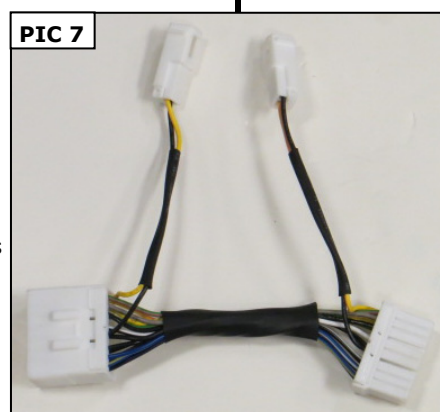

STEP 8

Refer to **PIC 8**. Determine the clutch-side (left) Speaker Grill from the brake-side (right).



-cont.-

PAGE
2

STEP 9

Refer to **PICs 9 and 10**. Route the wiring harness from the clutch-side Speaker Grill through the inner fairing. Continue to route the wire between the frame and inner fairing, aiming for the Fairing "Run" Adapter. Refer to **PIC 11**. Let the Grill hang down about three inches for now.

STEP 10

Repeat **STEP 9** for the brake side.

STEP 11

Apply Dielectric Grease to the open connector ends; link the connectors from both Speaker Grills to the two adapters on the Fairing "Run" Adapter. Turn the ignition on and test for proper function of the Speaker Grill lights.

NOTICE

Use the included Cable Ties to secure all wiring away from any moving parts, pinch points or extreme heat. Kuryakyn **WILL NOT** warranty any electrical component that fails due to pinched, crimped, broken, abraded, melted or frayed wires.

STEP 12

Reconnect the turn signal connectors; reinstall the outer fairing. Reconnect the headlight bulbs; reinstall the headlight assembly and headlight trim. Reinstall the screws in the outer fairing and speaker area. **Torque all headlight-mounting and fairing screws to 36 in/lbs.**

STEP 13

Refer to **PICs 11 and 12**. Align the locating tab on the backside of the grill with the raised slot in the inner fairing. Snap the Speaker Grill in place as shown. Repeat for the other side.

WARNING

VISIBILITY IS A MAJOR CONCERN FOR MOTORCYCLISTS. A LIGHT MALFUNCTION COULD RESULT IN DEATH OR SERIOUS INJURY. ENSURE PROPER LIGHT OPERATION BEFORE RIDING THE MOTORCY-

NOTICE

It is the end user's responsibility to ensure that all of the fasteners (including pre-assembled) are tightened before operation of the motorcycle. Kuryakyn will not provide warranty coverage on products or components lost due to improper installation or lack of maintenance. Periodic inspection and maintenance are required on all fasteners.

