



YOSHIMURA

RESEARCH&DEVELOPMENT OF AMERICA, INC.

5420 DANIELS STREET STE A, CHINO CA., 91710 · (800) 634-9166 · (909) 628-4722 · FACSIMILE (909) 591-2198

www.yoshimura-rd.com

Street Series

BMW R nineT ***1590025500***

RS-3 Stainless Steel Slip-On

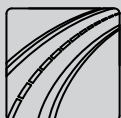

All Street Series systems are:

- Slip-on/Bolt-on applications that do not require tampering with the vehicle's emissions control system.
- CARB/EPA tail-pipe emissions compliant and
- Marked with appropriate EPA noise labels.
- Not tested for EPA new vehicle noise compliance.



You must know how to remove and replace your stock exhaust in order to install this product otherwise have it installed by a professional mechanic. Keep all stock parts from your existing system as some components may be necessary to install your new Yoshimura exhaust depending on the application. Read through all instructions before beginning installation. Exhaust system can be extremely hot. Let motorcycle cool down before beginning installation. Always wear hand and eye protection and take precautionary measures to avoid injury.



NOTE: IN THE STATE OF CALIFORNIA, IT IS ILLEGAL TO MODIFY THE EMISSION CONTROL SYSTEM, WHICH INCLUDES THE CARBURETORS OF ANY VEHICLE.

Assembly Diagram

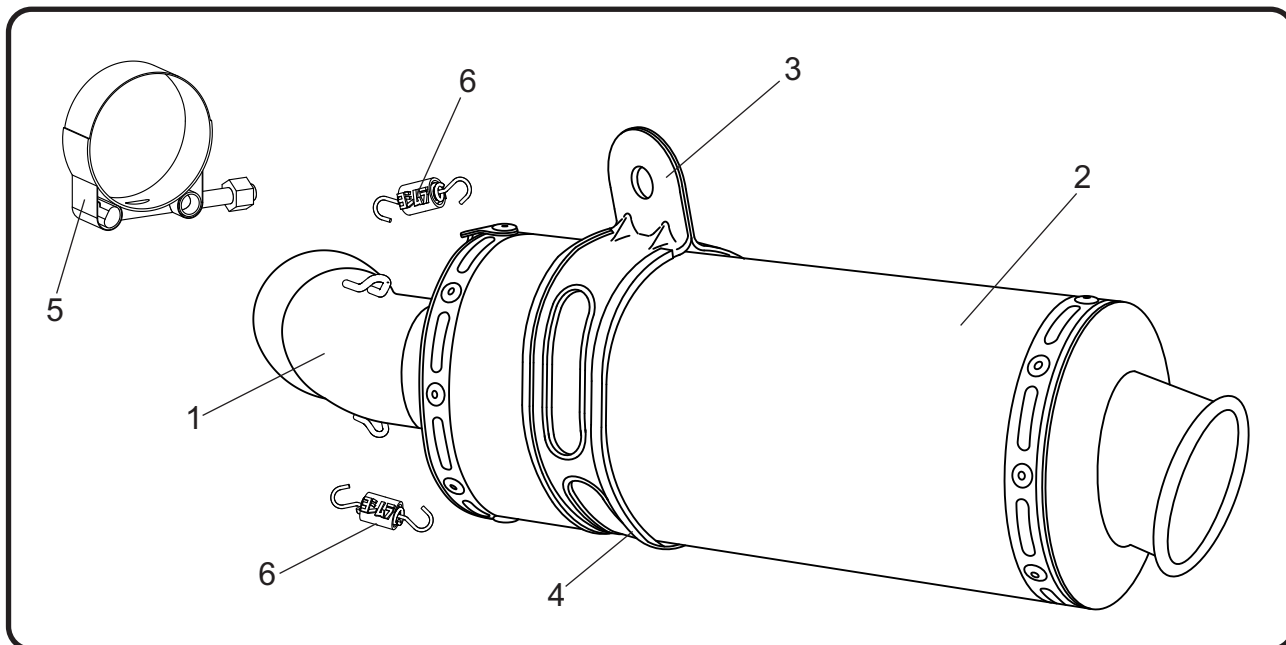

No.	Item	Description	Qty.
1	15900-435	Yoshimura Tailpipe	1
2	1590025500-LMA	Yoshimura Muffler	1
3	COS450S8DSX	Muffler Clamp	1
4	HT SHLDTRS	Muffler Clamp Heatshield	1
5	20069	Exhaust Clamp	1
6	RACE-SPX-1	Small Exhaust Spring	2
**	8MMNUT	8mm Flange Nut	1
**	RS3-INS-K	Low Volume Insert	1
**	ST-200	Spring Puller Tool	1
**	17029	Sticker Kit Sheet	1

** Not shown in diagram.

Removal

1. Loosen muffler exhaust clamp.
2. While securely supporting the stock muffler assembly, remove the muffler mount bolt and carefully remove the stock muffler assembly.

Note¹: The stock muffler exhaust gasket will not be used with the Yoshimura Slip-On system.

Note²: Do not remove or tamper with the exhaust valve servo system. Doing so may result in a malfunction indicator displayed on the gauge cluster.

Installation

1. Install (No. 4) *HT SHLDTRS*, muffler clamp heatshield onto (No. 3) *COS450S8DSX*, muffler clamp.
2. Install (No. 5) *20069*, exhaust clamp onto (No. 1) *15900-435*, tailpipe inlet.
3. Slide (No. 3) *COS450S8DSX*, muffler clamp over (No. 2) *1590025500-LMA*, Yoshimura muffler assembly.
4. Install (No. 1) *15900-435*, tailpipe inlet over the stock header outlet and align muffler clamp to the stock muffler mount.
5. Secure muffler to muffler mount using the stock bolt, stock countersink washer, and provided 8mm nut. Torque muffler mount bolt to factory specification.

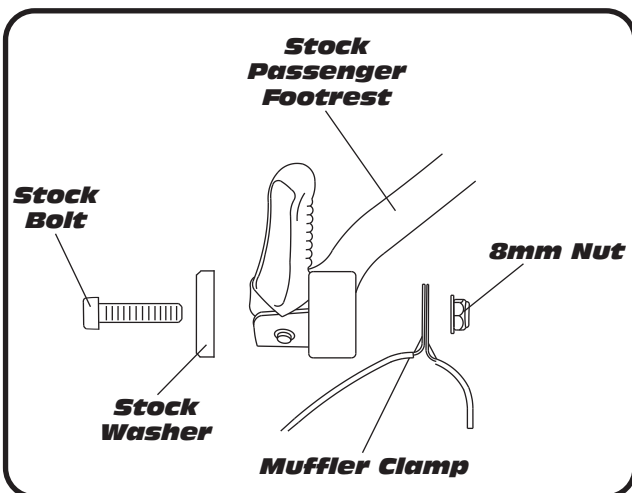

7. Before starting vehicle, check for proper clearance between new exhaust system and rear suspension (i.e. tire, control arm, brakes, rear shock, and etc.) If any problem is found, please carefully follow through the installation steps again. If problem still persists, please call Yoshimura Tech Department at (800) 634-9166 / in CA (909) 628-4722.
8. It is recommended that the muffler and tailpipe be wiped down with rubbing alcohol to remove oil and fingerprints. This will help prevent tarnishing of the finish after the exhaust is heated up.

Note: After starting vehicle, it is normal for new exhaust system and muffler to emit smoke until oil residue burns off.

6. Torque (No. 5) *20069*, exhaust clamp to 8.5 Nm (0.86 kg-m, 6 ft-lb).