



**ATTENTION INSTALLER** (if other than owner):

Please forward this instruction sheet and the warranty card to the purchaser of this product. These instructions also contain valuable information necessary to the end user.

**INTRODUCTION:**

These instructions describe the procedure for properly installing KHROME WERKS® Saddlebag Support kit onto certain 2008-up Harley-Davidson® FXD,B,C Dyna® (except FLD, FXDF); and 2010-up FXDWG Dyna® Wide Glide® models. Review instructions carefully before beginning, as they contain important information. Please retain for future reference.

Particularly important information is distinguished in these instructions by the following notations:

**NOTE:** A NOTE provides key information to make procedures easier or clearer.

**CAUTION:** A CAUTION indicates special procedures that must be followed to avoid damage to the motorcycle or accessories.

**WARNING:** A WARNING indicates special procedures that must be followed to avoid injury or death to a motorcycle operator or person inspecting or repairing the motorcycle.

**TOOLS REQUIRED:**

- 1 – 7/32" hex key socket
- 1 – T45 Torx socket
- 1 – 3/4" Socket
- 1 – Torque wrench
- #242 Loctite (blue)

**PROCEDURE:**

**CAUTION:** Perform installation on one side at a time.

1. Remove the OEM acorn nut, washer and upper shock cover if (If equipped). Save nut and washer (Items 2, 3), discard the shock cover.
2. Remove and discard OEM Torx screw directly behind upper shock acorn nut on the chrome fender support. This fastener threads into a nut plate and it will remain in place secured by the rear turn signal fastener. Make sure the OEM spacer washer between the fender and the frame strut remains in place.
3. Install the KW saddlebag supports front bracket (Ref item 4) over the OEM shock stud. Apply Loctite to the OEM shock nut (Item 2) and install along with the saved washer (Item 3). Do not tighten at this time.

**INSTALLATION INSTRUCTIONS**

**SADDLEBAG SUPPORT KIT**

For 2008-up FXD,B,C Dyna® (except FLD, FXDF);  
and 2010-up FXDWG models

Mfg. p/n 110825

(See pkg. label for Dist. p/n)

**Note:** In the next step FXDWG models use the 2.25" button head cap screw (Item 5). All other models except FXDWG use the 2.75" button head cap screw (Item 6) and .50" long spacer (Item 7).

4. Apply blue Loctite to the correct supplied button head cap screw (Item 5 or 6) and install through the rear saddlebag support boss (spacer if applicable), OEM chrome fender support, frame strut, sissy bar side plate, spacer washer, and fender and into the fender nut plate. Torque to 12-18 ft-lbs torque.

**WARNING:** Make sure that rear screw is fully engaged into nut plate, but not able to contact rear tire when rear shocks are compressed.

5. Torque acorn nut to 25-40 ft-lbs torque.

**WARNING:** Check saddlebag support clearance for proper operation of shock while suspension is compressed.

6. Repeat for other side.

**WARNING:** Saddlebags must be secured to the supports with straps supplied by saddlebag manufacturer. Upon initial installation ensure that no parts of the bags or the mounting straps could interfere with operation of rear belt, shocks, wheel or come in contact with rear muffler. We recommend throw-over saddlebags be mounting securely under the seat (not thrown over it). Periodically check straps to ensure proper installation.

**USE AND CARE:** Wash your accessories with the same care you use when washing your motorcycle. Use mild soap and water. DO NOT use abrasive chemicals or cleaners, or high pressure washers.

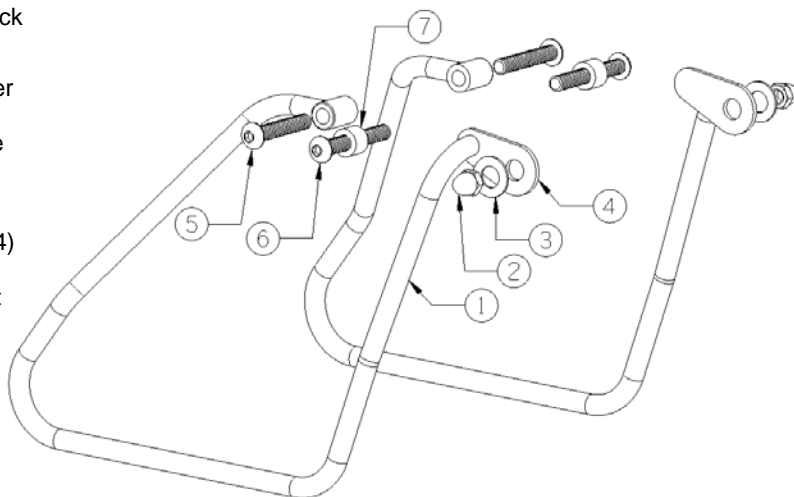

**KHROME WERKS®**

div. D.S. Manufacturing, Inc. • 67 Fifth St. N.E. • Pine Island, MN 55963