

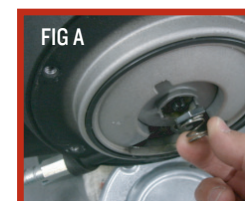

### NOSTALGIA SPORTSTER DERBY COVER



1. Turn your motorcycle off and place securely on a lift or side stand.
2. Place an oil pan underneath the derby cover area and remove the existing derby cover. (refer to the HD service manual if necessary).
3. Once the existing derby cover is removed clean all mounting surfaces and wipe out excess oil. Make sure to save the clutch adjustment spring and lock plate, they will be reinstalled (Fig A).



4. With the factory derby cover removed check the primary oil level. Add oil if necessary per the HD service manual.
5. Install the RSD Nostalgia Derby cover and hand tighten bolts to hold it in place.  
**Note: Upon assembly use blue Loctite 243 on all fasteners.**

6. Torque the 1/4-20 x 5/8" bolts to 95 in-lbs using the torque pattern in Fig B .



FIG B  
TORQUE SEQUENCE

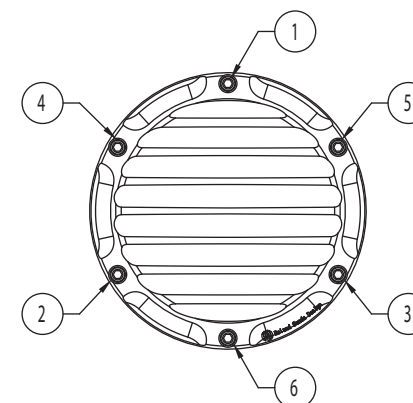

7. Go for a ride!

#### PRODUCT DESCRIPTION

2004-UP XL SPORTSTER MODELS : NOSTALGIA DERBY COVER

0177-2024

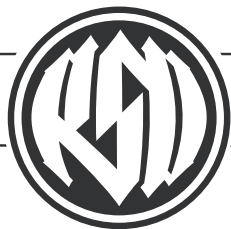

# ROLAND SANDS DESIGN

## Nostalgia Sportster Derby Cover

0048-0905 REVISION A 11/14/12 PAGE 2

# ASSEMBLY INSTRUCTIONS

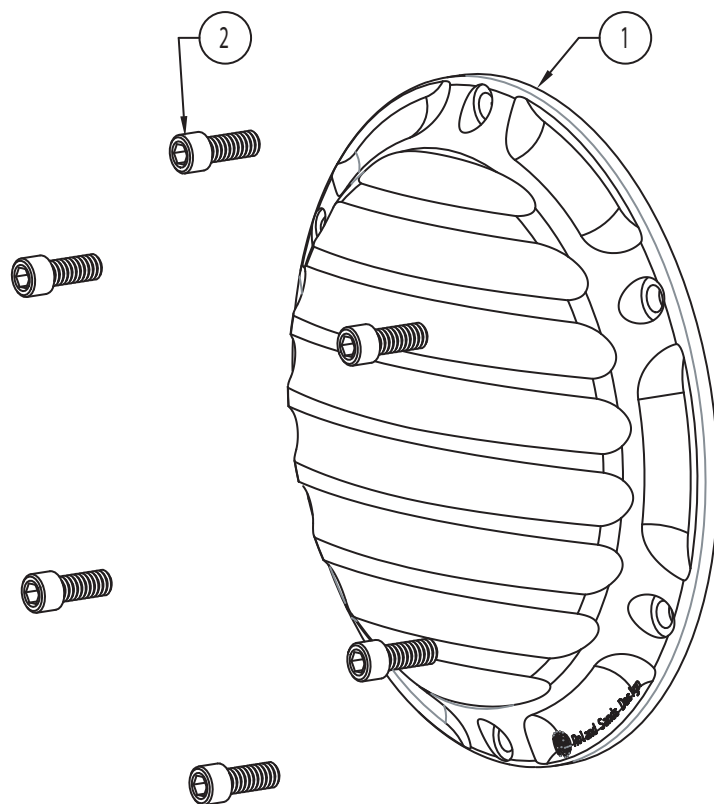

ITEM NO.	PART NUMBER	DESCRIPTION	QTY.
1	0177-0038	RSD NOSTALGIA DERBY COVER, 04-UP XL	1
2	0101-1005-SS	SHCS 1/4-20 X 5/8 SS	6

For questions pertaining to the installation of this product, please contact the Performance Machine technical department at 1-800-479-4037. This product is manufactured in the USA by Performance Machine LLC.