



ROLAND SANDS DESIGN®

ASSEMBLY INSTRUCTIONS

0048-0923

REVISION A

1/7/13

PAGE 1

TRACKER FORK BRACE FOR DYNA MODELS



PRODUCT DESCRIPTION

2006-LATER DYNA FXD MODELS (EXCEPT FXDWG, FXDF, & FLD)

0208-2048

1. Turn off motorcycle and place securely on a lift or sidestand.
2. Remove the 4 bolts holding the factory fender using a 1/4" hex wrench and a 1/2" box wrench. Consult the factory service manual for additional instructions.



3. With the fender removed clean and inspect the mating surfaces and install the RSD Tracker fork brace (6) using the supplied inner spacers (9), outer clamps (7), front spacers (8), and bolts (2).



4. Install the supplied washers (3) and nylock nuts (4) and torque to 17 ft-lbs.



5. Hit the road!

For questions pertaining to the installation of this product, please contact the Performance Machine technical department at 1-800-479-4037. This product is manufactured in the USA by Performance Machine LLC.



ROLAND SANDS DESIGN

TRACKER FORK BRACE

ASSEMBLY INSTRUCTIONS

0048-0923

REVISION A

1/7/13

PAGE 2

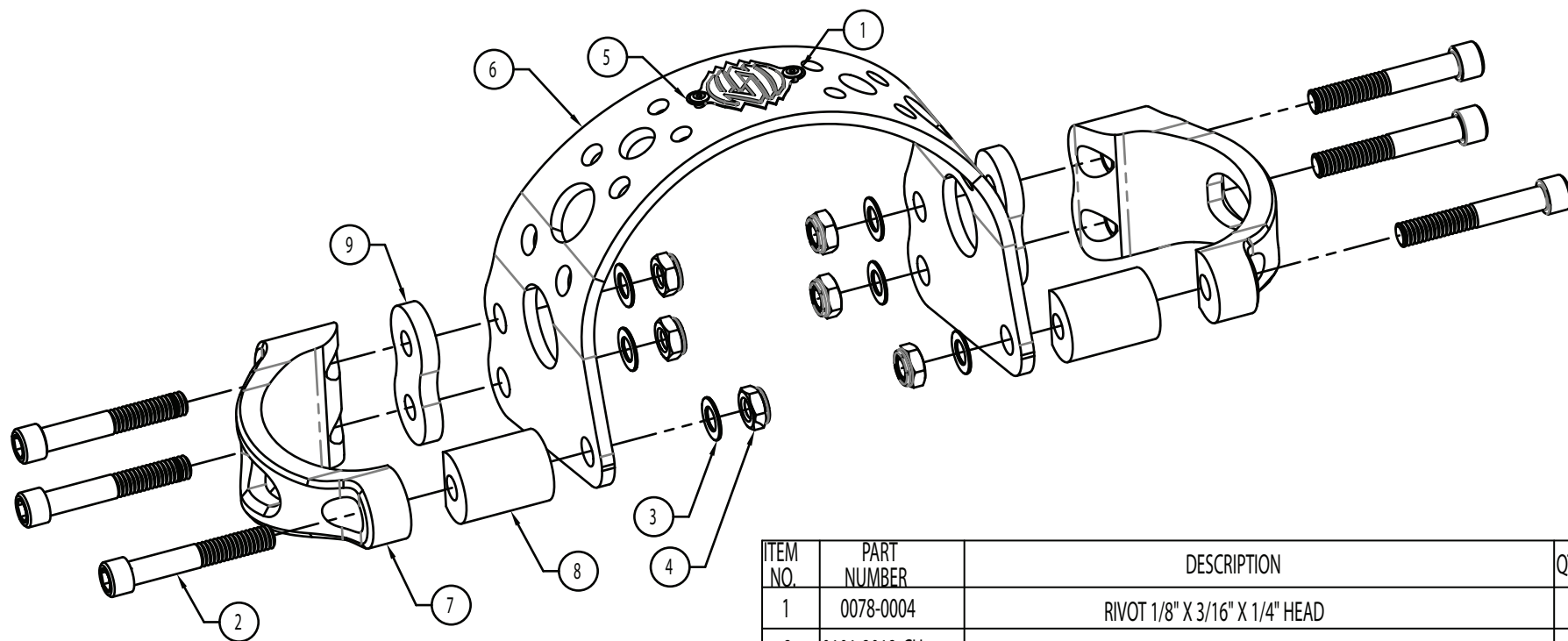

ITEM NO.	PART NUMBER	DESCRIPTION	QTY.
1	0078-0004	RIVOT 1/8" X 3/16" X 1/4" HEAD	2
2	0101-2012-CH	SHCS 5/16-18 X 2 CHROME	6
3	0106-2011	WASHER .32 X .57 X .03, STEEL FLAT	6
4	0107-2002-CH	NUT 5/16-18 ELASTIC JAM-CHROME	6
5	0208-0041	RSD BRASS BADGE, RSD TRACKER FRONT FORK BRACE	1
6	0208-0083	RSD FORK BRACE TRACKER, DYNA	1
7	0208-0084	RSD FORK CLAMP, TRACKER, DYNA	2
8	0208-0085	RSD 1.155 CLAMP SPACER	2
9	0208-0110	.175 FORK CLAMP SPACER	2