



PRODUCT DESCRIPTION

2001-2012 Twin Cam Models except 2001-2012 FL Touring models.

0177-2003

Warning: Will not fit 2001-2012 FL Touring models with stock and/or stock style exhaust pipes.

For questions pertaining to the installation of this product, please contact the Performance Machine technical department at 1-800-479-4037. This product is manufactured in the USA by Performance Machine LLC.

1. Turn your motorcycle off and disconnect the battery.
2. Place an oil pan underneath the cam cover area and remove the existing cam cover. (refer to the HD service manual if necessary). Removal of the exhaust system may be required on some models.
3. Once the existing cam cover is removed, clean all gasket/mounting surfaces and wipe out excess oil. **Note:** Do not use any harsh chemicals such as brake cleaner or acetone during cleaning.
4. Using supplied gasket, install the RSD Clarity Cam cover and hand tighten bolts to hold it in place.
NOTE: Upon assembly use blue 243 loctite on the 1/4" fasteners.
NOTE: Make sure the inside of the Lexan window is clean prior to installation. Clean with Plexus if necessary.
5. Torque the 1/4-20 x 1" bolts to 105 in-lbs using the torque sequence shown in Fig A below.
6. Reconnect the battery and check the oil level. Add oil if necessary per the HD service manual.
7. Reinstall the exhaust system if necessary.

Caution: The Clarity Cam cover may interfere with some exhaust systems. When installing, please verify there is an adequate distance of at least 5/16" between the Clarity window and the exhaust pipe to allow adequate air flow and cooling. Failure to verify the gap distance may result in severe damage to the Clarity windows, window discoloration, and potential oil leakage.

Disclaimer: Roland Sands Design is not responsible for damage caused by improper installation.

8. Go for a ride!

Fig A

CAUTION:

CLARITY WINDOW IS PERMANENTLY INSTALLED AT THE FACTORY AND SHOULD NOT BE REMOVED OR SERVICED. IF REMOVAL IS NECESSARY CONTACT THE TECH DEPARTMENT FOR SPECIAL SERVICE INSTRUCTIONS. PERFORMANCE MACHINE THE MANUFACTURER IS NOT RESPONSIBLE FOR DAMAGE TO THE CLARITY WINDOW CAUSED BY IMPROPER SERVICE.

USE ONLY LEXAN APPROVED CLEANERS SUCH AS PLEXUS TO CLEAN YOUR CLARITY WINDOW. HARSH CHEMICALS MAY CAUSE DAMAGE.

NOTE: FOGGING MAY OCCUR ON THE INSIDE OF THE LEXAN WINDOWS DUE TO HUMIDITY CHANGES. IF FOGGING IS VISIBLE START THE MOTORCYCLE AND RUN UNTIL FOGGING DISAPPEARS.

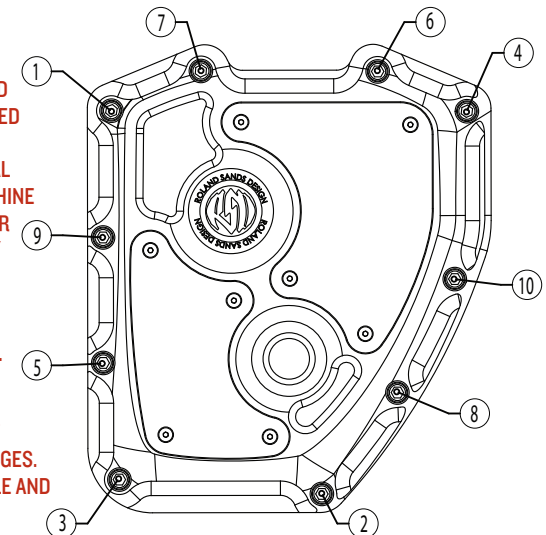

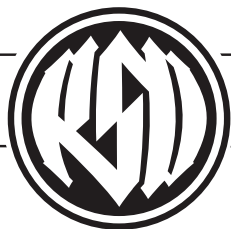

Clarity Cam Cover

Caution:

The Clarity Windows are preinstalled at the factory and should not be removed or serviced. If removal is necessary contact the tech department for special service instructions.

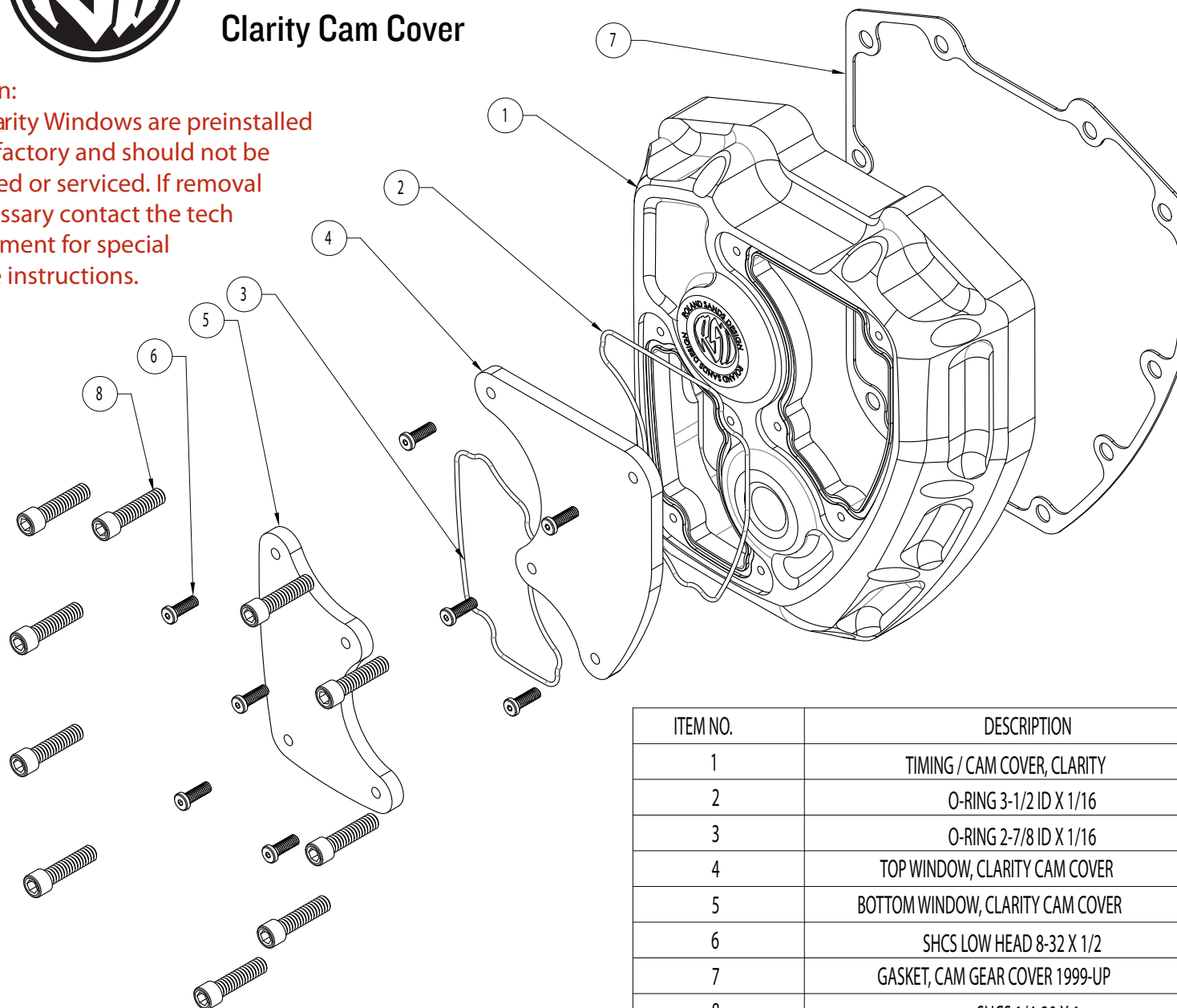

| ITEM NO. | DESCRIPTION | QTY. |
|----------|----------------------------------|------|
| 1 | TIMING / CAM COVER, CLARITY | 1 |
| 2 | O-RING 3-1/2 ID X 1/16 | 1 |
| 3 | O-RING 2-7/8 ID X 1/16 | 1 |
| 4 | TOP WINDOW, CLARITY CAM COVER | 1 |
| 5 | BOTTOM WINDOW, CLARITY CAM COVER | 1 |
| 6 | SHCS LOW HEAD 8-32 X 1/2 | 8 |
| 7 | GASKET, CAM GEAR COVER 1999-UP | 1 |
| 8 | SHCS 1/4-20 X 1 | 10 |