



## General Axle Slider Installation Instructions

### Part Numbers: 702 Series

---

**MADE IN THE USA!**

**Carefully read instructions in their entirety before the install**

Professional installation is recommended. Always use proper safety measures during product installation. Do not try to install this product without proper tools, recently calibrated torque wrench, correct torque specifications from **factory service manual**, safety goggles and gloves. The motorcycle must be in secured in a fixed position before the install process begins. **Shogun is not responsible for any damage caused to your motorcycle.** If you are performing your own installation (not suggested) and are unsure about the following directions any point please call us before the install process has begun.

**NOTE: These instructions are GENERAL use only!** Some motorcycles vary from brand or model; refer to your OEM service manual for all torque specs, disassembly and assembly instructions.

#### Replacement Parts List: Left Side Components (as if you were sitting on the bike)

QTY	Price each	Part Numbers	Descriptions
1	\$15.00	99-AS-702-0100	Black Left Side Puck
1	\$15.00	99-AS-702-0200	Black Left Side Puck (KAWASAKI ONLY)
1	\$18.99	99-HN-SS141525	Stainless Steel Machined Axle Bolt
1	\$0.49	99-HN-LN8125	8mm Lock nut
1	\$0.10	99-HWMO8WASH	8mm Washer

#### Replacement Parts List: Right Side Components (as if you were sitting on the bike)

1	\$15.00	99-AS-702-0100	Black Right Side Puck
1	\$15.00	99-AS-702-0200	Black Right Side Puck (KAWASAKI ONLY)
1	\$5.00	428-9086	Machined Spacer (HONDA/YAMAHA ONLY)
1	\$5.00	428-9087	Machined Spacer (SUZUKI ONLY)
1	\$0.49	99-HN-LN8125	8mm Lock nut
1	\$0.10	99-HWMO8WASH	8mm Washer
1	\$15.99	99-HR-TH8125485	Stainless Steel Machined Axle Rod

1. Remove left side OEM axle bolt. (If Required)
2. Install Shogun stainless steel machined axle bolt (99-HN-SS141525) and torque down. Refer to your service manual for proper torque specs. (If Required)
3. Using stainless steel machined axle rod (99-HR-TH8125485) 8mm lock nut (99-HN-LN8125) 8mm washer (99-HWMO8WASH) slide rod through axle puck (99-AS-702-0100) and slide assembly through front axle shown in pictures below.



4. In some motorcycles, a rubber retainer is inserted in the axle. Apply gentle force with rubber mallet to the rod to knock it loose. Remove and continue product installation.
5. Insert aluminum spacer over rod so that it fits flush in the axle. The smaller diameter portion of the spacer should be inserted facing towards the wheel.



6. Slide axle puck (99-AS-702-0100) over rod then tighten 8mm washer and 8mm locknut. NOTE: Do not over tighten assembly; nylon locking nuts will hold assembly tight.

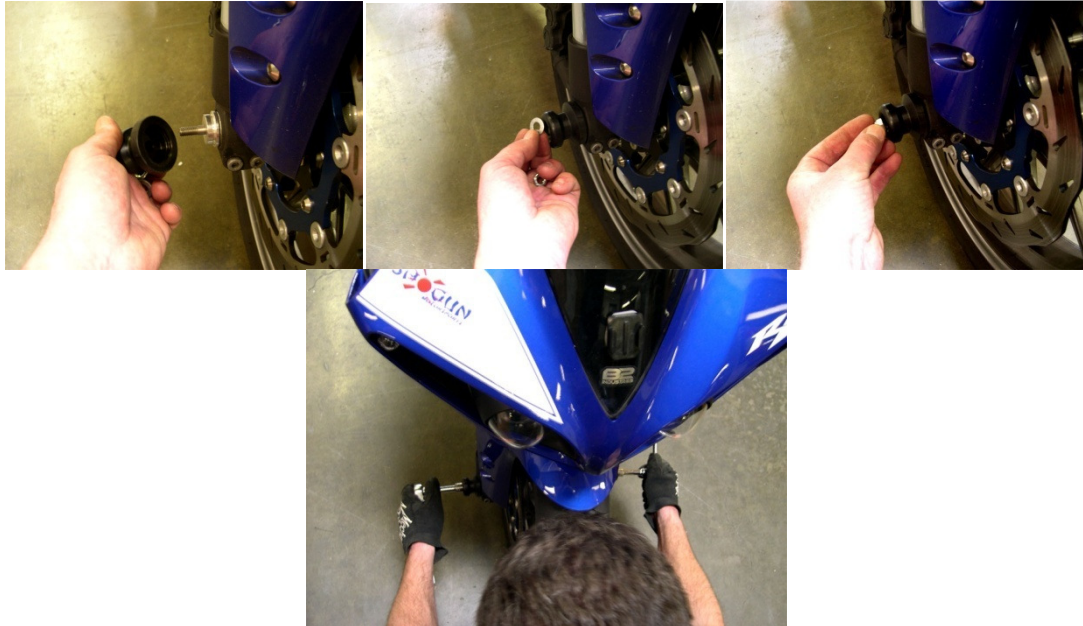

**READ CAREFULLY**

Shogun cannot guarantee that they will protect your motorcycle from any extent of damage. Shogun axle sliders are really meant to help possibly save the bottom of your forks from damage in the event of a crash. Because Shogun frame slider products have been very successful in saving cases, bodywork, levers and so on in the past, customers just assume sometimes you can put the product on and no damage will happen. The fact is, some crashes result in little or no damage to the motorcycle and some bikes are destroyed. Actual damage varies depending on all the interface of multiple forces applied during the incident. We have seen bikes crash at 100 mph with little damage and some at 15 mph with major damage.