



KAOKO™ CRUISE CONTROL KITS :

HNDST, HNDNT, HND31(S), HND30-17, HND30-19, HND28,
HNDVARA, HNDVARAOXF, KBBVARA

For Models **HONDA** ST1300

(Pan-European), NT700 Deauville, CBR600RR, CBR1000RR, 599, VFR800, CBR1100X,
Africa Twin, CB600, CB1000, CBF1000, CBF600, CB1300, VFR1200F/D : (including
OXFORD GRIPS &
BARKBUSTERS on some product codes listed above – enquire for further details)

For Models **SUZUKI** DL650 & DL1000 with Barkbusters
hand guards (KBBVARA product only).

SABS

DESIGN
EXCELLENCE
AWARDS
2009

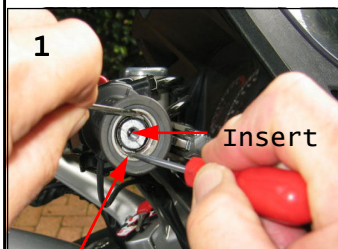

Two Spring Tabs

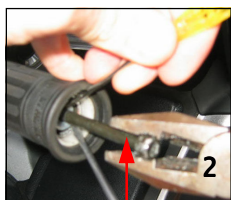

Bar weight
Retaining Screw

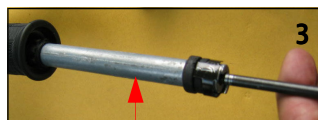

Handle Bar Insert

RSA Registered Designs
No. A2007/00202 No. A2007/00205
No. A2007/00203 No. A2007/00206
No. A2007/00204 No. A2007/00207



Throttle
Sleeve

Plastic
Thrust Washer

Grub
Screw



Central
Retaining
Screw

2mm gap between friction nut &
shoulder of KAOKO™ bar weight

Patens
"U.S. Pat. No. US D593,462 S"
"U.S. Pat. No. US D593,463 S"
"U.S. Pat. No. US D593,464 S"

DISCLAIMER: NO RESPONSIBILITY ACCEPTED FOR NON-ADHERENCE TO THESE INSTRUCTIONS

KAOKO™ Safety Warning:

See: www.kaoko.com - for further information - info@kaoko.com

The KAOKO™ Cruise Control is an aftermarket accessory. Any misunderstood, abused or incorrectly installed motorcycle accessory is a safety hazard that could cause injury or death. It's the rider's responsibility to understand the operation and purpose for which the KAOKO™ Cruise Control is designed, namely, for cruising, only when safe to do so. At all other times the control should be disengaged. The KAOKO™ Cruise Controls are to be used only by experienced and responsible riders. See reverse of page for full indemnity.

Fitting & Operating Instructions:

Step 1: Remove the Throttle side bar weight. Using two small screw drivers, prize the two spring tabs towards each other and simultaneously pull out the handle bar insert (see pic. 1, 2 & 3). Discard handle bar insert. For models HNDST & HNDNT; keep the bar weight retaining screw to attach the KAOKO™ kit.

Note: For model **HNDNT**, the spring tab is located deeper inside the handle bar than the other models. It is thus more difficult to remove the insert and using the 2 screw drivers. We suggest that if you experience difficulty that you take your bike into your Honda dealer and have their mechanic remove the insert for you.

Step 2: Place plastic thrust washer into end of throttle sleeve (see pic. 4).

Step 3: Fit the assembled KAOKO™ Kit fully into the handle bar and firmly tighten the bar weight retaining screw. Note to keep the 2mm gap between the Friction Nut and the shoulder of the KAOKO™ bar weight.

Note: For model **HNDNT**, a copper shim has been provided for the fitting. The ID of the handle bar varies between 17.5mm and 18mm. On most fitting applications the copper shim is required for the proper fitting. We suggest that you install the **HNDNT** control using the copper shim, and if there is no space for the shim then leave it out.

Step 4: see picture 5 for fully assembled KAOKO™ Cruise Control Kit.

Note: **HNDVARAOXF** – trim Oxford Grips to OEM grip length.

Note: **KBBVARA** – this item replaces part numbers 15, 17 & 18 from Barkbusters BHG31 product. Refer Barkbusters fitting instructions and follow all Barkbusters related fitting information. Fits Honda XL1000V Varadero with thrust washer "TH-TWD018W".

Note: **KBBVARA** – Also fits SUZUKI DL1000 and DL650 V-Strom with Barkbusters product BHG31. Fit with thrust washer "TH-TWD050"

Note: **KBBVARA** – Also fits HONDA XL600V, XL650V and XL700V Transalp with Barkbusters product BHG18; and replaces components 3 and 2 in Diagram 3 of Barkbusters BHG18 fitting instructions. Follow all Barkbusters related fitting instructions. Fit with thrust washer "TH-TWD100".

Operation: The friction nut has a **left hand thread**. In readiness for engagement, it must be adjusted so that it makes light contact against the thrust washer. (Picture 4 & 5)

To Engage: While rolling on the throttle, the friction nut can be gripped between the small finger and palm of hand. This action tightens the nut and provides sufficient friction to set throttle to the desired opening. (The friction is such that the rider may still open and close the throttle. The throttle simply has a slight rotational stiffness.)

To Disengage: While rolling off the throttle, grip friction nut between small finger and palm of hand.

VERY IMPORTANT—The throttle should open and snap closed freely when disengaged. **Note:** The Grub Screw is set to provide the necessary resistance on thread of friction nut. This may be adjusted periodically to take up wear.

Maintenance: Remove kit annually. Unscrew friction nut and brush clean threads with mild soap. Apply petroleum jelly to threads and assemble. Adjust grub screw to desired operating resistance. (O-Ring cushion: 19.6mm I.D. x 2.4mm section – if replacement is required)

Indemnity:

It is advised that the use of the cruise control is at the sole risk of the rider and by his/her decision to use it he/she does indemnify the manufacturers or organizers, their agents, employees and officers against any claim or action by themselves, their dependents or any other third party arising out of any loss, damage, injury or death suffered.

09.2011