



Part Number 75-105-4 Softail 2:1 Competition Series Exhaust System (00-10)

Congratulations, you have purchased the finest exhaust system available for your motorcycle. Your Vance & Hines exhaust is designed and crafted for maximum performance, a great sound and unbeatable style. Please follow the instructions below, check exhaust system for missing or damaged parts and if you need any assistance please contact our technical support line (562) 921-7461.

STOCK EXHAUST SYSTEM REMOVAL

Please remove the following:

1. Under the oil tank on the right hand side, locate the rear O² sensor connector. Unplug sensor and feed the end of wire through the frame. Note: Pay attention to wire routing for reinstallation.
2. Open the plastic cover above the rectifier located at the front of the frame. This will give you access to the front O² sensor connector. Unplug the sensor connector. Remove the cable tie holding the wire to the frame.
3. On FLSTC, FLSTF, FLSTN and FLSTSC models, loosen the right hand floor board mounting bolts to gain clearance for exhaust removal and installation.
4. Loosen the heat shield clamps on both front and rear exhaust pipes.
5. Remove the nuts from both front and rear exhaust cylinder head flanges.
6. If equipped, unbolt the carriage bolt and clamp attached to the bracket under the right side transmission cover.
7. Remove the nuts attaching the exhaust mounting bracket to the frame.
8. On FLSTD and FLSTF models, you will need to remove the right side passenger footpeg and hanger, as this is attached to the exhaust mounting bracket. Replace the passenger foot peg assembly using the 3/8"-16 x 2 1/2" allen bolt supplied.
9. Remove the entire exhaust system and set it aside.
10. If equipped, remove the bracket from under the right side transmission cover.
11. Using a 7/8" or 22mm wrench, carefully remove the O² sensor from the stock head pipes and save for re-use with the new system.
12. Remove the stock exhaust flanges and circlips from both the front and rear head pipes.
13. If the circlips are bent or damaged we recommend replacing them.

We recommend replacing the stock exhaust gaskets with the Screamin Eagle gasket kit, part number # 17048-98.

COMPETITION SERIES EXHAUST SYSTEM INSTALLATION

1. Identify front head pipe D352FB. Install the stock flange and circlip, install head pipe leaving the flange nuts hand tight.
2. Repeat the above step for the rear head pipe D353FB.
3. Slip the megaphone assembly onto the head pipes, secure with the springs supplied using the spring puller tool.
4. Align the megaphone mounting bracket to the frame and secure with the two 3/8"x3/4 bolts supplied.
5. Tighten the cylinder head flange nuts and bolts for both the front and rear head pipes.
6. Replace the O² plugs with the O² sensors removed from the stock exhaust on the front and rear head pipes.
7. Reconnect the O² sensors to the wire harness.
8. Clean all fingerprints from the exhaust using a contact cleaner (or other non flammable cleaner). Fingerprints will leave stains on the pipe once the motorcycle is started.
9. You are now ready to start the motorcycle.

Note: After initial ride it is recommended to re-torque the baffle screw to 8-10 lb. using a 5/32" allen wrench.

For best results, we recommend fuel injection mapping for your new combination using a Fuelpak or Power Commander. Settings for the Fuelpak and some Power Commander maps are available on our website at www.vanceandhines.com

Vance & Hines

13861 Rosecrans Ave, Santa Fe Springs, CA 90670

Phone: (562) 921-7461, Fax: (562) 802-0110

E-mail: sales@vanceandhines.com

Web: www.vanceandhines.com

Opening Hours – Monday through Friday, 8am – 5pm, Pacific Standard Time

Vance & Hines exhaust systems are warranted against defects in material and workmanship for a period of 90 days from the date of purchase from an authorized dealer. This warranty does not cover discoloration of any coated finishes. This warranty is limited to the repair or replacement of a product proven to be defective from normal use. Vance & Hines exhaust systems are designed to fit and operate on OEM motor and chassis. This warranty does not cover any product subject to abuse, misuse, improper installation or modification.

75-105-4 HD SOFTAIL 2:1 COMPETITION SERIES EXHAUST SYSTEM

75-105-4 PARTS LIST		
PART NO.	DESCRIPTION	QTY.
D352FB	Front Pipe Assy.	1
D353FB	Rear Pipe Assy.	1
A213HW	O ² Sensor Plug 18mm, Steel	2
A121HW	Washer, 24x18x1mm, Copper	2
D302RB	Megaphone Assy.	1
A204SP	Spring	2
A290HW	Flange Bolt, 3/8-16 x 3/4	2
A127R	Baffle Core Welded Assy	1
A1288EC	Comp. Baffle End Cap, TVD-DPD	1
A444HW	18-8 SS Capscrew 10-32, 3/8"	3
A235HW	BHCS 1/4"-20 x 1/2", Zinc	1
A112HW	Flat Washer Zinc, 1/4"	2
A115HW	Lock Washer Zinc, 1/4"	2
A445HW	BHCS 1/4"-20 x 5/8", Zinc	1
A205NP	Name Plate (2.5")	1
A362HW	Rivet	2
A267FG	Baffle Sock	1
A260SP	Exhaust Spring Puller Tool	1

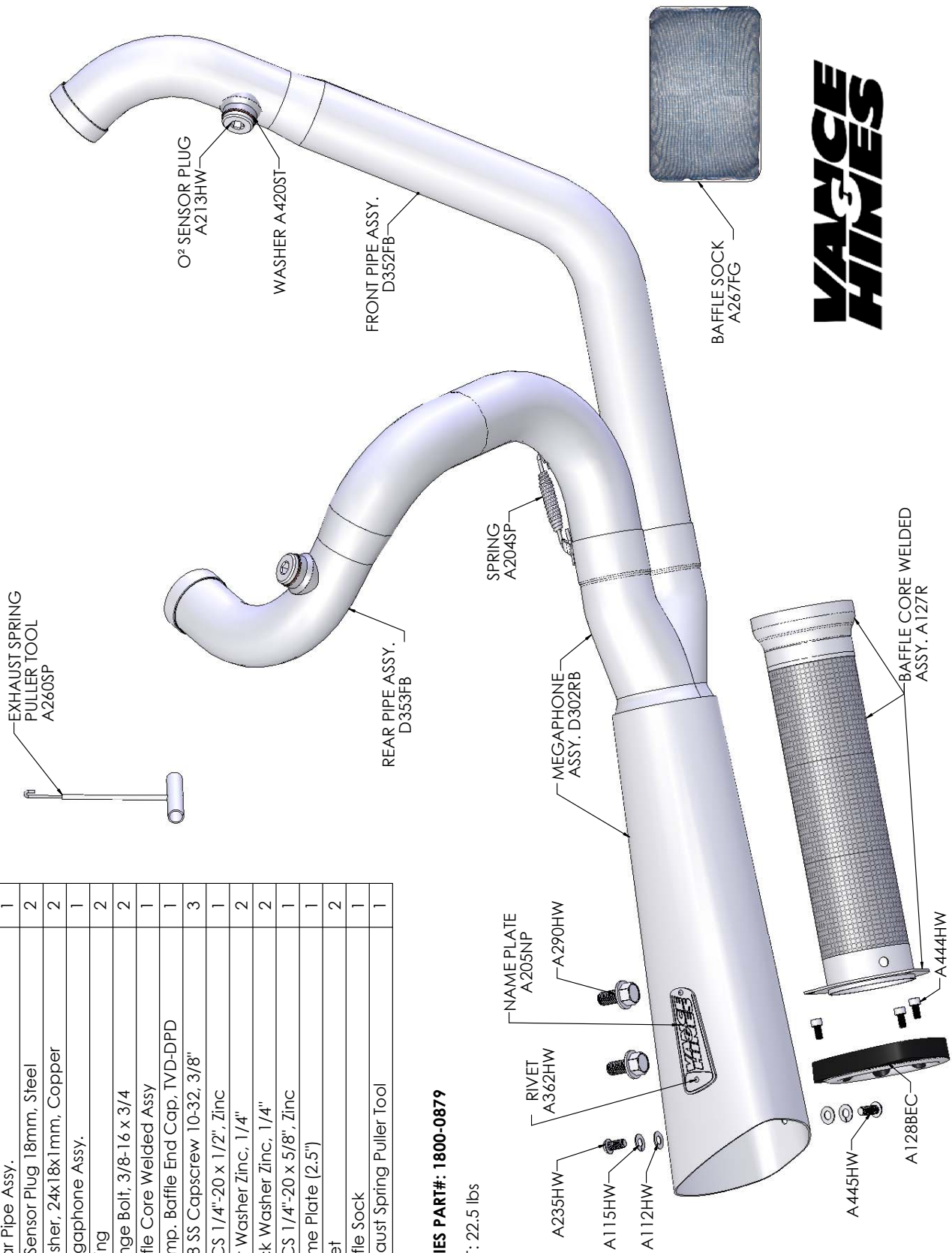

DRAG SPECIALTIES PART#: 1800-0879

STOCK EXHAUST: 22.5 lbs
75-105-4: 7 lbs