



PERFORMANCE EXHAUST SYSTEM

APPLICATION

YEAR	MODEL
2011-2012	Kawasaki ZX10R

PRODUCT

1418040220	R77 Stainless Steel 3/4 Exhaust System with Carbon Fiber Sleeve; Carbon Fiber Endcap
1418040520	R77 Stainless Steel 3/4 Exhaust System with Stainless Steel Sleeve; Carbon Fiber Endcap
1418040550	R77 Stainless Steel 3/4 Exhaust System with Stainless Steel Sleeve; Stainless Steel Endcap
1418040720	R77 Stainless Steel 3/4 Exhaust System with Titanium Sleeve; Carbon Fiber Endcap

!	This product is designed for use in closed course racing and is not intended for highway use. In the state of California, it is illegal to modify the emission control system, which includes the fuel injection system of any vehicle.
!	You must know how to remove and replace your stock exhaust in order to install this product otherwise have it installed by a professional mechanic. Keep all stock parts from your existing system as some components may be necessary to install your new Yoshimura exhaust depending on the application.
!	Read through all instructions before beginning installation. Exhaust system can be extremely hot. Let motorcycle cool down before beginning installation. Always wear hand and eye protection and take precautionary measures to avoid injury.

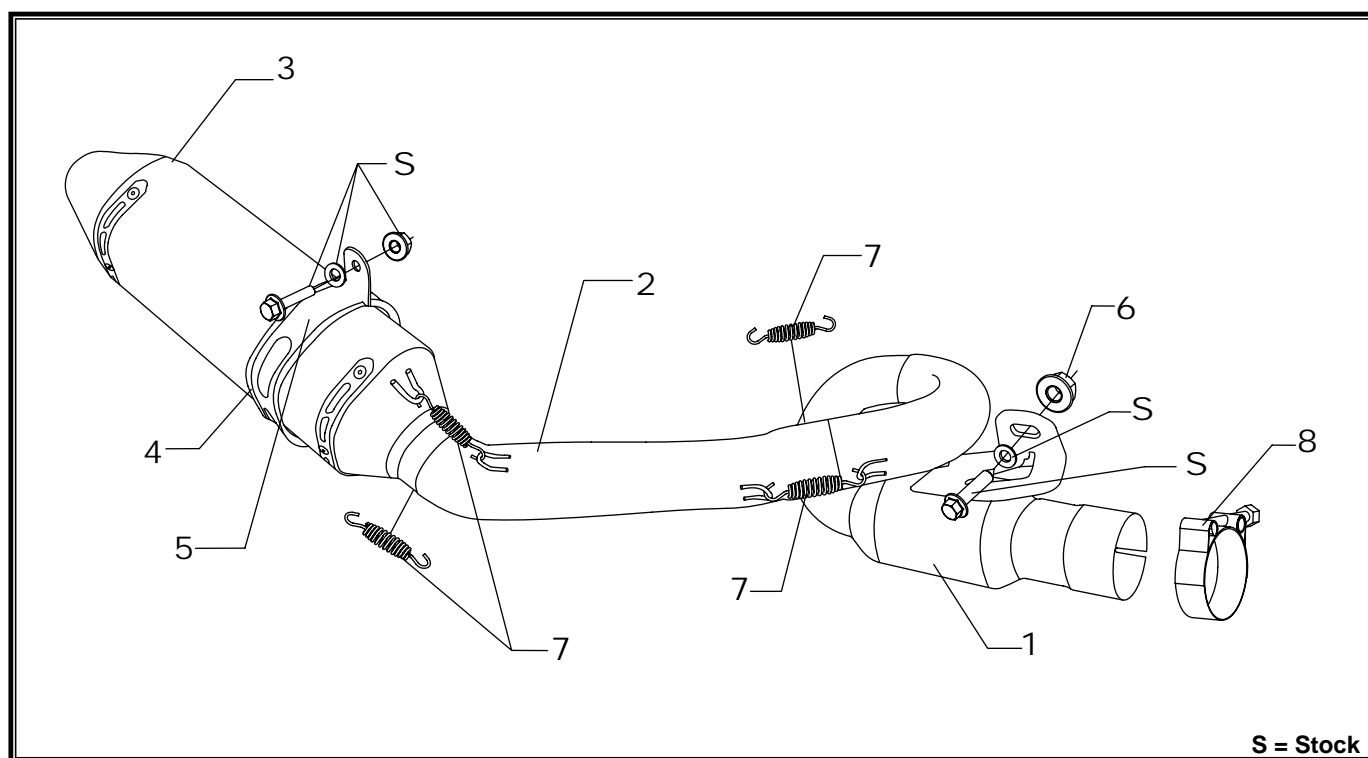

S = Stock

No.	Part #	Description	Qty
1	14180-415	Yoshimura Midpipe	1
2	14180-419	Yoshimura Tailpipe	1
3	CRR77116W SRR77116W SRR77116W-SS TRR77116W	Yoshimura Muffler CF Sleeve; CF Endcap SS Sleeve; CF Endcap SS Sleeve; SS Endcap Ti Sleeve; CF Endcap	1
4	HT SHLDR77	Muffler Clamp Heat Shield	1

5	1121-MPCL 1121-MPCLX	Muffler Clamp CF Sleeve Clamp SS/Ti Sleeve Clamp	1
6	10MMFNUT	10mm Flanged Nut	1
7	RACE-SPS-1	Medium Spring	4
8	20067	Exhaust Clamp	1
**	INS-03-K INS-04-K	SS EC Low Vol. Insert Kit CF EC Low Vol. Insert Kit	1
**	17029	Yoshimura Sticker Sht.	1
**	ST-200	Spring Puller Tool	1

-TOOLS REQUIRED-

Metric Socket Set

Combination Wrench Set

Torque Wrench

Metric Allen Wrench Set

-REMOVAL-

1. Removing the stock muffler assembly.

- a) Remove stock heat shield by removing the (3) screws.**
- b) Loosen muffler clamp.**
- c) While securely holding the muffler, remove the muffler mount bolt and carefully remove stock muffler and muffler clamp.**
- d) Remove exhaust valve cables as per Factory Service Manual. (Note: Exhaust valve cables will not be used with the Yoshimura 3/4 Exhaust System.)**
- e) Loosen belly muffler clamp.**
- f) Remove chassis mount bolt that supports belly muffler.**
- g) Slide belly muffler off header.**

-INSTALLATION-

1. Small parts installation.

- a) Install rubber heat shield on muffler clamp. (Note: Some trimming of the rubber heat shield may be necessary.)**
- b) Install muffler clamp over Yoshimura muffler.**

2. Installing the Yoshimura 3/4 Exhaust System.

- a) Install Yoshimura exhaust clamp on Yoshimura midpipe.**
- b) Install Yoshimura midpipe over stock header.**
- c) Using the stock chassis mount bolt, secure the midpipe to the stock belly muffler mount location. Do not torque at this time. (Note: Check for proper clearance on bottom of frame and adjust midpipe forward or backward as needed.)**
- d) Install Yoshimura muffler and tailpipe assembly to Yoshimura midpipe.**
- e) Secure muffler clamp to muffler mount using stock bolt, washer, and nut.**
- f) Tighten and torque exhaust clamp to 10 lb-ft. (13 Nm)**
- g) Torque muffler mount bolt to 10 lb-ft. (13 Nm)**
- h) Install springs on tailpipe to midpipe.**

3. Fitment check and Notes.

- a) Before starting motorcycle, check for proper clearance between new exhaust system and rear suspension (i.e. tire, swing-arm, brake, rear shock, engine, and etc.) If any problem is found, please carefully follow through the installation steps again. If problem still persists, please call Yoshimura Tech Department at (800) 634-9166 / in CA (909) 628-4722.**
- b) It is recommended that the muffler and tailpipe be wiped down with rubbing alcohol to remove oil and fingerprints. This will help prevent tarnishing of the finish after the exhaust is heated up.**
- c) NOTE: After starting motorcycle, it is normal for new exhaust system and muffler to emit smoke until oil residue burns off.**