

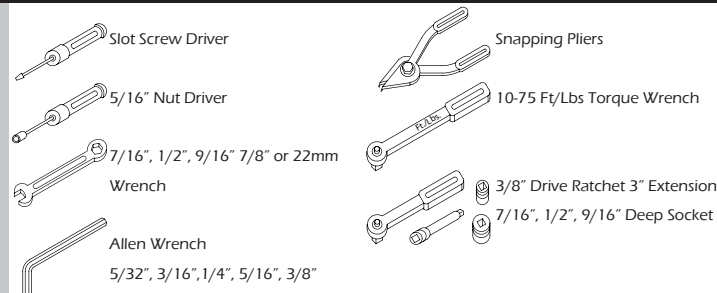

Congratulations, you have purchased the finest exhaust system available for your motorcycle. Your Vance & Hines exhaust is designed and crafted for maximum performance, a great sound and unbeatable style. Please follow the instructions below, check exhaust system for missing or damaged parts and if you need any assistance please contact our technical support line (562) 921-7461.

Attention installer (if other than owner), please forward this instruction sheet to the owner of this product. These instructions contain valuable information to the end user.

## TOOLS REQUIRED



## READ ALL INSTRUCTIONS BEFORE BEGINNING INSTALLATION

### STOCK EXHAUST REMOVAL

1. Remove seat to gain access to rear oxygen sensor connector. Unplug sensor and feed end of wire through frame to free it from motorcycle. NOTE: Pay attention to wire routing for reinstallation.
2. Remove two bolts holding rectifier onto front of frame (near front tire). Open plastic cover to gain access to front oxygen sensor connector. You must slide the connector to the right to remove it from the connector holder. Unplug sensor from harness. Remove cable tie holding wire to frame and feed end of wire through to free it from motorcycle.
3. Loosen heat shield clamps on both the front and rear head pipes.
4. Remove two cylinder exhaust port flange nuts from each head pipe, located at the cylinder head.
5. Remove front head pipe clamp bolt.
6. Remove the bolt that attaches mufflers to the frame mounting bar.
7. Remove the complete exhaust system and set aside (Assistance may be required).
8. Remove stock mounting bar and the studs in the transmission cover.
9. Remove the remaining bolts below the transmission cover. Position mounting bracket A227MB over the mounting location to determine which bolts to remove (Figure 1).
10. Carefully remove the flanges and circlips from the stock exhaust system using snapping pliers. NOTE: Replace bent or damaged circlips. Check condition of stock exhaust gaskets. Replace if worn or damaged. (Recommended replacement exhaust port gaskets, Screamin' Eagle part number 17048-98).
11. Remove stock oxygen sensors, they will be re-used on new system.

**FIGURE 1**

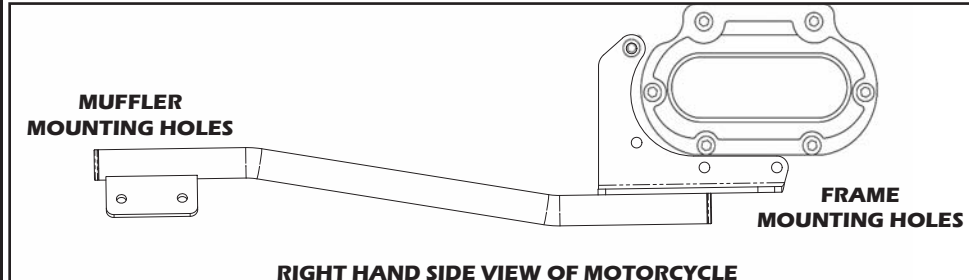

**FIGURE 2**

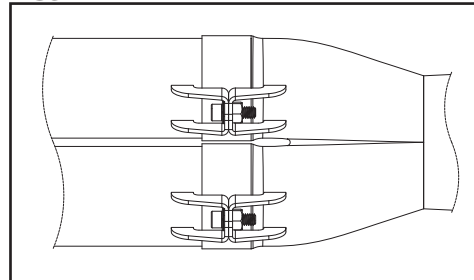

**FIGURE 3**

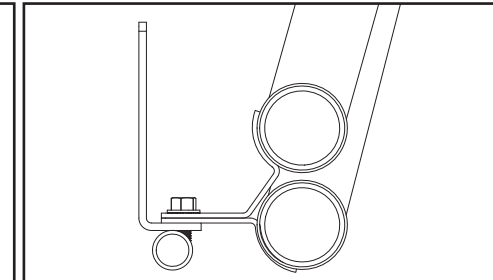



1. Install the bracket A227MB with the 5/16"x 1 1/2" bolts supplied, torque to 14-18 lbs (Figure 1).
2. Locate the front head pipe D197FP and rear head pipe D198FP.
3. On earlier models without O2 sensors it will be necessary to install O2 sensor plug kit #16925.
4. Apply a small amount of anti-seize compound to the threads of the O2 sensor and install them into the new head pipes. Note: Be careful not to get anti-seize on sensor tip, it may affect sensor function.
5. Install the flanges and circlips removed earlier.
6. Using the stock flange nuts, carefully install the head pipes into ports beginning with the rear cylinder. Note: Do not tighten the flange nuts completely at this time.
7. The brackets welded to the head pipes will lay on top of the new transmission bracket, refer to (Figure 3). Use the supplied 3/8 flange bolt and lock nut, do not fully tighten at this time.
8. Carefully slide the megaphone assembly D278RP over the head pipes.
9. Next slide a nut plate into the bracket welded to the back side of the megaphone. Loosely install two 5/16" flange head bolts (supplied).
10. Install the 1/4"x 3/4" bolts, lock washer and flat washer (supplied) through the head pipe mounting tabs (Figure 2).
11. Check alignment and tighten all the hardware starting with the cylinder nuts, transmission bracket bolt, megaphone bracket bolts and the head pipe mounting tab bolts.
12. Reinstall the O2 sensor connectors.
13. Check for adequate clearance between all exhaust system components and those motorcycle accessories prone to heat damage.
14. Be sure to check and tighten all hardware before starting your motorcycle.

Note: After initial ride it is recommended to re-torque the baffle screws to 129in lb. using a 3/16" allen wrench.

### EXHAUST CARE - HELPFUL HINTS KEEP YOUR EXHAUST LOOKING NEW

1. When installing a new set of black pipes, make sure your hands are clean and free of oil. After installation, thoroughly clean pipes with warm soapy water and a soft cloth. Dry with clean towel to remove any residue before starting the motorcycle. Do NOT use anything abrasive to clean pipes.

2. Avoid long periods of idling as this can cause discoloration.
3. Intake leaks can cause the engine to run lean and overheat, this could lead to discoloration.
4. Make sure there are no exhaust leaks at the junction of the exhaust pipes and cylinder head. We recommend replacing gaskets if they are worn.

### VANCE & HINES OPTIONAL ACCESSORIES



#### FUEL MANAGEMENT:

Maximize the efficiency of your improved air flow with properly managed fuel delivery by Fuelpak. Take the guess work out of fuel injection with Fuelpak Fuel Management. Contact your local dealer or call (562) 921-0071 to order. Visit [fuelpakfi.com](http://fuelpakfi.com) for more information.

Some Fuelpak systems are intended for use only on competition vehicles not used on public highways. For systems legal for use on public highways, please refer to ARB. E.O. No. D-632-1 or visit [www.fuelpakfi.com](http://www.fuelpakfi.com).

PLEASE NOTE: Every effort is made for Vance & Hines Exhaust Systems to provide improved cornering clearance. However, due to design and space limitations on some motorcycle models, ground and cornering clearance may not be improved and in some cases may be reduced. Be sure to follow proper installation instructions.

## HARLEY-DAVIDSON® 06-09 DYNA® MODEL PRO PIPE HI-OUTPUT 2-INTO-1 EXHAUST INSTALLATION INSTRUCTIONS PART# 47523



### PACKING LIST

47523 PARTS LIST		
PART NO.	Description	Qty.
D197FP	Front Pipe Assy.	1
D198FP	Rear Pipe Assy.	1
D278RP	Megaphone Assy.	1
A290HW	Flange Bolt, 3/8-16 x 3/4	1
A474HW	SHCS 1/4"-20 x 3/4"	2
A112HW	Flat Washer Zinc, 1/4"	2
A115HW	Lock Washer Zinc, 1/4"	2
A240HW	HHCS, 5/16-18 x 5/8	2
A195HW	Dog Bone Nut Plate	1
A227MB	Meg. Mounting Bracket	1
A475HW	Bolt, Flange Serrated 5/16-18 x 1 1/2	4
A126R	Baffle Core Welded Assy.	1
A266FG	Baffle Packing Sock	1

STOCK EXHAUST: 25 lbs  
47523: 18.5 lbs

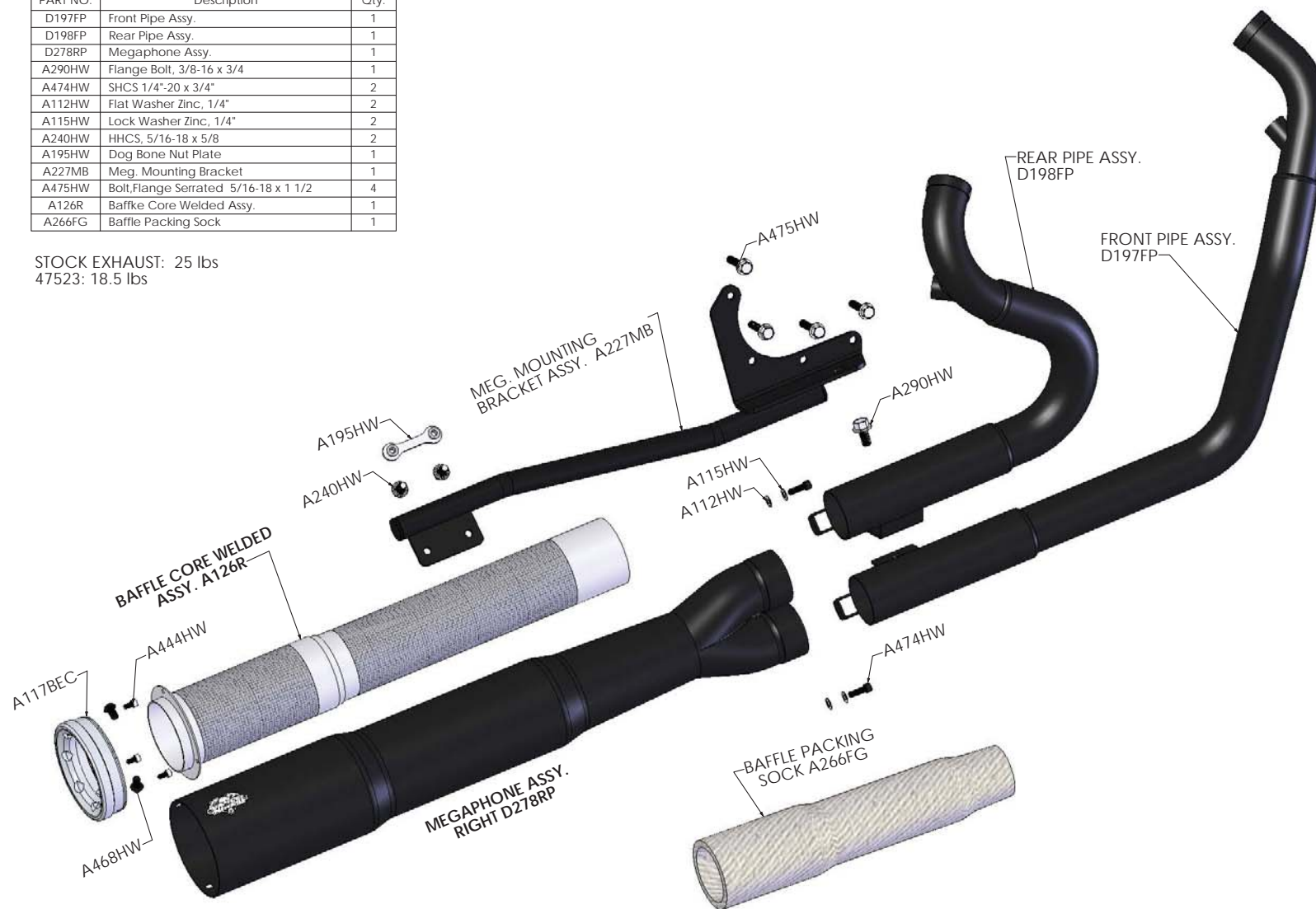

### WARRANTY

Vance & Hines products are warranted against defects in material and workmanship for a period of 90 days from the date of purchase from an authorized dealer. This warranty does not cover discoloration of chrome finishes. This warranty is limited to the repair or replacement of a product proven to be defective from normal use. Vance & Hines products are designed to fit and operate on OEM motor and chassis. This warranty does not cover any product subject to abuse, misuse, improper installation or modification.

## FUEL MANAGEMENT

**GET THE MOST OUT OF YOUR RIDING EXPERIENCE...**

### **NOW YOU NEED FUELPAK.**

Your fuel injected Harley-Davidson is equipped with an ECU (electronic control unit) that is programmed to deliver fuel to the motor based on an air/fuel ratio for a stock air filter and stock exhaust system. When you install a performance exhaust system, your airflow changes, so you need a fuel management system that adjusts your air/fuel ratio to match the changes. That fuel management system is Fuelpak. Fuelpak adds and takes away fuel, allowing for a more precise range of refinement in your air/fuel ratio. Get the perfect fuel management combination with your Vance & Hines exhaust system, get Fuelpak. For more information visit the tuning center at [fuelpakfi.com](http://fuelpakfi.com)

NOTICE: Fuelpak is intended for racing or off-highway use only, and is not legal for sale or use in California on pollution-controlled vehicles.



**13861 ROSECRANS AVENUE / SANTA FE SPRINGS, CA 90670**  
**SALES: (562) 921-5388 / TECHNICAL: (562) 926-5291 / FAX: (562) 802-0110**  
**VANCEANDHINES.COM**